

NO. OF COPIES RECEIVED	6
DISTRIBUTION	
SANTA FE	1
FILE	1
U.S.G.S.	2
LAND OFFICE	1
OPERATOR	1

NEW MEXICO OIL CONSERVATION COMMISSION

30-015-22629
Form C-101
Revised 1-1-65

RECEIVED

JUL 3 1978

5A. Indicate Type of Lease	
STATE <input checked="" type="checkbox"/>	FEE <input type="checkbox"/>
5. State Oil & Gas Lease No. E-7116	

APPLICATION FOR PERMIT TO DRILL, DEEPEN, OR PLUG BACK

1a. Type of Work DRILL <input checked="" type="checkbox"/> DEEPEN <input type="checkbox"/> PLUG BACK <input type="checkbox"/>		7. Unit Agreement Name Empire Abo Pressure Maintenance Project	
b. Type of Well OIL WELL <input checked="" type="checkbox"/> GAS WELL <input type="checkbox"/> OTHER <input type="checkbox"/>		8. Farm or Lease Name Empire Abo Unit "F"	
2. Name of Operator Atlantic Richfield Company		9. Well No. 353	
3. Address of Operator P. O. Box 1710, Hobbs, New Mexico 88240		10. Field and Pool, or Wildcat Empire Abo	
4. Location of Well UNIT LETTER G LOCATED 2400 FEET FROM THE North LINE AND 2350 FEET FROM THE East LINE OF SEC. 34 TWP. 17S RGE. 28E NMPM		12. County Eddy	
19. Proposed Depth 6370'		19A. Formation Abo Reef	
21. Elevations (Show whether DT, RT, etc.) 3661.4' GR		20. Rotary or C.T. Rotary	
21A. Kind & Status Plug. Bond GCA #8		22. Approx. Date Work will start Nov. 6, 1978	

23.

PROPOSED CASING AND CEMENT PROGRAM

SIZE OF HOLE	SIZE OF CASING	WEIGHT PER FOOT	SETTING DEPTH	SACKS OF CEMENT	EST. TOP
11"	8-5/8" OD	24# K-55	600'	300 sx	circ
7-7/8"	5-1/2" OD	15.5# K-55	6370'	1250 sx	circ

Propose to drill an infill development well within the Empire Abo Unit area to more economically recover additional oil reserves and conserve reservoir pressure in accordance with unit OCC Rules & Regulations.

Blowout Preventer Program attached.

NSL 937

APPROVAL VALID
FOR 90 DAYS UNLESS
DRILLING COMMENCED,

EXPIRES 10-26-78

IN ABOVE SPACE DESCRIBE PROPOSED PROGRAM: IF PROPOSAL IS TO DEEPEN OR PLUG BACK, GIVE DATA ON PRESENT PRODUCTIVE ZONE AND PROPOSED NEW PRODUCTIVE ZONE, GIVE BLOWOUT PREVENTER PROGRAM, IF ANY.

I hereby certify that the information above is true and complete to the best of my knowledge and belief.

Signed [Signature] Title Dist. Drlg. Supt. Date 6-28-78

(This space for State Use)

APPROVED BY [Signature] TITLE SUPERVISOR, DISTRICT II DATE JUL 26 1978
CONDITIONS OF APPROVAL, IF ANY:

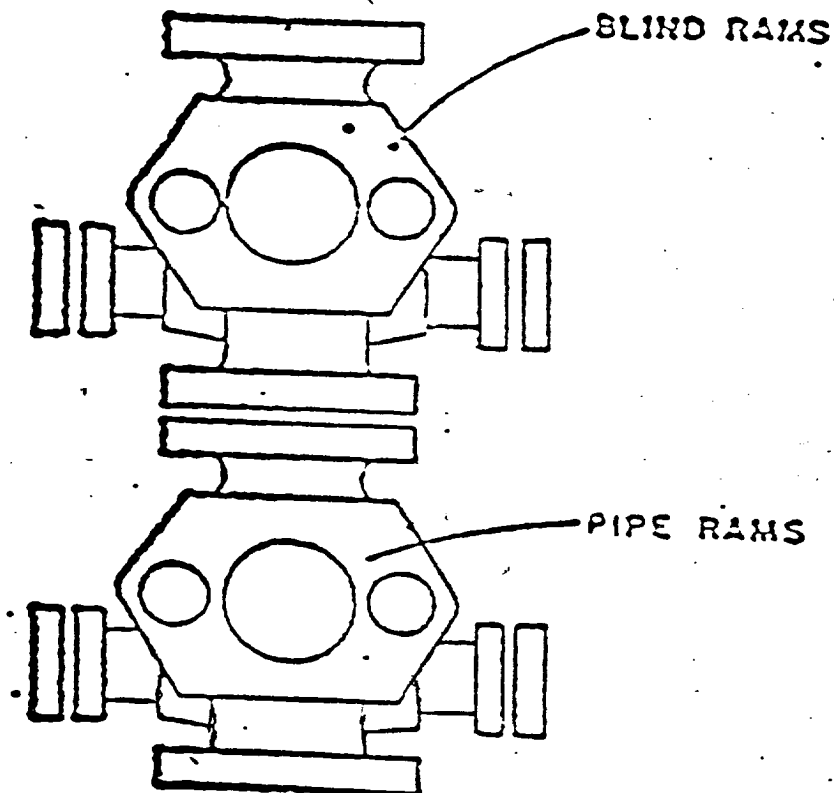

ATLANTIC RICHFIELD COMPANY
Blow Out Preventer Program

Lease Name Empire Abo Unit "F"

Well No. 353

Location 2400' FNL, 2350' FEL, Sec. 34,
T-17-S, R-28-E, Eddy Co., N.M.

BOP to be tested before installed on well and will be maintained in good working condition during drilling. All wellhead fittings to be of sufficient pressure to operate in a safe manner.

Form C-102
Supersedes C-128
Effective 1-1-65

Operator Atlantic Richfield Co.		Lease Empire Abo Unit # F		Well No. 353
Unit Letter G	Section 34	Township 17 South	Range 28 East	County Eddy
Actual Footage Location of Well:				
2400		feet from the North	line and 2350	feet from the East line
Ground Level Elev. 3661.4	Producing Formation Abo Reef		Pool Empire Abo	Dedicated Acreage: 40 Acres

- ☒ Yes ☐ No If answer is "yes," type of consolidation Unitization

No allowable will be assigned to the well until all interests have been consolidated (by communitization, unitization, forced-pooling, or otherwise) or until a non-standard unit, eliminating such interests, has been approved by the Commission.

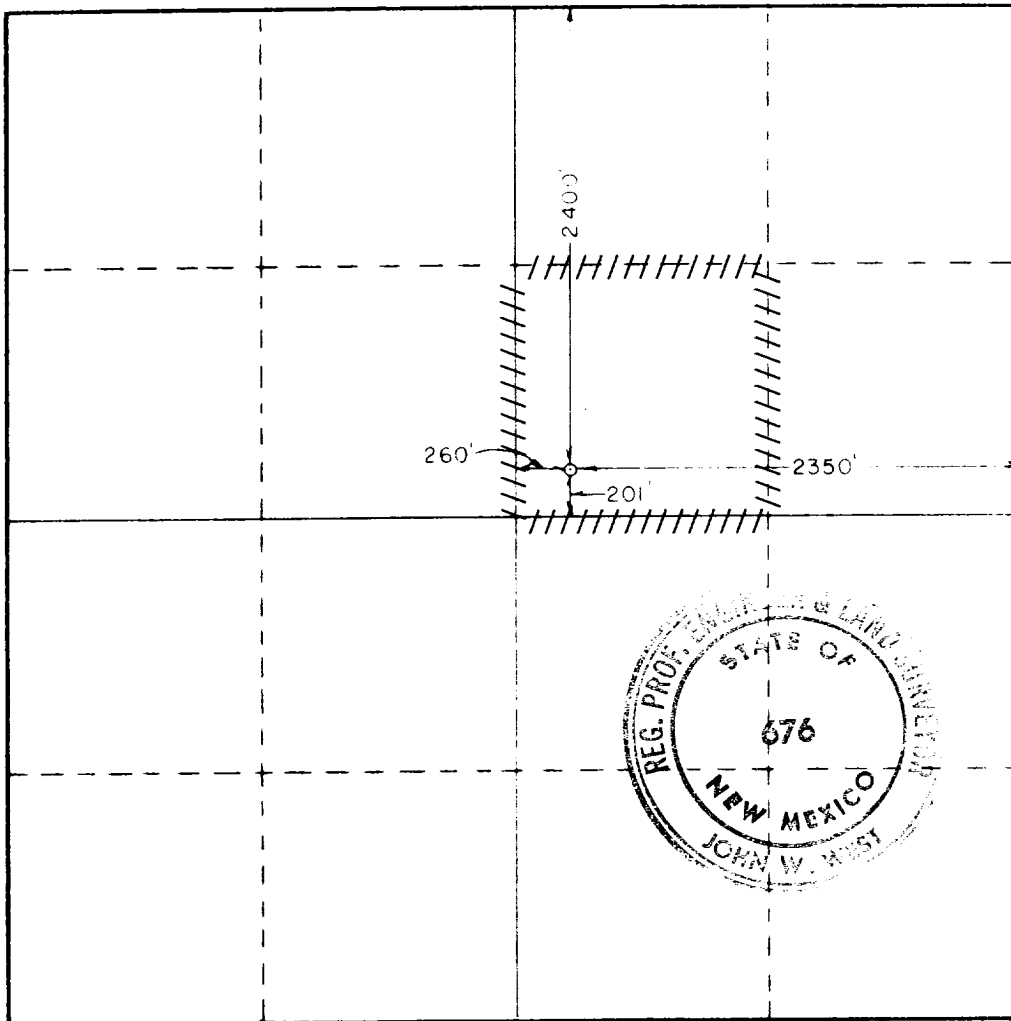

[Signature]

1

Position

CONFIDENTIAL

File

I hereby certify that the well location shown on this plat was plotted from field notes of actual surveys made by me or under my supervision and that the same is true and correct to the best of my knowledge and belief.

Date Surveyed: _____

Registered Professional Engineer
and/or Land Surveyor

Should What

Certificate No. John W. West 676

Ronald J. Eidson 3239