

NO. OF COPIES RECEIVED	6
DISTRIBUTION	
SANTA FE	1
FILE	1
U.S.G.S.	2
LAND OFFICE	1
OPERATOR	1

NEW MEXICO OIL CONSERVATION COMMISSION

RECEIVED

JUL 3 1978

30-015-22634  
Form C-101  
Revised 1-1-65

APPLICATION FOR PERMIT TO DRILL, DEEPEN, OR PLUG BACK

1a. Type of Work DRILL <input checked="" type="checkbox"/> DEEPEN <input type="checkbox"/> PLUG BACK <input type="checkbox"/>		A. Indicate Type of Lease STATE <input checked="" type="checkbox"/> FEE <input type="checkbox"/>	
b. Type of Well OIL WELL <input checked="" type="checkbox"/> GAS WELL <input type="checkbox"/> OTHER <input type="checkbox"/>		5. State Oil & Gas Lease No. 647-349, 647-351	
2. Name of Operator Atlantic Richfield Company		7. Unit Agreement Name Empire Abo Pressure Maintenance Project	
3. Address of Operator P. O. Box 1710, Hobbs, New Mexico 88240		8. Farm or Lease Name Empire Abo Unit "H"	
4. Location of Well UNIT LETTER N LOCATED 800 FEET FROM THE South LINE AND 1340 FEET FROM THE West LINE OF SEC. 33 TWP. 17S RGE. 28E NMPM		9. Well No. 303	
		10. Field and Pool, or Wildcat Empire Abo	
		12. County Eddy	
		19. Proposed Depth 6300'	
		19A. Formation Abo Reef	
		20. Rotary or C.T. Rotary	
21. Elevations (Show whether DF, RT, etc.) 3665.6' GR		21A. Kind & Status Plug. Bond GCA #8	
		21B. Drilling Contractor Hondo Drilling Co.	
		22. Approx. Date Work will start Nov. 6, 1978	

23.

PROPOSED CASING AND CEMENT PROGRAM

SIZE OF HOLE	SIZE OF CASING	WEIGHT PER FOOT	SETTING DEPTH	SACKS OF CEMENT	EST. TOP
11"	8-5/8" OD	24# K-55	600'	300	Circ
7-7/8"	5-1/2" OD	15.5# K-55	6300'	1250	Circ

Propose to drill an infill development well within the Empire Abo Unit Area to more economically recover additional oil reserves and conserve reservoir pressure in accordance with Unit OCC Rules & Regulations.

Blowout Preventer Program attached.

NSL-937

APPROVAL VALID  
FOR 90 DAYS UNLESS  
DRILLING COMMENCED,

EXPIRES 10-26-78

IN ABOVE SPACE DESCRIBE PROPOSED PROGRAM: IF PROPOSAL IS TO DEEPEN OR PLUG BACK, GIVE DATA ON PRESENT PRODUCTIVE ZONE AND PROPOSED NEW PRODUCTIVE ZONE. GIVE BLOWOUT PREVENTER PROGRAM, IF ANY.

I hereby certify that the information above is true and complete to the best of my knowledge and belief.

Signed W. A. Gressett Title Dist. Drlg. Supt. Date 6-28-78

(This space for State Use)

APPROVED BY W. A. Gressett TITLE SUPERVISOR, DISTRICT II DATE JUL 26 1978

CONDITIONS OF APPROVAL, IF ANY:

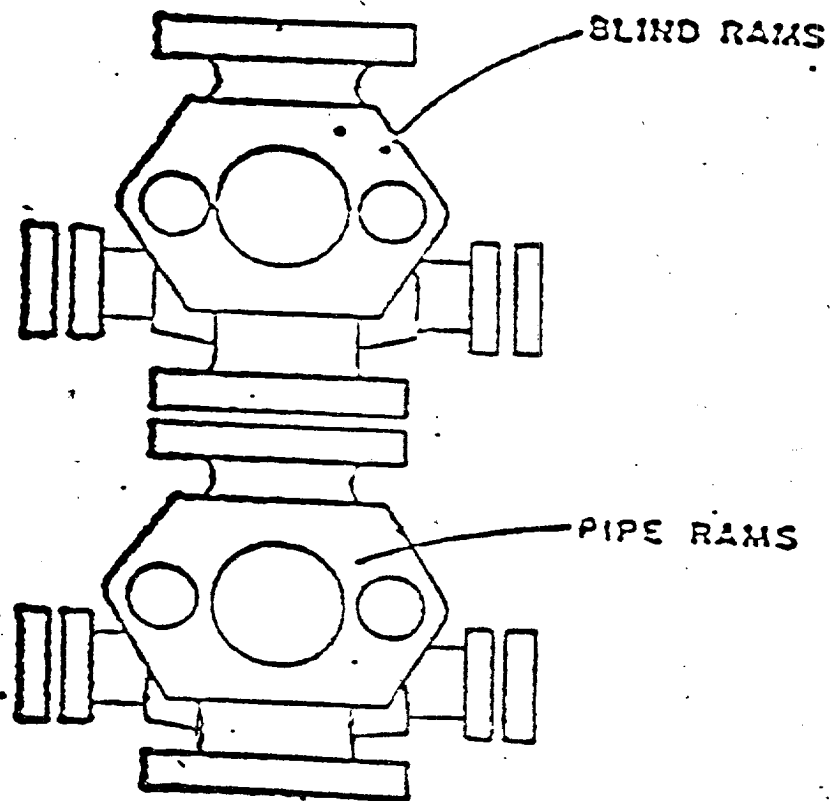

**ATLANTIC RICHFIELD COMPANY**  
**Blow Out Preventer Program**

**Lease Name** Empire Abo Unit "H"

**Well No.** 303

**Location** 800' FSL, 1340' FWL, Sec. 33,  
T-17-S, R-28-E, Eddy Co., N.M.

**BOP to be tested before installed on well and will be maintained in good working condition during drilling. All wellhead fittings to be of sufficient pressure to operate in a safe manner.**

NEW MEXICO OIL CONSERVATION COMMISSION  
WELL LOCATION AND ACREAGE DEDICATION PLAT

Form C-102  
Supersedes C-128  
Effective 1-1-65

All distances must be from the outer boundaries of the Section

Operator <b>Atlantic Richfield Co.</b>			Lease <b>Empire Abo Unit # H</b>		Well No. <b>303</b>
Section <b>N</b>	Section <b>33</b>	Township <b>17 South</b>	Range <b>28 East</b>	County <b>Eddy</b>	
Actual Well Location of Well:					
<b>800</b>		feet from the	<b>South</b>	line and	<b>1340</b>
				feet from the	<b>West</b>
Ground Level Elev. <b>3665.6</b>	Producing Formation <b>Abo Reef</b>		Pool <b>Empire Abo</b>		Dedicated Acreage: <b>40</b> Acres

- Outline the acreage dedicated to the subject well by colored pencil or hatchure marks on the plat below.
- If more than one lease is dedicated to the well, outline each and identify the ownership thereof (both as to working interest and royalty).
- If more than one lease of different ownership is dedicated to the well, have the interests of all owners been consolidated by communitization, unitization, force-pooling, etc?

☒ Yes ☐ No If answer is "yes," type of consolidation Unitization

If answer is "no," list the owners and tract descriptions which have actually been consolidated. (Use reverse side of this form if necessary.)

No allowable will be assigned to the well until all interests have been consolidated (by communitization, unitization, forced-pooling, or otherwise) or until a non-standard unit, eliminating such interests, has been approved by the Commission.

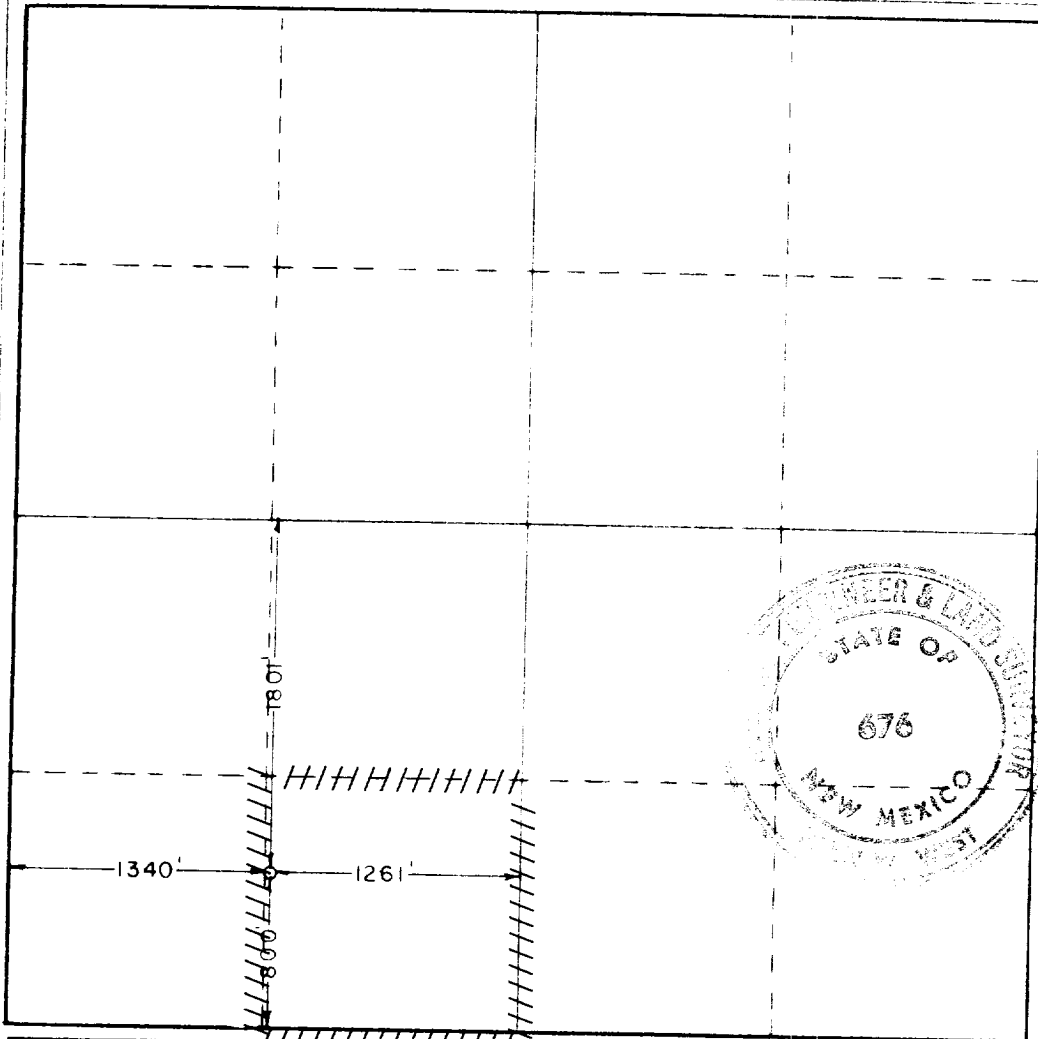

CERTIFICATION

I hereby certify that the information contained herein is true and complete to the best of my knowledge and belief.

Name

**LeRoy Lane**

Position

**Dist. Drlg. Supt.**

Company

**Atlantic Richfield Co.**

Date

**6-28-78**

I hereby certify that the well location shown on this plat was plotted from field notes of actual surveys made by me or under my supervision, and that the same is true and correct to the best of my knowledge and belief.

**March 15, 1978**

Date Surveyed

Registered Professional Engineer  
and/or Land Surveyor

*John W. West*

Certificate No. **John W. West 676**  
**Ronald J. Eidson 3239**