

NO. OF COPIES RECEIVED	6
DISTRIBUTION	
SANTA FE	1
FILE	1
U.S.G.S.	2
LAND OFFICE	1
OPERATOR	1

NEW MEXICO OIL CONSERVATION COMMISSION

RECEIVED

JUL 27 1978

30-015-22639

Form C-101
Revised 1-1-65

5A. Indicate Type of Lease STATE <input checked="" type="checkbox"/> FEE <input type="checkbox"/>
5. State Oil & Gas Lease No. B-1111
7. Unit Agreement Name
8. Farm or Lease Name STATE "B"
9. Well No. #4
10. Field and Pool, or Wildcat Und. E. EMPIRE YATES 7-R's
12. County EDDY
19. Proposed Depth 800
19A. Formation 7-R's
20. Rotary or C.T. ROTARY (AIR)
21. Elevations (Show whether DF, RL, etc.) 3590.8
21A. Kind & Status of Eng. Bond STATEWIDE
21B. Drilling Contractor YUCCA
22. Approx. Date Work will start JULY 26, 1978

APPLICATION FOR PERMIT TO DRILL, DEEPEN, OR PLUG BACK

1a. Type of Work b. Type of Well OIL WELL <input checked="" type="checkbox"/> GAS WELL <input type="checkbox"/> OTHER <input type="checkbox"/> DRILL <input checked="" type="checkbox"/> DEEPEN <input type="checkbox"/> PLUG BACK <input type="checkbox"/> SINGLE ZONE <input type="checkbox"/> MULTIPLE ZONE <input type="checkbox"/>	2. Name of Operator COLLIER & COLLIER	3. Address of Operator BOX 798, ARTESIA, NEW MEXICO 88210	4. Location of Well UNIT LETTER M LOCATED 990 FEET FROM THE SOUTH LINE AND 990 FEET FROM THE NORTH WEST LINE OF SEC. 22 TWP. 17 RGE. 28 NMPM
23. PROPOSED CASING AND CEMENT PROGRAM			

SIZE OF HOLE	SIZE OF CASING	WEIGHT PER FOOT	SETTING DEPTH	SACKS OF CEMENT	EST. TOP
7 7/8	4 1/2"	9.50 #	800'	250 sxs	Surface

July 26, 1978

Plan to spud using 7 7/8" bit and drill to T.D. using air

July 28, 1978

Plan to run 4 1/2", 9.50# casing to 800' and circulate cement to surface.

APPROVAL VALID
FOR 90 DAYS UNLESS
DRILLING COMMENCED,
EXPIRES 10-26-78

IN ABOVE SPACE DESCRIBE PROPOSED PROGRAM; IF PROPOSAL IS TO DEEPEN OR PLUG BACK, GIVE DATA ON PRESENT PRODUCTIVE ZONE AND PROPOSED NEW PRODUCTIVE ZONE. GIVE BLOWOUT PREVENTER PROGRAM, IF ANY.

I hereby certify that the information above is true and complete to the best of my knowledge and belief.

Signed Timothy D. Collier Title PARTNER Date JULY 25, 1978

(This space for State Use)

APPROVED BY W. A. Grossett TITLE SUPERVISOR, DISTRICT II DATE JUL 27 1978

CONDITIONS OF APPROVAL, IF ANY:

Cement must be circulated to
surface behind 4 1/2" casing

Notify N.M.O.C.C. in sufficient
time to witness cementing
the 4 1/2" casing

NEW MEXICO OIL CONSERVATION COMMISSION
WELL LOCATION AND ACREAGE DEDICATION LAT

Form C-102
Supersedes C-128
Effective 1-1-65

All distances must be from the outer boundaries of the Section.

Operator COLLIER & COLLIER			Lease STATE "B" New Mexico ST. A		Well No. M-1 # 4
Unit Letter M	Section 22	Township 17 South	Range 28 East	County Eddy	
Actual Footage Location of Well:					
990 feet from the South		Line and 990 feet from the West		Bore	
Ground Level Elev. 3590.8	Producing Formation 7-Rivers EMPIRE YATES 7-R		Pool EMPIRE YATES 7-R	Dedicated Acres per Acre 40	

1. Outline the acreage dedicated to the subject well by colored pencil or hatchure marks on the plat below.
2. If more than one lease is dedicated to the well, outline each and identify the ownership thereof (both as to working interest and royalty).
3. If more than one lease of different ownership is dedicated to the well, have the interests of all owners been consolidated by communitization, unitization, force-pooling, etc?
☐ Yes ☐ No If answer is "yes," type of consolidation _____

If answer is "no," list the owners and tract descriptions which have actually been consolidated. (Use reverse side of this form if necessary.) _____

No allowable will be assigned to the well until all interests have been consolidated (by communitization, unitization, forced-pooling, or otherwise) or until a non-standard unit, eliminating such interests, has been approved by the Commission.

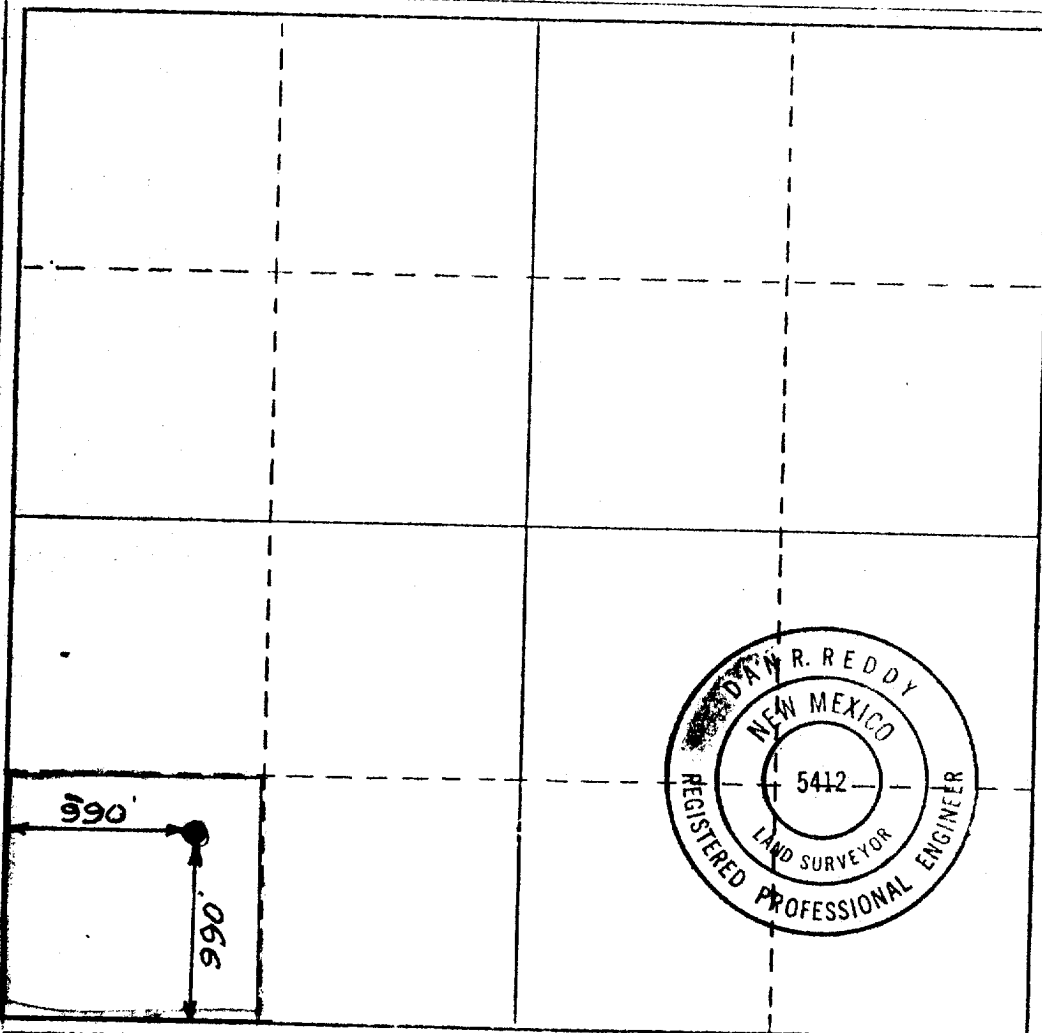

CERTIFICATION

I hereby certify that the information contained herein is true and complete to the best of my knowledge and belief.

Mary J. Bustamante
Name

Position
AGENT

Company
COLLIER & COLLIER

Date
JULY 24, 1978

I hereby certify that the well location shown on this plat was plotted from field notes of actual surveys made by me or under my supervision, and that the same is true and correct to the best of my knowledge and belief.

Date Surveyed

July 13, 1978

Registered Professional Engineer and/or Land Surveyor

Dan R. Reddy
Certificate No.

NM PE&LS #5412