

NO. OF COPIES RECEIVED	
DISTRIBUTION	
SANTA FE	1
FILE	1
U.S.G.S.	2
LAND OFFICE	1
OPERATOR	1

NEW MEXICO OIL CONSERVATION COMMISSION

RECEIVED

DEC 20 1978

O. C. C.
ARTESIA, OFFICE

30-015-22765
Form C-101
Revised 1-1-65

5A. Indicate Type of Lease STATE <input checked="" type="checkbox"/> FEE <input type="checkbox"/>
5. State Oil & Gas Lease No. 647-368, 647-363, 647-320

APPLICATION FOR PERMIT TO DRILL, DEEPEN, OR PLUG BACK

1a. Type of Work b. Type of Well OIL WELL <input checked="" type="checkbox"/> GAS WELL <input type="checkbox"/> OTHER <input type="checkbox"/> DRILL <input checked="" type="checkbox"/> DEEPEN <input type="checkbox"/> PLUG BACK <input type="checkbox"/> SINGLE ZONE <input checked="" type="checkbox"/> MULTIPLE ZONE <input type="checkbox"/>		7. Unit Agreement Name Empire Abo Pressure Maintenance Project 8. Farm or Lease Name Empire Abo Unit "E"
2. Name of Operator Atlantic Richfield Company		9. Well No. 383
3. Address of Operator P.O. Box 1710, Hobbs, New Mexico 88240		10. Field and Pool, or Wildcat Empire Abo
4. Location of Well UNIT LETTER C LOCATED 1190 FEET FROM THE North LINE AND 1910 FEET FROM THE West LINE OF SEC. 35 TWP. 17S RGE. 28E NMPM		12. County Eddy
19. Proposed Depth 6300'		19A. Formation Abo Reef
20. Rotary or C.T. Rotary		21. Elevations (Show whether DT, RT, etc.) 3679.3' GR
21A. Kind & Status Plug. Bond GCA #8		21B. Drilling Contractor Hondo Drlg. Co.
22. Approx. Date Work will start 1-2-79		

23.

PROPOSED CASING AND CEMENT PROGRAM

SIZE OF HOLE	SIZE OF CASING	WEIGHT PER FOOT	SETTING DEPTH	SACKS OF CEMENT	EST. TOP
11"	8-5/8" OD	24# K-55	750'	350	Circ to Surf.
7-7/8"	5-1/2" OD	15.5# K-55	6300'	1375	Circ to Surf by 2 Staging

Propose to drill a development well in the Empire Abo Pressure Maintenance Project to more economically recover remaining reserves.

Authority to drill above Non-Standard location by approval of Administrative Order NSL-999.

Blowout Preventer Program attached.

APPROVAL VALID
FOR 90 DAYS UNLESS
DRILLING COMMENCED,

EXPIRES 3-26-79

IN ABOVE SPACE DESCRIBE PROPOSED PROGRAM: IF PROPOSAL IS TO DEEPEN OR PLUG BACK, GIVE DATA ON PRESENT PRODUCTIVE ZONE AND PROPOSED NEW PRODUCTIVE ZONE. GIVE BLOWOUT PREVENTER PROGRAM, IF ANY.

I hereby certify that the information above is true and complete to the best of my knowledge and belief.

Signed [Signature] Title Dist. Drlg. Supt. Date 12-19-78

(This space for State Use)

APPROVED BY W. A. Gussett TITLE SUPERVISOR, DISTRICT II DATE DEC 26 1978

CONDITIONS OF APPROVAL, IF ANY:

MEXICO OIL CONSERVATION COMMISSION
WELL LOCATION AND ACREAGE DEDICATION PLAT

Form C-102
 Supersedes C-128
 Effective 1-1-65

All distances must be from the outer boundaries of the Section

Operator Atlantic Richfield Co.			Lease Empire Abo Unit E		Well No. 383
Unit Letter C	Section 35	Township 17-S	Range 28-E	County Eddy	
Actual Footage Location of Well: 1190 feet from the North line and 1910 feet from the West line					
Ground Level Elev. 3679.3	Producing Formation Abo Reef		Pool Empire Abo		Dedicated Acreage: 40 Acres

1. Outline the acreage dedicated to the subject well by colored pencil or hachure marks on the plat below.
2. If more than one lease is dedicated to the well, outline each and identify the ownership thereof (both as to working interest and royalty).
3. If more than one lease of different ownership is dedicated to the well, have the interests of all owners been consolidated by communitization, unitization, force-pooling, etc?

☒ Yes ☐ No If answer is "yes," type of consolidation Unitization

If answer is "no," list the owners and tract descriptions which have actually been consolidated. (Use reverse side of this form if necessary.) _____

No allowable will be assigned to the well until all interests have been consolidated (by communitization, unitization, forced-pooling, or otherwise) or until a non-standard unit, eliminating such interests, has been approved by the Commission.

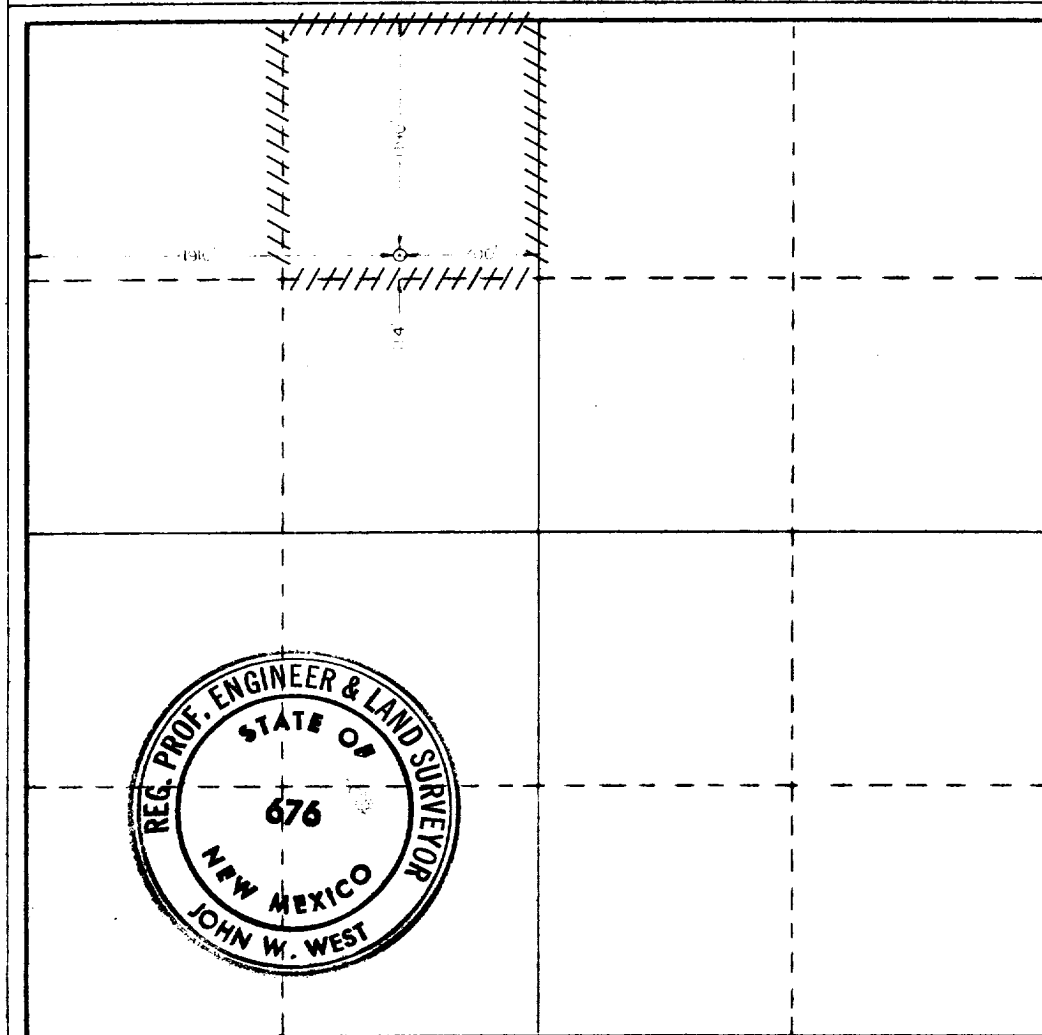

CERTIFICATION

I hereby certify that the information contained herein is true and complete to the best of my knowledge and belief.

LeRoy Lane

Name

LeRoy Lane

Position

Dist. Drlg. Supt.

Company

Atlantic Richfield Co.

Date

12-19-78

I hereby certify that the well location shown on this plat was plotted from field notes of actual surveys made by me or under my supervision, and that the same is true and correct to the best of my knowledge and belief.

Date Surveyed

October 25, 1978

Registered Professional Engineer and/or Land Surveyor

John W. West

Certificate No.

John W. West

676

Ronald J. Eidson

3239

0 330 660 990 1320 1650 1980 2310 2640 2970 3300 3630 3960 4290 4620 4950 5280 5610 5940 6270 6600

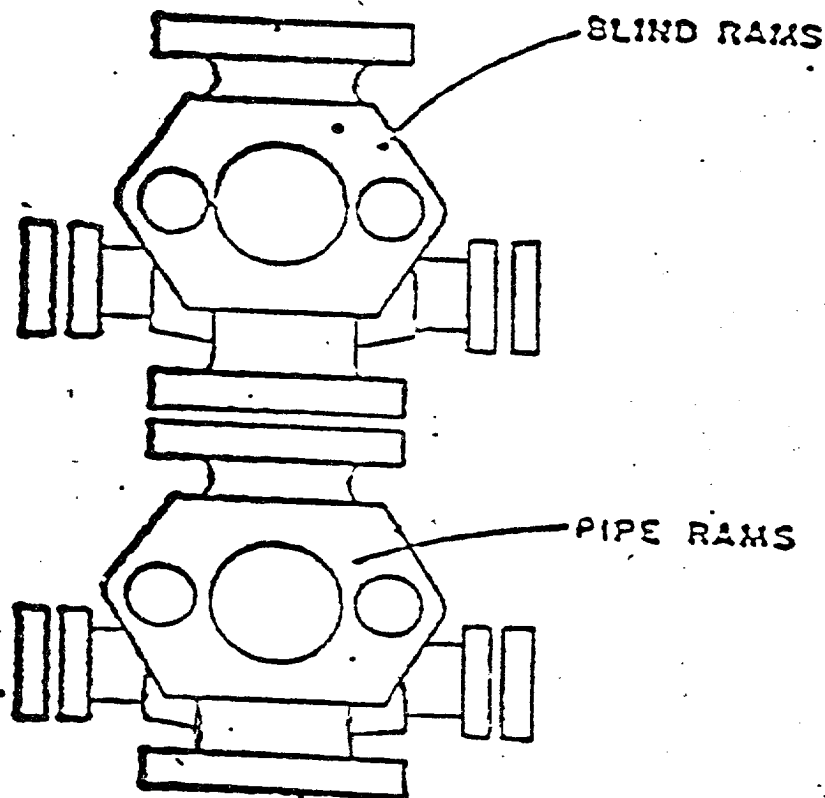

ATLANTIC RICHFIELD COMPANY
Blow Out Preventer Program

Lease Name Empire Abo Unit "E"

Well No. 383

Location Unit C, 1190 FNL & 1910 FWL,
Sec 35, T-17-S, R-28-E

BOP to be tested before installed on well and will be maintained in good working condition during drilling. All wellhead fittings to be of sufficient pressure to operate in a safe manner.