

NO. OF COPIES RECEIVED	6
DISTRIBUTION	
SANTA FE	1
FILE	1
U.S.G.S.	2
LAND OFFICE	1
OPERATOR	1

NEW MEXICO OIL CONSERVATION COMMISSION

RECEIVED

JAN 5 1979

O. C. C.

ARTERIA OFFICE

APPLICATION FOR PERMIT TO DRILL, DEEPEN, OR PLUG BACK

30-015-22772

Form C-101
Revised 1-1-65

5A. Indicate Type of Lease

STATE ☒ FEE ☐

5. State Oil & Gas Lease No.

647-368

647-363 647-320

7. Unit Agreement Name

Empire Abo Pressure

Maintenance Project

8. Farm or Lease Name

Empire Abo Unit "F"

9. Well No.

375

10. Field and Pool, or Wildcat

Empire Abo

1a. Type of Work

DRILL ☒

DEEPEN ☐

PLUG BACK ☐

b. Type of Well

OIL WELL ☒

GAS WELL ☐

OTHER

SINGLE ZONE ☒

MULTIPLE ZONE ☐

2. Name of Operator

Atlantic Richfield Company

3. Address of Operator

Box 1710, Hobbs, New Mexico 88240

4. Location of Well

UNIT LETTER E

LOCATED 1780

FEET FROM THE North LINE

AND 1175

FEET FROM THE West

LINE OF SEC. 35

TWP. 17S RGE. 28E NMPM

12. County

Eddy

21. Elevations (Show whether DF, RT, etc.)

3681.2' GL

21A. Kind & Status Plug. Bond

GCA #8

21B. Drilling Contractor

Hondo Drlg. Co.

22. Approx. Date Work will start

1/9/79

23.

PROPOSED CASING AND CEMENT PROGRAM

SIZE OF HOLE	SIZE OF CASING	WEIGHT PER FOOT	SETTING DEPTH	SACKS OF CEMENT	EST. TOP
11"	8-5/8" OD	24# K-55	750'	475	Circ to surf
7-7/8"	5-1/2" OD	15.5# K-55	6350'	1375	Circ to surf
					by 2 staging

Propose to drill a development well in the Empire Abo Pressure Maintenance Project to more economically recover remaining reserves.

Authority to drill above non-standard location by approval of Administrative Order NSL-999.

Blowout Preventer Program attached.

APPROVAL VALID
FOR 90 DAYS UNLESS
DRILLING COMMENCED,

EXPIRES 4-8-79

IN ABOVE SPACE DESCRIBE PROPOSED PROGRAM: IF PROPOSAL IS TO DEEPEN OR PLUG BACK, GIVE DATA ON PRESENT PRODUCTIVE ZONE AND PROPOSED NEW PRODUCTIVE ZONE. GIVE BLOWOUT PREVENTER PROGRAM, IF ANY.

I hereby certify that the information above is true and complete to the best of my knowledge and belief.

Signed [Signature] Title Dist Drlg. Supt. Date 1/4/79

(This space for State Use)

APPROVED BY W.A. Grassett TITLE SUPERVISOR, DISTRICT II DATE JAN 8 1979

CONDITIONS OF APPROVAL, IF ANY:

**MEXICO OIL CONSERVATION COMMISSION
WELL LOCATION AND ACREAGE DEDICATION PLAT**

Form C-128
Supersedes C-128
Effective 1-1-65

All distances must be from the outer boundaries of the Section

Operator Atlantic Richfield Co.			Lease Empire Abo Unit		F	Well No. 375
Unit Letter E	Section 35	Township 17-S	Range 28-E	County Eddy		

Actual Well Location of Well:
1780 feet from the **North** line and **1175** feet from the **West** line

Ground Level Elev. 3681.2	Producing Formation Abo Reef	Pool Empire Abo	Dedicated Acreage: 40 Acres
-------------------------------------	--	---------------------------	---------------------------------------

1. Outline the acreage dedicated to the subject well by colored pencil or hachure marks on the plat below.
2. If more than one lease is dedicated to the well, outline each and identify the ownership thereof (both as to working interest and royalty).
3. If more than one lease of different ownership is dedicated to the well, have the interests of all owners been consolidated by communitization, unitization, force-pooling, etc?

☒ Yes ☐ No If answer is "yes," type of consolidation Unitization

If answer is "no," list the owners and tract descriptions which have actually been consolidated (attach to back of this form if necessary.) _____

No allowable will be assigned to the well until all interests have been consolidated (by communitization, unitization, forced-pooling, or otherwise) or until a non-standard unit, eliminating such interests, has been approved by the Commission.

RECEIVED

JAN 5 1979

**O. C. C.
ARTERIAL OFFICE**

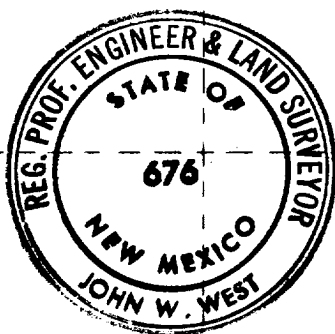
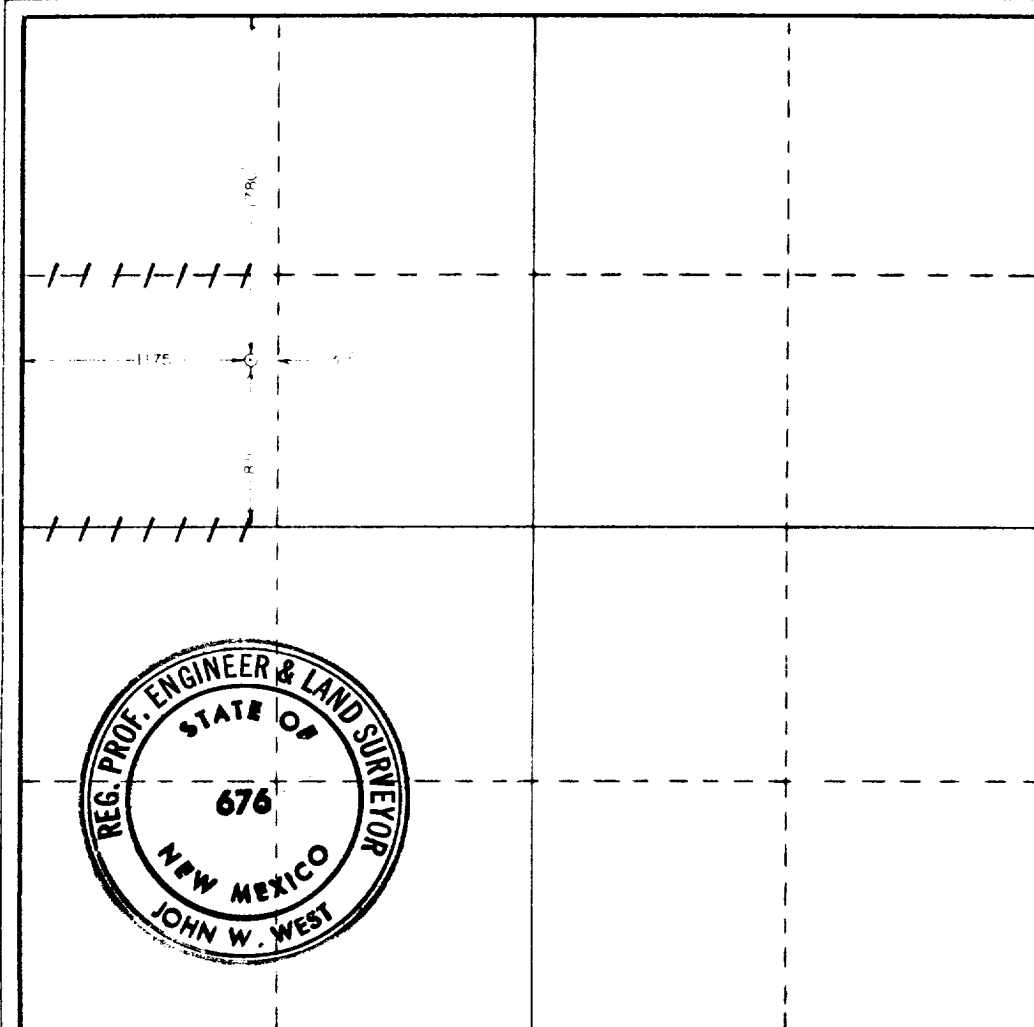

CERTIFICATION

I hereby certify that the information contained herein is true and complete to the best of my knowledge and belief.

Name

John W. West

Position

Dist. Dir. Supt.

Company

Atlantic Richfield Company

Date

1/4/79

I hereby certify that the well location shown on this plat was plotted from field notes of actual surveys made by me or under my supervision, and that the same is true and correct to the best of my knowledge and belief.

Date Surveyed

October 26, 1978

Registered Professional Engineer and/or Land Surveyor

John W. West

Certificate No. **John W. West 676**
Ronald J. Eidson 3239

0 330 660 990 1320 1650 1980 2310 2640 2970 3300 3630 3960 4290 4620 4950 5280 5610 5940 6270 6600 6930 7260 7590 7920 8250 8580 8910 9240 9570 9900 0

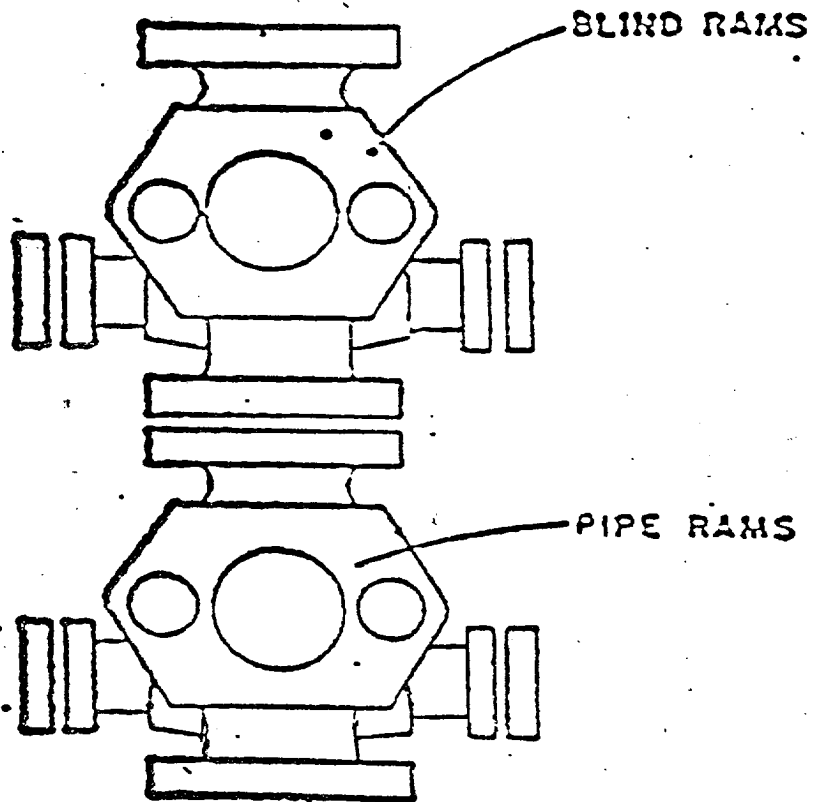

ATLANTIC RICHFIELD COMPANY
Blow Out Preventer Program

Lease Name Empire Abo Unit "F"

Well No. 375

Location 1780' FNL & 1175' F^WL
Sec 35-17S-28E, Eddy County

BOP to be tested before installed on well and will be maintained in good working condition during drilling. All wellhead fittings to be of sufficient pressure to operate in a safe manner.