

NO. OF COPIES RECEIVED	6
DISTRIBUTION	
SANTA FE	1
FILE	1
U.S.G.S.	2
LAND OFFICE	1
OPERATOR	1

NEW MEXICO OIL CONSERVATION COMMISSION

RECEIVED

JAN 10 1979

O. C. C.

30-015-22775

Form C-101
Revised 1-1-65

5A. Indicate Type of Lease	
STATE <input checked="" type="checkbox"/>	FEE <input type="checkbox"/>
5. State Oil & Gas Lease No.	
B-11593-8	
7. Unit Agreement Name	
Empire Abo Pressure Maintenance Project	
8. Farm or Lease Name	
Empire Abo Unit "E"	
9. Well No.	
374	
10. Field and Pool, or Wildcat	
Empire Abo	
12. County	
Eddy	
19. Proposed Depth	19A. Formation
6350'	Abo Reef
20. Rotary or C.T.	
Rotary	
21. Elevations (Show whether DP, RT, etc.)	21A. Kind & Status Plug. Bond
3680.7' GL	GCA #8
21B. Drilling Contractor	22. Approx. Date Work will start
Hondo Drlg. Co.	1/15/79

APPLICATION FOR PERMIT TO DRILL, DEEPEN, OR PLUG BACK

1a. Type of Work

DRILL ☒ DEEPEN ☐ PLUG BACK ☐

b. Type of Well
OIL WELL ☒ GAS WELL ☐ OTHER ☐ SINGLE ZONE ☐ MULTIPLE ZONE ☐

2. Name of Operator

Atlantic Richfield Company

3. Address of Operator

P. O. Box 1710, Hobbs, New Mexico 88240

4. Location of Well

UNIT LETTER D LOCATED 220 FEET FROM THE North LINE

AND 700 FEET FROM THE West LINE OF SEC. 35 TWP. 17S RGE. 28E NMPM

12. County

Eddy

19. Proposed Depth

6350'

19A. Formation

Abo Reef

20. Rotary or C.T.

Rotary

21. Elevations (Show whether DP, RT, etc.)

3680.7' GL

21A. Kind & Status Plug. Bond

GCA #8

21B. Drilling Contractor

Hondo Drlg. Co.

22. Approx. Date Work will start

1/15/79

23. PROPOSED CASING AND CEMENT PROGRAM

SIZE OF HOLE	SIZE OF CASING	WEIGHT PER FOOT	SETTING DEPTH	SACKS OF CEMENT	EST. TOP
11"	8-5/8" OD	24# K-55	750'	350	Circ to surf
7-7/8"	5-1/2" OD	15.5# K-55	6350'	1400	Circ to surf
					by 2-staging

Propose to drill a development well in the Empire Abo Pressure Maintenance Project to more economically recover remaining reserves.

Authority to drill above non-standard location by approval of Administrative Order NSL-999.

Blowout Preventer Program attached.

APPROVAL VALID
FOR 90 DAYS UNLESS
DRILLING COMMENCED,

EXPIRES 4-11-79

IN ABOVE SPACE DESCRIBE PROPOSED PROGRAM: IF PROPOSAL IS TO DEEPEN OR PLUG BACK, GIVE DATA ON PRESENT PRODUCTIVE ZONE AND PROPOSED NEW PRODUCTIVE ZONE. GIVE BLOWOUT PREVENTER PROGRAM, IF ANY.

I hereby certify that the information above is true and complete to the best of my knowledge and belief.

Signed J. Scott Kimbrough Title Dist. Drlg Supt. Date 1/8/79

APPROVED BY W.A. Gressett TITLE SUPERVISOR, DISTRICT II DATE JAN 11 1979

CONDITIONS OF APPROVAL, IF ANY:

**NEW MEXICO OIL CONSERVATION COMMISSION
WELL LOCATION AND ACREAGE DEDICATION PLAT**

Form C-102
Supersedes C-128
Effective 1-1-65

All distances must be from the outer boundaries of the Section.

Operator Atlantic Richfield Co.			Lease Empire Abo Unit		Well No. 374
Unit Letter D	Section 35	Township 17-S	Range 28-E	County Eddy	
Actual Footage Location of Well:					
220	feet from the North	line and	700	feet from the West	line
Ground Level Elev. 3680.7	Producing Formation Abo Reef		Pool Empire Abo	Dedicated Acreage: 40 Acres	

1. Outline the acreage dedicated to the subject well by colored pencil or hachure marks on the plat below.
2. If more than one lease is dedicated to the well, outline each and identify the ownership thereof (both as to working interest and royalty).
3. If more than one lease of different ownership is dedicated to the well, have the interests of all owners been consolidated by communitization, unitization, force-pooling, etc?

☒ Yes ☐ No If answer is "yes," type of consolidation Unitization

If answer is "no," list the owners and tract descriptions which have actually been consolidated. (Use reverse side of this form if necessary.) _____

No allowable will be assigned to the well until all interests have been consolidated (by communitization, unitization, forced-pooling, or otherwise) or until a non-standard unit, eliminating such interests, has been approved by the Commission.

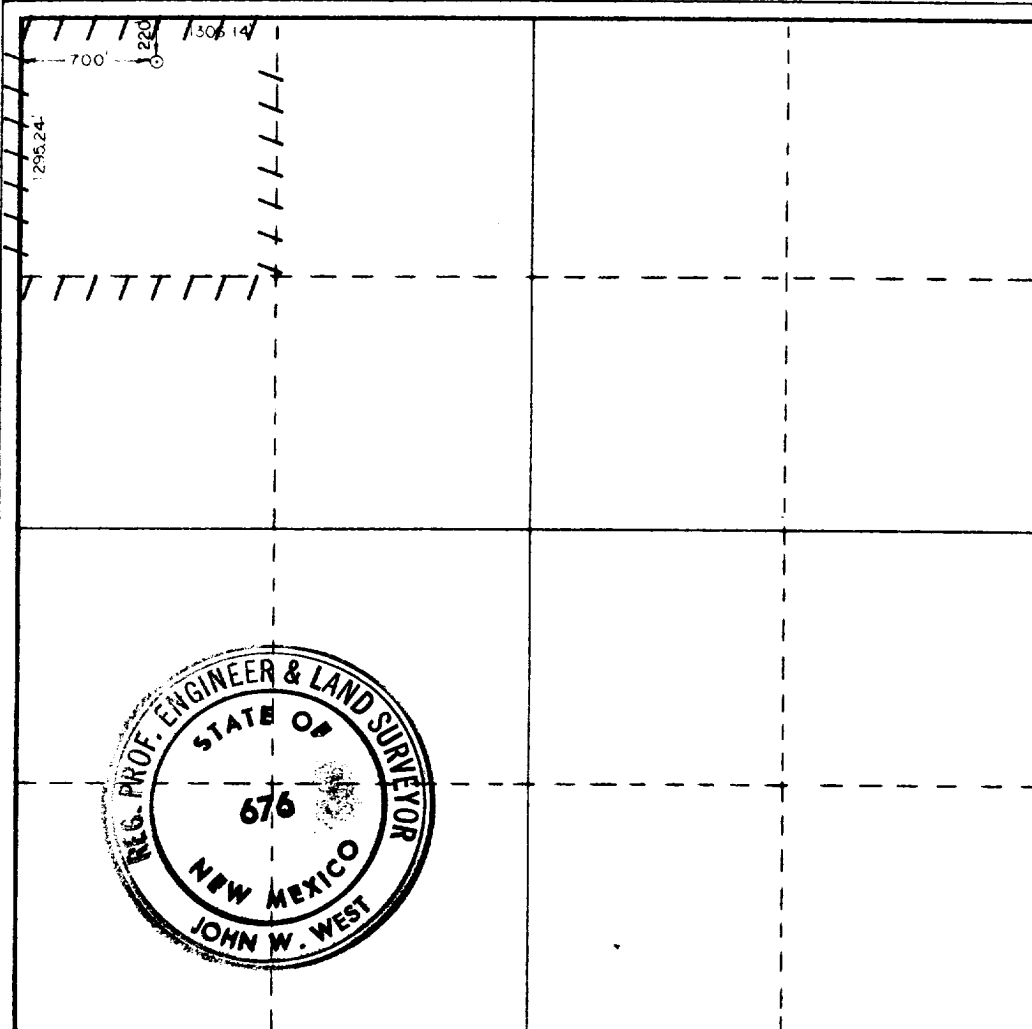

CERTIFICATION

I hereby certify that the information contained herein is true and complete to the best of my knowledge and belief.

Name J. Scott Kunkauf for L. Lane
Position _____

Dist. Dirg. Supt.

Company
Atlantic Richfield Company

Date
1/8/79

I hereby certify that the well location shown on this plat was plotted from field notes of actual surveys made by me or under my supervision, and that the same is true and correct to the best of my knowledge and belief.

Date Surveyed _____

Registered Professional Engineer and/or Land Surveyor

John W. West
Certificate No. **John W. West**

676
Ronald J. Eidson 3239

0 500 1000 1500 2000 2500 3000 3500 4000 4500 5000 5500 6000 6500 7000 7500 8000 8500 9000 9500 10000

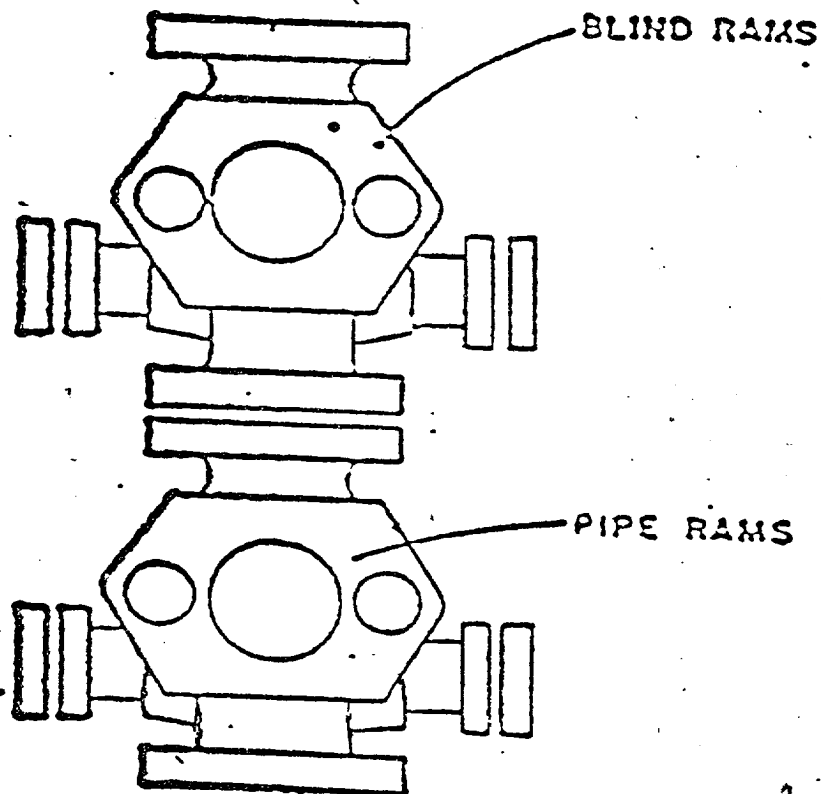

ATLANTIC RICHFIELD COMPANY
Blow Out Preventer Program

Lease Name Empire Abo Unit "E"

Well No. 374

Location 220' FNL & 700' FWL Sec 35-17S-28E
Eddy County, N.M.

BOP to be tested before installed on well and will be maintained in good working condition during drilling. All wellhead fittings to be of sufficient pressure to operate in a safe manner.