

| | |
|------------------------|---|
| NO. OF COPIES RECEIVED | 6 |
| DISTRIBUTION | |
| SANTA FE | 1 |
| FILE | 1 |
| U.S.G.S. | 2 |
| LAND OFFICE | 1 |
| OPERATOR | 1 |

N. MEXICO OIL CONSERVATION COMMISSION

30-015-22776
Form C-101
Revised 1-1-65

RECEIVED

JAN 10 1979

| | |
|---|------------------------------|
| 5A. Indicate Type of Lease | |
| STATE <input checked="" type="checkbox"/> | FEE <input type="checkbox"/> |
| 5. State Oil & Gas Lease No. | |
| 647-368 | 647-320 |

APPLICATION FOR PERMIT TO DRILL, DEEPEN, OR PLUG BACK

| | | | |
|---|-----------------------------------|--|---|
| 1a. Type of Work | | O.C.C. ARTESIA, OFFICE | |
| b. Type of Well | | DEEPEN <input type="checkbox"/> PLUG BACK <input type="checkbox"/> | |
| OIL WELL <input checked="" type="checkbox"/> | GAS WELL <input type="checkbox"/> | OTHER <input type="checkbox"/> | SINGLE ZONE <input type="checkbox"/> MULTIPLE ZONE <input type="checkbox"/> |
| 2. Name of Operator | | 9. Well No. | |
| Atlantic Richfield Company ✓ | | 382 | |
| 3. Address of Operator | | 10. Field and Pool, or Wildcat | |
| P. O. Box 1710, Hobbs, New Mexico 88240 | | Empire Abo | |
| 4. Location of Well | | 12. County | |
| UNIT LETTER <u>F</u> LOCATED <u>2400</u> FEET FROM THE <u>North</u> LINE | | Eddy | |
| AND <u>1600</u> FEET FROM THE <u>West</u> LINE OF SEC. <u>35</u> TWP. <u>17S</u> RGE. <u>28E</u> NMPM | | | |
| 19. Proposed Depth | | 19A. Formation | 20. Rotary or C.T. |
| 6300' | | Abo Reef | Rotary |
| 21. Elevations (Show whether DF, RT, etc.) | 21A. Kind & Status Plug. Bond | 21B. Drilling Contractor | 22. Approx. Date Work will start |
| 3675.6' GL | GCA #8 | Hondo Drlg. Co. | 1/15/79 |

PROPOSED CASING AND CEMENT PROGRAM

| SIZE OF HOLE | SIZE OF CASING | WEIGHT PER FOOT | SETTING DEPTH | SACKS OF CEMENT | EST. TOP |
|--------------|----------------|-----------------|---------------|-----------------|--------------|
| 11" | 8-5/8" OD | 24# K-55 | 750' | 350 | Circ to surf |
| 7-7/8" | 5-1/2" OD | 15.5# K-55 | 6300' | 1400 | Circ to surf |
| | | | | | by 2-staging |

Propose to drill a development well in the Empire Abo Pressure Maintenance Project to more economically recover remaining reserves.

Authority to drill above non-standard location by approval of Administrative Order NSL-999.

Blowout Preventer Program attached.

APPROVAL VALID
FOR 90 DAYS FROM
DRILLING COMMENCED,

EXPIRES 4-11-79

IN ABOVE SPACE DESCRIBE PROPOSED PROGRAM: IF PROPOSAL IS TO DEEPEN OR PLUG BACK, GIVE DATA ON PRESENT PRODUCTIVE ZONE AND PROPOSED NEW PRODUCTIVE ZONE. GIVE BLOWOUT PREVENTER PROGRAM, IF ANY.

I hereby certify that the information above is true and complete to the best of my knowledge and belief.

Signed J. Scott Kimbrough Title Dist. Drlg Supt. Date 1/8/79

(This space for State Use)
for C. Lane

APPROVED BY W. A. Gressett TITLE SUPERVISOR, DISTRICT II DATE JAN 11 1979

CONDITIONS OF APPROVAL, IF ANY:

N MEXICO OIL CONSERVATION COMMISS
WELL LOCATION AND ACREAGE DEDICATION PLAT

Form C-128
 Supersedes C-128
 Effective 1-1-65

All distances must be from the outer boundaries of the Section

| | | | | | | |
|--|--|-------------------------|---------------------------------|-----------------------|---------------------------------------|------------------------|
| Operator Atlantic Richfield Co. | | | Lease Empire Abo Unit | | F | Well No. 382 |
| Section Letter F | Section 35 | Township 17-S | Range 28-E | County Eddy | | |
| Actual Portage Location of Well: 2400 feet from the North line and 1600 feet from the West line | | | | | | |
| Ground Level Elev. 3675.6 | Producing Formation Abo Reef | | Pool Empire Abo | | Dedicated Acreage: 40 Acres | |

1. Outline the acreage dedicated to the subject well by colored pencil or hatchure marks on the plat below.
2. If more than one lease is dedicated to the well, outline each and identify the ownership thereof (both as to working interest and royalty).
3. If more than one lease of different ownership is dedicated to the well, have the interests of all owners been consolidated by communitization, unitization, force-pooling, etc?

☒ Yes ☐ No If answer is "yes," type of consolidation Unitization

If answer is "no," list the owners and tract descriptions which have actually been consolidated. (Use reverse side of this form if necessary.) _____

No allowable will be assigned to the well until all interests have been consolidated (by communitization, unitization, forced-pooling, or otherwise) or until a non-standard unit, eliminating such interests, has been approved by the Commission.

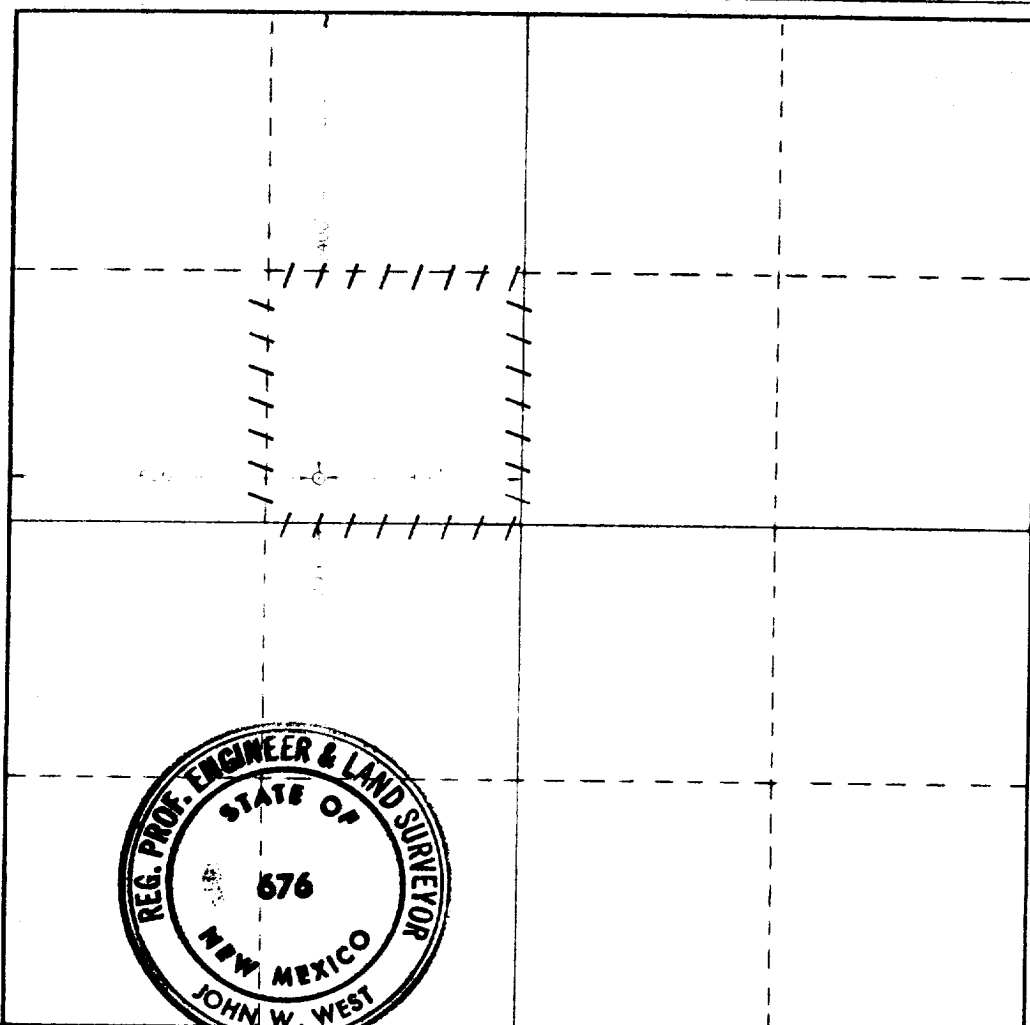

CERTIFICATION

I hereby certify that the information contained herein is true and complete to the best of my knowledge and belief.

Name John W. West
 Position Dist. Dir. Supt.

Company
Atlantic Richfield Company

Date
1/9/79

I hereby certify that the well location shown on this plat was plotted from field notes of actual surveys made by me or under my supervision, and that the same is true and correct to the best of my knowledge and belief.

Date Surveyed
October 26, 1978

Registered Professional Engineer and/or Land Surveyor

John W. West

Certificate No. John W. West **676**
Ronald J. Eidson **3239**

0 330 660 990 1320 1650 1980 2310 2640 2970 3300 3630 3960 4290 4620 4950 5280 5610 5940 6270 6600 6930 7260 7590 7920 8250 8580 8910 9240 9570 9900

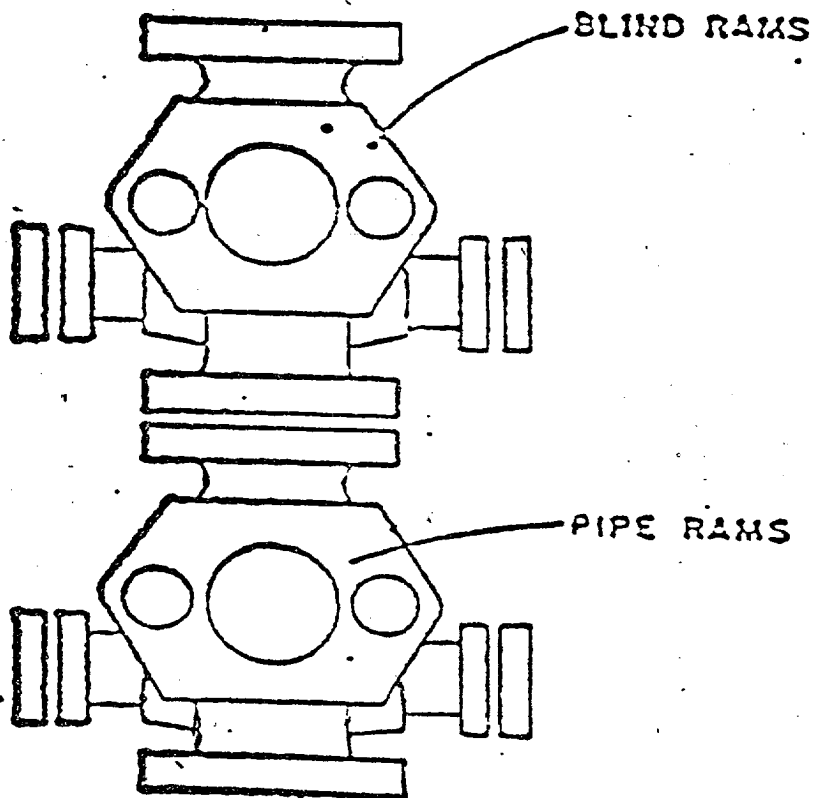

ATLANTIC RICHFIELD COMPANY
Blow Out Preventer Program

Lease Name Empire Abo Unit "F"

Well No. 382

Location 2400' FNL & 1600' FWL
Sec 35-17S-28E, Eddy County

BOP to be tested before installed on well and will be maintained in good working condition during drilling. All wellhead fittings to be of sufficient pressure to operate in a safe manner.