

NO. OF COPIES RECEIVED	6
DISTRIBUTION	
SANTA FE	1
FILE	1
U.S.G.S.	1
LAND OFFICE	1
OPERATOR	1

NEW MEXICO OIL CONSERVATION COMMISSION

30-015-22787

Form C-101
Revised 1-1-65

5A. Indicate Type of Lease	
STATE <input checked="" type="checkbox"/>	FEE <input type="checkbox"/>
5. State Oil & Gas Lease No.	
B-2071-24	

APPLICATION FOR PERMIT TO DRILL, DEEPEN, OR PLUG BACK

1a. Type of Work		7. Unit Agreement Name	
b. Type of Well		Empire Abo Pressure Maintenance Project	
DRILL <input checked="" type="checkbox"/>	DEEPEN <input type="checkbox"/>	8. Farm or Lease Name	
OIL WELL <input checked="" type="checkbox"/>	GAS WELL <input type="checkbox"/>	Empire Abo Unit "G"	
OTHER <input type="checkbox"/>		9. Well No.	
2. Name of Operator		334	
Atlantic Richfield Company		10. Field and Pool, or Wildcat	
3. Address of Operator		Empire Abo	
P. O. Box 1710, Hobbs, New Mexico 88240		12. County	
4. Location of Well		Eddy	
UNIT LETTER L LOCATED 2400 FEET FROM THE South LINE			
AND 500 FEET FROM THE West LINE OF SEC. 34 TWP. 17S RGE. 28E NMPM			
		19. Proposed Depth	
		6370'	
		19A. Formation	
		Abo Reef	
		20. Rotary or C.T.	
		Rotary	
21. Elevations (Show whether DF, RT, etc.)		21B. Drilling Contractor	
3661'4. GL		Hondo Drilling Company	
21A. Kind & Status Plug. Bond		22. Approx. Date Work will start	
GCA #8		1/30/79	

PROPOSED CASING AND CEMENT PROGRAM

SIZE OF HOLE	SIZE OF CASING	WEIGHT PER FOOT	SETTING DEPTH	SACKS OF CEMENT	EST. TOP
11"	8-5/8" OD	24# K-55	750'	350	Circ to surf
7-7/8"	5-1/2" OD	15.5# K-55	6370	1400	Circ to surf
					by 2-staging

Propose to drill a development well in the Empire Abo Pressure Maintenance Project to more economically recover remaining reserves.

Authority to drill above non-standard location by approval of Administrative Order NSL-999.

Blowout Preventer Program attached.

APPROVAL VALID
FOR 30 DAYS UNLESS
DRILL IS COMMENCED,
EXPIRES 4-15-79

IN ABOVE SPACE DESCRIBE PROPOSED PROGRAM: IF PROPOSAL IS TO DEEPEN OR PLUG BACK, GIVE DATA ON PRESENT PRODUCTIVE ZONE AND PROPOSED NEW PRODUCTIVE ZONE. GIVE BLOWOUT PREVENTER PROGRAM, IF ANY.

I hereby certify that the information above is true and complete to the best of my knowledge and belief.

Signed W. A. Gressett Title Dist. Dir. Supt. Date 1/8/79

(This space for State Use)

APPROVED BY W. A. Gressett TITLE SUPERVISOR, DISTRICT II DATE JAN 15 1979

CONDITIONS OF APPROVAL, IF ANY:

**MEXICO OIL CONSERVATION COMMISSION
WELL LOCATION AND ACREAGE DEDICATION PLAT**

Form C-102
Supersedes C-128
Effective 1-1-65

All distances must be from the outer boundaries of the Section

Operator Atlantic Richfield Co.			Lease Empire Abo Unit G		Well No. 334
Unit Letter L	Section 34	Township 17-S	Range 28-E	County Eddy	
Actual Footage Location of Well: 2400 feet from the South line and 500 feet from the West line					
Ground Level Elev. 3661.4	Producing Formation Abo Reef	Pool Empire Abo		Dedicated Acreage: 40 Acres	

1. Outline the acreage dedicated to the subject well by colored pencil or hatchure marks on the plat below.
2. If more than one lease is dedicated to the well, outline each and identify the ownership thereof (both as to working interest and royalty).
3. If more than one lease of different ownership is dedicated to the well, have the interests of all owners been consolidated by communitization, unitization, force-pooling, etc?

☒ Yes ☐ No If answer is "yes," type of consolidation Unitization

If answer is "no," list the owners and tract descriptions which have actually been consolidated. (Use reverse side of this form if necessary.) _____

No allowable will be assigned to the well until all interests have been consolidated (by communitization, unitization, forced-pooling, or otherwise) or until a non-standard unit, eliminating such interests, has been approved by the Commission.

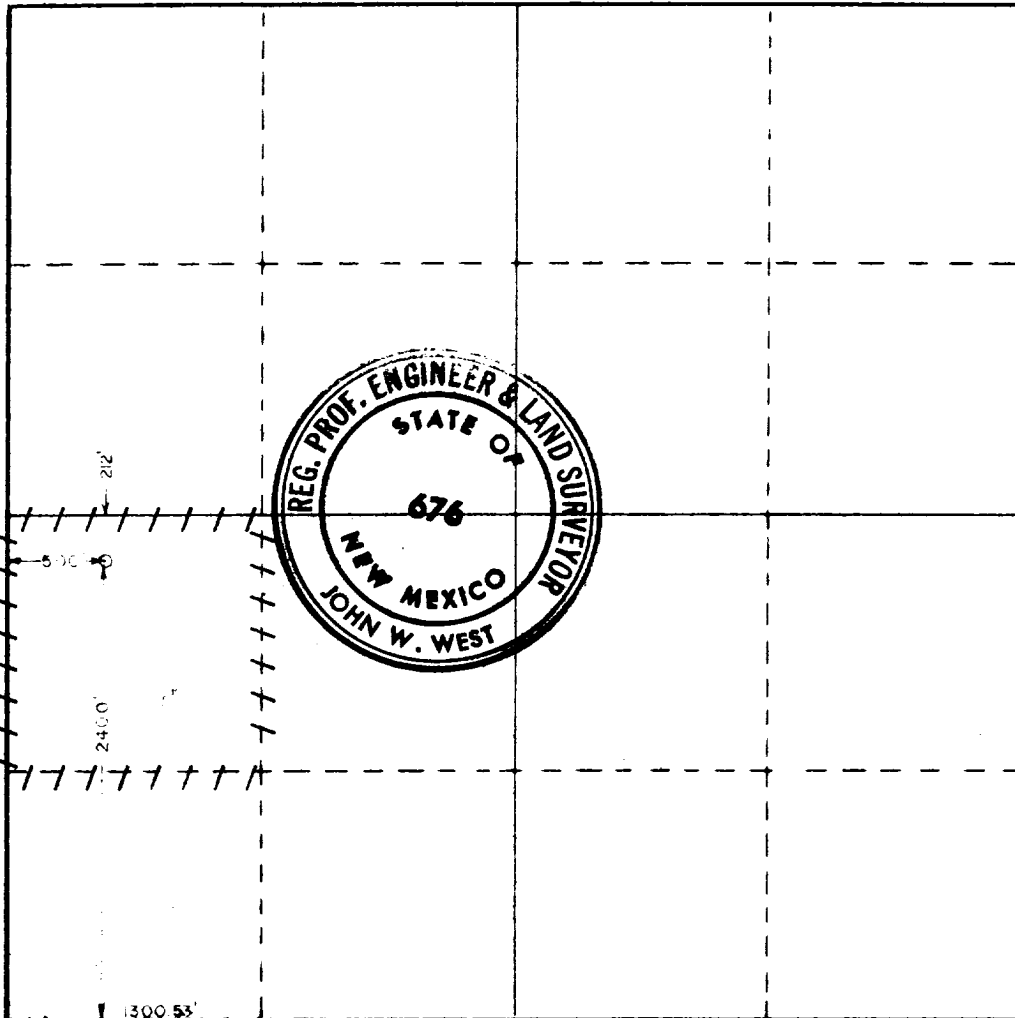

CERTIFICATION

I hereby certify that the information contained herein is true and complete to the best of my knowledge and belief

Name *John W. West*
 Position Dist. Drlg. Supt.
 Company Atlantic Richfield Company
 Date 1/9/79

I hereby certify that the well location shown on this plat was plotted from field notes of actual surveys made by me or under my supervision, and that the same is true and correct to the best of my knowledge and belief.

Date Surveyed
October 25, 1978

Registered Professional Engineer
and/or Land Surveyor

John W. West

Certificate No. **John W. West 676**
Ronald J. Eidson 3239



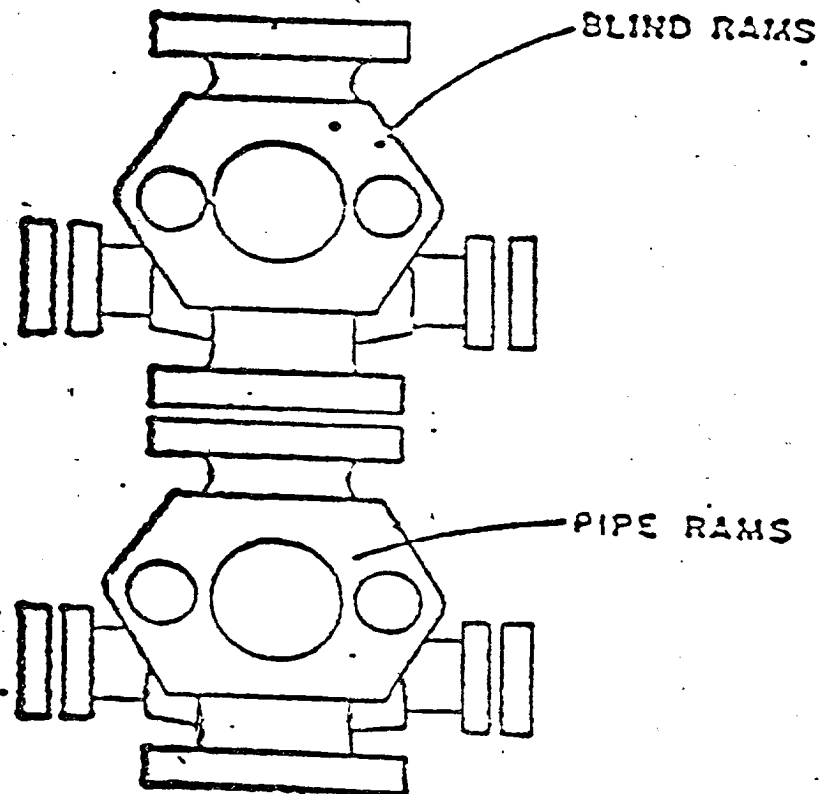

ATLANTIC RICHFIELD COMPANY
Blow Out Preventer Program

Lease Name Empire Abo Unit "G"

Well No. 334

Location 2400' FSL & 500' FWL
Sec 34-17S-28E, Eddy County

BOP to be tested before installed on well and will be maintained in good working condition during drilling. All wellhead fittings to be of sufficient pressure to operate in a safe manner.