

NO. OF COPIES RECEIVED	6
DISTRIBUTION	
SANTA FE	1
FILE	1
U.S.G.S.	2
LAND OFFICE	1
OPERATOR	1

MEXICO OIL DEVELOPMENT COMMISSION

FEB 6 1979

D. C. C.
ARTESIA, OFFICE

30-015-22820
Form C-101
Revised 1-1-65

5A. Indicate Type of Lease	
STATE <input checked="" type="checkbox"/>	FEE <input type="checkbox"/>
5. State Oil & Gas Lease No.	
B-2071-23	

APPLICATION FOR PERMIT TO DRILL, DEEPEN, OR PLUG BACK

1a. Type of Work		7. Unit Agreement Name	
DRILL <input checked="" type="checkbox"/> DEEPEN <input type="checkbox"/> PLUG BACK <input type="checkbox"/>		Empire Abo Pressure Maintenance Project	
b. Type of Well		8. Farm or Lease Name	
OIL WELL <input checked="" type="checkbox"/> GAS WELL <input type="checkbox"/> OTHER <input type="checkbox"/>		Empire Abo Unit "F"	
2. Name of Operator		9. Well No.	
Atlantic Richfield Company ✓		363	
3. Address of Operator		10. Field and Pool, or Wildcat	
P. O. Box 1710, Hobbs, New Mexico 88240		X Empire Abo	
4. Location of Well		12. County	
UNIT LETTER H LOCATED 2250 FEET FROM THE North LINE		Eddy	
AND 1250 FEET FROM THE East LINE OF SEC. 34 TWP. 17S RGE. 28E NMPM			
19. Proposed Depth		19A. Formation	
6350'		Abo Reef	
20. Rotary or C.T.		Rotary	
21. Elevations (Show whether DP, RT, etc.)		22. Approx. Date Work will start	
3663.3' GR		3/10/79	
21A. Kind & Status Plug. Bond		21B. Drilling Contractor	
GCA #8		Hondo Drlg. Co.	

23.

PROPOSED CASING AND CEMENT PROGRAM

SIZE OF HOLE	SIZE OF CASING	WEIGHT PER FOOT	SETTING DEPTH	SACKS OF CEMENT	EST. TOP
11"	8-5/8" OD	24# K-55	750	450	Circ to surf
7-7/8"	5-1/2" OD	15.5# K-55	6350'	1425	Circ to surf
					by 2-staging

Propose to drill a development well in the Empire Abo Pressure Maintenance Project to more economically recover remaining reserves.

Authority to drill above non-standard location by approval of Administrative Order NSL-999.

Blowout Preventer Program attached.

APPROVAL VALID
FOR 90 DAYS UNLESS
DRILLING COMMENCED,

EXPIRES 5-8-79

IN ABOVE SPACE DESCRIBE PROPOSED PROGRAM: IF PROPOSAL IS TO DEEPEN OR PLUG BACK, GIVE DATA ON PRESENT PRODUCTIVE ZONE AND PROPOSED NEW PRODUCTIVE ZONE. GIVE BLOWOUT PREVENTER PROGRAM, IF ANY.

I hereby certify that the information above is true and complete to the best of my knowledge and belief.

Signed W. A. Gressett Title Supervisor Dist. Drlg Supt. Date 2/2/79

(This space for State Use)

APPROVED BY W. A. Gressett TITLE SUPERVISOR, DISTRICT II DATE FEB 8 1979

CONDITIONS OF APPROVAL, IF ANY:

**MEXICO OIL CONSERVATION COMMISSION
WELL LOCATION AND ACREAGE DEDICATION PLAT**

Form C-102
Supersedes C-128
Effective 1-4-65

All distances must be from the outer boundaries of the Section

Operator Atlantic Richfield Co.		Lease Empire Abo Unit		Well No. 363	
Unit Letter H	Section 34	Township 17-S	Range 28-E	County Eddy	
Actual Footage Location of Well: 2250 feet from the North line and 1250 feet from the East line					
Ground Level Elev. 3663.3	Producing Formation Abo Reef		Pool Empire Abo		Dedicated Acreage: 40 Acres

1. Outline the acreage dedicated to the subject well by colored pencil or hatchure marks on the plat below.
2. If more than one lease is dedicated to the well, outline each and identify the ownership thereof (both as to working interest and royalty).
3. If more than one lease of different ownership is dedicated to the well, have the interests of all owners been consolidated by communitization, unitization, force-pooling, etc?

☒ Yes ☐ No If answer is "yes," type of consolidation Unitization

If answer is "no," list the owners and tract descriptions which have actually been consolidated. (Use reverse side of this form if necessary.) _____

No allowable will be assigned to the well until all interests have been consolidated (by communitization, unitization, forced-pooling, or otherwise) or until a non-standard unit, eliminating such interests, has been approved by the Commission.

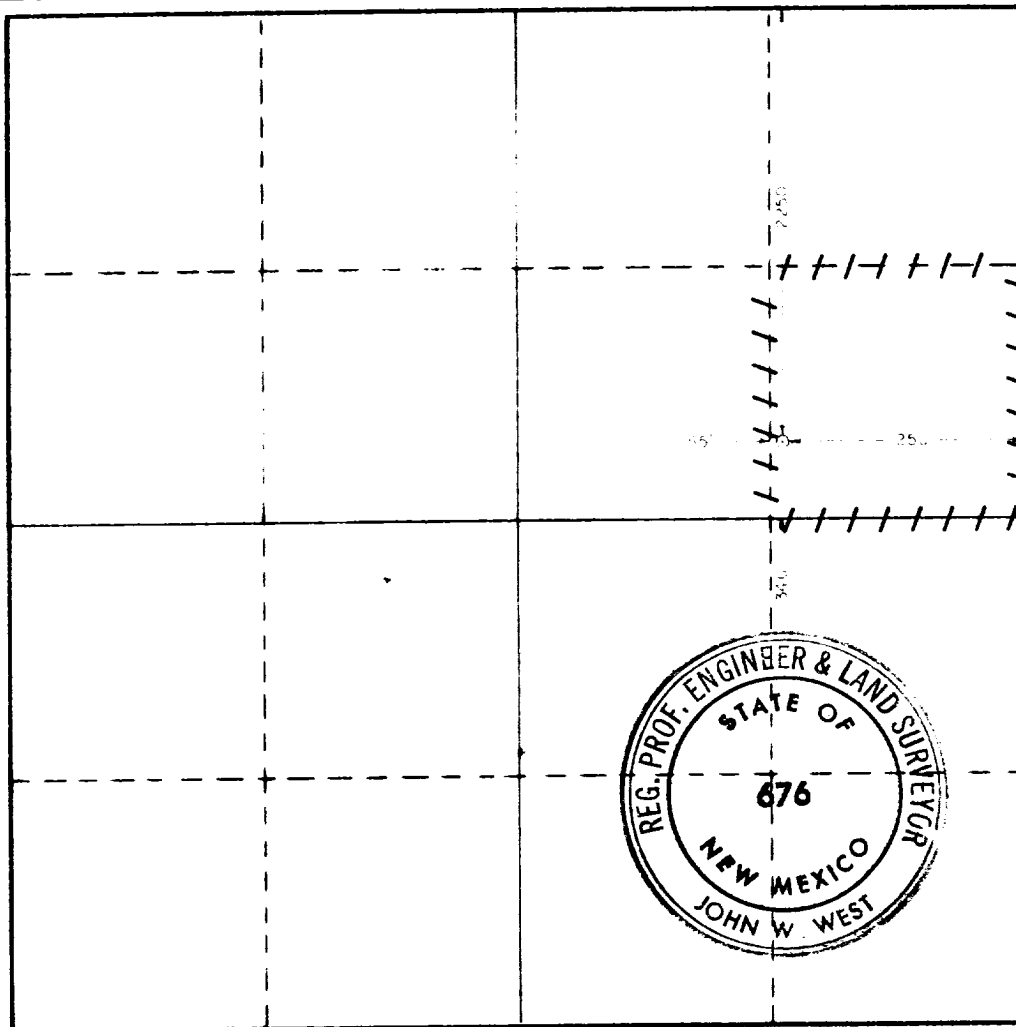

CERTIFICATION

I hereby certify that the information contained herein is true and complete to the best of my knowledge and belief.

Name *John W. West*
Position _____

Dist. Dir. Supt.

Company
Atlantic Richfield Company

Date
2/2/79

I hereby certify that the well location shown on this plat was plotted from field notes of actual surveys made by me or under my supervision, and that the same is true and correct to the best of my knowledge and belief.

Date Surveyed _____

Registered Professional Engineer and/or Land Surveyor

John W. West
Certificate No. **John W. West 676**

Ronald J. Eidson 3239



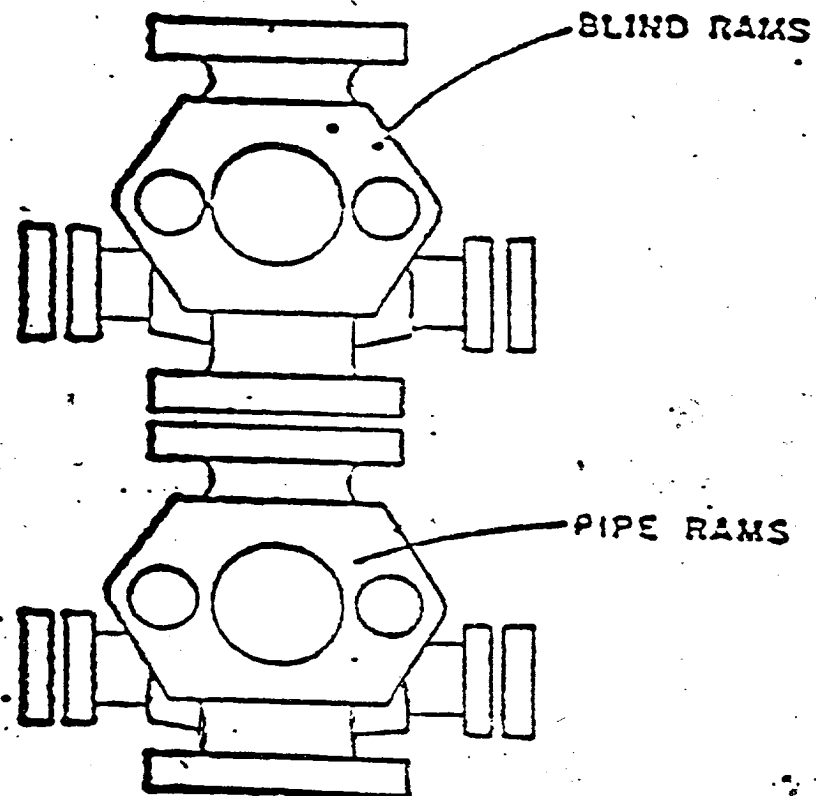

ATLANTIC RICHFIELD COMPANY
Blow Out Preventer Program

Lease Name Empire Abo Unit "F"

Well No. 363

Location 2250' FNL & 1250' FEL
Sec 34-17S-28E, Eddy County

BOP to be tested before installed on well and will be maintained in good working condition during drilling. All wellhead fittings to be of sufficient pressure to operate in a safe manner.