

NO. OF COPIES RECEIVED	6
DISTRIBUTION	
SANTA FE	1
FILE	1
U.S.G.S.	2
LAND OFFICE	1
OPERATOR	1

N. MEXICO OIL CONSERVATION COMMISSION

**RECEIVED**

FEB 6 1979

30-015-22822  
Form C-101  
Revised 1-1-65

5A. Indicate Type of Lease STATE <input checked="" type="checkbox"/> FEE <input type="checkbox"/>	
5. State Oil & Gas Lease No. 647-349 647-351	
7. Unit Agreement Name Empire Abo Pressure Maintenance Project	
8. Farm or Lease Name Empire Abo Unit "G"	
9. Well No. 324	
10. Field and Pool, or Wildcat Empire Abo	
12. County Eddy	
19. Proposed Depth 6370'	19A. Formation Abo Reef
20. Rotary or C.T. Rotary	
21. Elevations (Show whether DP, RT, etc.) 3662.3' GR	21A. Kind & Status Plug. Bond GCA #8
21B. Drilling Contractor Hondo Drlg. Co.	22. Approx. Date Work will start 3/1/79

APPLICATION FOR PERMIT TO DRILL, DEEPEN OR PLUG BACK

1a. Type of Work  
DRILL ☒ DEEPEN ☐ PLUG BACK ☐

b. Type of Well  
OIL WELL ☒ GAS WELL ☐ OTHER ☐ SINGLE ZONE ☐ MULTIPLE ZONE ☐

2. Name of Operator  
Atlantic Richfield Company ✓

3. Address of Operator  
P. O. Box 1710, Hobbs, New Mexico 88240

4. Location of Well  
UNIT LETTER I LOCATED 2250 FEET FROM THE South LINE  
AND 235 FEET FROM THE East LINE OF SEC. 33 TWP. 17S RGE. 28E NMPM

19. Proposed Depth  
6370'

19A. Formation  
Abo Reef

20. Rotary or C.T.  
Rotary

21. Elevations (Show whether DP, RT, etc.)  
3662.3' GR

21A. Kind & Status Plug. Bond  
GCA #8

21B. Drilling Contractor  
Hondo Drlg. Co.

22. Approx. Date Work will start  
3/1/79

23. PROPOSED CASING AND CEMENT PROGRAM					
SIZE OF HOLE	SIZE OF CASING	WEIGHT PER FOOT	SETTING DEPTH	SACKS OF CEMENT	EST. TOP
11"	8-5/8" OD	24# K-55	750'	450	Circ to surf
7-7/8"	5-1/2" OD	15.5# K-55	6370'	1425	Circ to surf
					by 2-staging

Propose to drill a development well in the Empire Abo Pressure Maintenance Project to more economically recover remaining reserves.

Authority to drill above non-standard location by approval of Administrative Order NSL-999. ✓

Blowout Preventer Program attached.

APPROVAL VALID  
FOR 90 DAYS UNLESS  
DRILLING COMMENCED,

EXPIRES 5-8-79

IN ABOVE SPACE DESCRIBE PROPOSED PROGRAM: IF PROPOSAL IS TO DEEPEN OR PLUG BACK, GIVE DATA ON PRESENT PRODUCTIVE ZONE AND PROPOSED NEW PRODUCTIVE ZONE. GIVE BLOWOUT PREVENTER PROGRAM, IF ANY.

I hereby certify that the information above is true and complete to the best of my knowledge and belief.

Signed W.A. Gressett Title Dist. Drlg Supt. Date 3/1/79

(This space for State Use)

APPROVED BY W.A. Gressett TITLE SUPERVISOR, DISTRICT II DATE FEB 8 1979

CONDITIONS OF APPROVAL, IF ANY:

**MEXICO OIL CONSERVATION COMMISSION  
WELL LOCATION AND ACREAGE DEDICATION PLAT**

Form C-102  
Supersedes C-128  
Effective 1-1-65

All distances must be from the outer boundaries of the Section

Land Owner <b>Atlantic Richfield Co.</b>			Lease <b>Empire Abo Unit</b>		Well No. <b>G 324</b>
Section <b>33</b>	Township <b>17-S</b>	Range <b>28-E</b>	County <b>Eddy</b>		
Actual Location of Well: <b>2250</b> feet from the <b>South</b> line and <b>235</b> feet from the <b>East</b> line					
Ground Level Elev. <b>3662.3</b>	Producing Formation <b>Abo Reef</b>	Pool <b>Empire Abo</b>	Dedicated Acreage: <b>40</b> Acres		

- 1 Outline the acreage dedicated to the subject well by colored pencil or hatchure marks on the plat below.
- 2 If more than one lease is dedicated to the well, outline each and identify the ownership thereof (both as to working interest and royalty).
- 3 If more than one lease of different ownership is dedicated to the well, have the interests of all owners been consolidated by communitization, unitization, force-pooling, etc?

☒ Yes    ☐ No    If answer is "yes," type of consolidation Unitization

If answer is "no," list the owners and tract descriptions which have actually been consolidated. (Use reverse side of this form if necessary.) \_\_\_\_\_

No allowable will be assigned to the well until all interests have been consolidated (by communitization, unitization, forced-pooling, or otherwise) or until a non-standard unit, eliminating such interests, has been approved by the Commission.

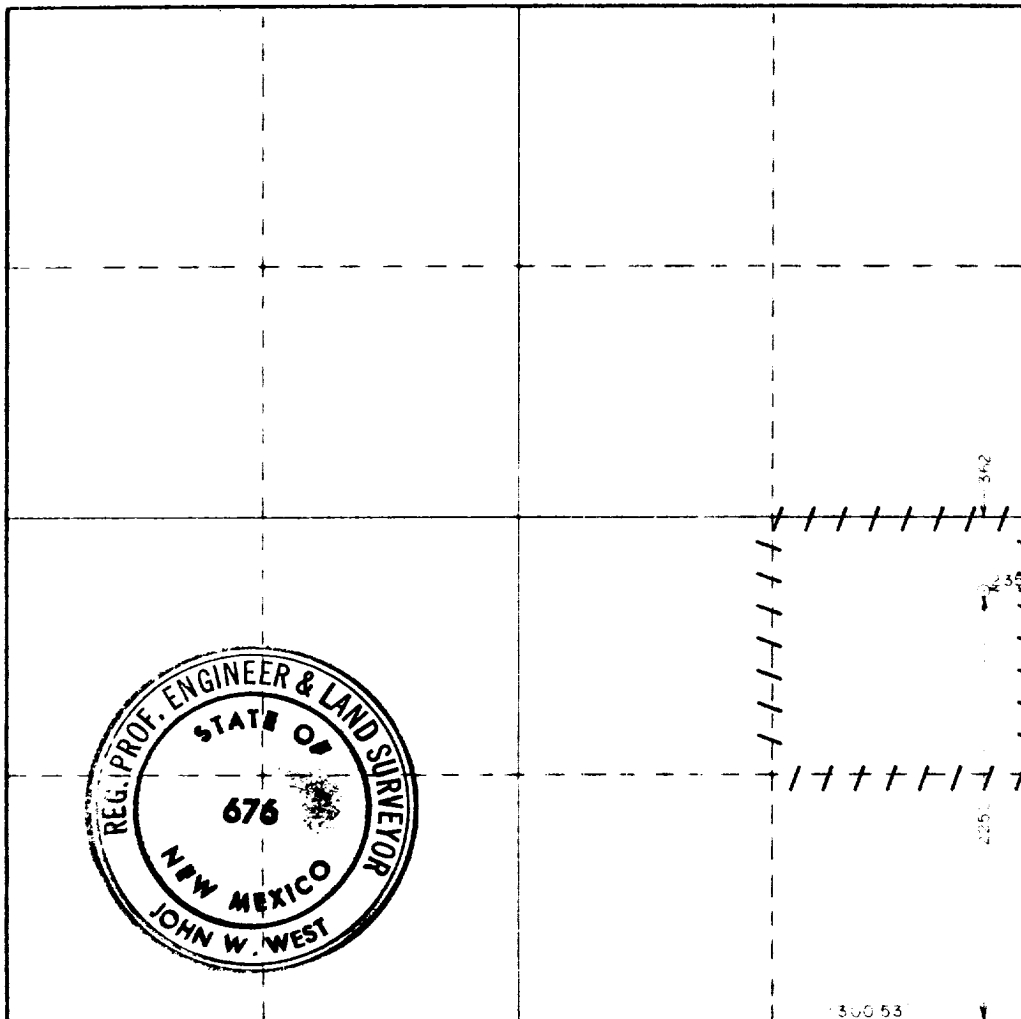

**CERTIFICATION**

I hereby certify that the information contained herein is true and complete to the best of my knowledge and belief.

Name *John W. West*  
 Position Dist. Dirg. Supt.  
 Company Atlantic Richfield Company  
 Date 2/2/79

I hereby certify that the well location shown on this plat was plotted from field notes of actual surveys made by me or under my supervision, and that the same is true and correct to the best of my knowledge and belief.

Date Surveyed October 25, 1978  
 Registered Professional Engineer and/or Land Surveyor

*John W. West*  
 Certificate No. John W. West 676  
Ronald J. Eidson 3239

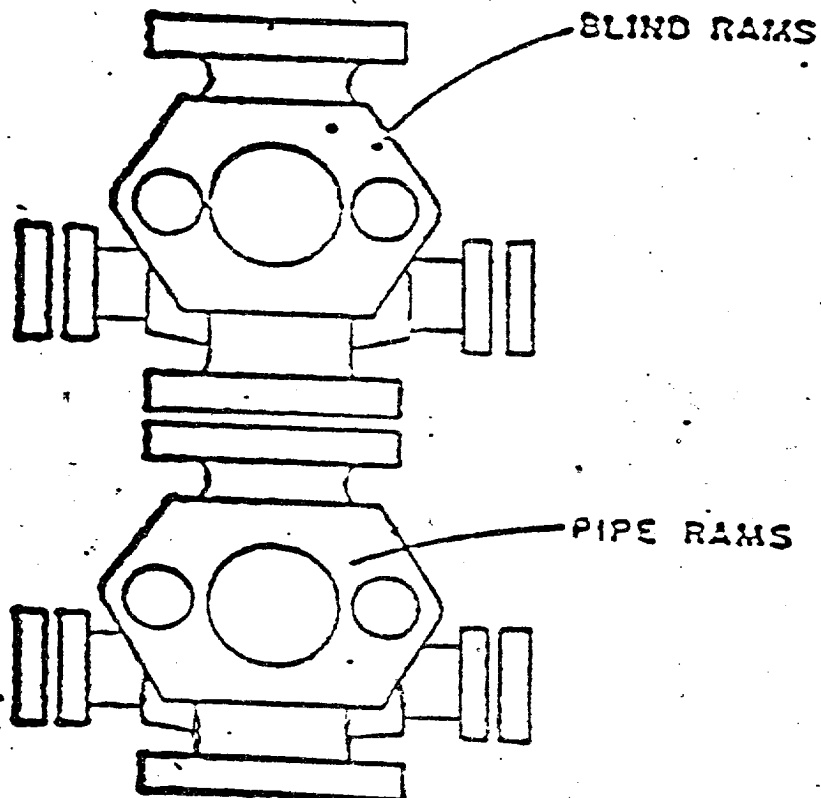

**ATLANTIC RICHFIELD COMPANY**  
**Blow Out Preventer Program**

**Lease Name** Empire Abo Unit "G"

**Well No.** 324

**Location** 2250' FSL & 235' FEL

Sec 33-17S-28E, Eddy County

BOP to be tested before installed on well and will be maintained in good working condition during drilling. All wellhead fittings to be of sufficient pressure to operate in a safe manner.