

## NEW MEXICO OIL CONSERVATION COMMISSION

Form C-101  
Revised 1-1-65

5A. Indicate Type of Lease

STATE ☒FEE ☐

5. State Oil &amp; Gas Lease No.

647-340, 647-351

## APPLICATION FOR PERMIT TO DRILL, DEEPEN, OR PLUG BACK

1a. Type of Work		7. Unit Agreement Name	
b. Type of Well DRILL <input checked="" type="checkbox"/> DEEPEN <input type="checkbox"/> PLUG BACK <input type="checkbox"/> OIL WELL <input checked="" type="checkbox"/> GAS WELL <input type="checkbox"/> OTHER <input type="checkbox"/> SINGLE ZONE <input checked="" type="checkbox"/> MULTIPLE ZONE <input type="checkbox"/>		Empire Abo Pressure Maintenance Project	
2. Name of Operator		8. Farm or Lease Name	
Atlantic Richfield Company ✓		Empire Abo Unit "G"	
3. Address of Operator		9. Well No.	
P. O. Box 1710, Hobbs, New Mexico 88240		314	
4. Location of Well UNIT LETTER <u>J</u> LOCATED <u>1450</u> FEET FROM THE <u>South</u> LINE AND <u>2000</u> FEET FROM THE <u>East</u> LINE OF SEC. <u>33</u> TWP. <u>17S</u> RGE. <u>28E</u> NMPM		10. Field and Pool, or Wildcat	
		Empire Abo	
		12. County	
		Eddy	
		19. Proposed Depth	
		6350'	
		19A. Formation	
		Abo Reef	
		20. Rotary or C.T.	
		Rotary	
21. Elevations (Show whether DF, RT, etc.)		21B. Drilling Contractor	
3661.7' GR		X-Pert Drilling Co.	
21A. Kind & Status Plug. Bond		22. Approx. Date Work will start	
GCA #8		3-23-79	

23.

## PROPOSED CASING AND CEMENT PROGRAM

SIZE OF HOLE	SIZE OF CASING	WEIGHT PER FOOT	SETTING DEPTH	SACKS OF CEMENT	EST. TOP
11"	8-5/8" OD	24# K-55	750'	425	Circ to surf
7-7/8"	5-1/2" OD	15.5# K-55	6350'	1425	Circ to surf

Propose to drill a development well in the Empire Abo Pressure Maintenance Project to more economically recover remaining reserves.

Authority to drill above non-standard location by approval of Administrative Order NSL-999.

Blowout Prevent Program attached.

APPROVAL VALID  
FOR 90 DAYS UNLESS  
DRILLING COMMENCED,

EXPIRES 5-26-79

IN ABOVE SPACE DESCRIBE PROPOSED PROGRAM; IF PROPOSAL IS TO DEEPEN OR PLUG BACK, GIVE DATA ON PRESENT PRODUCTIVE ZONE AND PROPOSED NEW PRODUCTIVE ZONE. GIVE BLOWOUT PREVENTER PROGRAM, IF ANY.

I hereby certify that the information above is true and complete to the best of my knowledge and belief.

Signed [Signature] Title Dist. Drlg. Supt. Date 2-20-79

(This space for State Use)

APPROVED BY [Signature] TITLE SUPERVISOR, DISTRICT II DATE FEB 26 1979

CONDITIONS OF APPROVAL, IF ANY:

MEXICO OIL CONSERVATION COMMISSION  
WELL LOCATION AND ACREAGE DEDICATION PLAT

Form C-102  
Supersedes C-128  
Effective 1-1-65

All distances must be from the outer boundaries of the Section

Owner <b>Atlantic Richfield Co.</b>			Lease <b>Empire Abo Unit</b>		<b>G</b>	Well No. <b>314</b>
Tract Letter <b>J</b>	Section <b>33</b>	Township <b>17-S</b>	Range <b>28-E</b>	County <b>Eddy</b>		
Actual Footage Location of Well: <b>1450</b> feet from the <b>South</b> line and <b>2000</b> feet from the <b>East</b> line						
Ground Level Elev <b>3661.7</b>	Producing Formation <b>Abo Reef</b>		Pool <b>Empire Abo</b>		Dedicated Acreage: <b>40</b> Acres	

1. Outline the acreage dedicated to the subject well by colored pencil or hachure marks on the plat below.
2. If more than one lease is dedicated to the well, outline each and identify the ownership thereof (both as to working interest and royalty).
3. If more than one lease of different ownership is dedicated to the well, have the interests of all owners been consolidated by communitization, unitization, force-pooling, etc?

☒ Yes ☐ No If answer is "yes," type of consolidation **Unitization**

If answer is "no," list the owners and tract descriptions which have actually been consolidated. (Use reverse side of this form if necessary.) \_\_\_\_\_

No allowable will be assigned to the well until all interests have been consolidated (by communitization, unitization, forced-pooling, or otherwise) or until a non-standard unit, eliminating such interests, has been approved by the Commission.

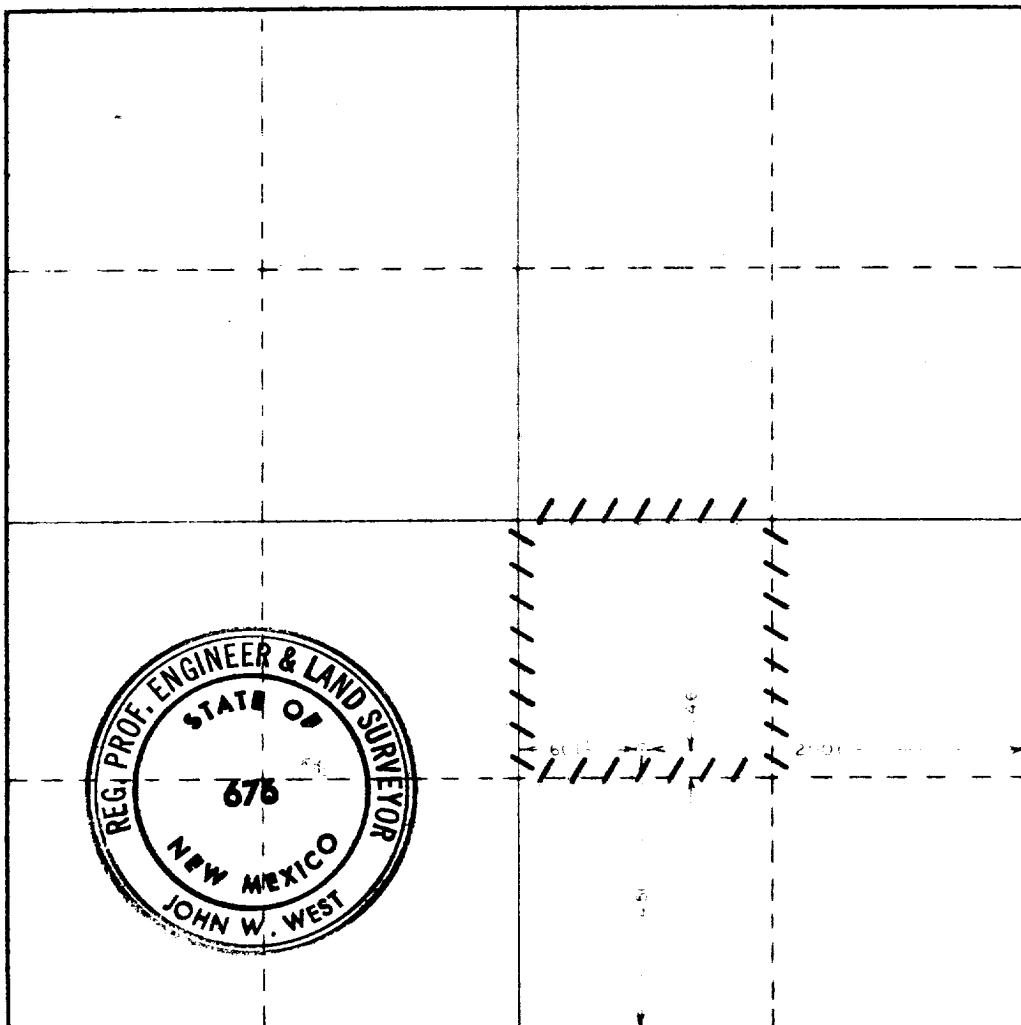

CERTIFICATION

I hereby certify that the information contained herein is true and complete to the best of my knowledge and belief.

*LeRoy Lane*

Name  
**LeRoy Lane**

Position  
**Dist. Drlg. Supt.**

Company  
**Atlantic Richfield Company**

Date  
**2-20-79**

I hereby certify that the well location shown on this plat was plotted from field notes of actual surveys made by me or under my supervision, and that the same is true and correct to the best of my knowledge and belief.

Date Surveyed  
**October 25, 1978**

Registered Professional Engineer  
and/or Land Surveyor

*John W. West*

Certificate No. **John W. West 676**  
**Ronald J. Eidson 3239**

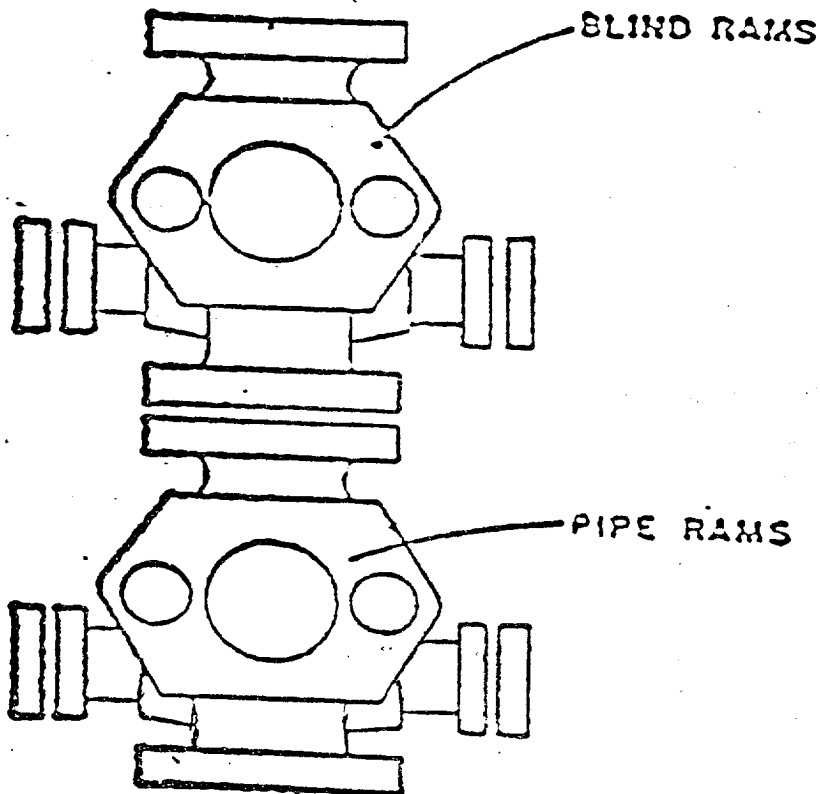

ATLANTIC RICHFIELD COMPANY  
Blow Out Preventer Program

Lease Name Empire Abo Unit "G"

Well No. 314

Location Unit Letter J, 1450 FSL & 2000 FEL,  
Section 33, T17S, R28E

BOP to be tested before installed on well and will be maintained in good working condition during drilling. All wellhead fittings to be of sufficient pressure to operate in a safe manner.