

NO. OF COPIES RECEIVED	6
DISTRIBUTION	
SANTA FE	1
FILE	1
U.S.G.S.	2
LAND OFFICE	1
OPERATOR	1

NEW MEXICO OIL CONSERVATION COMMISSION

FEB 22 1979

O. C. C.
ARTESIA, OFFICE

30-015-22846

Form C-101
Revised 1-1-65

5A. Indicate Type of Lease
STATE <input checked="" type="checkbox"/> FEE <input type="checkbox"/>
5. State Oil & Gas Lease No. 647-368, 647-320, 647-363

APPLICATION FOR PERMIT TO DRILL, DEEPEN, OR PLUG BACK

1a. Type of Work		7. Unit Agreement Name Empire Abo Pressure Maintenance Project	
b. Type of Well OIL WELL <input checked="" type="checkbox"/> GAS WELL <input type="checkbox"/> OTHER <input type="checkbox"/>		8. Farm or Lease Name Empire Abo Unit "G"	
2. Name of Operator Atlantic Richfield Company ✓		9. Well No. 352	
3. Address of Operator P. O. Box 1710, Hobbs, New Mexico 88240		10. Field and Pool, or Wildcat Empire Abo	
4. Location of Well UNIT LETTER J LOCATED 2200 FEET FROM THE South LINE AND 1450 FEET FROM THE East LINE OF SEC. 34 TWP. 17S RGE. 28E NMPM		12. County Eddy	
19. Proposed Depth 6350'		19A. Formation Abo Reef	
20. Rotary or C.T. Rotary		21. Elevations (Show whether DF, RT, etc.) 3662.2' GR	
21A. Kind & Status Plug. Bond GCA #8		21B. Drilling Contractor Hondo Drilling Company	
22. Approx. Date Work will start 3-30-79			

23.

PROPOSED CASING AND CEMENT PROGRAM

SIZE OF HOLE	SIZE OF CASING	WEIGHT PER FOOT	SETTING DEPTH	SACKS OF CEMENT	EST. TOP
11"	8-5/8" OD	24# K-55	750'	425	Circ to surf
7-7/8"	5-1/2" OD	15.5# K-55	6350'	1425	Circ to surf
					by 2 staging

Propose to drill a development well in the Empire Abo Pressure Maintenance Project to more economically recover remaining reserves.

Authority to drill above non-standard location by approval of Administrative Order NSL-999.

Blowout Prevent Program attached.

APPROVED AND
FOR 90 DAYS UNLESS
DRILLING COMMENCED,

EXPIRES 5-26-79

IN ABOVE SPACE DESCRIBE PROPOSED PROGRAM: IF PROPOSAL IS TO DEEPEN OR PLUG BACK, GIVE DATA ON PRESENT PRODUCTIVE ZONE AND PROPOSED NEW PRODUCTIVE ZONE. GIVE BLOWOUT PREVENTER PROGRAM, IF ANY.

I hereby certify that the information above is true and complete to the best of my knowledge and belief.

Signed [Signature] Title Dist. Drlg. Supt. Date 2-20-79

(This space for State Use)

APPROVED BY [Signature] TITLE SUPERVISOR, DISTRICT II DATE FEB 26 1979

CONDITIONS OF APPROVAL, IF ANY:

NEW MEXICO OIL CONSERVATION COMMISSION
WELL LOCATION AND ACREAGE DEDICATION PLAT

Form C-102
Supersedes C-128
Effective 1-1-65

All distances must be from the outer boundaries of the Section

Operator Atlantic Richfield Co.			Lease Empire Abo Unit		Well No. 352
Unit Letter J	Section 34	Township 17-S	Range 28-E	County Eddy	
Actual Entrance Location of Well: 2200 feet from the South line and 1450 feet from the East line					
Ground Level Elev. 3662.2	Producing Formation Abo Reef	Pool Empire Abo		Dedicated Acreage: 40 Acres	

1. Outline the acreage dedicated to the subject well by colored pencil or hachure marks on the plat below.
2. If more than one lease is dedicated to the well, outline each and identify the ownership thereof (both as to working interest and royalty).
3. If more than one lease of different ownership is dedicated to the well, have the interests of all owners been consolidated by communitization, unitization, force-pooling, etc?

☒ Yes ☐ No If answer is "yes," type of consolidation **Unitization**

If answer is "no," list the owners and tract descriptions which have actually been consolidated. (Use reverse side of this form if necessary.)

No allowable will be assigned to the well until all interests have been consolidated (by communitization, unitization, forced-pooling, or otherwise) or until a non-standard unit, eliminating such interests, has been approved by the Commission.

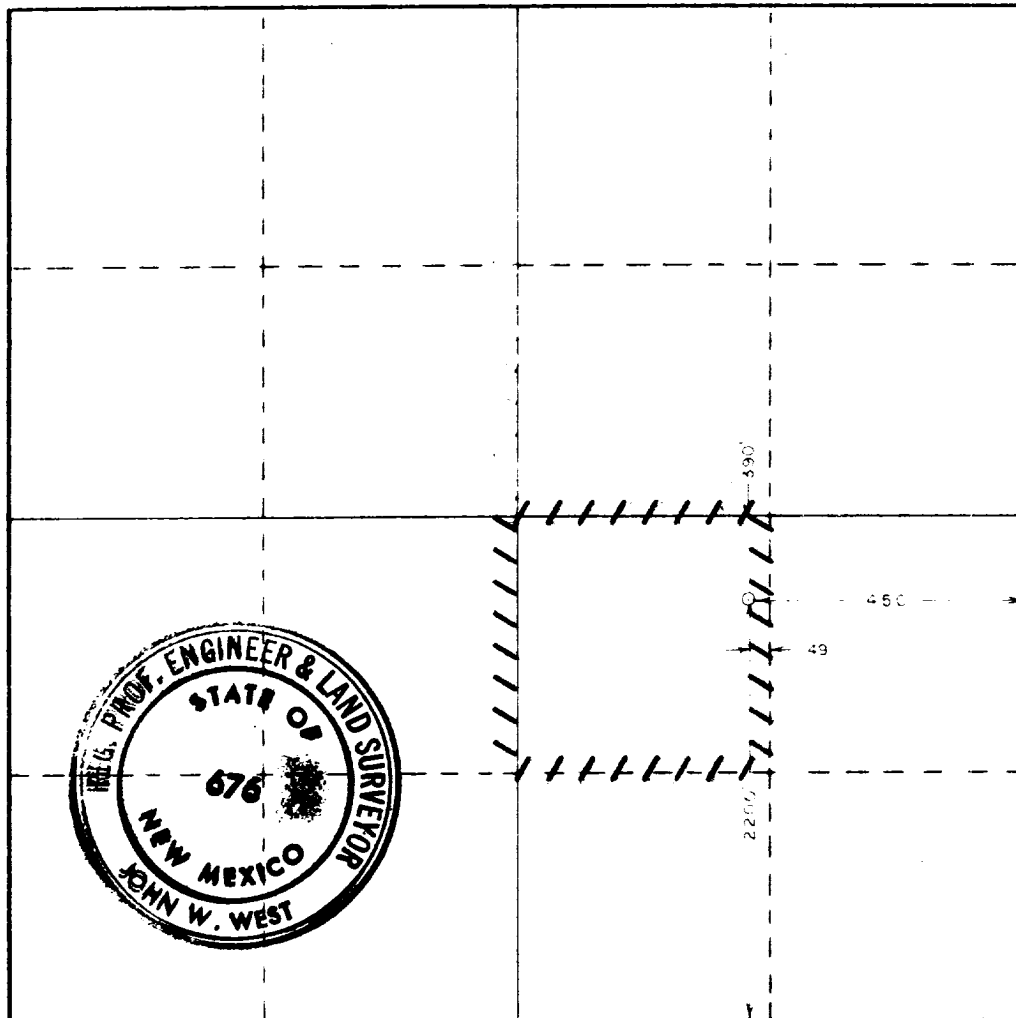

CERTIFICATION

I hereby certify that the information contained herein is true and complete to the best of my knowledge and belief.

[Signature]
Name

LeRoy Lane

Position

Dist. Brig. Supt.

Company

Atlantic Richfield Company

Date

2-28-79

I hereby certify that the well location shown on this plat was plotted from field notes of actual surveys made by me or under my supervision, and that the same is true and correct to the best of my knowledge and belief.

Date Surveyed

October 28, 1978

Registered Professional Engineer and/or Land Surveyor

[Signature]
Certificate No.

John W. West

676

Ronald J. Eidson

3239

0 800 1000 1600 2000 2640 2840 290 1320 1680 1980 2310

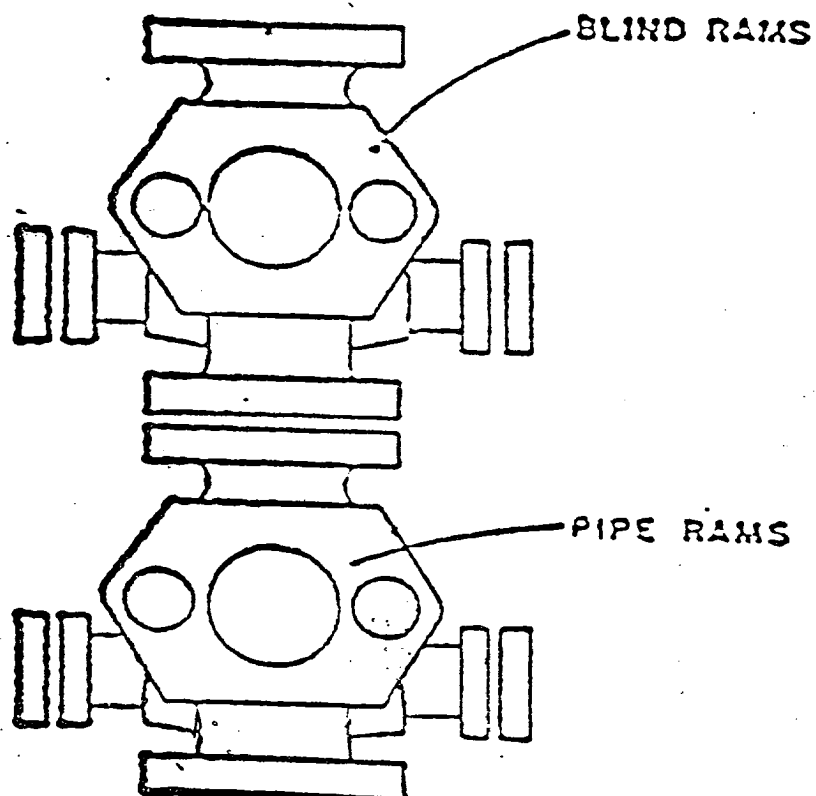

ATLANTIC RICHFIELD COMPANY
Blow Out Preventer Program

Lease Name Empire Abo Unit "G"

Well No. 352

Location Unit Letter J, 2200 FSL & 1450 FEL,
Section 34, T17S, R28E

BOP to be tested before installed on well and will be maintained in good working condition during drilling. All wellhead fittings to be of sufficient pressure to operate in a safe manner.