

NO. OF COPIES RECEIVED	6
DISTRIBUTION	
ANTA FE	1
FILE	1 ✓
U.S.G.S.	2
LAND OFFICE	1
OPERATOR	1

NEW MEXICO OIL CONSERVATION COMMISSION

OCT 12 1979

O. C. C.
ARTESIA, OFFICE

30-015-23028
Form C-101
Revised 1-1-65

5A. Indicate Type of Lease STATE <input checked="" type="checkbox"/> FEE <input type="checkbox"/>
5. State Oil & Gas Lease No. B-1969
7. Unit Agreement Name
8. Farm or Lease Name Camille
9. Well No. 1
10. Field and Pool, or Wildcat East Empire Yates 7-R
12. County Eddy
19. Proposed Depth 800'
19A. Formation Seven Rivers
20. Rotary or C.T. Rotary
21. Elevations (Show whether DF, RT, etc.) 3578.2 Gr.
21A. Kind & Status Plug. Bond Statewide
21B. Drilling Contractor Artesia Fishing Tool
22. Approx. Date Work will start 10-14-79

APPLICATION FOR PERMIT TO DRILL, DEEPEN, OR PLUG BACK					
1a. Type of Work b. Type of Well DRILL <input checked="" type="checkbox"/> DEEPEN <input type="checkbox"/> PLUG BACK <input type="checkbox"/> OIL WELL <input checked="" type="checkbox"/> GAS WELL <input type="checkbox"/> OTHER <input type="checkbox"/> SINGLE ZONE <input checked="" type="checkbox"/> MULTIPLE ZONE <input type="checkbox"/>					
2. Name of Operator JFG ENTERPRISES ✓					
3. Address of Operator Box 100, Artesia, New Mexico 88210					
4. Location of Well UNIT LETTER I LOCATED 1650 FEET FROM THE South LINE AND 330 FEET FROM THE East LINE OF SEC. 22 TWP. 17S RGE. 28E NMPM					
23.					

PROPOSED CASING AND CEMENT PROGRAM

SIZE OF HOLE	SIZE OF CASING	WEIGHT PER FOOT	SETTING DEPTH	SACKS OF CEMENT	EST. TOP
7 7/8"	5 1/2"	14#	800'	250 Sxs.	Surface

Plan to drill Seven Rivers Well using 7 7/8" bit to T.D. approximately at 800', using mud pump with mud and water.

Plan to run 800' of 5 1/2" 14# casing and circulate with 250 Sxs. class "C" cement to surface.

APPROVAL VALID
FOR 90 DAYS UNLESS
DRILLING COMMENCED,
EXPIRES 1-15-80

IN ABOVE SPACE DESCRIBE PROPOSED PROGRAM: IF PROPOSAL IS TO DEEPEN OR PLUG BACK, GIVE DATA ON PRESENT PRODUCTIVE ZONE AND PROPOSED NEW PRODUCTIVE ZONE. GIVE BLOWOUT PREVENTER PROGRAM, IF ANY.

I hereby certify that the information above is true and complete to the best of my knowledge and belief.

Signed L. J. Fletcher Title Agent Date 10-11-79

(This space for State Use)

APPROVED BY W. A. Gussitt TITLE SUPERVISOR, DISTRICT II DATE OCT 15 1979

CONDITIONS OF APPROVAL, IF ANY:

Cement must be cemented to surface behind 5 1/2"

Notify N.M.O.C.C. in sufficient time to witness cementing the 5 1/2" casing

All distances must be from the outer boundaries of the Section.

Operator JFG ENTERPRISES		Lease Camille		Well No. 1	
Section 22	Township 17 S.	Range 25 E.	County Eddy		
Acres of the location of well: 1650 feet from the SOUTH line and 330 feet from the East line					
Ground Level Elev 3575.2	Producing Formation Seven Rivers	Pool Und. East Empire Yates - 7R		Dedicated Acreage Acres	

1. Outline the acreage dedicated to the subject well by colored pencil or hatchure marks on the plat below.

2. If more than one lease is dedicated to the well, outline each and identify the ownership thereof (both as to working interest and royalty).

3. If more than one lease of different ownership is dedicated to the well, have the interests of all owners been consolidated by communitization, unitization, force-pooling, etc?

☐ Yes ☐ No If answer is "yes," type of consolidation _____

If answer is "no," list the owners and tract descriptions which have actually been consolidated. (Use reverse side of this form if necessary.) _____

No allowable will be assigned to the well until all interests have been consolidated (by communitization, unitization, forced-pooling, or otherwise) or until a non-standard unit, eliminating such interests, has been approved by the Commission.

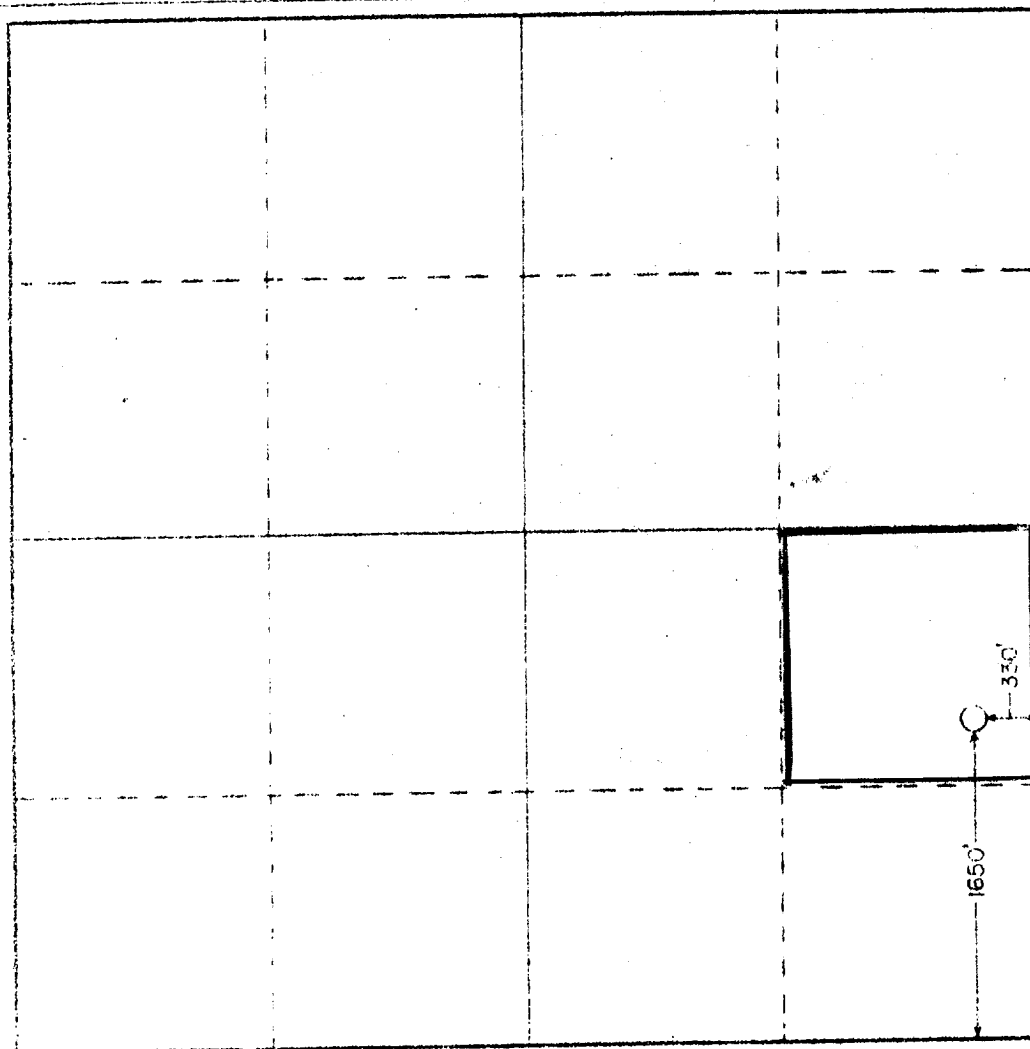
RECEIVED**OCT 12 1979****O.C.O.
ARTESIA, OFFICE**

CERTIFICATION.

I hereby certify that the information contained herein is true and complete to the best of my knowledge and belief.

X. J. Fletcher

Name

Agent

Position

JFG ENTERPRISES

Company

Box 100, Artesia, N.M. 88

Date

10-11-79

I hereby certify that the well location shown on this plat was plotted from field notes of actual surveys made by me or under my supervision, and that the same is true and correct to the best of my knowledge and belief.

Date Survey

Oct 10

Registered in the State of New Mexico and/or Land Surveyor

3640

Certificate No.

3640