

UNITED STATES
DEPARTMENT OF THE INTERIOR
GEOLOGICAL SURVEY

APPLICATION FOR PERMIT TO DRILL, DEEPEN, OR PLUG BACK

1a. TYPE OF WORK

DRILL ☒DEEPEN ☐PLUG BACK ☐

b. TYPE OF WELL

OIL
WELL ☒GAS
WELL ☐OTHER ☐SINGLE
ZONE ☐MULTIPLE
ZONE ☐

2. NAME OF OPERATOR

Collier & Collier

O. C. C.
ARTESIA, OFFICE

3. ADDRESS OF OPERATOR

P.O. Box 798, Artesia, New Mexico

4. LOCATION OF WELL (Report location clearly and in accordance with any State requirements.)*

At surface

660' FNL & 660' FEL

At proposed prod. zone

Slaughter

14. DISTANCE IN MILES AND DIRECTION FROM NEAREST TOWN OR POST

Approx. 1 1/2 miles south of Rivers

15. DISTANCE FROM PROPOSED*

LOCATION TO NEAREST
PROPERTY OR LEASE LINE, FT.
(Also to nearest drig. unit line, if any)18. DISTANCE FROM PROPOSED LOCATION*
TO NEAREST WELL, DRILLING, COMPLETED,
OR APPLIED FOR, ON THIS LEASE, FT.

16. NO. OF ACRES IN LEASE

40

19. PROPOSED DEPTH

1800'

17. NO. OF ACRES ASSIGNED
TO THIS WELL

40

20. ROTARY OR CABLE TOOLS

Cable Tool.

21. ELEVATIONS (Show whether DF, RT, GR, etc.)

3359.2 GL

22. APPROX. DATE WORK WILL START*

October 28, 1979

23.

PROPOSED CASING AND CEMENTING PROGRAM

SIZE OF HOLE	SIZE OF CASING	WEIGHT PER FOOT	SETTING DEPTH	QUANTITY OF CEMENT
** 12 1/2"	10 3/4"	40#	150'	Pipe will be pulled.
10"	7" API	20#	1400'	860 Sxs. Class C - 2% CaCl
6 3/4"	4 1/2"	11#	1800'	100 Sxs. Class C - 2% CaCl

Plan to test the San Andres formation. 7" casing will be set through the Artesian Zone. Cement will be circulated to surface. Will drill out of the 7" with 6 3/4" bit and test the Slaughter Zone at approximately 1735'. If sufficient shows are encountered will run 4 1/2" casing and set with 100 Sxs. of Class C cement, log, perforate and complete.

** No known usable surface water in three (3) mile radius. 10 3/4" will be run only if required for drilling operations' expediency.

IN ABOVE SPACE DESCRIBE PROPOSED PROGRAM: If proposal is to deepen or plug back, give data on present productive zone and proposed new productive zone. If proposal is to drill or deepen directionally, give pertinent data on subsurface locations and measured and true vertical depths. Give blowout preventer program, if any.

24.

SIGNED

Timothy D. Collier

TITLE

Partner

DATE October 25, 1979

(This space for Federal or State office use)

PERMIT NO.

APPROVAL DATE

10-31-79

APPROVED BY

TITLE

DATE

CONDITIONS OF APPROVAL, IF ANY:

*See Instructions On Reverse Side

N. MEXICO OIL CONSERVATION COMMISS.
WELL LOCATION AND ACREAGE DEDICATION PLAT

Form C-102
Supersedes C-128
Effective 1-1-65

All distances must be from the outer boundaries of the Section.

Operator COLLIER & COLLIER			Lease Hagen Federal		Well No. #1
Unit Letter A	Section 19	Township 17 South	Range 27 East	County Eddy	
Actual Footage Location of Well: 660 feet from the North line and 660 feet from the East line					
Ground Level Elev. 3359.2	Producing Formation San Andres-Slaughter		Pool Logan Draw	Dedicated Acreage: 40 Acres	

1. Outline the acreage dedicated to the subject well by color and perimeter marks on the plat below.
2. If more than one lease is dedicated to the well, outline each and identify the ownership thereof (both as to working interest and royalty).
3. If more than one lease of different ownership is dedicated to the well, have the interests of all owners been consolidated by communitization, unitization, force-pooling, etc.

☐ Yes ☐ No If answer is "yes," type of consolidation _____

If answer is "no," list the owners and tract descriptions which have actually been consolidated. (Use reverse side of this form if necessary.) _____

No allowable will be assigned to the well until all interests have been consolidated (by communitization, unitization, forced-pooling, or otherwise) or until a non-standard unit, eliminating such interests, has been approved by the Commission.

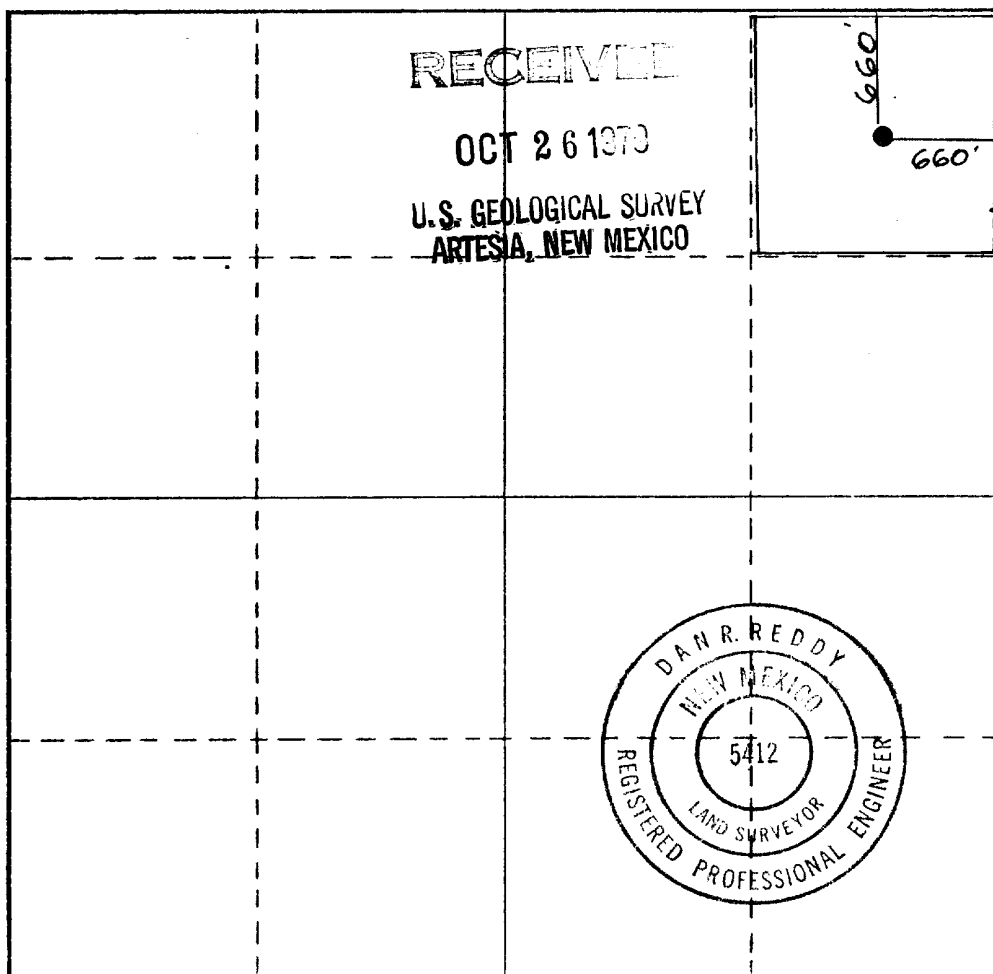

CERTIFICATION

I hereby certify that the information contained herein is true and complete to the best of my knowledge and belief.

Timothy D. Collier
Name

Timothy D. Collier

Position

Partner

Company

Collier & Collier

Date

October 25, 1979

I hereby certify that the well location shown on this plat was plotted from field notes of actual surveys made by me or under my supervision, and that the same is true and correct to the best of my knowledge and belief.

Date Surveyed

October 12, 1979

Registered Professional Engineer and/or Land Surveyor

Dan R. Reddy
Certificate No.

NM PE&LS #5412



N.M.O.C.D. COPY

United States Department of the Interior

GEOLOGICAL SURVEY

P. O. Drawer U
Artesia, New Mexico 88210

RECEIVED

NOV 5 1979

O. C. C.
ARTESIA, OFFICE

OCT 31 1979

Collier & Collier
P. O. Box 798
Artesia, New Mexico 88210

Gentlemen:

COLLIER & COLLIER
Hagen Federal No. 1
660 FNL 660 FEL Sec. 19 T.17S R.27E
Eddy County Lease No. NM 15867

Above Data Required on Well Sign

Your APPLICATION FOR PERMIT TO DRILL the above-described well to a depth of 1,800 feet to test the San Andres formation is hereby approved subject to compliance with the OIL AND GAS OPERATING REGULATIONS (30 CFR 221) and the following conditions:

1. Drilling operations authorized are subject to compliance with the GENERAL REQUIREMENTS FOR OIL AND GAS OPERATIONS ON FEDERAL LEASES, dated July 1, 1978.
2. Prior to commencing construction of road, pad, or other associated developments, operator will provide the dirt contractor with a copy of the SURFACE USE PLAN and this approval including the GENERAL REQUIREMENTS.
3. Submit a Daily Report of Operations from spud date until the Well Completion Report (form 9-330) is filed. The progress report should be not less than 8" x 5" in size and each page should identify the well.
4. All permanent above-ground structures and equipment shall be painted in accordance with the attached Painting Requirements. The color used should simulate Sandstone Brown (Federal Standard No. 595A, color 20318 or 30318).
5. Cement behind the 10-3/4" and 7" casing must be circulated.
6. Notify Survey in sufficient time to witness the cementing of 7" casing.
7. Please have anyone contacting the Survey in regard to this well to identify the well with all of the information required above for the well sign.

Sincerely yours,

GEORGE H. STEWART

George H. Stewart
Acting District Engineer



Collier & Collier ☆☆☆

DAVID C.

TIMOTHY D.

Independent Oil Producers

PHONE 505-746-6520

BOX 798

ARTESIA, NEW MEXICO 88210

SUPPLEMENT

Hagen Fed. #1 Lease No. NM#15867
660' FNL & 660' FEL
N.M.P.M.
Eddy County, New Mexico

This form is provided as a supplement to U.S.G.S. Form 9-331C, "Application to Drill". The following additional information is submitted:

1. See Form 9-331C.
2. See Form 9-331C.
3. The geologic name of surface formation: Permian Yates.
4. Cable Tool.
5. See Form 9-331C.
6. The estimated tops of important geologic markers are:
Seven Rivers 200', Queen 535', San Andres 1228'
7. Estimated depths at which water, oil, gas and other miners bearing formations are expected to be encountered are:

Seven Rivers	-	+	200'	Water
Queen	-	+	535'	Water
San Andres	-	+	1228'	Oil & Gas
Slaughter	-	+	1726'	Oil (Objective)
8. The proposed casing program including size, grade and weight per foot at each string has been indicated on form 9-331C. All strings will be J-55 new or grade #1 used.
9. See Form 9-331C for cement. 10 3/4" surface pipe will not be cemented nor do we anticipate running same unless casing problems exist during drilling operations. 7" casing will be set through the Artesian Zone and circulated back to the surface.
10. Pressure control head for cable tool drilling operation attached to Form 9-331C. Type DV pressure operated control.
11. Not applicable - Cable tool.
12. Testing will be bail test on all formations.

TYPE DV PRESSURE OPERATED GATE VALVES

3000-4000-6000 and 10,000 Lbs. Test

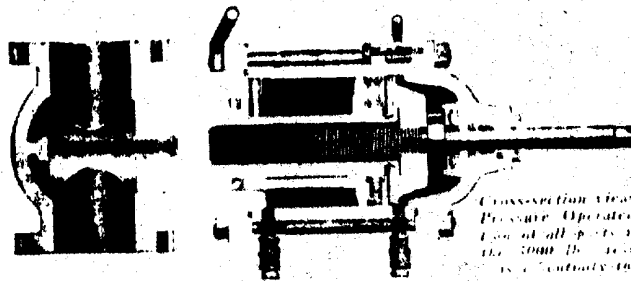

Cross-section view of the Cameron 6000 Lbs. Test Pressure Operated Gate Valve. The design of all parts is substantially the same as that of the 4000 Lbs. test model. The design of the seat is entirely the same in all test pressures.

This fast, positive-sealing Cameron Pressure Operated Gate Valve has a number of features of design and construction which enable it to provide the highest degree of safe, dependable control over destructive well pressures. Used either as a drilling-through valve, as a flow-line valve, or at any vital point in a drilling or completion control hook-up, it affords maximum security against loss of control.

Remote control and pressure operation, eliminating virtually all personal hazard to members of a drilling crew, inspire complete confidence in handling high pressures.

The Cameron Pressure Operated Gate Valve can be depended

upon to effect a leak-proof shut-off because of the unique design of its seat, and the fully tested and proved Cameron packing element. Complete absence of delicate sealing surfaces, whose efficiency declines very rapidly under service conditions, marks the Cameron Valve as unique in its field. Ability to seal against no pressure, even if the valve seat be rusted, corroded, roughened, or to a limited degree sand-cut, raises this valve into a class of its own.

See pages 552-554 of the 1941 Composite Catalog for complete mechanical details, or full details will gladly be provided on request.

CAMERON IRON WORKS, INC.

HOUSTON, TEXAS

SOLE OFFICE: 147 E. 11th St., New York, N. Y. CALIFORNIA DISTRIBUTOR: J. H. H. Co., 1000 S. W. 1st St., Los Angeles, CALIF. OKLAHOMA DISTRIBUTOR: J. H. H. Co., 1000 S. W. 1st St., Oklahoma City, OKLA.

Collier & Collier ☆☆☆

DAVID C.

TIMOTHY D.

Independent Oil Producers

PHONE 505-746-6520

BOX 798

ARTESIA, NEW MEXICO 88210

SURFACE USE PLAN

RECEIVED

Hagen Fed. #1 Lease No. NM#15867

660' FNL & 660' FEL

N.M.P.M.

Eddy County, New Mexico

Cable Tool Hole

OCT 26 1979

U.S. GEOLOGICAL SURVEY
ARTESIA, NEW MEXICO

This plan is submitted with the application for permit to drill the above described well. Purpose is to describe the location of proposed well, construction activities, operations and magnitude of surface disturbance along with rehabilitation plan of impacted surface upon completion of operations. Trust complete appraisal of effects associated with operation can be made with information contained herein:

1. Existing Roads:

- A. Exhibit "A" is a portion of map showing the location of proposed well as staked, outlining existing roads in a one (1) mile radius.

2. Planned Access Roads:

- A. Access will be made to well site area on existing county roads all of which are in proper condition to accomodate movement of equipment and personnel.
- B. No culverts, cattleguards, gates will be installed.
- C. No cuts or fill or dirt work of any kind on existing roads will be needed. Well site is located approximately 210 feet off existing road. No construction is necessary on location or road work required with the exception of digging the pit necessary for drilling operations.

3. Location of Existing Wells:

- A. Existing well within a two (2) mile radius is shown on Exhibit "B".

4. Location of Existing and/or Proposed Facilities:

- A. Exhibit "C" outlines location of production equipment if well is commercial. Flowline and tank battery will be located on well site and no new surface disturbance will be involved.

Collier & Collier ☆☆☆

DAVID C.

TIMOTHY D.

Independent Oil Producers

PHONE 505-746-6520

BOX 798

ARTESIA, NEW MEXICO 88210

-2-

5. Location and Type of Water Supply.

- A. Water for drilling will be purchased from local water transportation company and/or hauled by company trucks transported to well site. Cable tool operations do not require large amounts of water.

6. Source of Construction Materials:

- A. If caliche is encountered when digging cuttings pit as outlined in paragraph #7, it will be used in the immediate area of rig. No additional construction materials required.

7. Methods of Handling Waste Disposal:

- A. Drill cuttings will be disposed of in drilling pit. See Exhibit "C".
- B. Drilling fluids will be allowed to evaporate in drilling pit until dry. Pit will be closed upon drying.
- C. Produced water during any test will be placed in drilling pit. Oil produced during testing will be stored in test tanks until sold.
- D. Current laws and regulations pertaining to human waste will be complied with.
- E. Trash, garbage, junk and any debris buried in a separate pit covered with a minimum of 24" of dirt. All trash will be contained to prevent scattering. Location of trash pit is in Exhibit "C". All trash will be buried or removed within 30 days.

8. Auxillary Facilities:

- A. None required.

9. Well Site Layout:

- A. Exhibit "C" shows the relative locations and dimensions of the well site, cuttings, pit, trash pit, and major components of drilling equipment.
- B. Leveling off well site can be done by shovel if any needed. No cuts and fills are required. 210' road and pad will be scraped if so required but not needed for operations.

Collier & Collier ☆☆☆

DAVID C.

TIMOTHY D.

Independent Oil Producers

PHONE 505-746-6520

BOX 798

ARTESIA, NEW MEXICO 88210

-3-

- C. "Pad" and pit area stated and flagged as outlined in Exhibit "C".

10. Plans for Restoration of Surface:

- A. After completion of drilling and/or completion of operations all equipment and other material not needed for operations will be removed. Pits will be filled and location cleaned to leave well site aesthetically pleasing as possible.
- B. Any pits containing fluids will be fenced until they are filled.
- C. Any special revegetation requirement of Surface Management Agency will be complied with and accomplished as expeditiously as feasible.

11. Other Information:

- A. Land surface is relatively flat and smooth. Elevation is 3359' GL at well site. No gullies, washes or depressions are in immediate area.
- B. Soil: Sand red clay underlain by caliche.

Flora and Fauna:

- A. Vegetative cover is relatively sparse consisting mainly of broom weed and perennial native range grasses dotted with mesquite and greasewood. Wildlife is typical of our semi-arid desert in New Mexico; rabbits, rodents, reptiles, dove, quail, and an occasional coyote.

Ponds and Streams:

- A. None in area.

Residence and Other Structures:

- A. ~~No~~ occupied structures in three (3) mile radius. This area consists primarily of oil field supply and salvage yards. Drilling of well will pose no threat to inhabitants or passersby in this area.

Collier & Collier ☆☆☆

DAVID C.

TIMOTHY D.

Independent Oil Producers

PHONE 505-746-6520

BOX 798

ARTESIA, NEW MEXICO 88210

-4-

Land Use:

A. Grazing and seasonal hunting.

Surface Ownership:

A. Well site is on Bureau of Land Management surface. Existing roads are on state and federal lands. The 210' of additional road way will be on Bureau of Land Management surface.

12. Operator's Representatives:

The field representatives responsible for assuring compliance with approved surface use and operations plan are as follows:

Tim Collier
P.O. Box 798
Artesia, New Mexico 88210
Office Phone: 505-746-6520
746-4531
Home Phone 505-748-1052

James W. (Pete) McGuire
P.O. Box 798
Artesia, New Mexico 88210
Office Phone: 505-746-6520
746-4531
Home Phone: 505-746-4874

13. Certification:

I hereby certify that I, or persons under my direct supervision, have inspected the proposed drillsite and access route; that I am familiar with the conditions which presently exist; that the statements made in this plan are, to the best of my knowledge true and correct; and, that the work associated with the operations proposed herein will be performed by Collier & Collier and its contractors and subcontractors in conformity with this plan and the terms and conditions under which it is approved.

Date: October 25, 1979

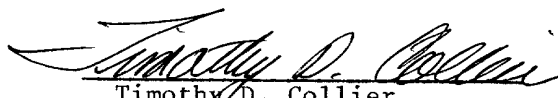
Timothy D. Collier
Partner

Collier & Collier ★★

DAVID C.

TIMOTHY D.

Independent Oil Producers

PHONE 505-746-6520

BOX 798

ARTESIA, NEW MEXICO 88210

EXHIBIT "A"

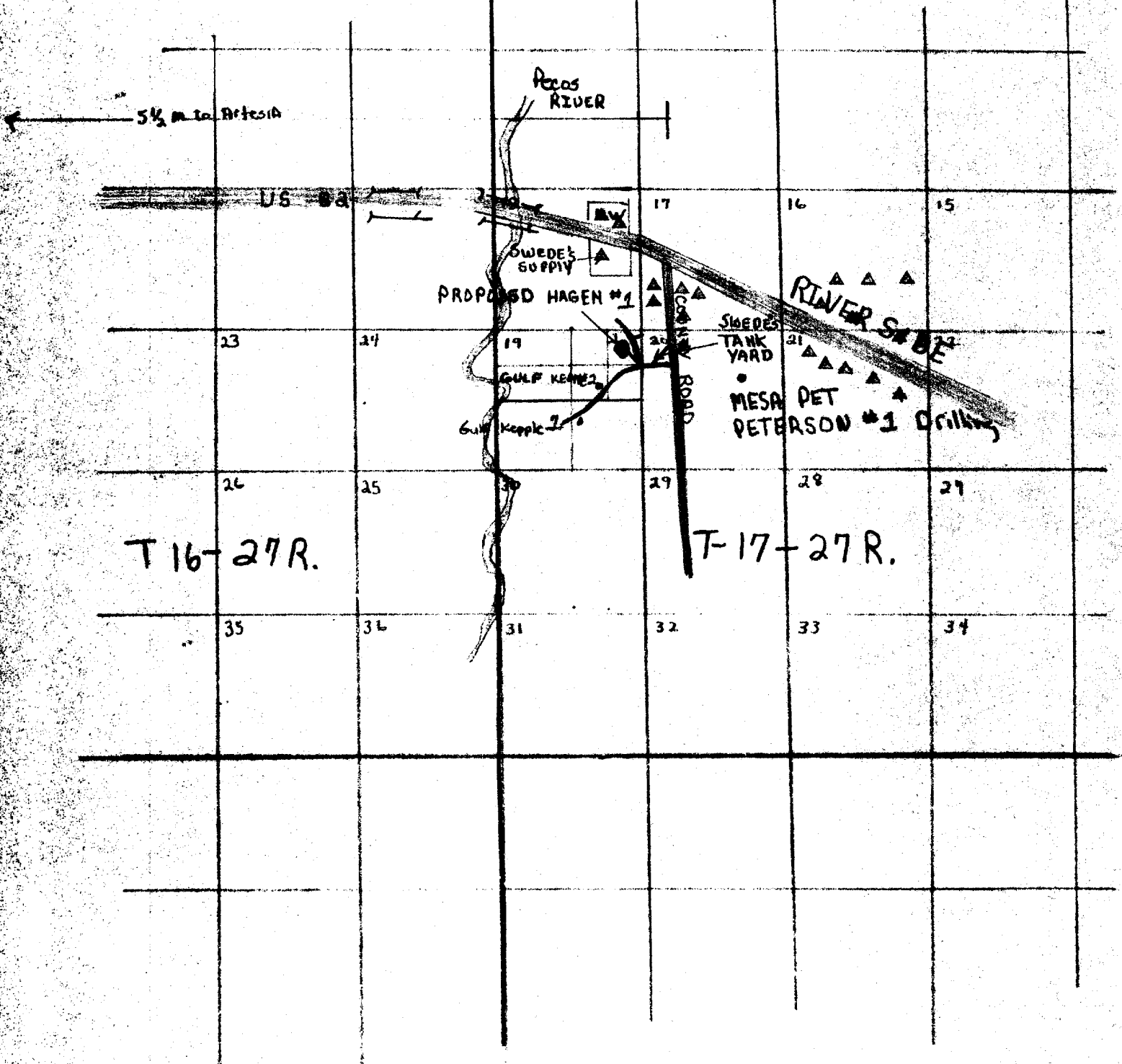

LEGEND

- Existing Road (Paved) ■
- Existing Road (Unpaved) ■
- Pecos River ■
- New Road & Area Required ■
- Structure ▲



Scale 1" = 5000'

NOTE: Well location approximately 210' off existing pipe line road.

EXHIBIT "C"

