

COPIES RECEIVED	
DISTRIBUTION	
NTA FE	1
LE	1
G.S.	2
ND OFFICE	1
ERATOR	1

# NEW MEXICO OIL CONSERVATION COMMISSION RECEIVED

JAN 25 1980

O. C. D.

30-015-23148  
Form C-101  
Revised 1-4-65

5A. Indicate Type of Lease STATE <input checked="" type="checkbox"/> FEE <input type="checkbox"/>
5. State Oil & Gas Lease No. L-1603

## APPLICATION FOR PERMIT TO DRILL, DEEPEN, OR PLUG BACK

1. Type of Work DRILL <input checked="" type="checkbox"/> DEEPEN <input type="checkbox"/> PLUG BACK <input type="checkbox"/>
2. Type of Well OIL <input checked="" type="checkbox"/> GAS <input type="checkbox"/> OTHER <input type="checkbox"/>
3. Zone SINGLE <input checked="" type="checkbox"/> MULTIPLE <input type="checkbox"/>

7. Unit Agreement Name
8. Farm or Lease Name New Mexico <del>State</del> 36
9. Well No. 4
10. Field and Pool, or Wildcat Red Lake East (Q.-G.)

4. Name of Operator WILLIAM N. BEACH
5. Address of Operator P. O. BOX 3669, Midland, TX 79702
6. Location of Well UNIT LETTER C LOCATED 1980 FEET FROM THE West LINE 660 FEET FROM THE North LINE OF SEC. 36 TWP. 16-S RGE. 28-E NMPM

12. County EDDY
--------------------

11. Proposed Depth 1750	13A. Formation Grayburg	14. History or C.T. C.T.
15. Kind & Status Plug Bond 1 well bond	16. Drilling Contractor Cortez Drilling	17. Approx. Date Work will start 1/27/80
18. Notes on whether DE, RI, etc. 3605 GL		

### PROPOSED CASING AND CEMENT PROGRAM

SIZE OF HOLE	SIZE OF CASING	WEIGHT PER FOOT	SETTING DEPTH	SACKS OF CEMENT	EST. TOP
11"	8-5/8"	28	350*	150	circ
7-7/8"	4-1/2"	10.5	1750	250	900

\* on top of salt

Drill 11" hole, set 350 + surface csg., circ. cement.  
Install BOP, drill 7-7/8" hole to TD, Run 4-1/2" production  
csg., then production test.

APPROVAL VALID  
FOR 90 DAYS UNLESS  
DRILLING COMMENCED,  
EXPIRES 4-30-80

ABOVE SPACE DESCRIBE PROPOSED PROGRAM: IF PROPOSAL IS TO DEEPEN OR PLUG BACK, GIVE DATA ON PRESENT PRODUCTIVE ZONE AND PROPOSED NEW PRODUCTIVE ZONE. GIVE BLOWOUT PREVENTER PROGRAM, IF ANY.

I hereby certify that the information above is true and complete to the best of my knowledge and belief.

Signed W. C. Smith Title Landman Date 1-22-80

(This space for State Use)

APPROVED BY W. A. Gressett TITLE SUPERVISOR, DISTRICT II DATE JAN 30 1980

ADDITIONS OF APPROVAL, IF ANY:

**N MEXICO OIL CONSERVATION COMMISS**  
**WELL LOCATION AND ACREAGE DEDICATION PLAT**

Form C-102  
 Supersedes C-128  
 Effective 1-1-85

All distances must be from the outer boundaries of the Section

Operator <b>William N. Beach</b>		Lease <b>New Mexico State 36</b>		Acres <b>4</b>
Unit Letter <b>C</b>	Section <b>36</b>	Township <b>16 South</b>	Range <b>28 East</b>	County <b>Eddy</b>
Actual Well Location of Well: <b>660</b> feet from the <b>North</b> line and <b>1980</b> feet from the <b>West</b> line				
Ground Level Elev. <b>3609.7</b>	Producing Formation <b>PENROSE and RED LAKE EAST (Queen/Grybg)</b>		Estimated Acreage <b>40</b>	

1. Outline the acreage dedicated to the subject well by colored pencil or hatchure marks on the plat below.
2. If more than one lease is dedicated to the well, outline each and identify the ownership thereof (both as to working interest and royalty).
3. If more than one lease of different ownership is dedicated to the well, have the interests of all owners been consolidated by communitization, unitization, force-pooling, etc?

☐ Yes ☐ No If answer is "yes," type of consolidation \_\_\_\_\_

If answer is "no," list the owners and tract descriptions which have actually been consolidated. (Use reverse side of this form if necessary.) \_\_\_\_\_

No allowable will be assigned to the well until all interests have been consolidated (by communitization, unitization, forced-pooling, or otherwise) or until a non-standard unit, eliminating such interests, has been approved by the Commission.

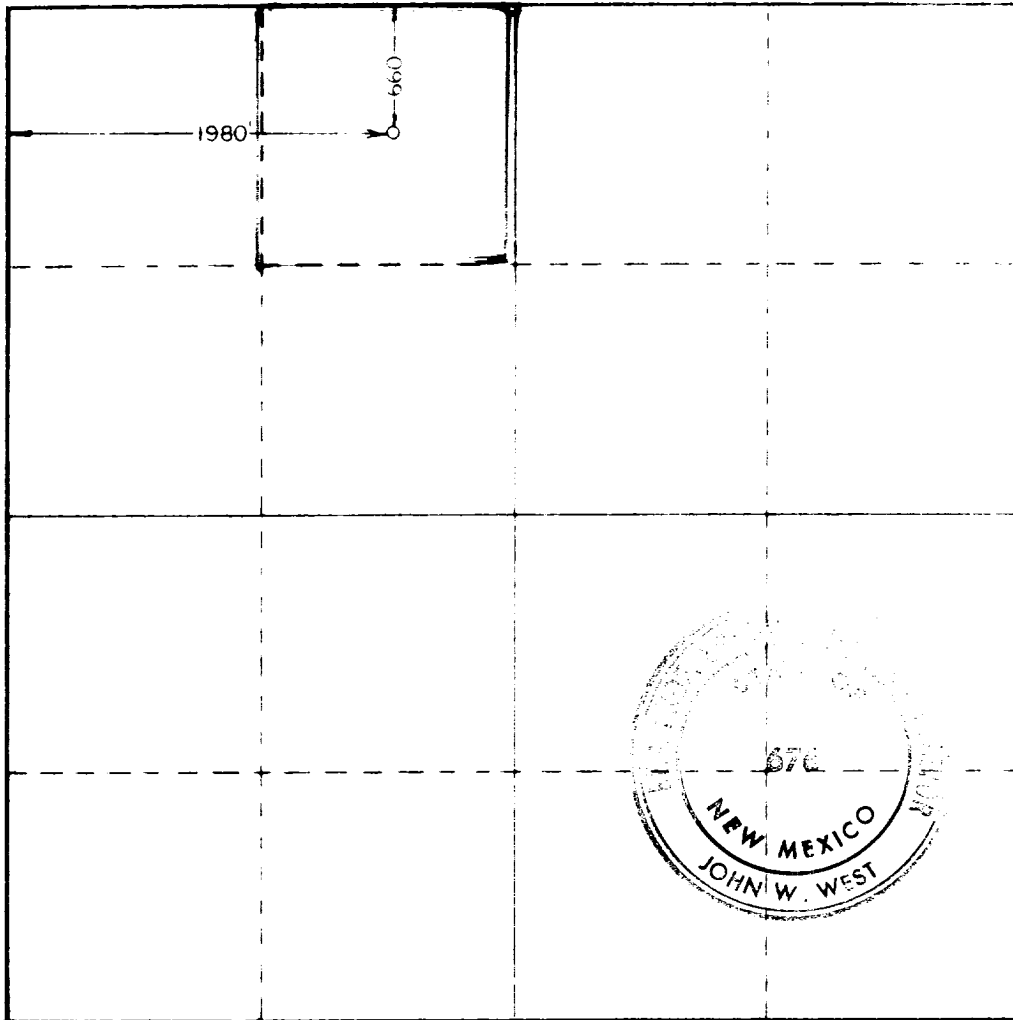

**CERTIFICATION**

I hereby certify that the information contained herein is true and complete to the best of my knowledge and belief.

*Carl C. Beach*

**CARL C. BEACH**

**LANDMAN**

**WILLIAM N. BEACH**

**1-25-80**

I hereby certify that the well location shown on this plat was plotted from field notes of actual surveys made by me or under my supervision and that the same is true and correct to the best of my knowledge and belief.

Date Surveyed:  
**January 23, 1980**

Registered Professional Engineer  
 and Land Surveyor

*John W. West*

Certificate No. **JOHN W. WEST 676**  
**PATRICK A. ROMERO 6663**  
**Ronald J. Eidson 3239**

