

Operator Exxon Corporation		Lease New Mexico "CY" State Com.		Well No. 1
Unit Letter I	Section 23	Township 17 South	Range 28 East	County Eddy
Actual Footage Location of Well: 1980 feet from the South line and 660 feet from the East line				
Ground Level Elev: 3705.3 Ft.	Producing Formation Morrow	Pool Aid-Morrow	Dedicated Acreage: 320 Acres	

1. Outline the acreage dedicated to the subject well by colored pencil or hard pencil on the plat below.
2. If more than one lease is dedicated to the well, outline each and identify the ownership thereof (both as to working interest and royalty).
3. If more than one lease of different ownership is dedicated to the well, have the interests of all owners been consolidated by communitization; unitization, force-pooling, etc?

☒ Yes    ☐ No    If answer is "yes," type of consolidation Communitization Pending

If answer is "no," list the owners and tract descriptions which have actually been consolidated. (Use reverse side of this form if necessary.) \_\_\_\_\_

No allowable will be assigned to the well until all interests have been consolidated (by communitization, unitization, forced-pooling, or otherwise) or until a non-standard unit, eliminating such interests, has been approved by the Commission.

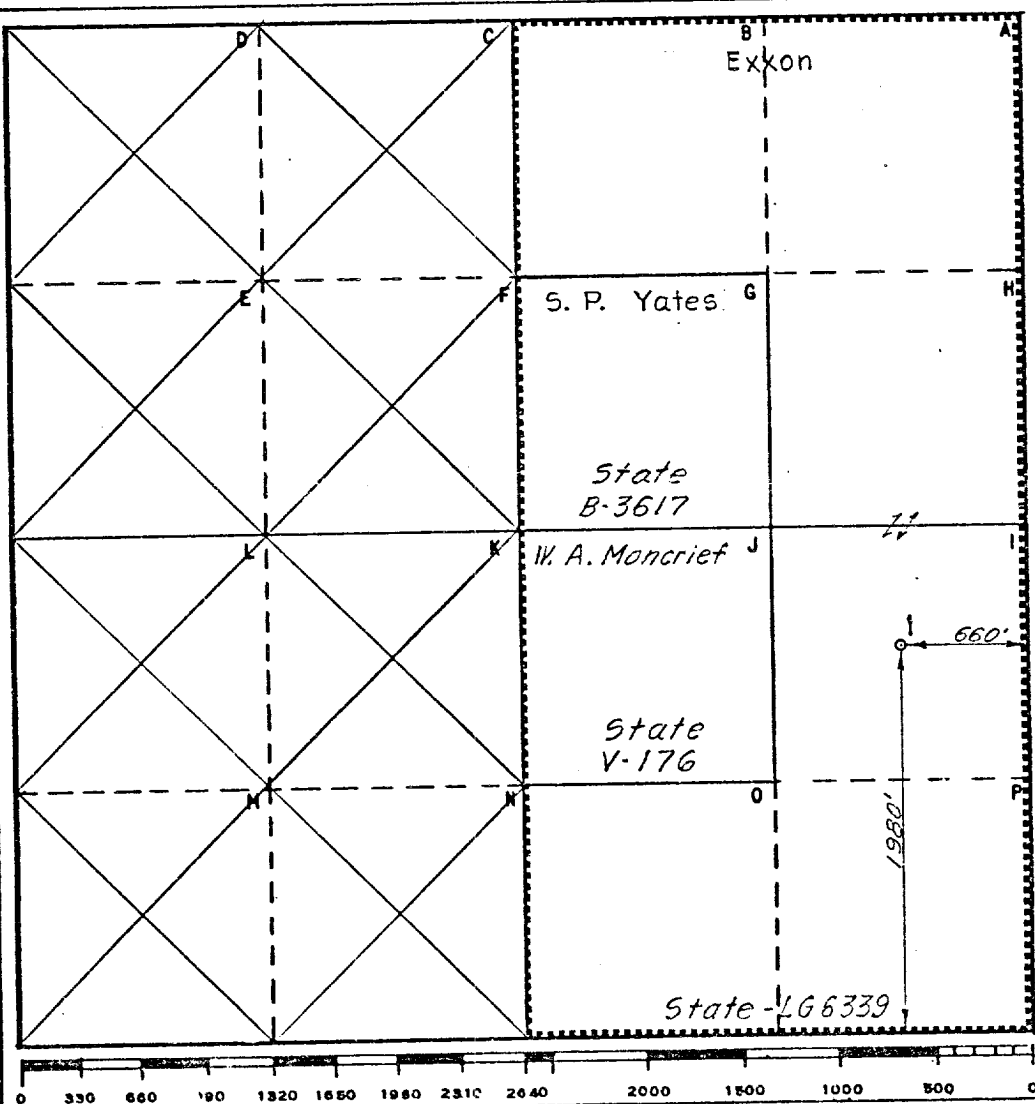

CERTIFICATION	
I hereby certify that the information contained herein is true and complete to the best of my knowledge and belief.	
Name <i>Frederick Knippling</i>	Position <i>Proration Specialist</i>
Company Exxon Corporation Box 1600 Midland, Texas	
Date 2-26-80	
I hereby certify that the well location shown on this plat was plotted from field notes of actual surveys made by me or under my supervision, and that the same is true and correct to the best of my knowledge and belief.	
Date Surveyed <i>Feb. 22, 1980</i>	
Registered Professional Engineer and/or Land Surveyor <i>H. S. Shusterfeld</i>	
Certificate No. 1382	