

30-015-23233

COPIES RECEIVED	
DISTRIBUTION	
SANTA FE	
FILE	
U.S.G.S.	
LAND OFFICE	
OPERATOR	

NEW MEXICO OIL CONSERVATION COMMISSION

Form O-101  
Revised 1-1-65

APPLICATION FOR PERMIT TO DRILL, DEEPEN, OR PLUG BACK

1a. Type of Work  
b. Type of Well  
c. Name of Operator  
d. Location of Well  
e. Proposed Depth  
f. Formation  
g. Rotary or C.T.  
h. Approx. Date Work will start

DRILL ☒ DEEPEN ☐ PLUG BACK ☐  
 GAS WELL ☐ OTHER ☐ SINGLE ZONE ☐ MULTIPLE ZONE ☐  
 Yates Petroleum Corporation  
 207 South 4th Street, Artesia, NM 88210  
 UNIT LETTER C LOCATED 990 FEET FROM THE North LINE  
 1650 FEET FROM THE West LINE OF SEC. 23 TWP. 17S R. 25E  
 approx. 1500 San Andres Rotary  
 3499 GL Blanket L&M Drilling Co. As soon as approved

1a. Indicate Type of Lease  
STATE ☐ FEE ☒  
 1b. Field and Pool, or Well Unit  
 1c. Field and Pool, or Well Unit  
 1d. Field and Pool, or Well Unit  
 1e. Field and Pool, or Well Unit  
 1f. Field and Pool, or Well Unit  
 1g. Field and Pool, or Well Unit  
 1h. Field and Pool, or Well Unit  
 1i. Field and Pool, or Well Unit  
 1j. Field and Pool, or Well Unit  
 1k. Field and Pool, or Well Unit  
 1l. Field and Pool, or Well Unit  
 1m. Field and Pool, or Well Unit  
 1n. Field and Pool, or Well Unit  
 1o. Field and Pool, or Well Unit  
 1p. Field and Pool, or Well Unit  
 1q. Field and Pool, or Well Unit  
 1r. Field and Pool, or Well Unit  
 1s. Field and Pool, or Well Unit  
 1t. Field and Pool, or Well Unit  
 1u. Field and Pool, or Well Unit  
 1v. Field and Pool, or Well Unit  
 1w. Field and Pool, or Well Unit  
 1x. Field and Pool, or Well Unit  
 1y. Field and Pool, or Well Unit  
 1z. Field and Pool, or Well Unit

23. PROPOSED CASING AND CEMENT PROGRAM

SIZE OF HOLE	SIZE OF CASING	WEIGHT PER FOOT	SETTING DEPTH	SACKS OF CEMENT	EST. TOP
15"	10 3/4"	32#	approx. 350'	Circulate	
9 1/2"	7"	20#	approx. 1150'	Circulate	
6 1/2"	4 1/2 & 5 1/2"	10.5 & 15.5#	TD	Circulate	

Propose to drill a San Andres test. Approximately 350' of 10 3/4" casing will be run if needed, and cemented to the surface to shut off surface gravel and cavings, 7" casing will be run 100' below the Artesian Zone, cemented to surface. A tapered string of production casing will be run and cemented, perforated and San frac'd for completion.

MUD PROGRAM: Fresh water mud w/LCM from surface to 1150', fresh water to total depth.

BOP PROGRAM: BOP's to be installed on 7" casing and tested daily.

APPROVAL VALID  
FOR 90 DAYS UNLESS  
DRILLING COMMENCED,  
EXPIRES 2-6-80

IN ABOVE SPACE DESCRIBE PROPOSED PROGRAM; IF PROPOSAL IS TO DEEPEN OR PLUG BACK, GIVE DATA ON PRESENT PRODUCTIVE ZONE AND PROPOSED NEW PRODUCTIVE ZONE. GIVE BLOWOUT PREVENTER PROGRAM, IF ANY.

I hereby certify that the information above is true and complete to the best of my knowledge and belief.

Signed [Signature] Title Regulatory Coordinator Date 10/29/80

APPROVED BY [Signature] TITLE SUPERVISOR, DISTRICT II DATE NOV 06 1980

CONDITIONS OF APPROVAL, IF ANY:  
Cement must be circulated to surface below all casing the 7" casing

NEW MEXICO OIL CONSERVATION COMMISSION  
WELL LOCATION AND ACREAGE DEDICATION PLAT

Form C-102  
Supersedes C-128  
Effective 1-1-65

All distances must be from the outer boundaries of the Section.

Operator <b>YATES PETROLEUM CORPORATION</b>			Lease <b>Gissler AV</b>		Well No. <b>17</b>
Unit Letter <b>C</b>	Section <b>23</b>	Township <b>17 South</b>	Range <b>25 East</b>	County <b>Eddy</b>	
Actual Footage Location of Well: <b>990</b> feet from the <b>North</b> line on <b>1650</b> feet from the <b>West</b> line					
Ground Level Elev. <b>3499.</b>	Producing Formation <b>SAN ANDRES</b>	Pool <b>EAGLE CREEK - S. A.</b>	Dedicated Acreage: <b>40</b> Acres		

1. Outline the acreage dedicated to the subject well by colored pencil or hachure marks on the plat below.
2. If more than one lease is dedicated to the well, outline each and identify the ownership thereof (both as to working interest and royalty).
3. If more than one lease of different ownership is dedicated to the well, have the interests of all owners been consolidated by communitization, unitization, force-pooling, etc?

☐ Yes ☐ No If answer is "yes," type of consolidation \_\_\_\_\_

If answer is "no," list the owners and tract descriptions which have actually been consolidated. (Use reverse side of this form if necessary.) \_\_\_\_\_

No allowable will be assigned to the well until all interests have been consolidated (by communitization, unitization, forced-pooling, or otherwise) or until a non-standard unit, eliminating such interests, has been approved by the Commission.

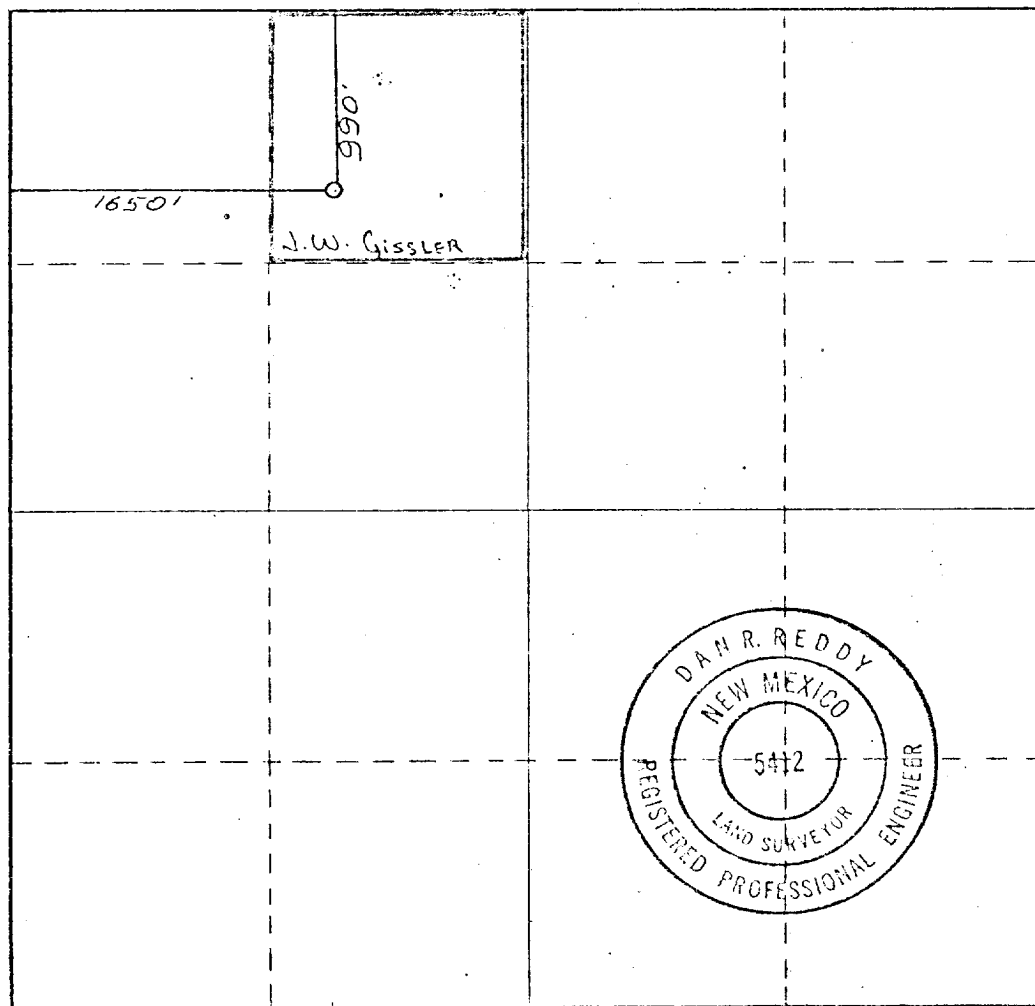

CERTIFICATION

I hereby certify that the information contained herein is true and complete to the best of my knowledge and belief.

*Johnny A. Lopez*  
Name

**JOHNNY A. LOPEZ**  
Position

**REGULATORY COORDINATOR**  
Company

**YATES PETROLEUM CORPORATION**  
Date

**10/31/80**

I hereby certify that the well location shown on this plat was plotted from field notes of actual surveys made by me or under my supervision, and that the same is true and correct to the best of my knowledge and belief.

Date Surveyed

**October 25, 1980**  
Registered Professional Engineer  
and/or Land Surveyor

*Dan R. Reddy*  
Certificate No.

**NM PE&LS #5412**

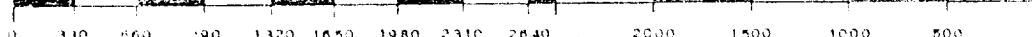

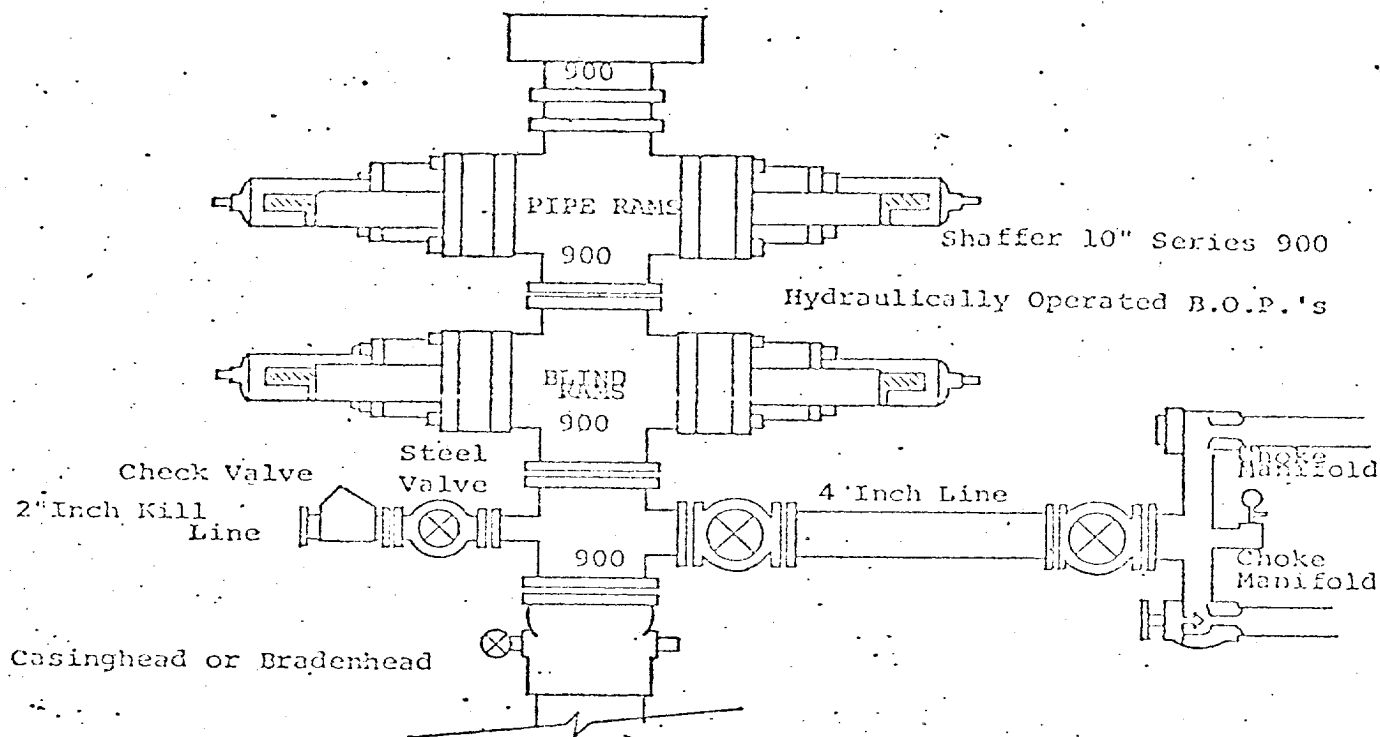

THE FOLLOWING CONSTITUTE MINIMUM BLOWOUT PREVENTER REQUIREMENTS

1. All preventers to be hydraulically operated with secondary manual controls installed prior to drilling out from under casing.
2. Choke outlet to be a minimum of 4" diameter.
3. Kill line to be of all steel construction of 2" minimum diameter.
4. All connections from operating manifolds to preventers to be all steel, hole or tube a minimum of one inch in diameter.
5. The available closing pressure shall be at least 15% in excess of that required with sufficient volume to operate the B.O.P.'s.
6. All connections to and from preventer to have a pressure rating equivalent to that of the B.O.P.'s.
7. Inside blowout preventer to be available on rig floor.
8. Operating controls located a safe distance from the rig floor.
9. Hole must be kept filled on trips below intermediate casing. Operator not responsible for blowouts resulting from not keeping hole full.
10. D. P. float must be installed and used below zone of first gas intrusion.