

|                        |                                     |
|------------------------|-------------------------------------|
| NO. OF COPIES RECEIVED |                                     |
| DISTRIBUTION           | <input checked="" type="checkbox"/> |
| SANTA FE               | <input checked="" type="checkbox"/> |
| FILE                   | <input checked="" type="checkbox"/> |
| U.S.G.S.               | <input checked="" type="checkbox"/> |
| LAND OFFICE            | <input checked="" type="checkbox"/> |
| OPERATOR               | <input checked="" type="checkbox"/> |

NEW MEXICO OIL CONSERVATION **RECEIVED** DIVISION

30-015-23296  
Form C-101  
Revised 1-1-65

APR 15 1980

O. C. D.

ARTESIA, OFFICE

|   |                              |
|---|------------------------------|
| 5A. Indicate Type of Lease                |                              |
| STATE <input checked="" type="checkbox"/> | FEE <input type="checkbox"/> |
| 5. State Oil & Gas Lease No.              |                              |
| LG5760                                    |                              |

APPLICATION FOR PERMIT TO DRILL, DEEPEN, OR PLUG BACK

|  |                               |                                |                                  |
|--|-------------------------------|--------------------------------|----------------------------------|
| 1a. Type of Work   |                               | 7. Unit Agreement Name         |                                  |
| b. Type of Well<br>OIL WELL <input type="checkbox"/> GAS WELL <input checked="" type="checkbox"/> OTHER <input type="checkbox"/> |                               | 8. Farm or Lease Name          |                                  |
| DRILL <input checked="" type="checkbox"/> DEEPEN <input type="checkbox"/> PLUG BACK <input type="checkbox"/>                     |                               | State                          |                                  |
| 2. Name of Operator  |                               | 9. Well No.                    |                                  |
| Colorado Interstate Gas Company  |                               | 1                              |                                  |
| 3. Address of Operator   |                               | 10. Field and Pool, or Wildcat |                                  |
| 415 West 8th, Amarillo, Texas 79101  |                               | Wildcat                        |                                  |
| 4. Location of Well  |                               | 12. County                     |                                  |
| UNIT LETTER <u>ef</u> LOCATED 1000 FEET FROM THE North LINE  |                               | Eddy                           |                                  |
| AND 2010 FEET FROM THE West LINE OF SEC. 1 TWP. 16S RGE. 28E NMPM  |                               |                                |                                  |
| 19. Proposed Depth   |                               | 19A. Formation                 | 20. Rotary or C.T.               |
| 9600'  |                               | Morrow                         | Rotary                           |
| 21. Elevations (Show whether DF, RT, etc.)   | 21A. Kind & Status Plug. Bond | 21B. Drilling Contractor       | 22. Approx. Date Work will start |
| 3553' G.L.   | One-well                      | Unknown at present             | June 1, 1980                     |

PROPOSED CASING AND CEMENT PROGRAM

| SIZE OF HOLE | SIZE OF CASING | WEIGHT PER FOOT | SETTING DEPTH | SACKS OF CEMENT | EST. TOP |
|--------------|----------------|-----------------|---------------|-----------------|----------|
| 17 1/2"      | 13 3/8"        | 48              | 325           | 350             | Surface  |
| 12 1/4"      | 8 5/8"         | 24              | 1975          | 1000            | Surface  |
| 7 7/8"       | 5 1/2"         | 17, 15.5, 14    | 9600          | 200             | 8600'    |

Blowout Prevention Program: The following blowout prevention program will be implemented by Colorado Interstate Gas Company. At 1975' after 8 5/8" casing is set at that depth, a stack consisting of a 10" Shaffer Type F, Series 1500 pipe and blind rams will be installed. The working pressure is 5000 psi. A Hydril GK annular preventor will also be installed. The choke manifold is rated to 5000 psi. The accumulator unit will be installed approximately 100' from the rig, allowing for remote shut-in. Prior to drilling the Wolfcamp at approximately 6800', a rotating head and a complete PVT and flow sensor system will be installed. This program will provide sufficient protection should a Kick occur.

The gas is not dedicated.

APPROVAL VALID  
FOR 90 DAYS UNLESS  
DRILLING COMMENCED,

EXPIRES 7-18-80

IN ABOVE SPACE DESCRIBE PROPOSED PROGRAM: IF PROPOSAL IS TO DEEPEN OR PLUG BACK, GIVE DATA ON PRESENT PRODUCTIVE ZONE AND PROPOSED NEW PRODUCTIVE ZONE. GIVE BLOWOUT PREVENTER PROGRAM, IF ANY.

I hereby certify that the information above is true and complete to the best of my knowledge and belief.

Signed Paul D. Robert Title Petroleum Engineer Date April 14, 1980

(This space for State Use)

APPROVED BY W.A. Gressett TITLE SUPERVISOR, DISTRICT II DATE 4-18-80

CONDITIONS OF APPROVAL, IF ANY:

Costal State

State 1 F

1-16-28

NE. MEXICO OIL CONSERVATION COMMISS. 4  
WELL LOCATION AND ACREAGE DEDICATION PLAT

Form C-102  
Supersedes C-128  
Effective 1-1-65

All distances must be from the outer boundaries of the Section.

|  |                                      |                           |                        |   |                      |
|--|--------------------------------------|---------------------------|------------------------|---|----------------------|
| Operator<br><b>Colorado Interstate Gas Co.</b>   |                                      |                           | Lease<br><b>STATE</b>  |   | Well No.<br><b>1</b> |
| Unit Letter<br><b>F</b>  | Section<br><b>1</b>                  | Township<br><b>T-16-S</b> | Range<br><b>R-28-E</b> | County<br><b>EDDY</b>                     |                      |
| Actual Footage Location of Well:<br><b>1000</b> feet from the <b>NORTH</b> line and <b>2010</b> feet from the <b>WEST</b> line |                                      |                           |                        |   |                      |
| Ground Level Elev.<br><b>3553'</b>   | Producing Formation<br><b>Morrow</b> | Pool<br><b>Wildcat</b>    |                        | Dedicated Acreage:<br><b>219.60</b> Acres |                      |

1. Outline the acreage dedicated to the subject well by colored pencil or hatchure marks on the plat below.

2. If more than one lease is dedicated to the well, outline each and identify the ownership thereof (both as to working interest and royalty).

3. If more than one lease of different ownership is dedicated to the well, have the interests of all owners been consolidated by communitization, unitization, force-pooling, etc?

☐ Yes ☒ No If answer is "yes," type of consolidation \_\_\_\_\_

If answer is "no," list the owners and tract descriptions which have actually been consolidated. (Use reverse side of this form if necessary.) None consolidated. Will communitize after production established.

No allowable will be assigned to the well until all interests have been consolidated (by communitization, unitization, forced-pooling, or otherwise) or until a non-standard unit, eliminating such interests, has been approved by the Commission.

RECEIVED

APR 21 1980

O. C. D.

ARTESIA, OFFICE

CERTIFICATION

I hereby certify that the information contained herein is true and complete to the best of my knowledge and belief.

Name \_\_\_\_\_  
Petroleum Engineer  
Position  
Colorado Interstate Gas Co.  
Company  
April 14, 1980  
Date

I hereby certify that the well location shown on this plat was plotted from field notes of actual surveys made by me or under my supervision and that the same is true and correct to the best of my knowledge and belief.

March 26, 1980

Date Surveyed \_\_\_\_\_  
Registered Professional Engineer  
and/or Land Surveyor

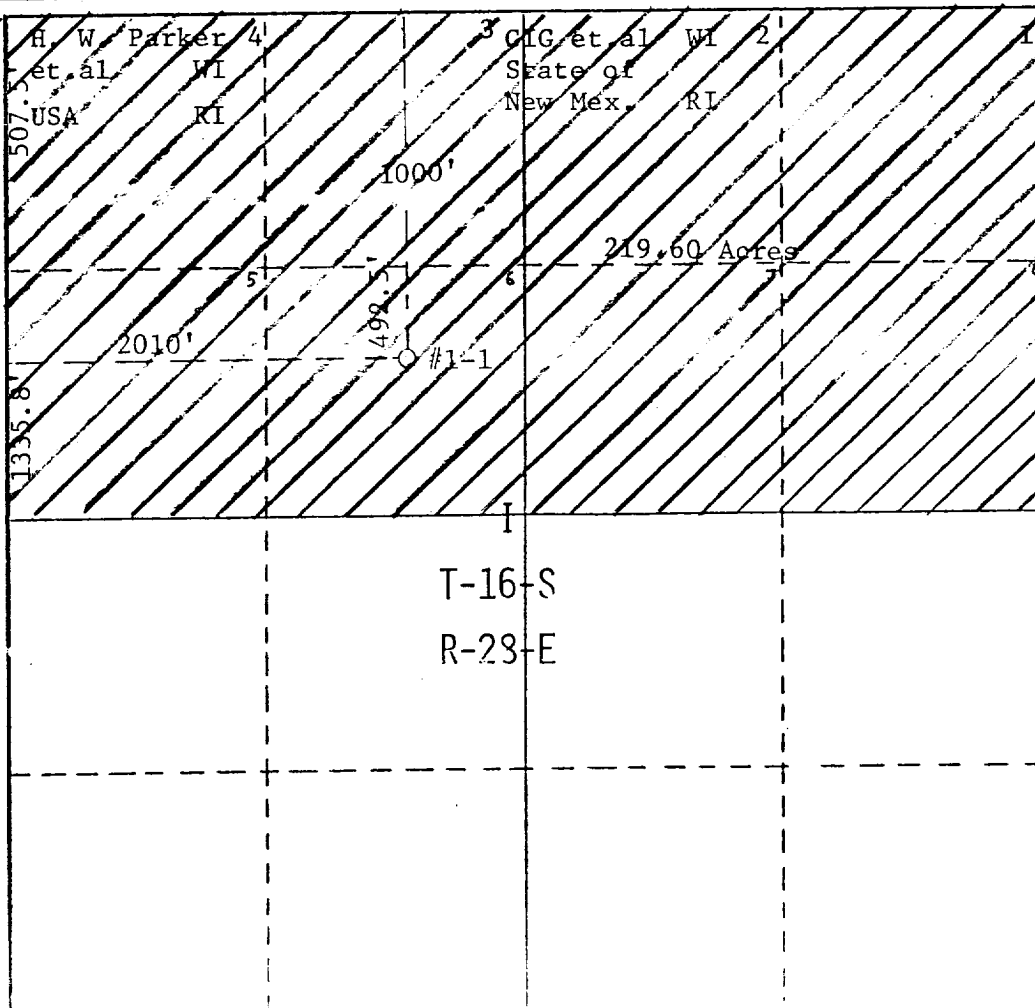

NE MEXICO OIL CONSERVATION COMMISSION  
WELL LOCATION AND ACREAGE DEDICATION PLAT

Form C-102  
Supersedes C-128  
Effective 1-1-65

All distances must be from the outer boundaries of the Section.

|  |                                      |                           |  |   |                      |
|--|--------------------------------------|---------------------------|--|---|----------------------|
| Operator<br><b>Colorado Interstate Gas Co.</b>   |                                      |                           | Lease<br><b>STATE OF <del>NEW MEXICO</del></b> |   | Well No.<br><b>1</b> |
| Unit Letter<br><b>C</b>  | Section<br><b>1</b>                  | Township<br><b>T-16-S</b> | Range<br><b>R-28-E</b>                         | County<br><b>EDDY</b>                     |                      |
| Actual Footage Location of Well:<br><b>1000</b> feet from the <b>NORTH</b> line and <b>2010</b> feet from the <b>WEST</b> line |                                      |                           |  |   |                      |
| Ground Level Elev.<br><b>3553'</b>   | Producing Formation<br><b>Morrow</b> |                           | Pool<br><b>Wildcat</b>                         | Dedicated Acreage:<br><b>219.60</b> Acres |                      |

1. Outline the acreage dedicated to the subject well by colored pencil or hachure marks on the plat below.
2. If more than one lease is dedicated to the well, outline each and identify the ownership thereof (both as to working interest and royalty).
3. If more than one lease of different ownership is dedicated to the well, have the interests of all owners been consolidated by communitization, unitization, force-pooling, etc?

☐ Yes ☒ No If answer is "yes," type of consolidation \_\_\_\_\_

If answer is "no," list the owners and tract descriptions which have actually been consolidated. (Use reverse side of this form if necessary.) None consolidated. Will communitize after production established.

No allowable will be assigned to the well until all interests have been consolidated (by communitization, unitization, forced-pooling, or otherwise) or until a non-standard unit, eliminating such interests, has been approved by the Commission.

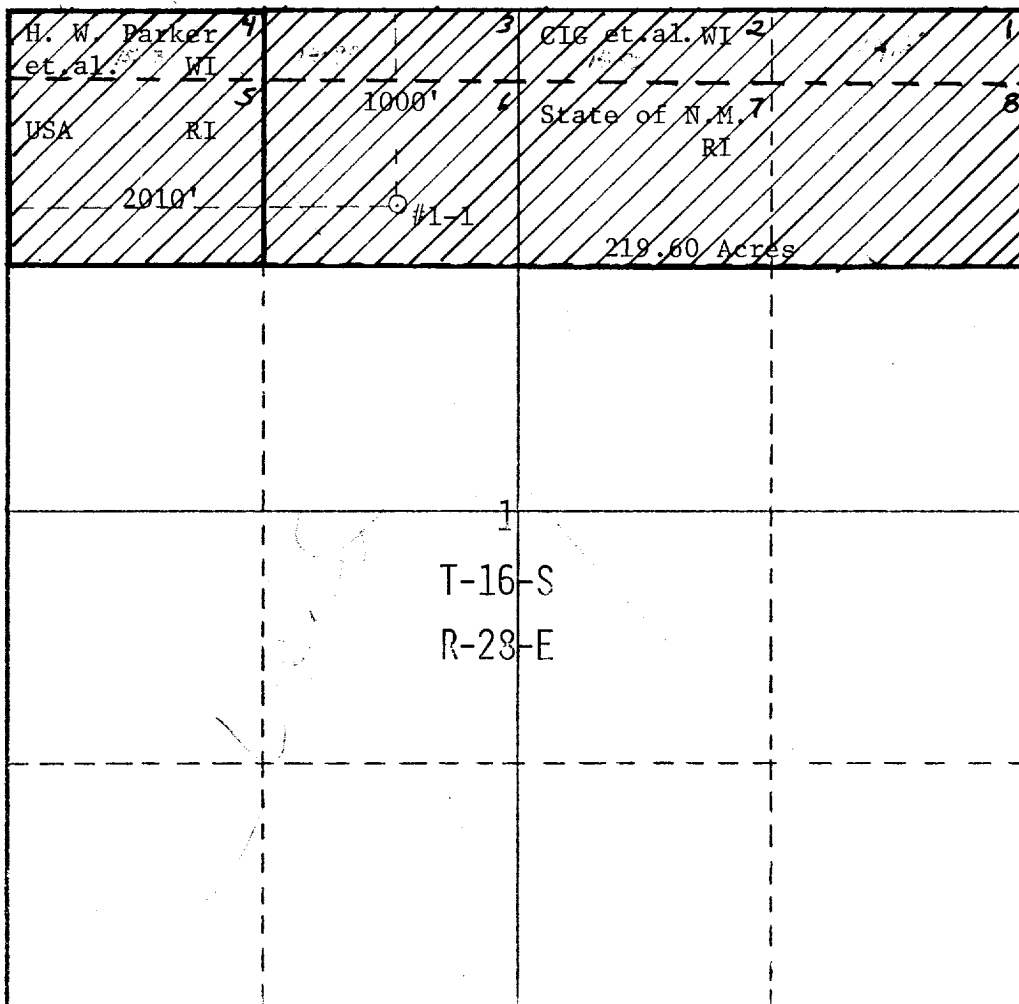

CERTIFICATION

I hereby certify that the information contained herein is true and complete to the best of my knowledge and belief.

*Paul D. Roberts*

Name

Petroleum Engineer

Position

Colorado Interstate Gas Co.

Company

April 14, 1980

Date

I hereby certify that the well location shown on this plat was plotted from field notes of actual surveys made by me or under my supervision, and that the same is true and correct to the best of my knowledge and belief.

March 26, 1980

Date Surveyed

*[Signature]*  
Registered Professional Engineer  
and/or Land Surveyor

Certificate No.

3959

0 330 660 990 1320 1650 1980 2310 2640 2970 3300 3630 3960 4290 4620 4950 5280 5610 5940 6270 6600



*Colorado Interstate Gas Company*

415 WEST 8TH STREET • SUITE 202 • AMARILLO, TEXAS 79101  
(806) 372-4391

April 18, 1980  
AD #132

RECEIVED  
APR 21 1980  
O. C. D.  
ARTESIA, OFFICE

The State of New Mexico  
Energy and Minerals Department  
Oil Conservation Division  
P. O. Box Drawer DD  
Artesia, New Mexico 88210

ATTENTION: Mr. Bill Gressett

Dear Sir:

Enclosed are copies of well locations and acreage dedication plats for CIG's State #1 well. It has footage marked as requested. Also, enclosed is a one well plugging bond in accordance with state regulations.

If you require any further information, please advise. Thank you very much for your time and consideration.

Sincerely,

P. D. Roberts  
Petroleum Engineer

PDR:og

Enclosure



STATE OF NEW MEXICO  
ENERGY AND MINERALS DEPARTMENT  
OIL CONSERVATION DIVISION

March 26, 1980

BRUCE KING  
GOVERNOR

LARRY KEHOE  
SECRETARY

POST OFFICE BOX 2088  
STATE LAND OFFICE BUILDING  
SANTA FE, NEW MEXICO 87501  
(505) 827-2434

RECEIVED

MAR 31 1980

O. C. D.  
ARTESIA, OFFICE

CIG Exploration, Inc.  
415 W. 8th Street  
Amarillo, Texas 79101

Attention: Mr. Tom R. Gray

Administrative Order NSP-1188

Gentlemen:

Reference is made to your application for a 219.60-acre non-standard gas proration unit consisting of the following acreage:

EDDY COUNTY, NEW MEXICO  
TOWNSHIP 16 SOUTH, RANGE 28 EAST, NMPM  
Section 1: Lots 1, 2, 3, 4, 5, 6, 7, and 8.

It is my understanding that this unit is to be dedicated to your State of New Mexico Well No. 1 located 1000 feet from the North line and 2010 feet from the West line of said Section 1 and is for the Wolfcamp, Pennsylvanian and Mississippian formations.

By authority granted me under the provisions of Rule 104 D II, the above non-standard proration unit is hereby approved.

Sincerely,

JOE D. RAMEY,  
Director

JDR/dr

cc: Oil Conservation Division - Artesia  
Oil & Gas Engineering Committee - Hobbs  
Oil & Gas Division - State Land Office - Santa Fe