

NO. OF COPIES RECEIVED	
DISTRIBUTION	
ARTESIA	1
FILE	✓
U.S.G.S.	2
LAND OFFICE	1
OPERATOR	1

NEW MEXICO OIL CONSERVATION COMMISSION

RECEIVED

30-015-23434
Form C-101
Revised 1-1-65

AUG 7 1980

O. C. D.
ARTESIA, OFFICE

5A. Indicate Type of Lease	
STATE <input checked="" type="checkbox"/>	FEE <input type="checkbox"/>
5. State Oil & Gas Lease No.	
B-1969	

APPLICATION FOR PERMIT TO DRILL, DEEPEN, OR PLUG BACK

1a. Type of Work				7. Unit Agreement Name	
b. Type of Well DRILL <input checked="" type="checkbox"/> DEEPEN <input type="checkbox"/> PLUG BACK <input type="checkbox"/>				8. Farm or Lease Name	
OIL WELL <input checked="" type="checkbox"/> GAS WELL <input type="checkbox"/> OTHER <input type="checkbox"/>				Camille	
2. Name of Operator				9. Well No.	
JFG ENTERPRISES				3	
3. Address of Operator				10. Field and Pool, or Wildcat	
Box 100, Artesia, New Mexico 88210				East Empire Yates 7 R	
4. Location of Well				12. County	
UNIT LETTER I LOCATED 1650 FEET FROM THE FSL LINE				Eddy	
AND 990 FEET FROM THE FEL LINE OF SEC. 22 TWP. 17S RGE. 28E NMPM					
19. Proposed Depth		19A. Formation		20. Rotary or C.T.	
800'		Seven Rivers		Rotary	
21. Elevations (Show whether DF, RT, etc.)		21A. Kind & Status Plug. Bond		21B. Drilling Contractor	
3580.9 GR.		Statewide		Artesia Fishing Tool	
				22. Approx. Date Work will start	
				8-18-80	

PROPOSED CASING AND CEMENT PROGRAM

SIZE OF HOLE	SIZE OF CASING	WEIGHT PER FOOT	SETTING DEPTH	SACKS OF CEMENT	EST. TOP
7 7/8"	5 1/2"	14#	800'	250 Sx.	Surf.

Plan to drill Seven Rivers well using 7 7/8" Bit to T.D.
Approx. 800' using mud pump with mud and water.

Plan to run 800' 5 1/2" 14# Casing & Circulate w/250 Sx Class C Cement to surface.

APPROVAL VALID
FOR 90 DAYS UNLESS
DRILLING COMMENCED,
EXPIRES 11-8-80

IN ABOVE SPACE DESCRIBE PROPOSED PROGRAM: IF PROPOSAL IS TO DEEPEN OR PLUG BACK, GIVE DATA ON PRESENT PRODUCTIVE ZONE AND PROPOSED NEW PRODUCTIVE ZONE. GIVE BLOWOUT PREVENTER PROGRAM, IF ANY.

I hereby certify that the information above is true and complete to the best of my knowledge and belief.

Signed T. J. Ditcher Title Agent Date 8-6-80

(This space for State Use)

APPROVED BY W. A. Gresser TITLE SUPERVISOR, DISTRICT II DATE AUG 8 1980

CONDITIONS OF APPROVAL, IF ANY:

Cement must be circulated to
surface behind 5 1/2" casing

Notify N.M.O.C.C. in sufficient
time to witness cementing
the 5 1/2" casing

MEXICO OIL CONSERVATION COMMISSION
WELL LOCATION AND ACREAGE DEDICATION PLAT

Form C-102
 Supersedes C-128
 Effective 1-1-65

All distances must be from the outer boundaries of the Section.

Operator JFG ENTERPRISES			Lease Camille		Well No. 3
Unit Letter "I"	Section 22	Township 17 S.	Range 28 E.	County Eddy	
Actual Footage Location of Well: 1650 feet from the South line and 990 feet from the East line					
Ground Level Elev. 3580.9	Producing Formation SR	Pool E. Empire y-SR		Dedicated Acreage: 40 Acres	

1. Outline the acreage dedicated to the subject well by colored pencil or hachure marks on the plat below.
2. If more than one lease is dedicated to the well, outline each and identify the ownership thereof (both as to working interest and royalty).
3. If more than one lease of different ownership is dedicated to the well, have the interests of all owners been consolidated by communitization, unitization, force-pooling, etc?
☐ Yes ☐ No If answer is "yes," type of consolidation _____

If answer is "no," list the owners and tract descriptions which have actually been consolidated. (Use reverse side of this form if necessary.) _____

No allowable will be assigned to the well until all interests have been consolidated (by communitization, unitization, forced-pooling, or otherwise) or until a non-standard unit, eliminating such interests, has been approved by the Commission.

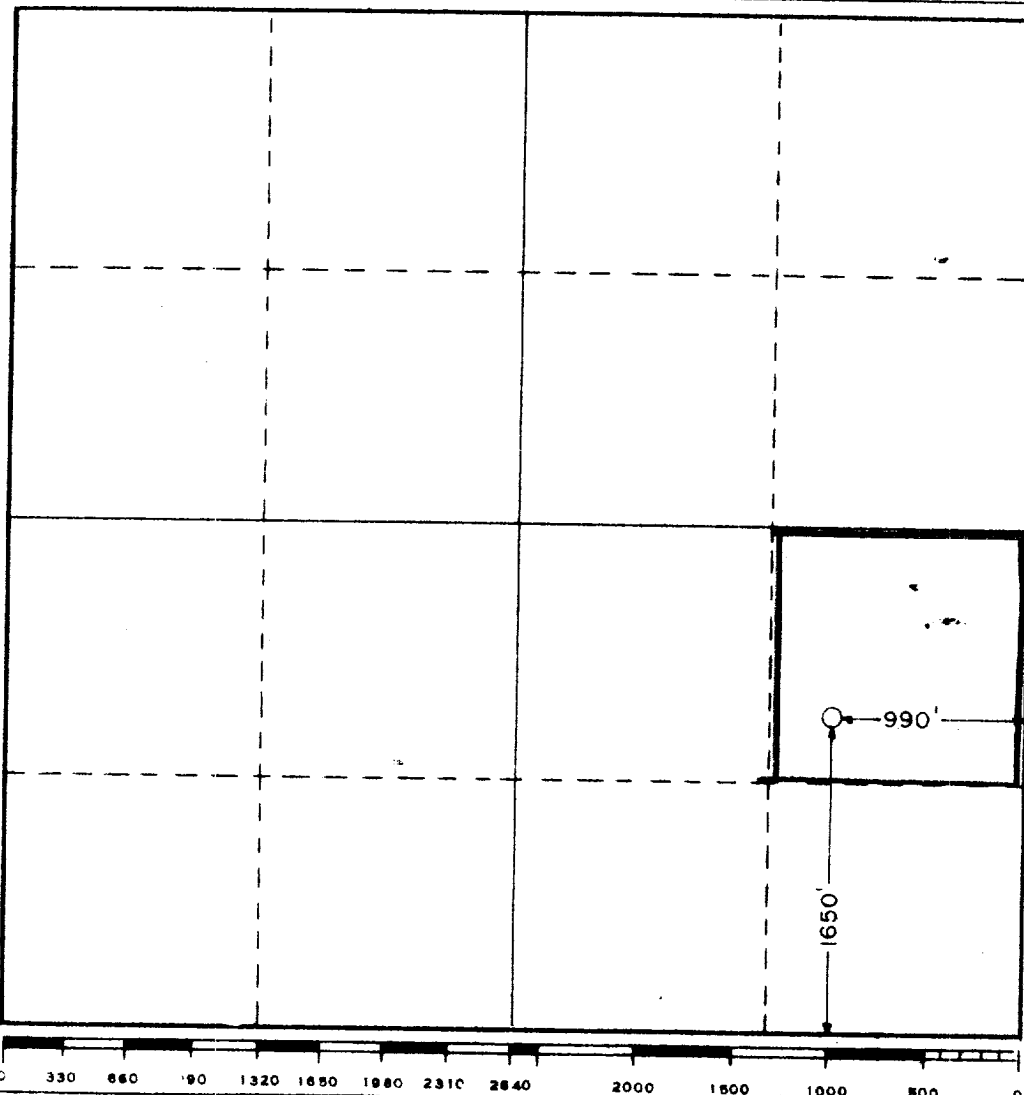

CERTIFICATION

I hereby certify that the information contained herein is true and complete to the best of my knowledge and belief.

Name **James E. Buey**
 Position **Pastor**
 Company **J. F. S. Enterprises**
 Date **Aug 6, 1980**

I hereby certify that the well location shown on this plat was plotted from field notes of actual surveys made by me or under my supervision, and that the same is true and correct to the best of my knowledge and belief.

Date Surveyed **October 1980**
HERSCHEL L. JONES
 Registered Professional Engineer
 and/or Licensed Surveyor **3640**

Certificate No. **3640**