

N.M.O.C.D. COPY

Form 9-331
(May 1963)UNITED STATES
DEPARTMENT OF THE INTERIOR
GEOLOGICAL SURVEYSUBMIT IN TRIPLICATE*
(Other instructions on re-
verse side)Form approved.
Budget Bureau No. 42-R1424.
5. LEASE DESIGNATION AND SERIAL NO.

NM 30395

6. IF INDIAN, ALLOTTEE OR TRIBE NAME

SUNDRY NOTICES AND REPORTS ON WELLS

(Do not use this form for proposals to drill or to deepen or plug back to a different reservoir.
Use "APPLICATION FOR PERMIT—" for such proposals.)1. OIL WELL ☐ GAS WELL ☒ OTHER

2. NAME OF OPERATOR

Gulf Oil Corporation

3. ADDRESS OF OPERATOR

P. O. Box 670, Hobbs, NM 88240

4. LOCATION OF WELL (Report location clearly and in accordance with any State requirements.
See also space 17 below.)
At surface

2525' FNL & 1980' FEL

14. PERMIT NO.

15. ELEVATIONS (Show whether DF, RT, GR, etc.)

3592' GL

7. UNIT AGREEMENT NAME

8. FARM OR LEASE NAME

Callaway Federal

9. WELL NO.

2

10. FIELD AND POOL, OR WILDCAT

Undes, Diamond Mound

11. SEC., T., R., M., OR BLK. AND
SURVEY OR AREA

Sec 6-T16S-R28E

12. COUNTY OR PARISH 13. STATE

Eddy

NM

16. Check Appropriate Box To Indicate Nature of Notice, Report, or Other Data

NOTICE OF INTENTION TO:

TEST WATER SHUT-OFF

PULL OR ALTER CASING

FRACTURE TREAT

MULTIPLE COMPLETE

SHOOT OR ACIDIZE

ABANDON*

REPAIR WELL

CHANGE PLANS

(Other)

SUBSEQUENT REPORT OF:

WATER SHUT-OFF

FRACTURE TREATMENT

SHOOTING OR ACIDIZING

(Other)

REPAIRING WELL

ALTERING CASING

ABANDONMENT*

Location Change

(NOTE: Report results of multiple completion on Well
Completion or Recompletion Report and Log form.)17. DESCRIBE PROPOSED OR COMPLETED OPERATIONS (Clearly state all pertinent details, and give pertinent dates, including estimated date of starting any
proposed work. If well is directionally drilled, give subsurface locations and measured and true vertical depths for all markers and zones perti-
nent to this work.)

Location was moved 125' south in order to move away from gas transmission line.

RECEIVED

OCT 3 1980

O. C. D.
ARTESIA, OFFICERECEIVED
SEP 29 1980
U.S. GEOLOGICAL SURVEY
ARTESIA, NEW MEXICO

18. I hereby certify that the foregoing is true and correct

SIGNED

TITLE Area Engineer

DATE 9-26-80

(This space for Federal or State office use)

ACTING DISTRICT ENGINEER

OCT 9 1980

APPROVED BY

TITLE

DATE

CONDITIONS OF APPROVAL, IF ANY:

Form C-102
Supersedes C-128
Effective 1-1-68

Operator Gulf Oil Corporation		Lease Calloway Federal		Well No. 2
Unit Letter GJ	Section 6	Township 16 South	Range 28 East	County Eddy
Actual Footage Location of Well: 2525 feet from the north line and 1980 feet from the east line				
Ground Level Elev. 3592.0	Producing Formation Atoka	Pool Undes. Diamond Mound Atoka		Dedicated Acreage: 270.80 Acres

- No allowable will be assigned to the well until all interests have been consolidated (by communitization, unitization, forced-pooling, or otherwise) or until a non-standard unit, eliminating such interests, has been approved by the Commission.

LOT 2
15.60

LOT 1
15.20

LOT 7
40

LOT 8
40

LOT 10
40

LOT 9
40

LOT 15
40

LOT 16
40

1980'

5034'

PATRICK A. ROMERO
NEW MEXICO
6663
REGISTERED LAND SURVEYOR

Certificate No.	JOHN W. WEST	678
	PATRICK A. ROMERO	6883
	Ronald J. Eideon	3239

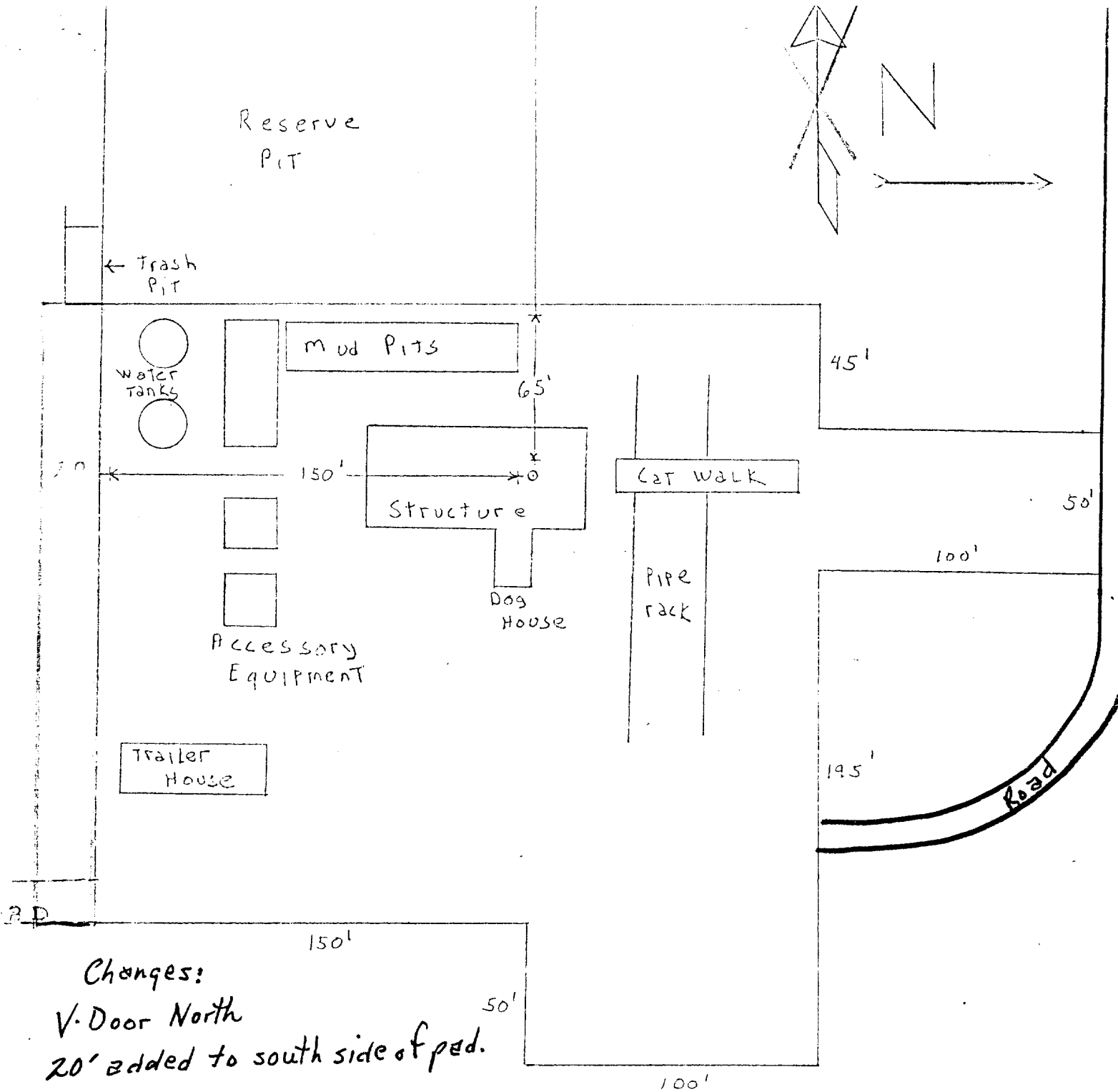

Exhibit C
Callaway Fed #2
Sec 6 T16S, R28E
Eddy Co, New Mexico
Drilling Pad layout

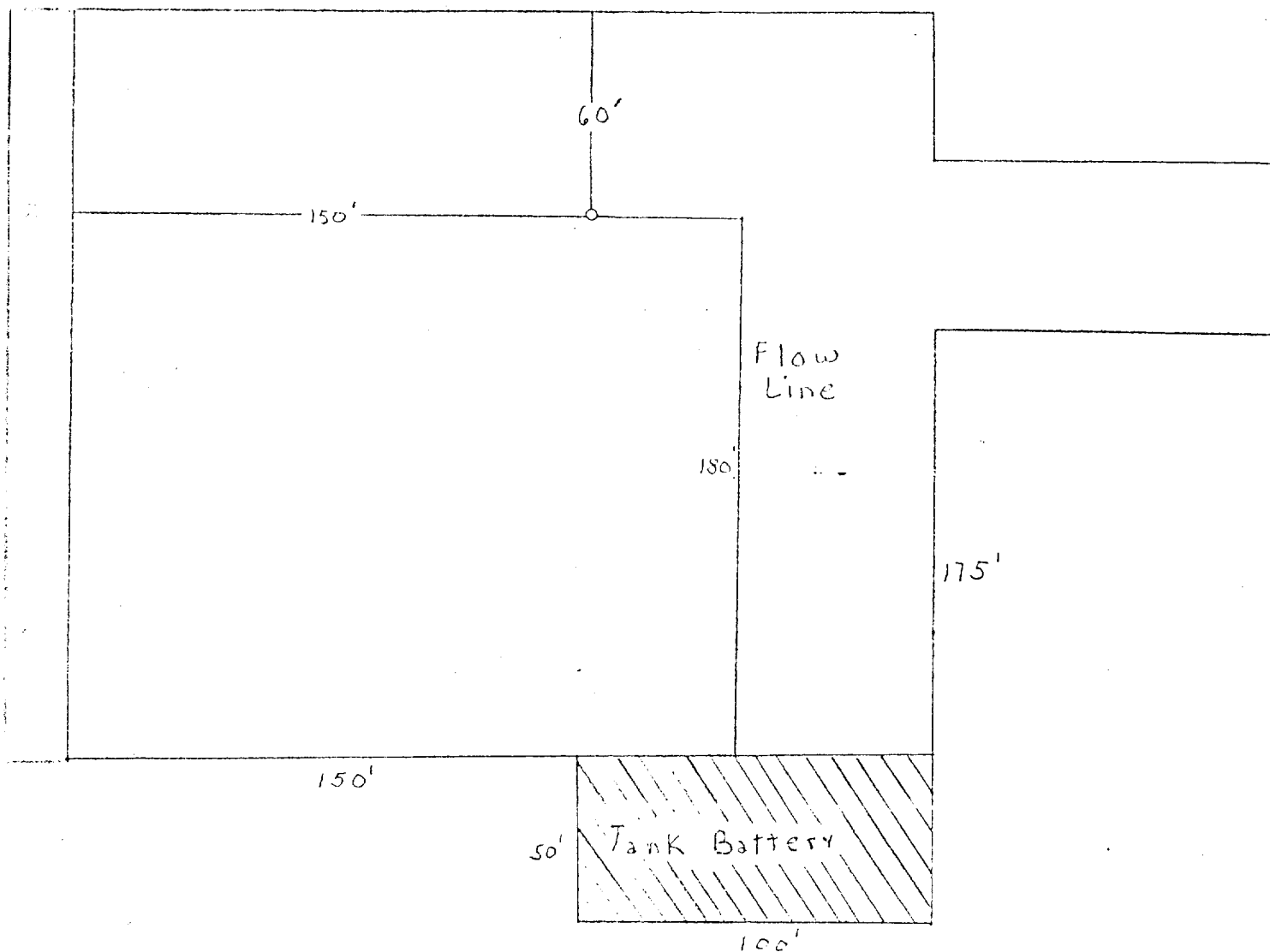

Exhibit "D"
Callaway Fed #2
Sec 6, T 16 S, R 28 E
Eddy Co, New Mexico
Drilling Pad Layout