

UNITED STATES
DEPARTMENT OF THE INTERIOR
GEOLOGICAL SURVEY

APPLICATION FOR PERMIT TO DRILL, DEEPEN, OR PLUG BACK

1a. TYPE OF WORK

DRILL ☒DEEPEN ☐PLUG BACK ☐

b. TYPE OF WELL

OIL
WELL ☒GAS
WELL ☐

OTHER

SINGLE
ZONE ☒MULTIPLE
ZONE ☐

2. NAME OF OPERATOR

C. E. LaRue and B. N. Muncy, Jr.

3. ADDRESS OF OPERATOR

P. O. Box 196 Artesia, New Mexico 88210

4. LOCATION OF WELL (Report location clearly and in accordance with any State requirements.)

At surface

330' FNL and 330' FWL Section 19, T16S, R31E.

At proposed prod. zone

14. DISTANCE IN MILES AND DIRECTION FROM NEAREST TOWN OR POST OFFICE*

8 Miles Northeast of Loco Hills, New Mexico

15. DISTANCE FROM PROPOSED*

LOCATION TO NEAREST
PROPERTY OR LEASE LINE, FT.
(Also to nearest drlg. unit line, if any)

330'

16. NO. OF ACRES IN LEASE

80

17. NO. OF ACRES ASSIGNED
TO THIS WELL

40

18. DISTANCE FROM PROPOSED LOCATION*
TO NEAREST WELL, DRILLING, COMPLETED,
OR APPLIED FOR, ON THIS LEASE, FT.

19. PROPOSED DEPTH

3750

20. ROTARY OR CABLE TOOLS

ROTARY

21. ELEVATIONS (Show whether DF, RT, GR, etc.)

3892.3' GL

22. APPROX. DATE WORK WILL START*

NOVEMBER 15, 1980

23.

PROPOSED CASING AND CEMENTING PROGRAM

SIZE OF HOLE	SIZE OF CASING	WEIGHT PER FOOT	SETTING DEPTH	QUANTITY OF CEMENT
12 1/4"	8 5/8"	29#	450'	Circulated
7 7/8"	4 1/2"	10 1/2#	3700'	

Estimated Tops; Yates 1450, Seven Rivers 1640, Queen 2280,
Penrose 2550, San Andres 3000, Lovington 3100. Adequate
BOP will be used.

RECEIVED

NOV 24 1980

O. C. D.
ARTESIA, OFFICE

RECEIVED

OCT 24 1980

U.S. GEOLOGICAL SURVEY
ARTESIA, NEW MEXICO

IN ABOVE SPACE DESCRIBE PROPOSED PROGRAM: If proposal is to deepen or plug back, give data on present productive zone and proposed new productive zone. If proposal is to drill or deepen directionally, give pertinent data on subsurface locations and measured and true vertical depths. Give blowout preventer program, if any.

24.

SIGNED

TITLE

Operator

DATE October 8, 1980

(This space for Federal or State office use)

PERMIT NO.

APPROVAL DATE

APPROVED BY GEORGE H. STEWART

TITLE

DATE NOV 21 1980

CONDITIONS OF APPROVAL, IF ANY:

*See Instructions On Reverse Side

NEW MEXICO OIL CONSERVATION COMMISSION
WELL LOCATION AND ACREAGE DEDICATION PLAT

Form C-102
Supersedes C-128
Effective 1-1-65

All distances must be from the outer boundaries of the Section.

Operator C.E. La Rue and B.N. Muncy, Jr.		Lease Welch Fed.		Well No. 1
Unit Letter D	Section 19	Township 16 South	Range 31 East	County Eddy
Actual Footage Location of Well: 330 feet from the North line and 330 feet from the West line				
Ground Level Elev. 3892.3	Producing Formation San Andres	Pool Und. Henshaw (Q,G,SA)	Dedicated Acreage 30.16	

- Outline the acreage dedicated to the subject well by colored pencil or hatchure marks on the plat below.
- If more than one lease is dedicated to the well, outline each and identify the ownership thereof (both as to working interest and royalty).
- If more than one lease of different ownership is dedicated to the well, have the interests of all owners been consolidated by communitization, unitization, force-pooling, etc?

☐ Yes ☐ No If answer is "yes," type of consolidation _____

If answer is "no," list the owners and tract descriptions which have actually been consolidated. (Use reverse side of this form if necessary.) _____

No allowable will be assigned to the well until all interests have been consolidated (by communitization, unitization, forced-pooling, or otherwise) or until a non-standard unit, eliminating such interests, has been approved by the Commission.

		<p align="center">RECEIVED</p> <p align="center">OCT 24 1980</p> <p align="center">U.S. GEOLOGICAL SURVEY ARTESIA, NEW MEXICO</p>	

CERTIFICATION

I hereby certify that the information contained herein is true and complete to the best of my knowledge and belief.

Name **B.N. Muncy, Jr.**
Operator

Company **C.E. LaRue and B.N. Muncy, Jr.**

Date **October 13, 1980**

I hereby certify that the well location shown on this plat was plotted from field notes of actual surveys made by me or under my supervision, and that the same is true and correct to the best of my knowledge and belief.

Date Surveyed **October 8, 1980**

Registered Professional Engineer and/or Land Surveyor

Certificate No. **JOHN W. WEST 676**
PATRICK A. ROMERO 6865
Ronald J. Eldson 3239

0 320 640 960 1280 1600 1920 2240 2560 2880 3200 3520 3840 4160 4480 4800 5120 5440 5760 6080 6400 6720 7040 7360 7680 8000 8320 8640 8960 9280 9600 0

C. E. LaRue and B. N. Muncy, Jr.

Welch Federal No. 1

330' FNL and 330' FWL, Section 19, T16S, R31E
Eddy County, New Mexico

Lease No. NM 2469

RECEIVED

OCT 24 1980

U.S. GEOLOGICAL SURVEY
ARTESIA, NEW MEXICO

1. Existing Roads - Maps showing drillsite and all existing roads are shown on Exhibit A & B, from existing road 500' of new road is planned South to location.
2. Planned Access Roads - Exhibit A shows new road to be constructed in red line. Road will be built to a maximum width of 12 feet and surfaced with caliche, with no turn-outs planned. Drainage will not be a factor as surface is sandy with no water drainage. Road design will be for drilling equipment and water haulage for drilling purposes, and for oil trucking. No culverts or special drainage features are believed necessary. Center line of new road has been staked with flagging visible from one stake to the other.
3. Existing wells are shown on Exhibit B.
4. Tank battery will be placed on edge of drilling pad, and flow lines will cross only caliche pad. All pads and access roads will be used for production and maintenance. If well is non-productive, the drilling pad and such access road as not needed to reach other location will be ripped and restored in accordance with current rules.
5. There are no rivers, creeks, lakes, ponds in the entire lease area. All water for drilling purposes will be trucked to location over present and to be constructed access roads shown on Exhibit A from the nearest water supply at Loco Hills, New Mexico.
6. Caliche pits will be the only source of material used in road and pad construction, location is shown on Exhibit A, in SW $\frac{1}{4}$ SW $\frac{1}{4}$, Section 18. All material will be hauled over present roads and roads to be constructed as shown on Exhibit A.
7. All cutting and drilling fluid will be left in pits and covered after they have dried; which should be in 4 to 6 weeks. All garbage and trash will be kept in containers, placed in trash pit as shown on Exhibit C and covered when well is completed. No well in area has produced water or oil during drilling.
8. No camps or airstrips will be constructed.
9. See Exhibit C. There will be no lining used in mud pits. All equipment and transportation will use only access roads and drilling pad. Mud will be stacked on drilling pad adjacent to mud pump. Only minor leveling and caliche cover will be needed on drilling pad. No significant cuts or fills will be required other than construction of mud pits and reserve pit. The pad and pit area have been staked.
10. At completion of drilling and completion operations, all equipment not necessary for well production will be removed, pits will be filled when dried, and trash pit will be covered when completion equipment is moved off. All access roads not needed for other producing wells or lease will be ripped and restored in accordance with current rules as will the pad if well is non-productive.
11. Area in general is rolling, with sand dunes creating the principal changes in elevation. Scrub oak is primary brush growth, with extremely scanty native grasses and fairly heavy weeds. All surface area is Federal land, as are all roads present and to be constructed. Topsoil is extremely sandy, underlaid with caliche. Land is used for grazing purposes, and is classed very low in number of livestock it will maintain because of the extremely sparse vegetation, and the fact there is no natural water above ground in the area from streams or ponds, and closest water well to this location is 1 mile Northwest. Nothing has been observed in the area that would give indication of archaeological, historical or cultural sites. There are no steep hillsides or gullies in the area where road and drilling pad are to be constructed, and no drainage or erosion problems should be encountered. Road and pit construction will require little change other than blading and spreading caliche. Wildlife in the area is typical semi-arid natives, numbers of all are considerable less than average across most of this country. The only structure in the area is a windmill 1 mile northwest.
12. Operators representative is B. N. Muncy, Jr., P. O. Box 196, Artesia, New Mexico 88210 Telephone number (505) 746-6651

C. E. LaRue and B. N. Muncy, Jr.

Welch Federal #1

Page 2

13. I hereby certify that I, or persons under my direct supervision, have inspected the proposed drill site and access route; that I'm familiar with the conditions which presently exist; that the statements made in this plan are, to the best of my knowledge, true and correct and that the work assisted with the operations proposed herein will be performed by LaRue and Muncy and its contractors and sub-contractors in conformity with this plan and the terms and conditions under which it is approved.

October 7, 1980

Date



Operator

PROPOSED
LOCATION ★

ROAD TO BE
CONSTRUCTED

—
CALICHE PIT

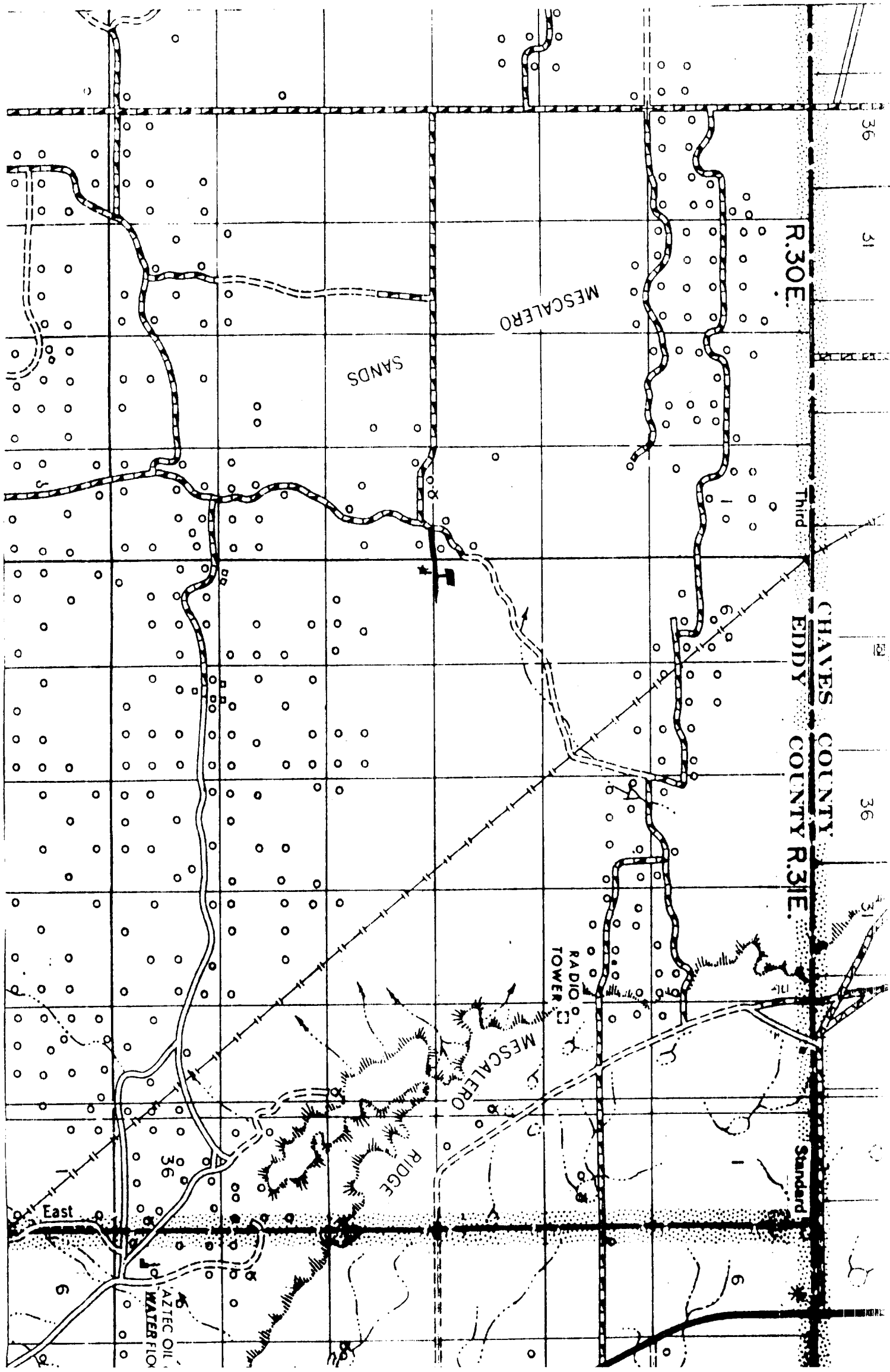

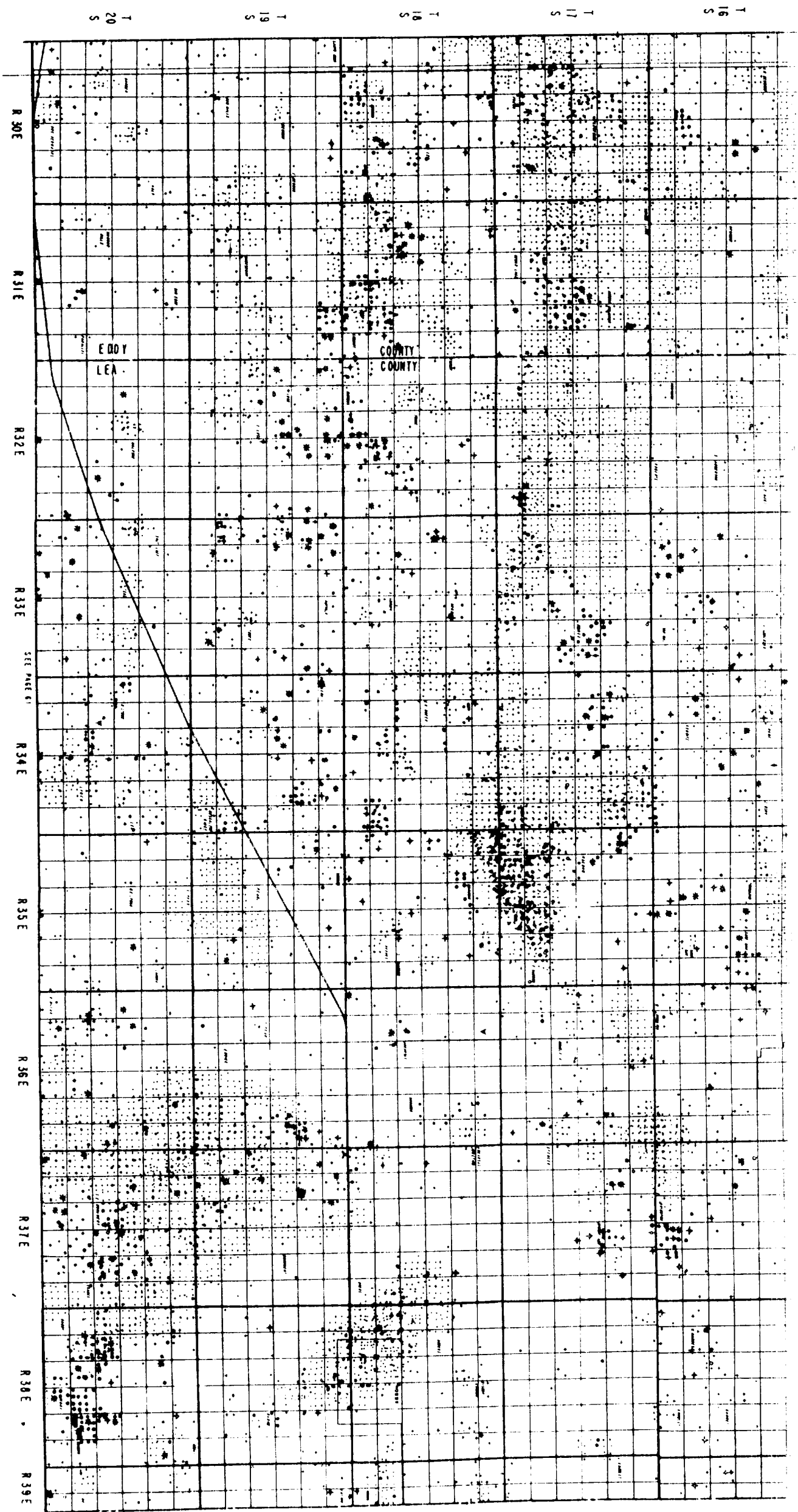

C.E. LeRue and B.N. Muncy, Jr.

WELCH FEDERAL PI

C.E. LeRue and B.M. Murray, Jr. WELCH #1 LOCATION EXHIBIT D R 316

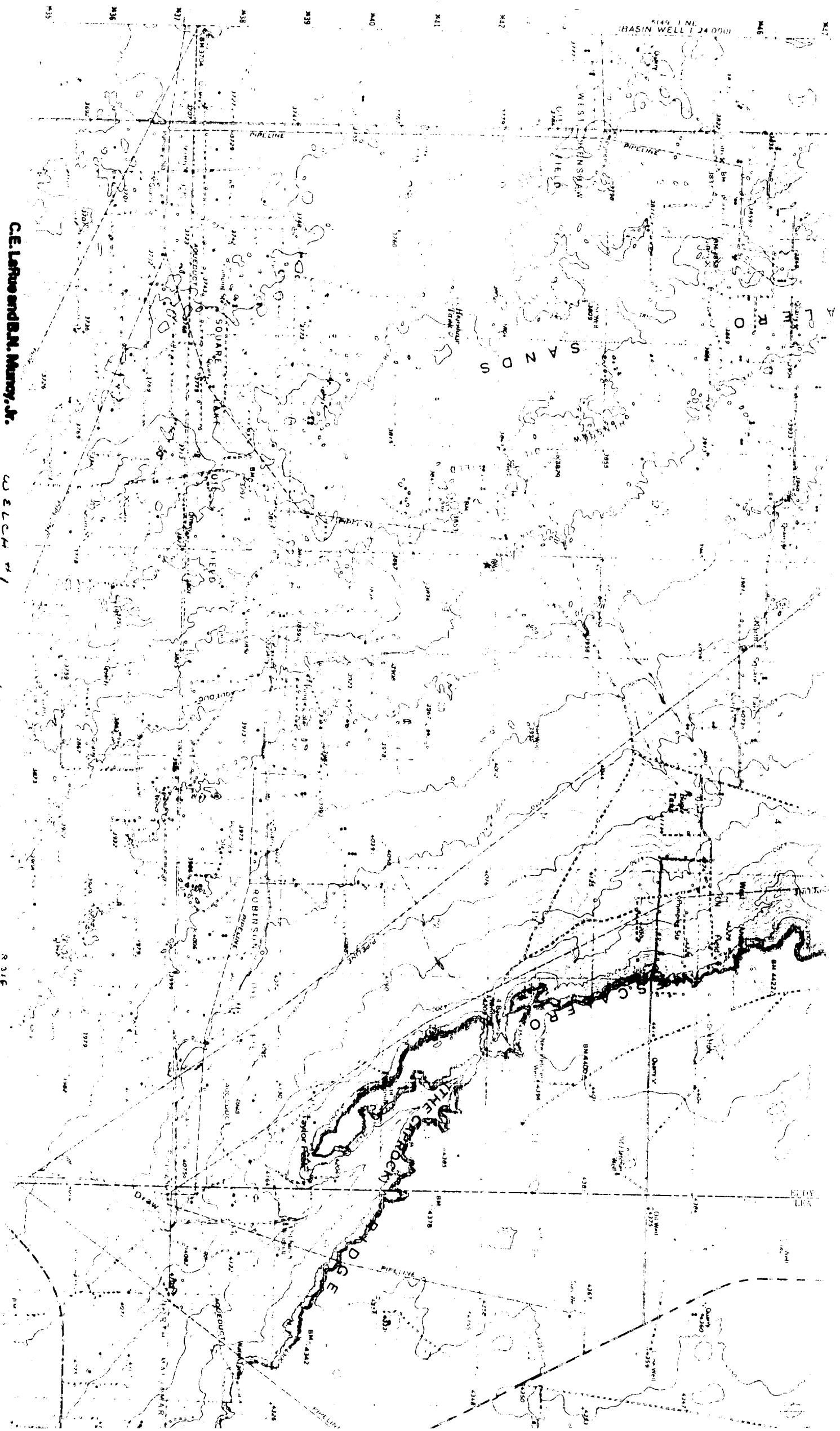

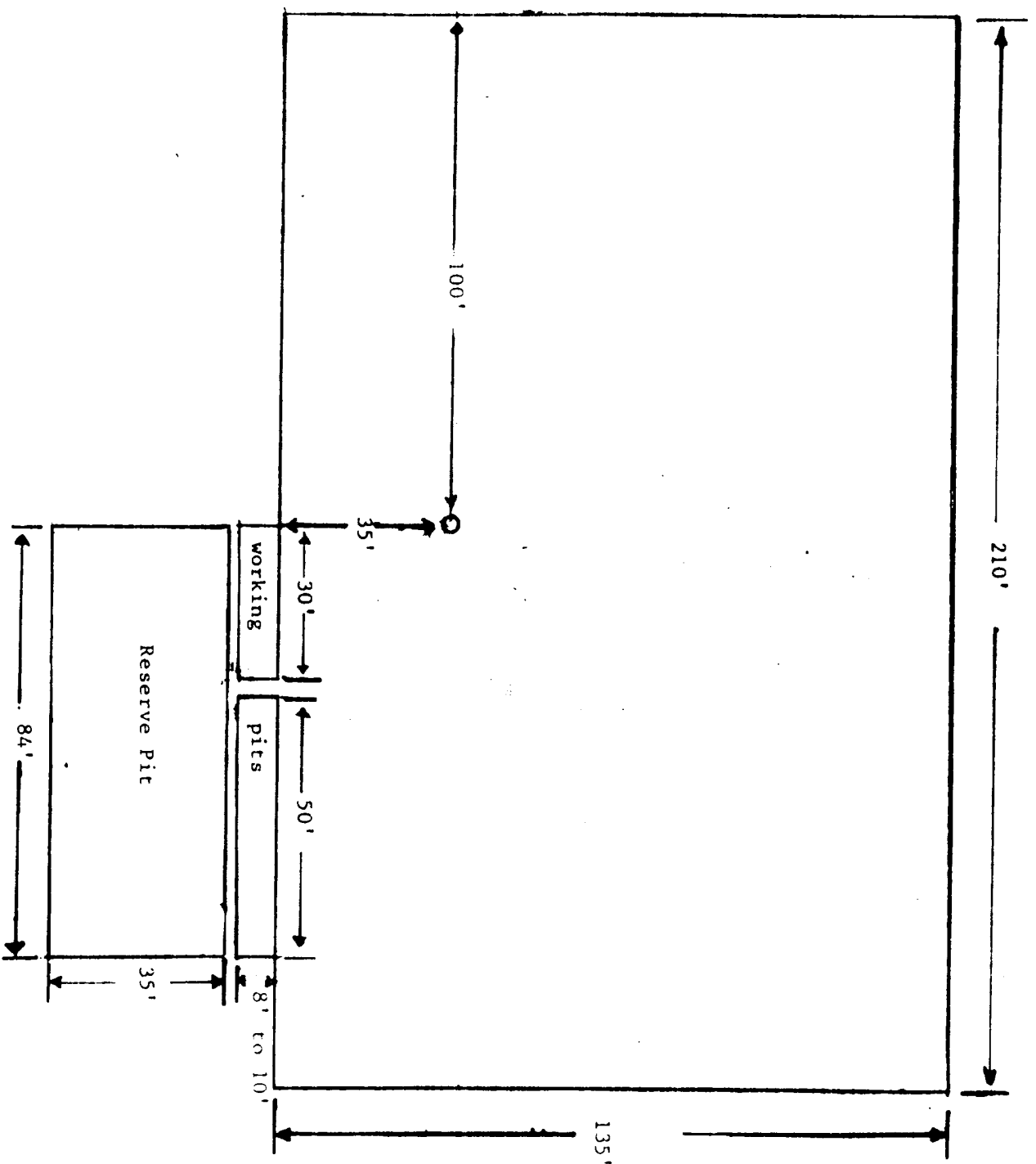

C.E. LaRue and B.N. Muncy, Jr.

USLCH RECORDS

