

NO. OF COPIES RECEIVED	6
DISTRIBUTION	
NTA FE	1
LE	✓
S.G.S.	2
AND OFFICE	1
ERATOR	1

# NEW MEXICO OIL CONSERVATION COMMISSION

RECEIVED

DEC 8 1980

O. C. D.

ARTESIA OFFICE

30-015-23568

Form C-101  
Revised 1-1-65

5A. Indicate Type of Lease STATE <input checked="" type="checkbox"/> FEE <input type="checkbox"/>
5. State Oil & Gas Lease No. B-2071
7. Unit Agreement Name
8. Farm or Lease Name NG Phillips St.
9. Well No. 13
10. Field and Pool, or Wildcat East Empire Yates SR
12. County Eddy
19. Proposed Depth 1050'
19A. Formation Seven Rivers
20. Rotary or C.T.
21. Elevations (Show whether DF, RT, etc.) 3657.5' GR
21A. Kind & Status Plug. Bond Statewide active
21B. Drilling Contractor Yucca Drilling Co.
22. Approx. Date Work will start 11/8/80

## APPLICATION FOR PERMIT TO DRILL, DEEPEN, OR PLUG BACK

1. Type of Well DRILL <input checked="" type="checkbox"/> DEEPEN <input type="checkbox"/> PLUG BACK <input type="checkbox"/>	2. Location of Well UNIT LETTER P LOCATED 965.2 FEET FROM THE South LINE
3. Address of Operator Marbob Energy Corporation P. O. Box 304, Artesia, N.M. 88210	4. Location of Well AND 978.7 FEET FROM THE East LINE OF SEC. 27 TWP. 17S RGE. 28E NMPM
5. Type of Well GAS WELL <input type="checkbox"/> OTHER <input type="checkbox"/>	6. Location of Well AND 978.7 FEET FROM THE East LINE OF SEC. 27 TWP. 17S RGE. 28E NMPM
7. Unit Agreement Name	8. Farm or Lease Name NG Phillips St.
9. Well No. 13	10. Field and Pool, or Wildcat East Empire Yates SR
12. County Eddy	19. Proposed Depth 1050'
19A. Formation Seven Rivers	20. Rotary or C.T.
21. Elevations (Show whether DF, RT, etc.) 3657.5' GR	21A. Kind & Status Plug. Bond Statewide active
21B. Drilling Contractor Yucca Drilling Co.	22. Approx. Date Work will start 11/8/80

### PROPOSED CASING AND CEMENT PROGRAM

SIZE OF HOLE	SIZE OF CASING	WEIGHT PER FOOT	SETTING DEPTH	SACKS OF CEMENT	EST. TOP
11"	8 5/8"	24#	140'	Circ.	
7 7/8"	4 1/2"	10.50#	1050'	350	

We propose to drill to approximately 1,050' to test the Seven Rivers formation. We will run 140' of 8 5/8" 24# new casing and circulate, will drill on to 1,050' of 4 1/2" 10.50# casing and cement w/350 sax.

APPROVAL VALID  
FOR 90 DAYS UNLESS  
DRILLING COMMENCED,

EXPIRES 3-9-81

IN ABOVE SPACE DESCRIBE PROPOSED PROGRAM: IF PROPOSAL IS TO DEEPEN OR PLUG BACK, GIVE DATA ON PRESENT PRODUCTIVE ZONE AND PROPOSED NEW PRODUCTIVE ZONE. GIVE BLOWOUT PREVENTER PROGRAM, IF ANY.

I hereby certify that the information above is true and complete to the best of my knowledge and belief.

*Carolyn Davis*

Title Production Clerk

Date 12/5/80

(This space for State Use)

*W. A. Gressett*

SUPERVISOR, DISTRICT II

DATE DEC 9 1980

CONDITIONS OF APPROVAL, IF ANY:

Cement to be drilled to  
surface below 8 5/8" & 4 1/2" casing

Notify N.M.C.C. of time to various casing the 4 1/2" casing

NEW MEXICO OIL CONSERVATION COMMISSION  
WELL LOCATION AND ACREAGE DEDICATION PLAT

Form C-102  
Supersedes C-128  
Effective 1-1-65

All distances must be from the outer boundaries of the Section

Operator <b>MARBOB ENERGY CORPORATION</b>			Lease <b>N. G. PHILLIPS, STATE OF NEW MEX.</b>		Well No. <b>13</b>
Unit Letter <b>P</b>	Section <b>27</b>	Township <b>17 South</b>	Range <b>28 East</b>	County <b>EDDY</b>	
Actual Footage Location of Well: <b>965.2</b> feet from the <b>South</b> line and <b>978.7</b> feet from the <b>East</b> line					
Ground Level Elev. <b>3657.5</b>	Producing Formation <b>Seven Rivers</b>		Foot <b>East Empire Yates SR</b>		Dedicated Acreage: <b>40</b> Acres

1. Outline the acreage dedicated to the subject well by colored pencil or hachure marks on the plat below.
2. If more than one lease is dedicated to the well, outline each and identify the ownership thereof (both as to working interest and royalty).
3. If more than one lease of different ownership is dedicated to the well, have the interests of all owners been consolidated by communitization, unitization, force-pooling, etc?

☐ Yes ☐ No If answer is "yes," type of consolidation \_\_\_\_\_

If answer is "no," list the owners and tract descriptions which have actually been consolidated. (Use reverse side of this form if necessary.) \_\_\_\_\_

No allowable will be assigned to the well until all interests have been consolidated (by communitization, unitization, forced-pooling, or otherwise) or until a non-standard unit, eliminating such interests, has been approved by the Commission.

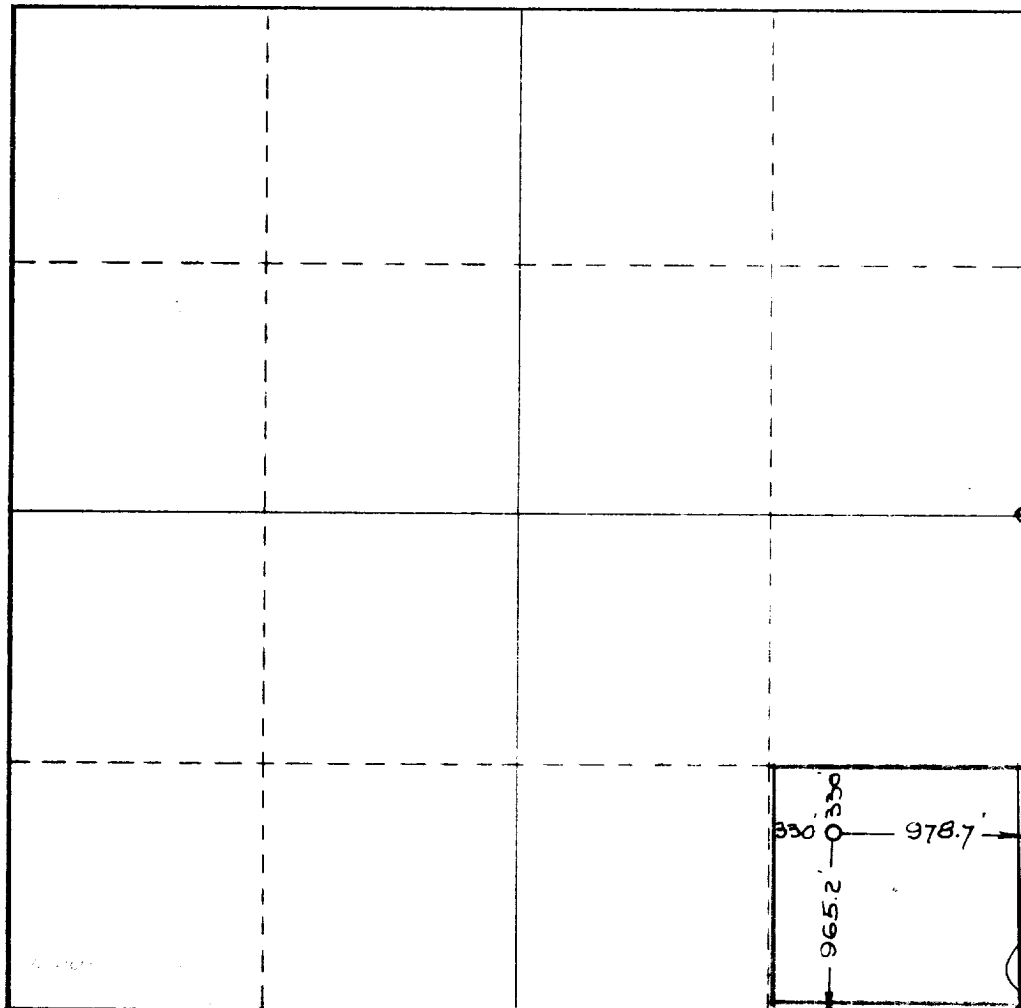

CERTIFICATION

I hereby certify that the information contained herein is true and complete to the best of my knowledge and belief.

Name  
*Norothy Hammond*  
Position  
**Gen. Mgr.**  
Company  
**Marbob Energy Corporation**  
Date  
**6/6/79**

I hereby certify that the well location shown on this plat was plotted from field notes of actual surveys made by me or under my supervision, and that the same is true and correct to the best of my knowledge and belief.

Date Surveyed **May 31 & June 1, 1979**

Registered Professional Engineer and/or Land Surveyor

*John W. Shearn*  
Certificate No. **1559**