

NO. OF COPIES RECEIVED		
DISTRIBUTION		
SANTA FE	1	
FILE	1	✓
U.S.G.S.	2	
LAND OFFICE		
OPERATOR	1	

NEW MEXICO OIL CONSERVATION COMMISSION

JAN 28 1981

ARTESIA OFFICE

30-015-23641

Form C-101
Revised 1-1-65

5A. Indicate Type of Lease	
STATE <input type="checkbox"/>	FEE <input checked="" type="checkbox"/>
5. State Oil & Gas Lease No.	
7. Unit Agreement Name	
8. Farm or Lease Name	
Zumwalt "PT"	
9. Well No.	
1	
10. Field and Pool, or Wildcat	
Wildcat San Andres	
12. County	
Eddy	
19. Proposed Depth	19A. Formation
Approx. 2200'	San Andres
20. Rotary or C.T.	
Rotary	
21. Elevations (Show whether DF, RT, etc.)	21A. Kind & Status Plug. Bond
3421	Blanket
21B. Drilling Contractor	22. Approx. Date Work will start
Artesia Fishing Tool	1-30-81

APPLICATION FOR PERMIT TO DRILL, DEEPEN, OR PLUG BACK

1a. Type of Work	
DRILL <input checked="" type="checkbox"/>	DEEPEN <input type="checkbox"/>
PLUG BACK <input type="checkbox"/>	
b. Type of Well	
OIL WELL <input checked="" type="checkbox"/>	GAS WELL <input type="checkbox"/>
OTHER <input type="checkbox"/>	
2. Name of Operator	
Yates Petroleum Corporation	
3. Address of Operator	
207 S. 4th Street, Artesia, NM 88210	
4. Location of Well	
UNIT LETTER C	LOCATED 330 FEET FROM THE North LINE
AND 2310 FEET FROM THE West	LINE OF SEC. 31 TWP. 16S RGE. 26E NMPM
21. Elevations (Show whether DF, RT, etc.)	
3421	

SIZE OF HOLE	SIZE OF CASING	WEIGHT PER FOOT	SETTING DEPTH	SACKS OF CEMENT	EST. TOP
15"	10 3/4"	32#	Approx. 400'	370 sx.	circulate
9 1/2"	7"	20#	Approx. 1250'	850 sx.	circulate
6 1/4"	4 1/2"	9.5#	TD	250 sx.	

9A. Propose to drill and test the intermediate formations. Casing will be set at least 100' below the Artesian Water Zone, and a 4 1/2" production string will be set at TD, all casing circulate to the surface. Will perforate and stimulate as needed for production.

MUD PROGRAM: F.W. gel to 1250, fresh water to TD.

BOP PROGRAM: BOP's will be installed on the 7' casing and tested, pipe rams tested daily for operational, blind rams on trips.

APPROVAL VALID FOR 180 DAYS
PERMIT EXPIRES 7-29-81
UNLESS DRILLING UNDERWAY

7-29-81 ID
API - M. B.
1-30-81

IN ABOVE SPACE DESCRIBE PROPOSED PROGRAM: IF PROPOSAL IS TO DEEPEN OR PLUG BACK, GIVE DATA ON PRESENT PRODUCTIVE ZONE AND PROPOSED NEW PRODUCTIVE ZONE. GIVE BLOWOUT PREVENTER PROGRAM, IF ANY.

I hereby certify that the information above is true and complete to the best of my knowledge and belief.

Signed Glenn R. B... Title Geographer Date Jan 28, 1981

(This space for State Use)

APPROVED BY N.A. Gressett TITLE COMMISSIONER DISTRICT II DATE JAN 29 1981

CONDITIONS OF APPROVAL, IF ANY:

Cement must be circulated to surface behind all casing

Notify N.M.O.C.C. to permit time to witness cementing the 7" casing

NE MEXICO OIL CONSERVATION COMMISSION
WELL LOCATION AND ACREAGE DEDICATION PLAT

Form C-102
Supersedes C-100
Effective 1-1-81

All distances must be from the outer boundaries of the Section.

Operator Yates Petroleum Corporation			Lease Zumwalt "PT"		Well No. 1
Unit Letter C	Section 31	Township 16S	Range 26E	County Eddy	
Actual Footage Location of Well: 330 feet from the North line and 2310 feet from the West line					
Ground Level Elev. 3421	Producing Formation SAN ANDRES		Pool UNION SAN ANDRES	Dedicated Acreage: 40 Acres	

1. Outline the acreage dedicated to the subject well by colored pencil or hatchure marks on the plat below.
2. If more than one lease is dedicated to the well, outline each and identify the ownership thereof (both as to working interest and royalty).
3. If more than one lease of different ownership is dedicated to the well, have the interests of all owners been consolidated by communitization, unitization, force-pooling, etc?

☐ Yes ☐ No If answer is "yes," type of consolidation _____

If answer is "no," list the owners and tract descriptions which have actually been consolidated. (Use reverse side of this form if necessary.) _____

No allowable will be assigned to the well until all interests have been consolidated (by communitization, unitization, forced-pooling, or otherwise) or until a non-standard unit, eliminating such interests, has been approved by the Commission.

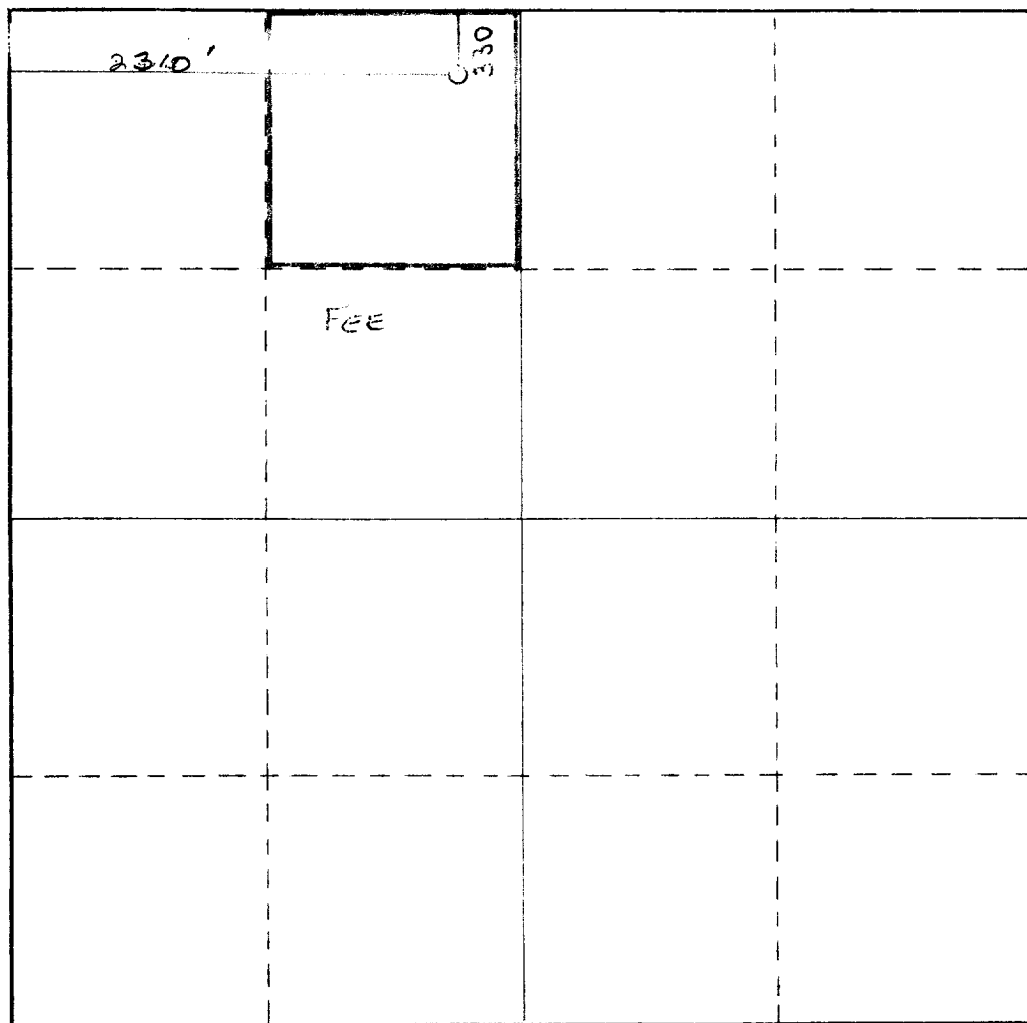

CERTIFICATION

I hereby certify that the information contained herein is true and complete to the best of my knowledge and belief.

Gliserio Rodriguez
Name
GLISERIO RODRIGUEZ
Position
GEODESIC SURVEYOR
Company
YATES PETROLEUM CORP.
Date
1-28-81

I hereby certify that the well location shown on this plat was plotted from field notes of actual surveys made by me under my supervision, and that the same is true and correct to the best of my knowledge and belief.

Date Surveyed
January 27, 1981

Registered Professional Engineer and/or Land Surveyor

Dan R. Reddy
Certificate No.

PE#LS 5412

0 330 660 990 1320 1650 1980 2310 2640 2970 3300 3630 3960 4290 4620 4950 5280 5610 5940 6270 6600

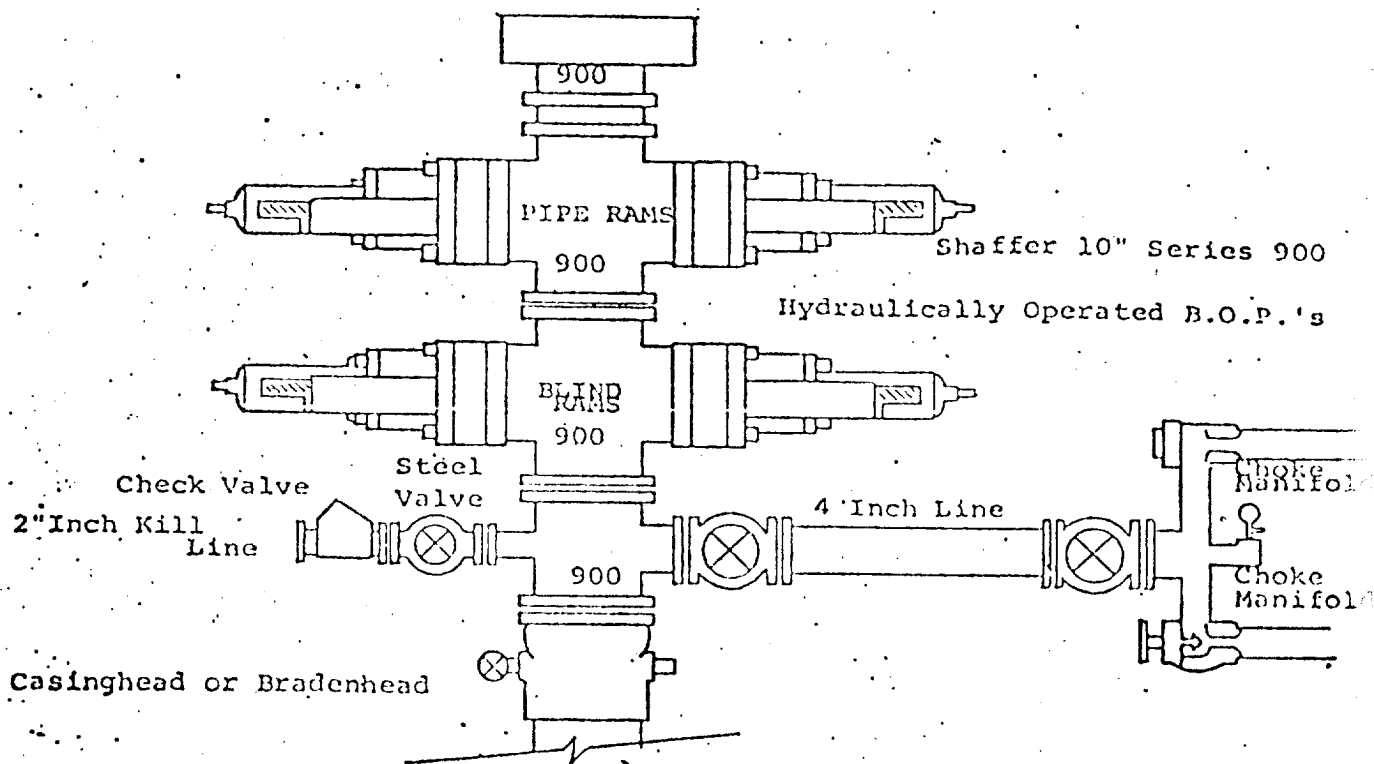

THE FOLLOWING CONSTITUTE MINIMUM BLOWOUT PREVENTER REQUIREMENTS

1. All preventers to be hydraulically operated with secondary manual controls installed prior to drilling out from under casing.
2. Choke outlet to be a minimum of 4" diameter.
3. Kill line to be of all steel construction of 2" minimum diameter.
4. All connections from operating manifolds to preventers to be all steel. hole or tube a minimum of one inch in diameter.
5. The available closing pressure shall be at least 15% in excess of that required with sufficient volume to operate the B.O.P.'s.
6. All connections to and from preventer to have a pressure rating equivalent to that of the B.O.P.'s.
7. Inside blowout preventer to be available on rig floor.
8. Operating controls located a safe distance from the rig floor.
9. Hole must be kept filled on trips below intermediate casing. Operator not responsible for blowouts resulting from not keeping hole full.
10. D. P. float must be installed and used below zone of first gas intrusion.