

NO. OF COPIES RECEIVED	
DISTRIBUTION	
SANTA FE	1
FILE	1
U.S.G.S.	2
LAND OFFICE	1
OPERATOR	1

NEW MEXICO OIL CONSERVATION COMMISSION

FEB 03 1981

36-015-23659

Form C-101
Revised 1-1-65

5A. Indicate Type of Lease

STATE ☒ FEE ☐

5. State Oil & Gas Lease No.

L-1603

APPLICATION FOR PERMIT TO DRILL, DEEPEN, OR PLUG BACK

1a. Type of Work		7. Unit Agreement Name	
b. Type of Well OIL WELL <input checked="" type="checkbox"/> GAS WELL <input type="checkbox"/> OTHER <input type="checkbox"/>		8. Farm or Lease Name State "36" New Mexico	
2. Name of Operator WILLIAM N. BEACH		9. Well No. 6	
3. Address of Operator P. O. Box 3669, Midland, TX 79702		10. Field and Pool, or Wildcat Red Lake East-Que-	
4. Location of Well UNIT LETTER A LOCATED 330' FEET FROM THE North LINE AND 981 FEET FROM THE East LINE OF SEC. 36 TWP. 16-S RGE. 28-E NMPM		12. County Eddy	
19. Proposed Depth 1900		19A. Formation Penrose	
20. Rotary or C.T. Cable Tool		21. Elevation (Show whether D.F., R.I., etc.) 3715.8 G.L.	
21A. Kind & Status Plug, Bond Blanket		21B. Drilling Contractor S & D Drilling	
22. Approx. Date Work will start Feb. 15, 1981			

23.

PROPOSED CASING AND CEMENT PROGRAM

SIZE OF HOLE	SIZE OF CASING	WEIGHT PER FOOT	SETTING DEPTH	SACKS OF CEMENT	EST. TOP
11"	8-5/8"	20#	325 *	150 sax	circ.
8"	4 1/2"	10.50#	TD	150 sax	900

* on top of salt.

Drill 11" hole to 325' or top of salt. Set 8-5/8" csg and circulate cement.

Drill plug and bail test hole.

Drill 8" hole to TD and run 4 1/2" csg and cement.

Log, perforate and stimulate to effect completion.

APPROVAL VALID FOR 180 DAYS
PERMIT EXPIRES 8-10-81
UNLESS DRILLING UNDERWAY

III. ABOVE SPACE DESCRIBE PROPOSED PROGRAM: IF PROPOSAL IS TO DEEPEN OR PLUG BACK, GIVE DATA ON PRESENT PRODUCTIVE ZONE AND PROPOSED NEW PRODUCTIVE ZONE. GIVE BLOWOUT PREVENTER PROGRAM, IF ANY.

I hereby certify that the information above is true and complete to the best of my knowledge and belief.

Signed M. L. Cherryhomes Title Clerk Date 2-3-81

(This space for State Use)

APPROVED BY W. A. Gressett TITLE SUPERVISOR, DISTRICT II DATE FEB 10 1981

CONDITIONS OF APPROVAL, IF ANY:

MEXICO OIL CONSERVATION COMMISS.
WELL LOCATION AND ACREAGE DEDICATION PLAT

Form C-102
 Supersedes C-128
 Effective 1-1-65

All distances must be from the outer boundaries of the Section

Operator William A. Beach			Lease <i>New Mexico</i> N.M. State 36		Well No. 6
Unit Letter A	Section 36	Township 16 South	Range 28 East	County Eddy	
Actual Footage Location of Well: 330 feet from the North line and 981 feet from the East line					
Ground Level Elev. 3715.8	Producing Formation QUEEN	Pool RED LAKE EAST- P-2		Dedicated Acreage: 40 Acres	

1. Outline the acreage dedicated to the subject well by colored pencil or hachure marks on the plat below.
2. If more than one lease is dedicated to the well, outline each and identify the ownership thereof (both as to working interest and royalty).
3. If more than one lease of different ownership is dedicated to the well, have the interests of all owners been consolidated by communitization, unitization, force-pooling, etc?

☐ Yes ☒ No If answer is "yes," type of consolidation _____

If answer is "no," list the owners and tract descriptions which have actually been consolidated. (Use reverse side of this form if necessary.) _____

No allowable will be assigned to the well until all interests have been consolidated (by communitization, unitization, forced-pooling, or otherwise) or until a non-standard unit, eliminating such interests, has been approved by the Commission.

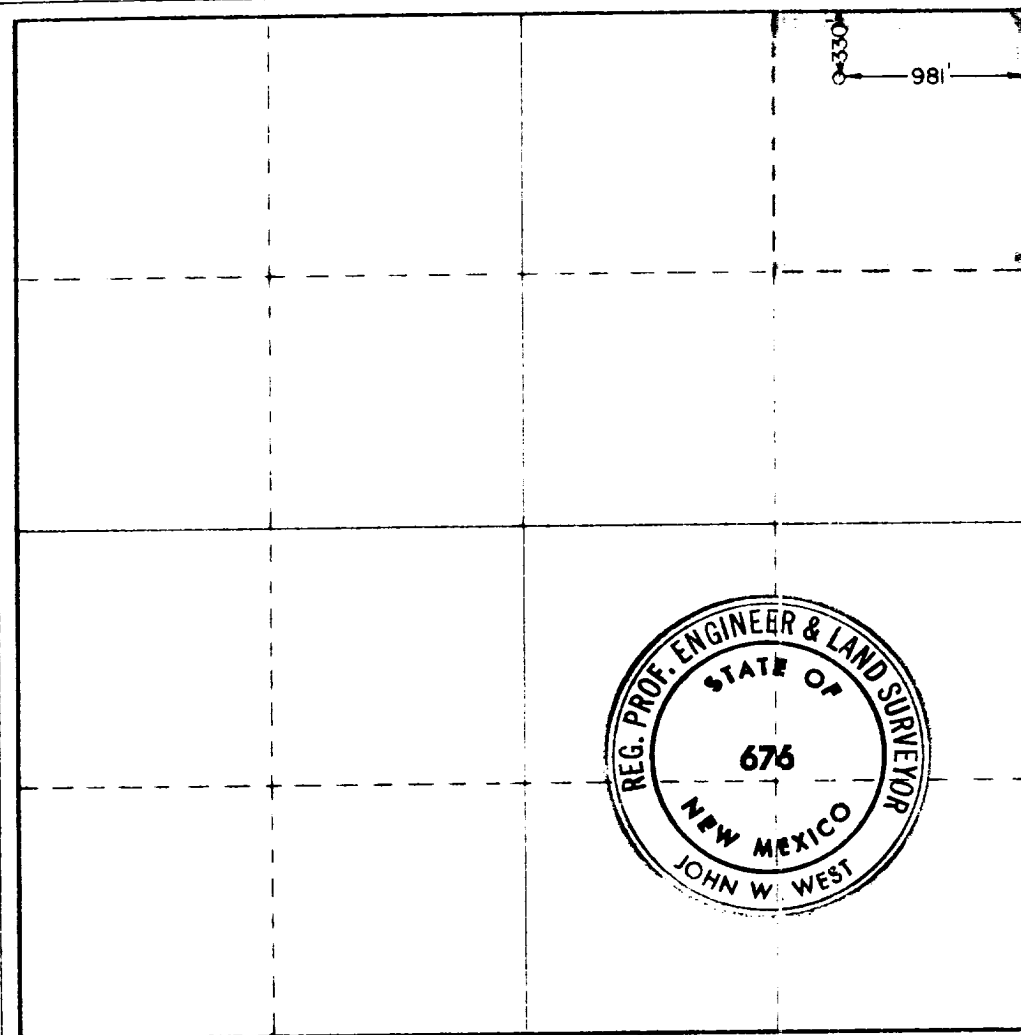

CERTIFICATION

I hereby certify that the information contained herein is true and complete to the best of my knowledge and belief.

Carl C. Beach
 Name

CARL C. BEACH

LANDMAN

WILLIAM N. BEACH

7-6-80

I hereby certify that the well location shown on this plat was plotted from field notes of actual surveys made by me or under my supervision, and that the same is true and correct to the best of my knowledge and belief.

Date Surveyed **July 1, 1980**

Registered Professional Engineer and Professional Surveyor

John W. West

Certificate No **JOHN W. WEST 676**
PATRICK A. ROMERO 6663
Ronald J. Eidson 3239

