

NO. OF COPIES RECEIVED
DISTRIBUTION
SANTA FE
FILE
N.G.S.
LAND OFFICE
OPERATOR

NEW MEXICO OIL CONSERVATION COMMISSION
AMENDED LOCATION

MAR 20 1981

30-015-23702

Form O-101
Revised 1-1-81

5A. Indicate Type of Lease
STATE ☐ FEE ☒
5. State of New Mexico Lease No.

APPLICATION FOR PERMIT TO DRILL, DEEPEN, OR PLUG BACK

6. Type of Work
a. Type of Well
DRILL ☒ DEEPEN ☐ PLUG BACK ☐
b. Type of Well
OIL ☒ GAS ☐ WATER ☐ SINGLE ZONE ☐ MULTIPLE ZONE ☐
c. Name of Operator
Yates Petroleum Corporation
d. Address of Operator
207 South 4th Street, Artesia, New Mexico 88210
e. Location of Well
UNIT LETTER J LOCATED 2170 FEET FROM THE south LINE
1650 FEET FROM THE east LINE OF SEC. 30 TWP. 16S RGE. 26E NMPM
f. Elevation (Show whether D.P., R.T., etc.)
3403' GL
g. Blanket
Blanket
h. Proposed Depth
approx. 1650'
i. Formation
San Andres
j. Rotary or C.T.
Rotary
k. Preliminary Contractor
Artesia Fishing Tool
l. Approx. Date Work will start
ASAP

PROPOSED CASING AND CEMENT PROGRAM

SIZE OF HOLE	SIZE OF CASING	WEIGHT PER FOOT	SETTING DEPTH	SACKS OF CEMENT	EST. TOP
15"	10 3/4"	32#	approx. 400'	370 sx.	circulate
9 1/2"	7"	20#	approx. 1250'	850 sx	circulate
6 1/4"	4 1/2"	9.5#	TD	250 sx	

Propose to drill and test the SA intermediate formations. Casing will be set at least 100' below the Artesian water zone, and a 4 1/2" production string will be set at TD, all casing will be circulated to the surface. Will perforate and stimulate as needed for production.

WED PROGRAM: F.W. gel to 1250, fresh water to TD.

BOP PROGRAM: BOP's will be installed on the 7" casing and tested, pipe rams tested daily for operational, blind rams on trips.

ABOVE SPACE DESCRIBE PROPOSED PROGRAM: IF PROPOSAL IS TO DEEPEN OR PLUG BACK, GIVE DATA ON PRESENT PRODUCTIVE ZONE AND PROPOSED NEW PRODUCTION ZONE. GIVE BLOWOUT PREVENTER PROGRAM, IF ANY.

I hereby certify that the information above is true and complete to the best of my knowledge and belief.

by Glenn R. Roberts Title Geographer Date 3/20/81

(This space for State Use)

APPROVED BY W. A. Gressett TITLE SUPERVISOR, DISTRICT II DATE MAR 24 1981

ADDITIONS OF APPROVAL, IF ANY:

NEW MEXICO OIL CONSERVATION COMMISSION
WELL LOCATION AND ACREAGE DEDICATION PLAT

Form C-102
Supersedes C-128
Effective 1-1-65

All distances must be from the outer boundaries of the Section.

Yates Petroleum Corporation			Lease Havins "OK"		Well No. 1
Section J	Section 30	Township 16	Range 26	County Eddy	

Well Footage Location of Well:

2170 feet from the South line and 1650 feet from the East line	Well Elevation 3403	Formation SAN ANDRES	Pool UNPROD SAN ANDRES	Dedicated Acreage: 40 Acres
--	---------------------	----------------------	------------------------	-----------------------------

- Outline the acreage dedicated to the subject well by colored pencil or hachure marks on the plat below.
- If more than one lease is dedicated to the well, outline each and identify the ownership thereof (both as to working interest and royalty).
- If more than one lease of different ownership is dedicated to the well, have the interests of all owners been consolidated by communitization, unitization, force-pooling, etc?

☒ Yes ☐ No If answer is "yes" type of consolidation TO BE COMMUNITIZED

If answer is "no," list the owners and tract descriptions which have actually been consolidated. (Use reverse side of this form if necessary.)

No allowable will be assigned to the well until all interests have been consolidated (by communitization, unitization, forced-pooling, or otherwise) or until a non-standard unit, eliminating such interests, has been approved by the Commission.

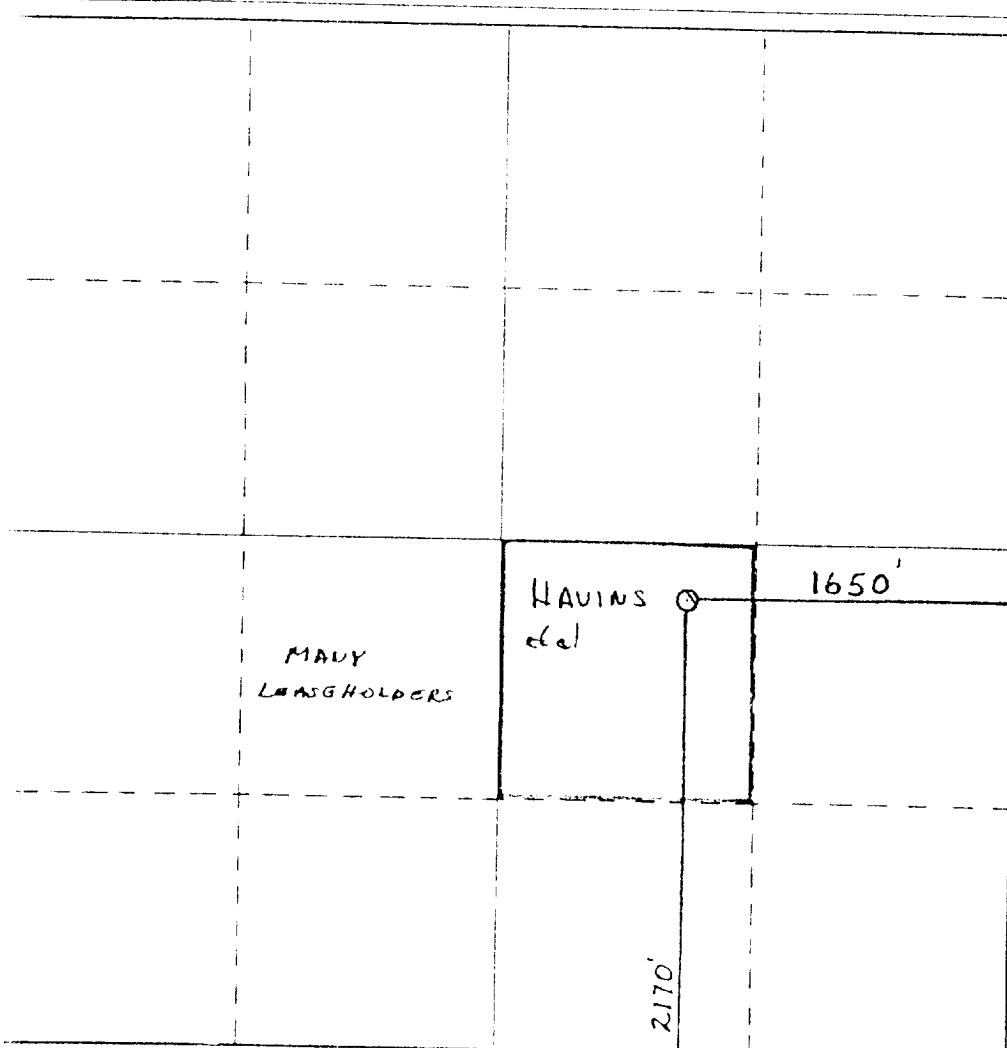

CERTIFICATION

I hereby certify that the information contained herein is true and complete to the best of my knowledge and belief.

Name Gliserio Rodriguez
Position Geographer
Company Yates Petroleum Corporation

Date March 13, 1981

I hereby certify that the well location shown on this plat was plotted from field notes of actual surveys made by me or under my supervision, and that the same is true and correct to the best of my knowledge and belief.

Date Surveyed March 12, 1981
Registered Professional Engineer and/or Land Surveyor

Dan R. Reddy
Certificate No. NM PE&LS #5412