

STATE OF NEW MEXICO  
ENERGY AND MINERALS DEPARTMENT

OIL CONSERVATION DIVISION

P. O. BOX 2088

SANTA FE, NEW MEXICO 87501

Form C-101  
Revised 10-1-78

30-015-23863

NO. OF COPIES RECEIVED	
DISTRIBUTION	
SANTA FE	
FILE	
U.S.G.S.	
LAND OFFICE	
OPERATOR	

O. C. D.  
ARTESIA OFFICE

APPLICATION FOR PERMIT TO DRILL, DEEPEN, OR PLUG BACK

Type of Work

DRILL ☒

DEEPEN ☐

PLUG BACK ☐

Type of Well

OIL WELL ☒

GAS WELL ☐

OTHER

SINGLE ZONE ☒

MULTIPLE ZONE ☐

Name of Operator

Marbob Energy Corporation

Address of Operator

P.O. Box 304, Artesia, N.M. 88210

Location of Well

UNIT LETTER A LOCATED 966.5 FEET FROM THE North LINE

653.4 FEET FROM THE East LINE OF SEC. 27 TWP. 17S RGE. 28E

5A. Indicate Type of Lease

STATE ☒

FEE ☐

5. State Oil & Gas Lease No.

B-2071

7. Unit Agreement Name

8. Farm or Lease Name

Gillespie St.

9. Well No.

1

10. Field and Pool, or Whichever

Red Lake On Grbg SA

12. County

Eddy

18. Proposed Depth

3500'

19A. Formation

San Andres

19B. Rotary or C.T.

Rotary

19C. Depth of hole (Feet, ft., etc.)

3589' GR

21A. Kind & Status Prop. Lease

Statewide active

21B. Drilling Contractor

WEK Drilling Co.

22. Approx. Date work will start

7/9/81

PROPOSED CASING AND CEMENT PROGRAM

SIZE OF HOLE	SIZE OF CASING	WEIGHT PER FOOT	SETTING DEPTH	SACKS OF CEMENT	EST. TOP
12 1/4"	8 5/8"	24#	500'	Circulate	
7 7/8"	4 1/2"	10.50#	3500'	650 attempt to circulate	

We propose to drill to 500', set 8 5/8" casing, drill on to 3500' to test the San Andres formation, set 4 1/2" casing and cement.

APPROVAL VALID FOR 180 DAYS  
PERMIT EXPIRES 1-9-82  
UNLESS DRILLING UNDERWAY

BELOW SPACE DESCRIBE PROPOSED PROGRAM: IF PROPOSAL IS TO DEEPEN OR PLUG BACK, GIVE DATA ON PRESENT PRODUCTIVE ZONE AND PROPOSED NEW PRODUCTION ZONE. GIVE BLOWOUT PREVENTER PROGRAM, IF ANY.

I hereby certify that the information above is true and complete to the best of my knowledge and belief.

*Carolee Ann*

Title Production Clerk

Date 7/7/81

(This space for State Use)

APPROVED BY

*W. A. Gressett*

TITLE SUPERVISOR, DISTRICT II

DATE

7-9-81

REASONS OF APPROVAL, IF ANY:

**MEXICO OIL CONSERVATION COMMISSION  
WELL LOCATION AND ACREAGE DEDICATION PLAT**

Form C-102  
Supersedes C-128  
Effective 1-1-65

All distances must be from the outer boundaries of the Section.

Operator <b>MARBOB ENERGY CORPORATION</b>			Lease <b>GILLESPIE STATE</b>		Well No. <b>1</b>
Unit Letter <b>A</b>	Section <b>27</b>	Township <b>17 South</b>	Range <b>28 East</b>	County <b>Eddy</b>	
Actual Footage Location of Well: <b>966.5</b> feet from the <b>North</b> line and <b>653.4</b> feet from the <b>East</b> line					
Ground Level Elev. <b>3589</b>	Producing Formation <b>San Andres</b>		Pool <b>Red Lake Qn Grbg SA</b>		Dedicated Acreage: <b>40</b> Acres

1. Outline the acreage dedicated to the subject well by colored pencil or hachure marks on the plat below.
2. If more than one lease is dedicated to the well, outline each and identify the ownership thereof (both as to working interest and royalty).
3. If more than one lease of different ownership is dedicated to the well, have the interests of all owners been consolidated by communitization, unitization, force-pooling, etc?

☐ Yes    ☐ No    If answer is "yes," type of consolidation \_\_\_\_\_

If answer is "no," list the owners and tract descriptions which have actually been consolidated. (Use reverse side of this form if necessary.) \_\_\_\_\_

No allowable will be assigned to the well until all interests have been consolidated (by communitization, unitization, forced-pooling, or otherwise) or until a non-standard unit, eliminating such interests, has been approved by the Commission.

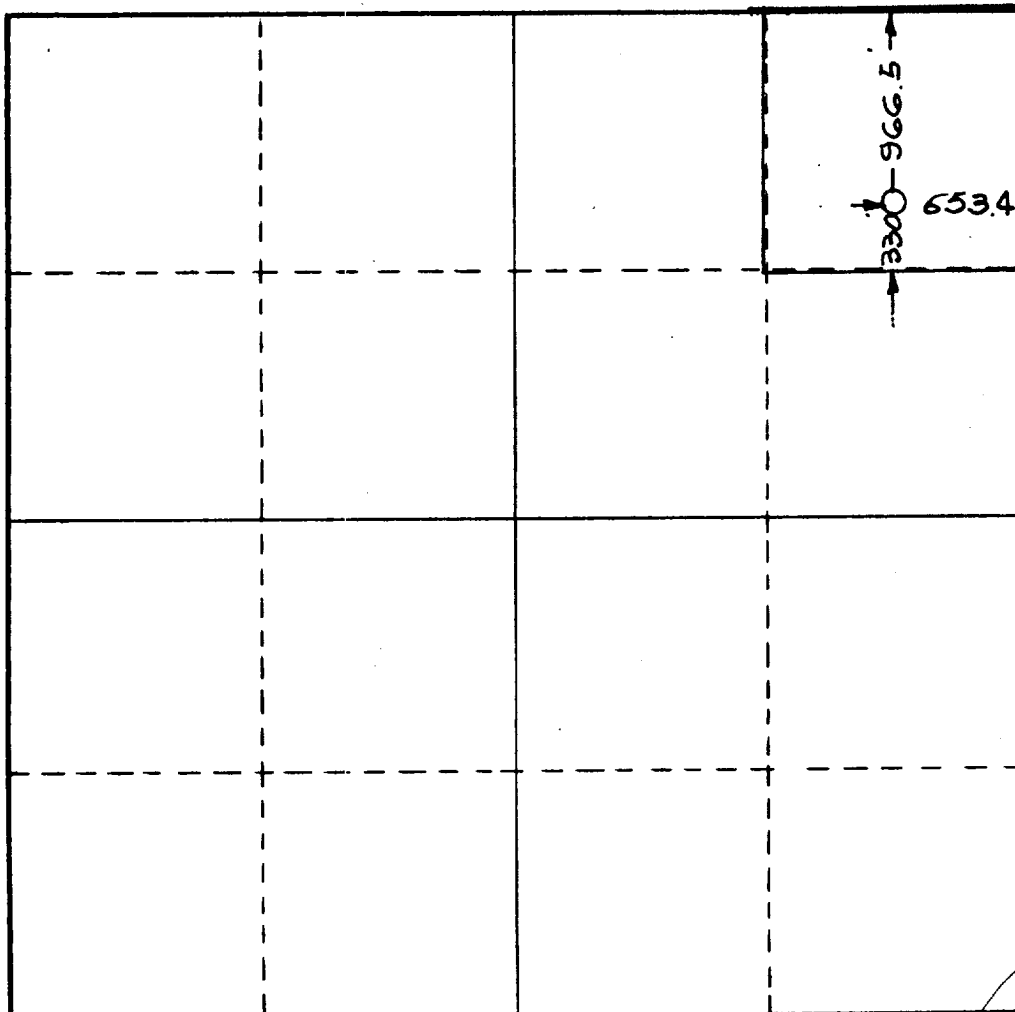

**CERTIFICATION**

I hereby certify that the information contained herein is true and complete to the best of my knowledge and belief.

*Carolyn Orris*  
Name

Carolyn Orris

Position  
Production Clerk

Company  
Marbob Energy Corp.

Date  
7/7/81

I hereby certify that the well location shown on this plat was plotted from field notes of actual surveys made by me or under my supervision, and that the same is true and correct to the best of my knowledge and belief.

Date Surveyed  
June 19, 1981

Registered Professional Engineer  
and/or Land Surveyor

*W. W. Shearn*  
Certificate No.

1559

