

**MEXICO OIL CONSERVATION COMMISSION
WELL LOCATION AND ACREAGE DEDICATION PLAT**

Form C-102
Supersedes C-128
Effective 1-1-65

All distances must be from the outer boundaries of the Section

Operator TXO PRODUCTION CORP.			Lease EMPIRE STATE COM.		Well No. 1
Unit Letter M	Section 20	Township 17 South	Range 28 East	County Eddy	
Actual Footage Location of Well:					
660 feet from the South line and		660 feet from the West line			
Ground Level Elev. 3563.8	Producing Formation PENN	Pool EMPIRE (PENN)		Dedicated Acreage: 320 Acres	

1. Outline the acreage dedicated to the subject well by colored pencil or hachure marks on the plat below.
2. If more than one lease is dedicated to the well, outline each and identify the ownership thereof (both as to working interest and royalty).
3. If more than one lease of different ownership is dedicated to the well, have the interests of all owners been consolidated by communitization, unitization, force-pooling, etc?

☒ Yes ☐ No If answer is "yes," type of consolidation **CURRENTLY BEING COMMUNITIZED**

If answer is "no," list the owners and tract descriptions which have actually been consolidated. (Use reverse side of this form if necessary.) _____

No allowable will be assigned to the well until all interests have been consolidated (by communitization, unitization, forced-pooling, or otherwise) or until a non-standard unit, eliminating such interests, has been approved by the Commission.

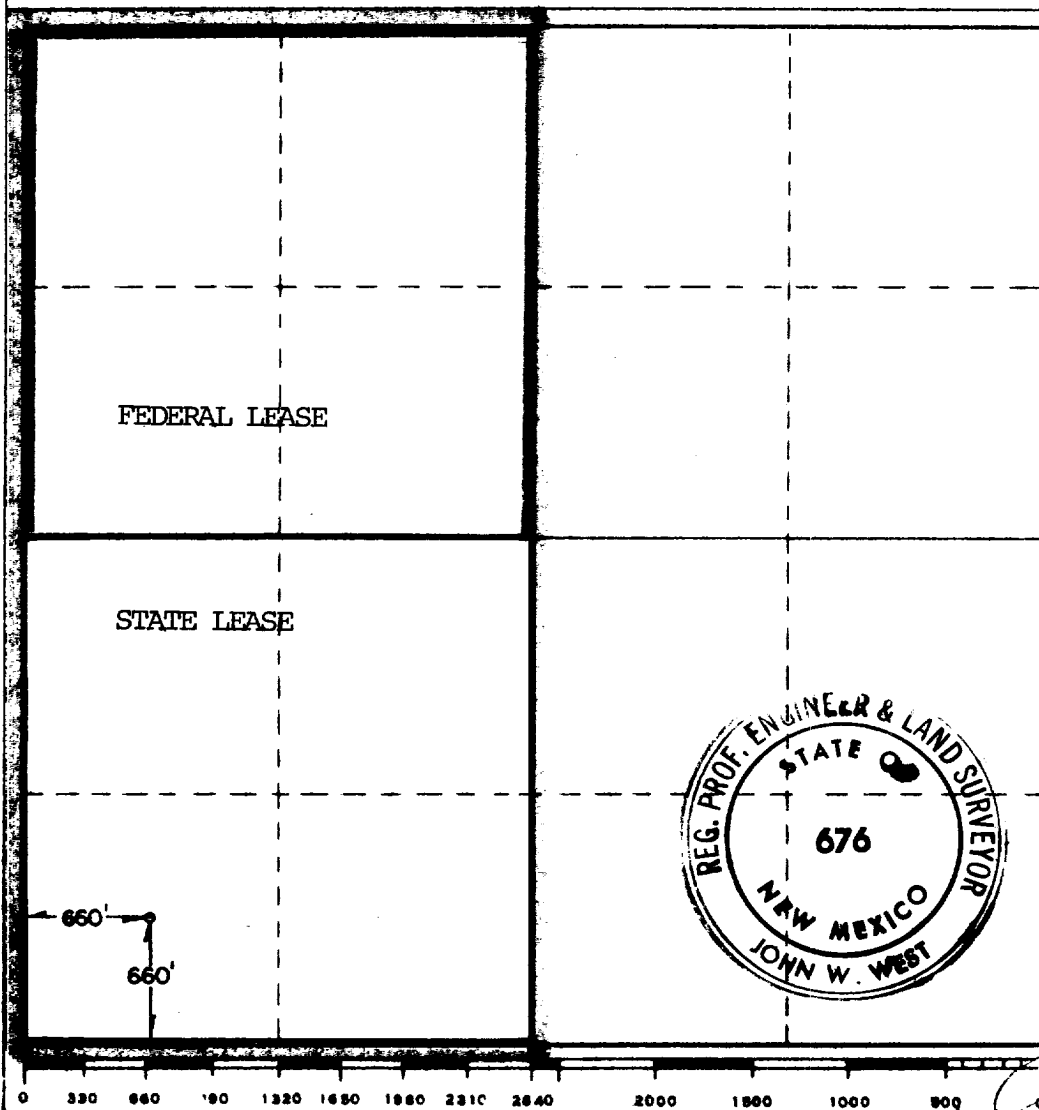

CERTIFICATION	
I hereby certify that the information contained herein is true and complete to the best of my knowledge and belief.	
FRIEDA CRAWFORD	
Name	ENGINEERING ASS'T
Position	TXO PRODUCTION CORP.
Company	NOVEMBER 13, 1981
Date	<i>Frieda Crawford</i>
I hereby certify that the well location shown on this plat was plotted from field notes of actual surveys made by me or under my supervision, and that the same is true and correct to the best of my knowledge and belief.	
Date Surveyed	9/25/81
Registered Professional Engineer and/or Land Surveyor	
<i>John W. West</i>	
Certificate No.	JOHN W. WEST 676
	PATRICK A. ROMERO 6688
	Ronald J. Eldon 3239