

UNITED STATES
DEPARTMENT OF THE INTERIOR
GEOLOGICAL SURVEY

APPLICATION FOR PERMIT TO DRILL, DEEPEN, OR PLUG BACK

1a. TYPE OF WORK

DRILL ☒DEEPEN ☐PLUG BACK ☐

b. TYPE OF WELL

OIL
WELL ☒GAS
WELL ☐OTHER ☐SINGLE
ZONE ☒MULTIPLE
ZONE ☐

2. NAME OF OPERATOR

John H. Trigg

3. ADDRESS OF OPERATOR

Box 520, Roswell, New Mexico 88202

RECEIVED

4. LOCATION OF WELL (Report location clearly and in accordance with any State requirements.*)

At surface

1650' FSL & 990' FEL

DEC 10 1981

O. C. D.

At proposed prod. zone

14. DISTANCE IN MILES AND DIRECTION FROM NEAREST TOWN OR POST OFFICE*

9 1/2 miles Northwest of Loco Hills, New Mexico

ARTESIA, OFFICE

15. DISTANCE FROM PROPOSED*
LOCATION TO NEAREST
PROPERTY OR LEASE LINE, FT.
(Also to nearest d-ig. unit line, if any)

990'

16. NO. OF ACRES IN LEASE

600

17. NO. OF ACRES ASSIGNED
TO THIS WELL

40

18. DISTANCE FROM PROPOSED LOCATION*
TO NEAREST WELL, DRILLING, COMPLETED,
OR APPLIED FOR, ON THIS LEASE, FT.

1000'

19. PROPOSED DEPTH

1900'

20. ROTARY OR CABLE TOOLS

Cable Tools

21. ELEVATIONS (Show whether DF, RT, GR, etc.)

3711.8' G.L.

22. APPROX. DATE WORK WILL START*

November 26, 1981

23.

PROPOSED CASING AND CEMENTING PROGRAM

SIZE OF HOLE	SIZE OF CASING	WEIGHT PER FOOT	SETTING DEPTH	QUANTITY OF CEMENT
10"	8-5/8"	20 lb.	320'	150 sx (Circ.)
8"	7"	18 lb.	1600'	Set
6-3/4"	4-1/2"	9 1/2 lb.	1900'	200 sx

Will drill to approximately 1900' to test the Penrose sand. If production is indicated, will run casing and attempt completion. Conventional cable tool control head will be utilized.

Estimated Geologic Tops: Yates 810'; Queen 1575'; Penrose 1790'.

Mud Program: No mud will be used as this is a cable tool hole.

IN ABOVE SPACE DESCRIBE PROPOSED PROGRAM: If proposal is to deepen or plug back, give data on present productive zone and proposed new productive zone. If proposal is to drill or deepen directionally, give pertinent data on subsurface locations and measured and true vertical depths. Give blowout preventer program, if any.

24.

SIGNED

John H. Trigg

TITLE Owner

DATE 11/23/81

(This space for Federal or State office use)

PERMIT NO.

APPROVAL DATE

APPROVED BY

TITLE

DATE

CONDITIONS OF APPROVAL

APPROVED
DEC 7 1981
JAMES A. GILLHAM
DISTRICT SUPERVISOR

*See Instructions On Reverse Side

N MEXICO OIL CONSERVATION COMMISS
WELL LOCATION AND ACREAGE DEDICATION PLAT

Form C-102
 Supersedes C-128
 Effective 1-1-65

All distances must be from the outer boundaries of the Section

Lease to: JOHN H. TRIGG			Lease: GOVERNMENT			Well No.: 5		
Section: I	Section: 25	Township: 16 SOUTH	Range: 28 EAST	County: EDDY				
Well Location of Well: 1650 feet from the SOUTH line and 990 feet from the EAST line								
Elevation: 3711.8' Producing Formation: Penrose Sand		Pool: E. Red Lake Q. G. Undesignated			Dedicated Acreage: 40 Acres			

- 1 Outline the acreage dedicated to the subject well by colored pencil or hachure marks on the plat below.
- 2 If more than one lease is dedicated to the well, outline each and identify the ownership thereof (both as to working interest and royalty).
- 3 If more than one lease of different ownership is dedicated to the well, have the interests of all owners been consolidated by communitization, unitization, force-pooling, etc?

☐ Yes ☒ No If answer is "yes," type of consolidation _____

If answer is "no," list the owners and tract descriptions which have actually been consolidated (Use reverse side of this form if necessary.) _____

No allowable will be assigned to the well until all interests have been consolidated (by communitization, unitization, forced-pooling, or otherwise) or until a non-standard unit, eliminating such interests, has been approved by the Commission.



CERTIFICATION

I hereby certify that the information contained herein is true and complete to the best of my knowledge and belief.

John H. Trigg
 Name: **John H. Trigg**

Owner

John H. Trigg

November 23, 1981

I hereby certify that the well location shown on this plat was plotted from field notes of actual surveys made by me or under my supervision, and that the same is true and correct to the best of my knowledge and belief.

Date Surveyed:

11/21/81

Registered Professional Engineer and Land Surveyor

Patrick A. Romero
 Certificate No. **JOHN W. WEST 676**
PATRICK A. ROMERO 6663
Ronald J. Eidson 3239

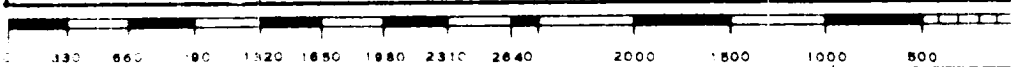
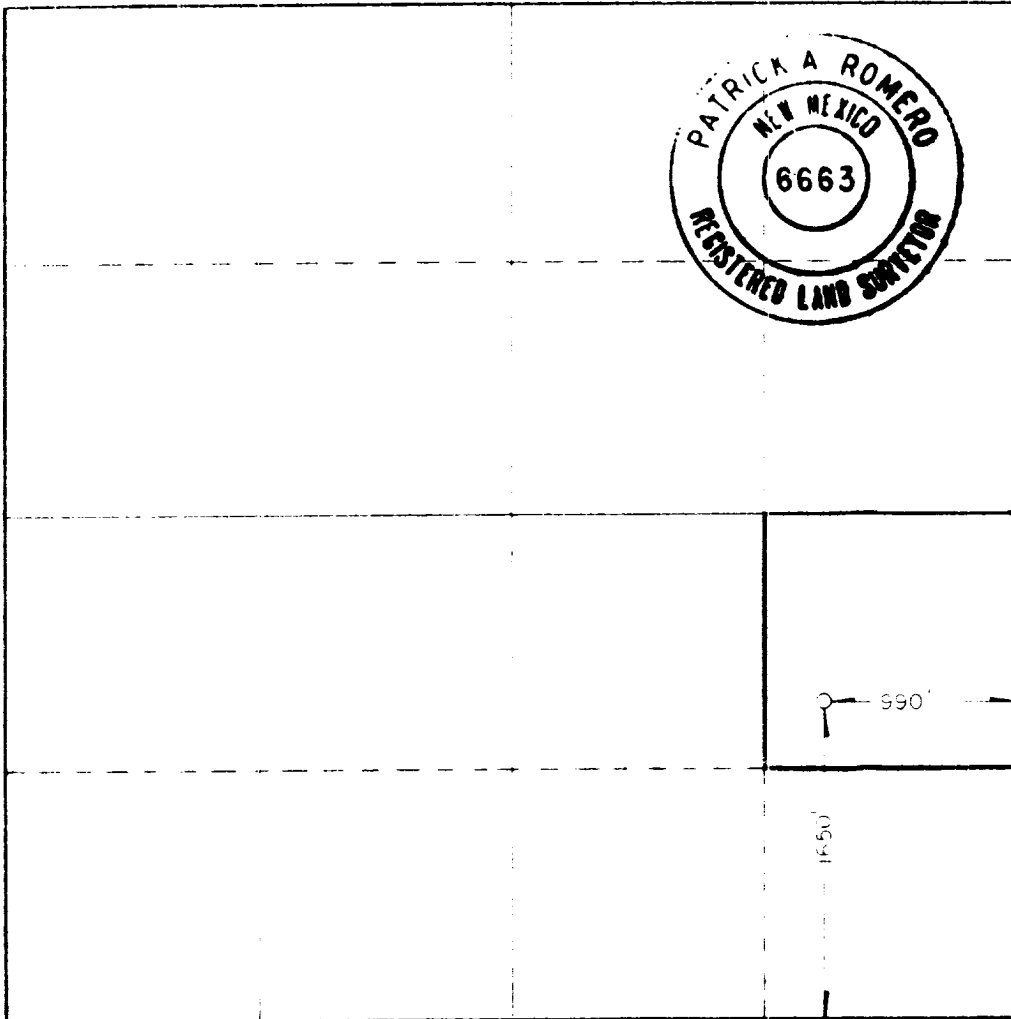

John H. Trigg
No. 5 Government
REQUIREMENTS
(NTL-6)

1. Location: 1650' FSL & 990' FEL, Sec. 25, T16S, R28E, Eddy Co., New Mexico
2. Elevation: 3711.8' G.L.
3. Geologic name of surface formation: Recent alluvium at Quaternary age
4. Type of drilling rig and associated equipment: Walker-Neer 33-Super
Cable tool drilling rig.
5. Proposed drilling depth and objective formation: 1900 (Penrose sand)
6. Estimated tops of geologic markers:

Yates <u>810</u>	San Andres _____	Abo _____
7-Rivers <u>1425</u>	Glorieta _____	Wolfcamp _____
Queen <u>1575</u>	Tubb _____	
Penrose <u>1790</u>		
7. Estimated depths of any oil, water, or gas: Possible water 1600',
oil and/or gas 1780'-1800'.
- 8-9. Proposed casing program:

<u>8-5/8" @ 320'</u> Grade <u>J-55</u> Wt. <u>20 lb.</u> Type Cement <u>Class "C" with 2% CaCl</u>
* <u>7" @ 1600'</u> Grade <u>J-55</u> Wt. <u>17 lb.</u> Type Cement <u>Set (not cemented)</u>
<u>4-1/2" @ 1900'</u> Grade <u>J-55</u> Wt. <u>9½ lb.</u> Type Cement <u>Class "C" with 12% CaCl</u> , 2 lb. salt
10. Specifications for pressure control equipment and testing procedures: _____
Conventional cable tool control head will be used.
11. Type and characteristics of drilling fluids: Natural mud used by adding fresh
water as well is being drilled.
12. Testing, logging, and coring programs: Natural tests will be taken as a
result of cable tool. Gamma-ray neutron log will be run.
No coring program is planned.
13. Anticipated abnormal pressures or temperature: None
14. Anticipated commencement and completion date: As soon as possible.
15. Other pertinent information: None

R-28-E

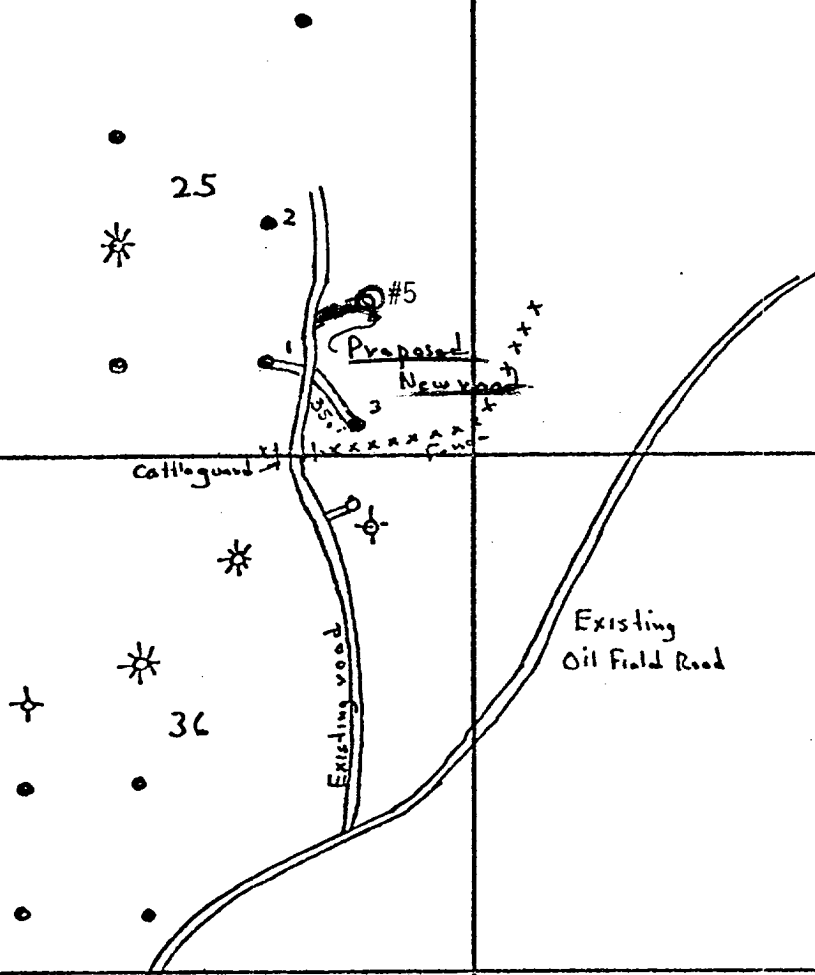

T
16
S