

STATE OF NEW MEXICO
ENERGY AND MINERALS DEPARTMENT

OIL CONSERVATION DIVISION **RECEIVED**

30-015-24063

Form C-101
Revised 10-1-78

P. O. BOX 2088
SANTA FE, NEW MEXICO 87501

JAN 19 1982

O. C. D.
ARTESIA, OFFICE

NO. OF COPIES RECEIVED	
DISTRIBUTION	
SANTA FE	
FILE	
U.S.G.S.	
LAND OFFICE	
OPERATOR	

APPLICATION FOR PERMIT TO DRILL, DEEPEN, OR PLUG BACK

Type of Work

Type of Well

GEL WELL ☐

DRILL ☒

GAS WELL ☒

OTHER

DEEPEN ☐

PLUG BACK ☐

SINGLE ZONE ☐

MULTIPLE ZONE ☐

Operator

Yates Petroleum Corporation

Address of Operator

207 S. 4th, Artesia, New Mexico 88210

Location

SECTION E

LOCATED 2310

FEET FROM THE

North

LINE

990

FEET FROM THE West

LINE OF SEC. 10

TWP. 17S

R. 26E

NECOR

5A. Indicate Type of Lease

STATE ☐

FEE ☒

5. State Oil & Gas Lease No.

7. Unit Agreement Name

8. Form or Lease Name

Ralph "SJ" Com

9. Well No.

1

10. Field and Pool, or Wildcat

Undesignated Morrow

11. County

Eddy

12. Depth of Well

Approx. 8400'

13. Formation

Morrow

14. Rotary or C.D.

Rotary

15. Fluids (Water, Oil, Gas, etc.)

3333.0 GL

16. Kind of Fluids (Oil, Gas, etc.)

Blanket

17. Drilling Contractor

Landis Rig #4

18. Approx. Date Work will start

ASAP

PROPOSED CASING AND CEMENT PROGRAM

SIZE OF HOLE	SIZE OF CASING	WEIGHT PER FOOT	SETTING LENGTH	SACKS OF CEMENT	EST. TOP
17 1/2"	13 3/8"	48# J-55	Approx 400'	350 sx	circulated
12 1/4"	8 5/8"	24# J-55	Approx 1400'	650 sx	circulated
7 7/8"	5 1/2 or 4 1/2"	15.5 - 17# or 10.5 - 11.6#	TD	375 sx	

We propose to drill and test the Morrow and intermediate formations. Approximately 400' of surface casing will be set for protection from gravel and caving, and intermediate casing will be set at least 100' below the Artesian water sands, cement circulated on both strings. If commercial will run 5 1/2" or 4 1/2" casing and cement with 600' of cover.

MUD PROGRAM: FW gel & LCM to 1400', water to 6400'. Starch-Drispak-KCL mud to 7700'. Flosal-Drispak-KCL to total depth.

BOP PROGRAM: BOP's and hydril on 8 5/8" casing and tested, pipe rams daily for operational, yellow jacket prior to drilling Wolfcamp (approx. 5475').

GAS NOT DEDICATED.

APPROVAL VALID FOR 180 DAYS
PERMIT EXPIRES 2-22-82
UNLESS DRILLING UNDERWAY

3. HAVE SPACE DESCRIBE PROPOSED PROGRAM: IF PROPOSAL IS TO DEEPEN OR PLUG BACK, GIVE DATA ON PRESENT PRODUCTIVE ZONE AND PROPOSED NEW PRODUCTIVE ZONE. GIVE BLOWOUT PREVENTER PROGRAM, IF ANY.

by certify that the information above is true and complete to the best of my knowledge and belief.

[Signature]

Title Regulatory Manager

Date 12/31/81

(This space for State Use)

APPROVED BY *[Signature]*

TITLE OIL AND GAS INSPECTOR

DATE JAN 22 1982

REVISIONS OF APPROVAL, IF ANY:

Can not have be drilled to

137/18 5/8

Notify N.E.L.C.C. in sufficient time to witness cementing

the 8 5/8

**W MEXICO OIL CONSERVATION COMMISSION
WELL LOCATION AND ACREAGE DEDICATION PLAT**

Form C-102
Supersedes C-128
Effective 1-1-65

All distances must be from the outer boundaries of the Section.

Operator Yates Petroleum Corporation			Lease Ralph "SJ" Com		Well No. 1
Unit Letter E	Section 10	Township 17 South	Range 26 East	County Eddy	
Actual Footage Location of Well: 2310 feet from the North line and 990 feet from the West line					
Ground Level Elev. 3333.0	Producing Formation Morrow	Pool Undesignated Morrow		Dedicated Acreage: 320 Acres	

1. Outline the acreage dedicated to the subject well by colored pencil or hachure marks on the plat below.
2. If more than one lease is dedicated to the well, outline each and identify the ownership thereof (both as to working interest and royalty).
3. If more than one lease of different ownership is dedicated to the well, have the interests of all owners been consolidated by communitization, unitization, force-pooling, etc?

☒ Yes ☐ No If answer is "yes," type of consolidation _____

If answer is "no," list the owners and tract descriptions which have actually been consolidated. (Use reverse side of this form if necessary.) _____

No allowable will be assigned to the well until all interests have been consolidated (by communitization, unitization, forced-pooling, or otherwise) or until a non-standard unit, eliminating such interests, has been approved by the Commission.

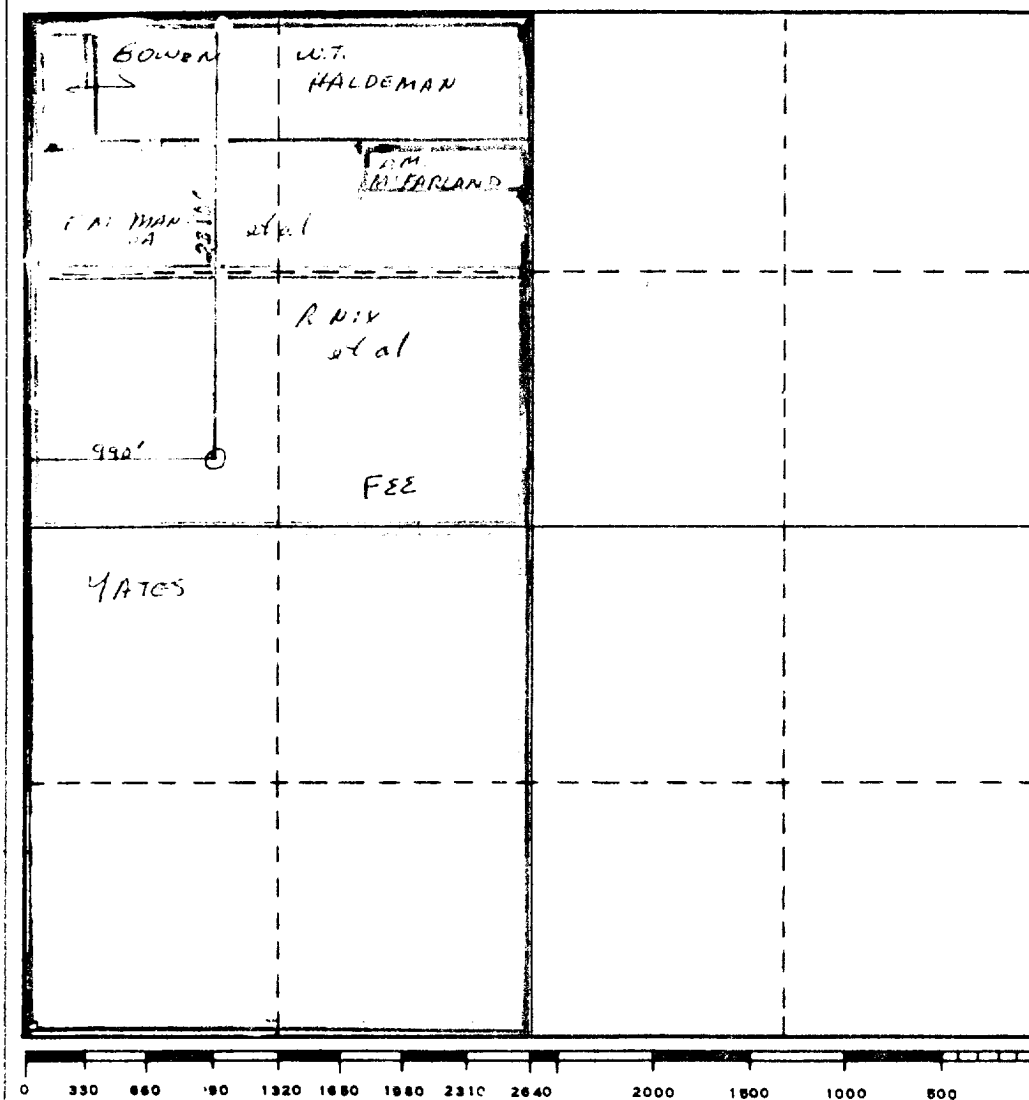

CERTIFICATION

I hereby certify that the information contained herein is true and complete to the best of my knowledge and belief.

Name
Gliserio Rodriguez
Position
Regulatory Manager
Company
Yates Petroleum Corporation
Date
12/15/81

I hereby certify that the well location shown on this plat was taken from field notes of actual surveys made by me or under my supervision, and that the same is true and correct to the best of my knowledge and belief.

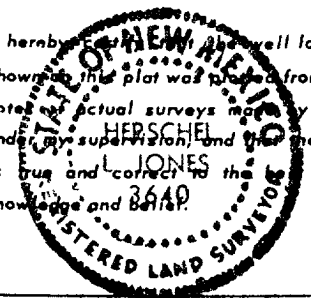

Date Surveyed
December 12, 1981
Registered Professional Engineer
and/or Land Surveyor

Certificate No.
3640

ating head if neces. ry
fill up Line

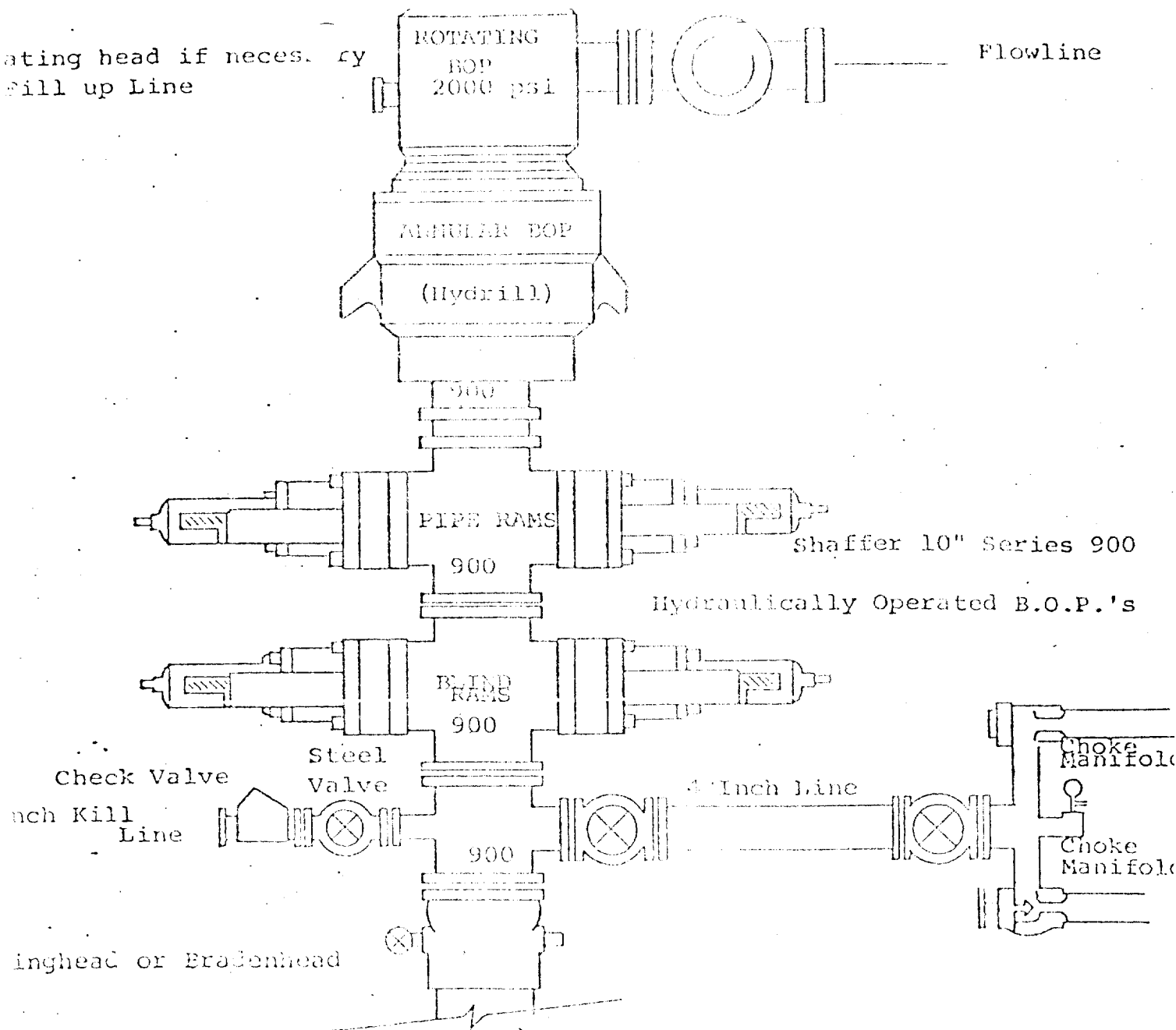

FOLLOWING CONSTITUTE MINIMUM BLOWOUT PREVENTER REQUIREMENTS

- All preventers to be hydraulically operated with secondary manual control installed prior to drilling out from under casing.
- Choke outlet to be a minimum of 4" diameter.
- Kill line to be of all steel construction of 2" minimum diameter.
- All connections from operating manifolds to preventers to be all steel, hole or tube a minimum of one inch in diameter.
- The available closing pressure shall be at least 15% in excess of that required with sufficient volume to operate the B.O.P.'s.
- All connections to and from preventer to have a pressure rating equivalent to that of the B.O.P.'s.
- Inside blowout preventer to be available on rig floor.
- Operating controls located a safe distance from the rig floor.
- Hole must be kept filled on trips below intermediate casing. Operator not responsible for blowouts resulting from not keeping hole full.
- D. P. float must be installed and used below zone of first gas intrusion.