

NO. OF COPIES RECEIVED	
DISTRIBUTION	
SANTA FE	1
FILE	1
U.S.G.S.	2
LAND OFFICE	
OPERATOR	1

RECEIVED  
NEW MEXICO OIL CONSERVATION COMMISSION

AUG 2 1982

O. C. D.  
ARTESIA, OFFICE

30-019-24225

Form C-101  
Revised 1-1-65

5A. Indicate Type of Lease	
STATE <input type="checkbox"/>	FEE <input checked="" type="checkbox"/>
5. State Oil & Gas Lease No.	

APPLICATION FOR PERMIT TO DRILL, DEEPEN, OR PLUG BACK

1a. Type of Work		7. Unit Agreement Name	
b. Type of Well DRILL <input checked="" type="checkbox"/> DEEPEN <input type="checkbox"/> PLUG BACK <input type="checkbox"/> OIL WELL <input type="checkbox"/> GAS WELL <input checked="" type="checkbox"/> OTHER <input type="checkbox"/> SINGLE ZONE <input checked="" type="checkbox"/> MULTIPLE ZONE <input type="checkbox"/>		8. Farm or Lease Name Logan Draw "23" Com.	
2. Name of Operator Southland Royalty Company		9. Well No. 1	
3. Address of Operator 21 Desta Drive, Midland, Texas 79701		10. Field and Pool, or Wildcat Kennedy Farms (Morrow)	
4. Location of Well UNIT LETTER <u>BG</u> LOCATED 1980 FEET FROM THE North LINE AND 1980 FEET FROM THE East LINE OF SEC. 23 TWP. 17S RGE. 26E NMPM		12. County Eddy	
21. Elevations (Show whether DF, RT, etc.) 3317'		22. Approx. Date Work will start 9-1-82	
21A. Kind & Status Plug. Bond <u>Blanket</u>		21B. Drilling Contractor	
19. Proposed Depth 8700'		19A. Formation Morrow	
20. Rotary or C.T. Rotary			

23.

PROPOSED CASING AND CEMENT PROGRAM

SIZE OF HOLE	SIZE OF CASING	WEIGHT PER FOOT	SETTING DEPTH	SACKS OF CEMENT	EST. TOP
17 1/2"	13 3/8"	48#	450'	550 sx.	Circ.
12 1/4"	8 5/8"	24#	1500'	700 sx.	Circ.
7 7/8"	4 1/2"	11.6/10.5#	8700'	1200 sx.	TOC est @ 5000'

Drill 17 1/2" hole to 450'. Set 13 3/8" csg. Circ cmt. Drill 12 1/4" hole to 1500'. Set 8 5/8" csg. Circ cmt. Drill 7 7/8" hole to TD to test the Morrow and intermediate horizons with shows. If commercial, run 4 1/2" csg to TD. Cmt w/sufficient volume to bring cmt above prospective zones. Estimated top of cmt @ 5000'. Perforate and stimulate.

MUD PROGRAM: 0-350' spud mud; 350-1500' Fresh wtr; 1500-7400' Fresh wtr; 7400-8700' gel, drispac, 3% KCL. Mud wt 9.1-9.3#, vis 32-36, wl 6 cc. BHP @ TD anticipated to be 3073 psi.

BOP PROGRAM: BOP to be installed and tested after setting 8 5/8" csg. BOP to be tested by Yellow Jacket, Inc.

GAS NOT DEDICATED

APPROVAL VALID FOR 150 DAYS  
PERMIT EXPIRES 2-19-83  
UNLESS DRILLING UNDERWAY

IN ABOVE SPACE DESCRIBE PROPOSED PROGRAM: IF PROPOSAL IS TO DEEPEN OR PLUG BACK, GIVE DATA ON PRESENT PRODUCTIVE ZONE AND PROPOSED NEW PRODUCTIVE ZONE. GIVE BLOWOUT PREVENTER PROGRAM, IF ANY.

I hereby certify that the information above is true and complete to the best of my knowledge and belief.

Signed F. N. RAD Title District Operations Engineer Date 7/30/82

(This space for State Use)

APPROVED BY [Signature] TITLE SUPERVISOR, DISTRICT II DATE AUG 1 1982

CONDITIONS OF APPROVAL, IF ANY:

Notify N.M.O.C.C. in sufficient  
time to witness cementing  
the 8 5/8" casing

NEW MEXICO OIL CONSERVATION COMMISSION  
WELL LOCATION AND ACREAGE DEDICATION PLAT

Form C-102  
Supersedes C-128  
Effective 1-1-65  
**RECEIVED**

All distances must be from the outer boundaries of the Section.

Operator <b>SOUTHLAND ROYALTY COMPANY</b>			Lease <b>Logan Draw 23 Com</b>		
Unit Letter <b>B</b>	Section <b>23</b>	Township <b>17-S</b>	Range <b>26-E</b>	County <b>O. C. D.</b>	
Actual Footage Location of Well: 1980 feet from the <b>NORTH</b> line and 1980 feet from the <b>EAST</b> line					
Ground Level Elev. <b>3317'</b>	Producing Formation <b>Morrow</b>	Pool <b>Kennedy Farms</b>	Dedicated Acreage: <b>320</b> Acres		

1. Outline the acreage dedicated to the subject well by colored pencil or hatchure marks on the plat below.
2. If more than one lease is dedicated to the well, outline each and identify the ownership thereof (both as to working interest and royalty).
3. If more than one lease of different ownership is dedicated to the well, have the interests of all owners been consolidated by communitization, unitization, force-pooling, etc?

☒ Yes ☐ No If answer is "yes," type of consolidation Communitization

If answer is "no," list the owners and tract descriptions which have actually been consolidated. (Use reverse side of this form if necessary.)

No allowable will be assigned to the well until all interests have been consolidated (by communitization, unitization, forced-pooling, or otherwise) or until a non-standard unit, eliminating such interests, has been approved by the Commission.

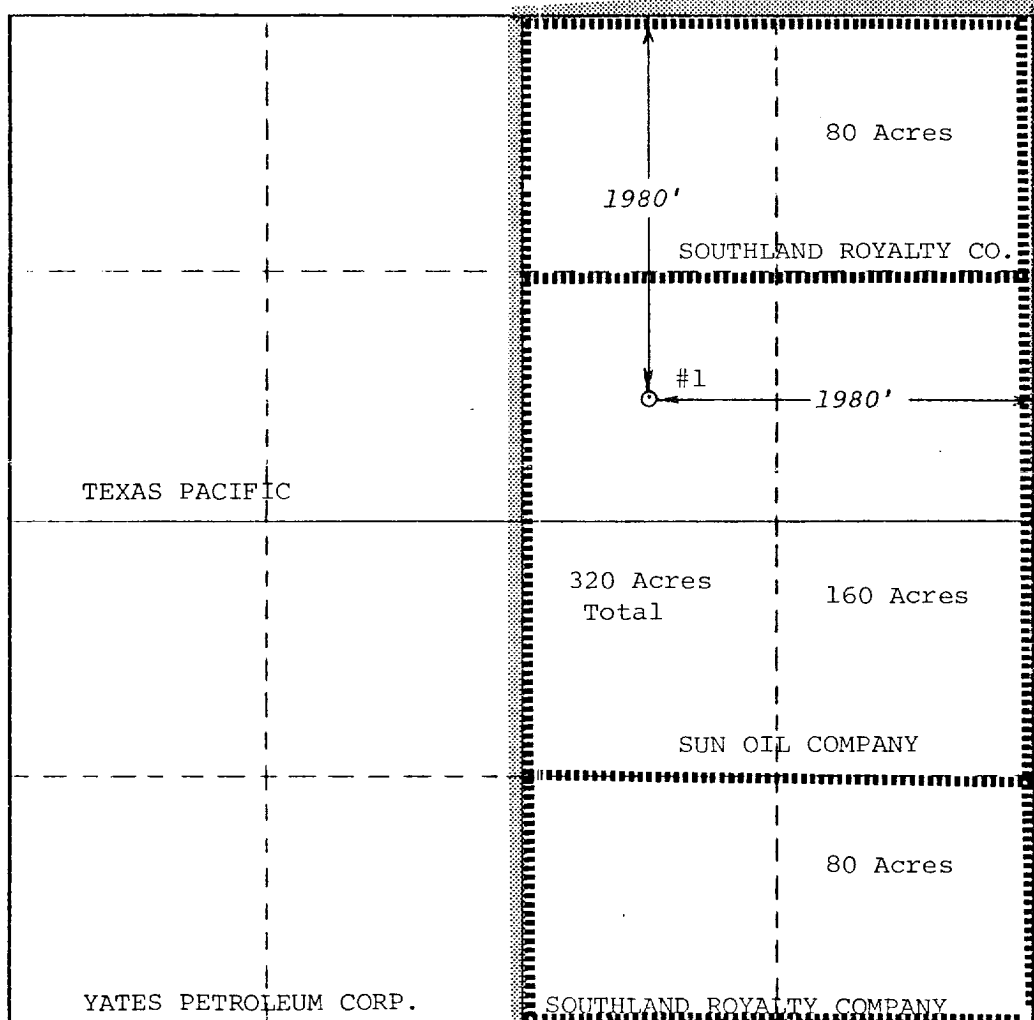

**CERTIFICATION**

I hereby certify that the information contained herein is true and complete to the best of my knowledge and belief.

*F. N. Rad*

Name  
District Operations Engineer  
Position  
Southland Royalty Company  
Company  
July 30, 1982  
Date

I hereby certify that the well location shown on this plat was plotted from field notes of actual surveys made by me or under my supervision and that the same is true and correct to the best of my knowledge and belief.

**GARY D. BOSWELL**  
July 22, 1982  
NO. 6689  
GARY D. BOSWELL  
Registered Professional Engineer  
and/or Land Surveyor

*Gary D. Boswell*  
Certificate No. 6689

