

RECEIVED

NOV 9 1982

O. C. D.

ARTESIA, OFFICE

NO. COPIES RECEIVED	
DISTRIBUTION	
SANTA FE	
FILE	
U.S.G.S.	
LAND OFFICE	
OPERATOR	

APPLICATION FOR PERMIT TO DRILL, DEEPEN, OR PLUG BACK

1. Type of Work

DRILL ☐DEEPEN ☐PLUG BACK ☐

2. Type of Well

OIL WELL ☒GAS WELL ☐OTHER ☐SINGLE ZONE ☐MULTIPLE ZONE ☐

3. Name of Operator

Yates Petroleum Corporation ✓

4. Address of Operator

207 South 4th Street, Artesia, New Mexico 88210

5. Location of Well

UNIT LETTER M LOCATED 330' FEET FROM THE South LINED 330' FEET FROM THE West LINE OF SEC. 23 TWP. 17 RGE. 25 NMPM

5A. Indicate Type of Lease

STATE ☐FEE ☒

6. State Oil & Gas Lease No.

7. Unit Agreement Name

8. Farm or Lease Name

Gissler AV

9. Well No.

31

10. Field and Pool, or Wildcat

Eagle Creek (SA)

12. County

Eddy

19. Proposed Depth

Apprx. 1500'

19A. Formation

Abo

20. Rotary or C.T.

Rotary

21. Elevations (Show whether DT, KL, etc.)

3508' GL

21A. Kind & Status Plug. Bond

Blanket

21B. Drilling Contractor

L & M #2

22. Approx. Date Work will start

ASAP

PROPOSED CASING AND CEMENT PROGRAM

SIZE OF HOLE	SIZE OF CASING	WEIGHT PER FOOT	SETTING DEPTH	SACKS OF CEMENT	EST. TOP
14 1/2"	10 3/4"	32#	apprx 350'	200 sxs	circ.
9 1/2"	7"	30#	apprx 1150'	700 sxs	circ.
6 1/4"	4 1/2"	10.5#	apprx 1500'	150 sxs	circ.

Propose to drill a San Andres test. Approximately 350' of 10 3/4" casing will be run and cemented to the surface to shut off gravel and caving, and 7" casing will be run 100' below the Artesia zone, cemented to the surface. A tapered oil string will be run and cemented, perforated and sand frac'd for production.

MUD PROGRAM: FW gel and LCM to 1150' (or dry drill) fresh water to TD.

BOP PROGRAM: BOP's to be installed on 7" casing and tested daily for operational.

APPROVAL VALID FOR 130 DAYS
PERMIT EXPIRES 5-1983
UNLESS DRILLING UNDERWAY

BOVE SPACE DESCRIBE PROPOSED PROGRAM: IF PROPOSAL IS TO DEEPEN OR PLUG BACK, GIVE DATA ON PRESENT PRODUCTIVE ZONE AND PROPOSED NEW PRODUCTIVE ZONE. GIVE BLOWOUT PREVENTER PROGRAM, IF ANY.

by certify that the information above is true and complete to the best of my knowledge and belief.

ed Cy Cameron Title Regulatory Coordinator Date November 9, 1982

(This space for State Use)

ROVED BY Mike Walker TITLE _____ DATE _____

DITIONS OF APPROVAL, IF ANY:

Notify N.I.O.C.C. in _____

time to witness cementing

the 7 casing

NE. MEXICO OIL CONSERVATION COMMISSION
WELL LOCATION AND ACREAGE DEDICATION PLAT RECEIVED

Form C-102
Supersedes C-128
Effective 1-1-65

All distances must be from the outer boundaries of the Section.

Operator YATES PETROLEUM CORPORATION			Lease Gissler AV		NOV 9 1982	Well No. 31
Unit Letter M	Section 23	Township 17 South	Range 25 East	County O. C. D.		
Actual Footage Location of Well: 330 feet from the South line and 330 feet from the West line						
Ground Level Elev. 3508.	Producing Formation SAN ANDRES		Pool Eagle Creek (SA)		Dedicated Acreage: 40 Acres	

1. Outline the acreage dedicated to the subject well by colored pencil or hachure marks on the plat below.
2. If more than one lease is dedicated to the well, outline each and identify the ownership thereof (both as to working interest and royalty).
3. If more than one lease of different ownership is dedicated to the well, have the interests of all owners been consolidated by communitization, unitization, force-pooling, etc?

☐ Yes ☒ No If answer is "yes," type of consolidation _____

If answer is "no," list the owners and tract descriptions which have actually been consolidated. (Use reverse side of this form if necessary.) _____

No allowable will be assigned to the well until all interests have been consolidated (by communitization, unitization, forced-pooling, or otherwise) or until a non-standard unit, eliminating such interests, has been approved by the Commission.

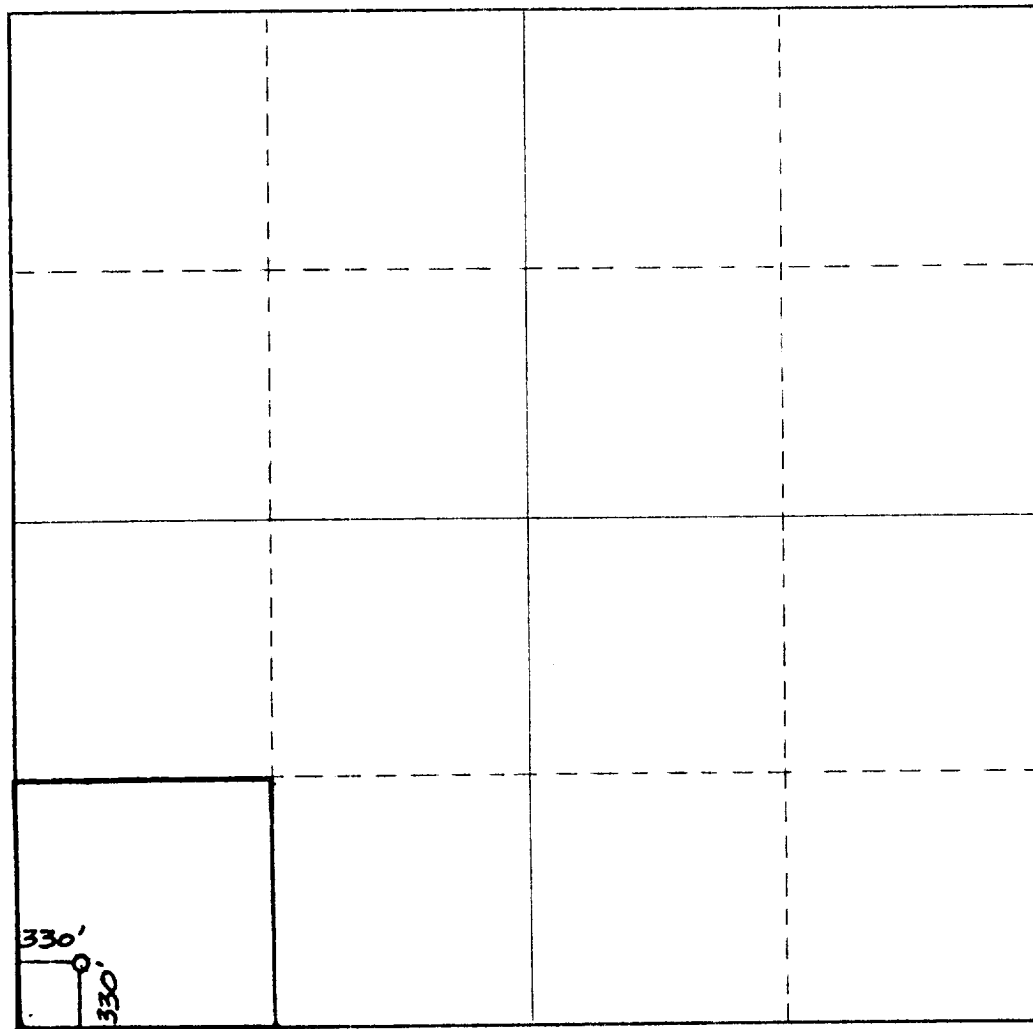

CERTIFICATION

I hereby certify that the information contained herein is true and complete to the best of my knowledge and belief.

Cy Amara

Name
Regulatory Coordinator

Position
Yates Petroleum Corp.

Company
November 9, 1982

Date

I hereby certify that the well location shown on this plat was plotted from field notes of actual surveys made by me or under my supervision, and that the same is true and correct to the best of my knowledge and belief.

Date Surveyed
November 6, 1982

Registered Professional Engineer and/or Land Surveyor

Dan R. Reddy

Certificate No.
NM PE&LS #5412

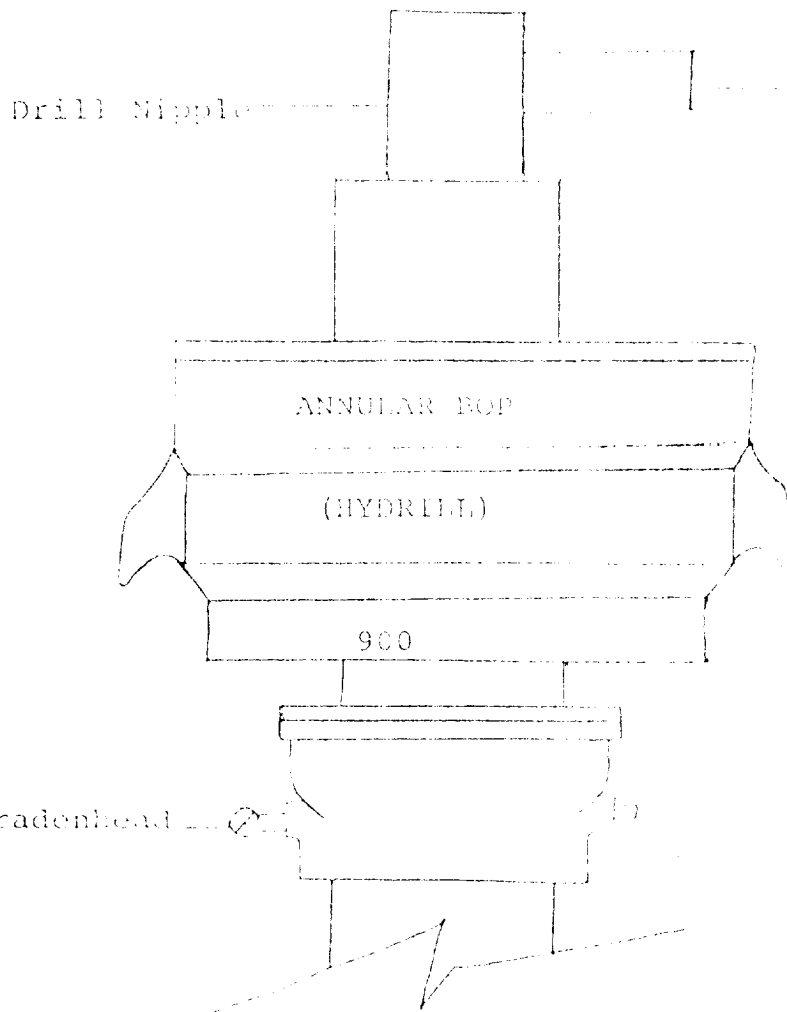

RECEIVED

Flowline
NOV 9 1982

O. C. D.
ARTESIA, OFFICE

THE FOLLOWING CONSTITUTE MINIMUM BLOWOUT PREVENTER REQUIREMENTS

1. All preventers to be hydraulically operated with secondary manual controls installed prior to drilling out from under casing.
2. All connections from operating manifolds to preventers to be all steel. Hole or tube a minimum of one inch in diameter.
3. The available closing pressure shall be at least 15% in excess of that required with sufficient volume to operate the BOP's.
4. All connections to and from preventer to have a pressure rating equivalent to that of the BOP's.
5. Hole must be kept filled on trips below intermediate casing.