

30-015-24329
C/82

NO. OF COPIES RECEIVED	
DISTRIBUTION	
SANTA FE	<input checked="" type="checkbox"/>
FILE	<input checked="" type="checkbox"/>
U.S.G.S.	<input checked="" type="checkbox"/>
LAND OFFICE	<input type="checkbox"/>
OPERATOR	<input checked="" type="checkbox"/>

NEW MEXICO OIL CONSERVATION COMMISSION

NOV 15 1982

O. C. D.
ARTESIA, OFFICE

Form C-101
Revised 1-1-65

5A. Indicate Type of Lease STATE <input checked="" type="checkbox"/> FEE <input type="checkbox"/>
5. State Oil & Gas Lease No. E-3510
7. Unit Agreement Name
8. Farm or Lease Name State "MT" Com
9. Well No. 1
10. Field and Pool, or Wildcat Wildcat Morrow
12. County Eddy
19. Proposed Depth 10,500
19A. Formation Morrow
20. Rotary or C.T. Rotary
21. Elevations (Show whether DT, RT, etc.) 3683.2 GL
21A. Kind & Status Plug. Bond Blanket on file
21B. Drilling Contractor
22. Approx. Date Work will start

APPLICATION FOR PERMIT TO DRILL, DEEPEN, OR PLUG BACK

1a. Type of Work

b. Type of Well

DRILL ☒

DEEPEN ☐

PLUG BACK ☐

OIL WELL ☐

GAS WELL ☒

OTHER

SINGLE ZONE ☐

MULTIPLE ZONE ☐

2. Name of Operator

Amoco Production Company

3. Address of Operator

P. O. Box 68, Hobbs, New Mexico 88240

4. Location of Well

UNIT LETTER I

LOCATED 1980

FEET FROM THE South LINE

660

FEET FROM THE

East

LINE OF SEC. 1

TWP. 17-S

RGE. 28-E

NMPM

AND

12. County

Eddy

21. Elevations (Show whether DT, RT, etc.)

3683.2 GL

21A. Kind & Status Plug. Bond

Blanket on file

19. Proposed Depth

10,500

19A. Formation

Morrow

20. Rotary or C.T.

Rotary

21. Elevations (Show whether DT, RT, etc.)

3683.2 GL

21A. Kind & Status Plug. Bond

Blanket on file

21B. Drilling Contractor

22. Approx. Date Work will start

PROPOSED CASING AND CEMENT PROGRAM

SIZE OF HOLE	SIZE OF CASING	WEIGHT PER FOOT	SETTING DEPTH	SACKS OF CEMENT	EST. TOP
17-1/2"	13-3/8"	48#	400'	Circ.	Surface
11" or 12-1/4"	8-5/8"	32#	2650'	tieback to 13-3/8	400'
7-7/8"	5-1/2"	17#, 15.5#	10,500	500' above AB0	Appx. 5343'

Propose to drill and equip well in the Morrow zone. After reaching TD logs will be run and evaluated; perforate and/or stimulate as necessary in attempting commercial production.

Mud Program:

0-400'

Native mud and fresh water.

400-2650'

Saturated Brine water.

2500-10000

Add fresh water to brine for makeup.

10000-10500

KCL and cut Brine through Morrow-mud up with salt gel/Drispac if necessary.

APPROVAL VALID FOR 120 DAYS

PERMIT EXPIRES 5-18-82

UNLESS DRILLING UNDERWAY

0+6-NMOCD, A 1-HOU 1-W. Stafford 1-CMH

IN ABOVE SPACE DESCRIBE PROPOSED PROGRAM: IF PROPOSAL IS TO DEEPEN OR PLUG BACK, GIVE DATA ON PRESENT PRODUCTIVE ZONE AND PROPOSED NEW PRODUCTION ZONE. GIVE BLOWOUT PREVENTER PROGRAM, IF ANY.

hereby certify that the information above is true and complete to the best of my knowledge and belief.

Signed Charles M. Lerring Title Assist. Admin. Analyst

Date 11-10-82

(This space for State Use)

APPROVED BY Mike Hoffman TITLE SUPERVISOR, DISTRICT II

DATE NOV 18 1982

CONDITIONS OF APPROVAL, IF ANY:

NEW MEXICO OIL CONSERVATION COMMISSION
WELL LOCATION AND ACREAGE DEDICATION PLAT

Form C-102
Supersedes C-128
Effective 1-1-65

All distances must be from the outer boundaries of the Section

Operator AMOCO PRODUCTION CO.		Lease ST. MT COM.		Well No. 1
Unit Letter I	Section 1	Township 17 SOUTH	Range 28 EAST	County EDDY
Actual Footage Location of Well: 660 feet from the EAST line and 1980 feet from the SOUTH line				
Ground Level Elev. 3683.2	Producing Formation Morrow	Pool Wildcat Morrow	Dedicated Acreage: 320 Acres	

1. Outline the acreage dedicated to the subject well by colored pencil or hatchure marks on the plat below.
2. If more than one lease is dedicated to the well, outline each and identify the ownership thereof (both as to working interest and royalty).
3. If more than one lease of different ownership is dedicated to the well, have the interests of all owners been consolidated by communitization, unitization, force-pooling, etc?

☒ Yes ☐ No If answer is "yes," type of consolidation Communitization

If answer is "no," list the owners and tract descriptions which have actually been consolidated. (Use reverse side of this form if necessary.) _____

No allowable will be assigned to the well until all interests have been consolidated (by communitization, unitization, forced-pooling, or otherwise) or until a non-standard unit, eliminating such interests, has been approved by the Commission.

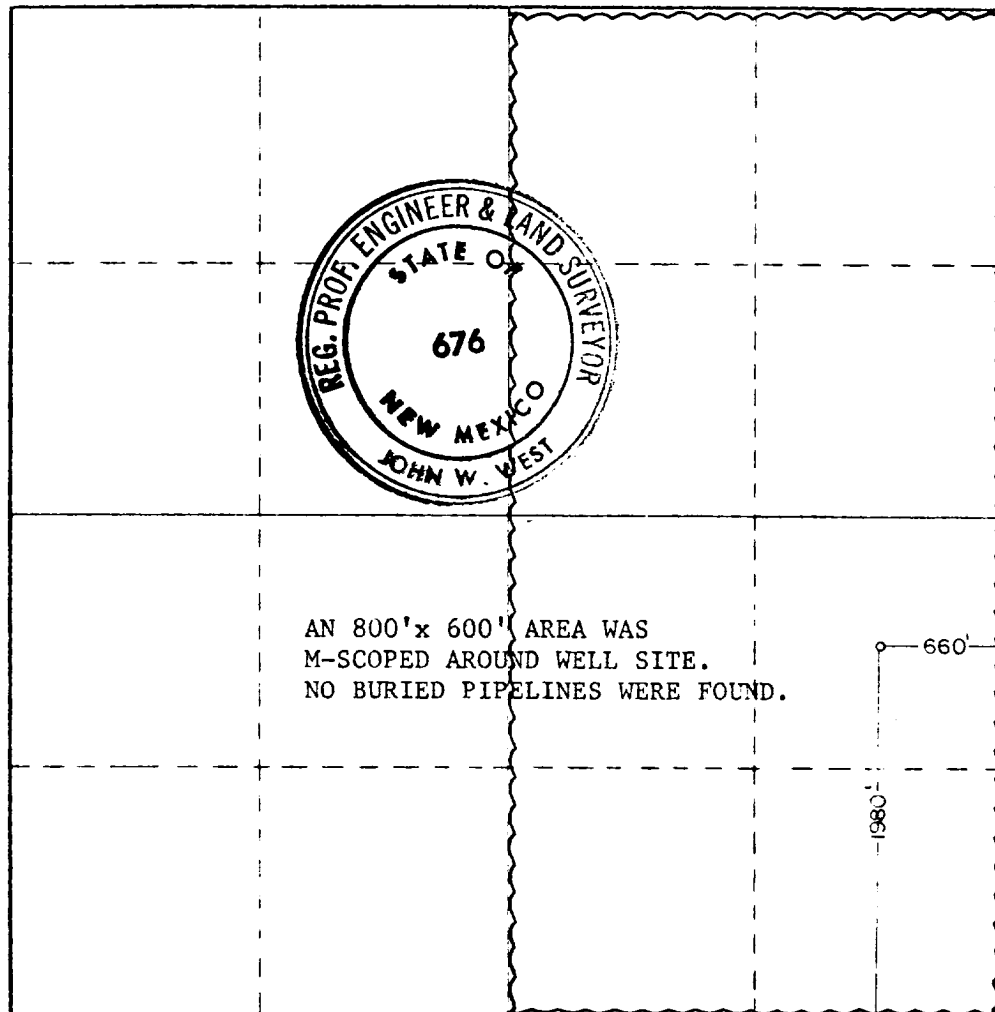

CERTIFICATION

I hereby certify that the information contained herein is true and complete to the best of my knowledge and belief.

By Charles M. Lerring
Position
Assist. Admin. Analyst
Company
Amoco Production Company
Date
11-10-82

I hereby certify that the well location shown on this plat was plotted from field notes of actual surveys made by me or under my supervision, and that the same is true and correct to the best of my knowledge and belief.

Date Surveyed
10-29-82
Registered Professional Engineer and/or Land Surveyor

John W. West
Certificate No. **JOHN W. WEST 676**
PATRICK A. ROMERO 6863
Ronald J. Eidson 3239



1. BOP'S TO BE FLUID OPERATED.
2. BOP'S AND ALL FITTINGS MUST BE IN GOOD CONDITION AND RATED AT 3000 PSI W.P. MINIMUM.
3. EQUIPMENT THROUGH WHICH BIT MUST PASS SHALL BE AT LEAST AS LARGE AS CASING SIZE BEING DRILLED THROUGH.
4. NIPPLE ABOVE BOP'S SHALL BE SAME SIZE AS LAST CASING SET.
5. UPPER KELLY COCK IS REQUIRED AND SHALL BE 3000# W.P. MINIMUM.
6. T. I. W. OR COMPARABLE SAFETY VALVE SHALL BE AVAILABLE ON RIG FLOOR WITH CONNECTION OR SUBS TO FIT ANY TOOL JOINT IN THE STRING. VALVE TO BE FULL BORE 5000# MIN.
7. VALVE NEXT TO SPOOL SHALL BE 4". OTHER EQUIPMENT MAY BE 3" OR 4". ALL CHOKE MANIFOLD EQUIPMENT SHALL BE FLANGED. FLOW LINE FROM MANIFOLD TO BE MINIMUM OF 3" AND STRAIGHT AS POSSIBLE WITH MINIMUM BENDS.
8. FLUID LINES FROM ACCUMULATOR TO BOP'S AND ALL REMOTE CONTROL FLUID LINES SHALL BE STEEL, AND RATED AT OR ABOVE MAXIMUM ACCUMULATOR PRESSURE. LINES SHALL BE ROUTED IN BUNDLES AND ADEQUATELY PROTECTED FROM DAMAGE.
9. USE RAMS IN FOLLOWING POSITIONS:*

	<u>DRILLING</u>	<u>RUNNING CASING</u>
UPPER RAM	DRILL PIPE	CASING
LOWER RAM	BLIND	BLIND

*AMOCO AREA SUPT. MAY REVERSE LOCATION OF RAMS.

10. CHOKER MANIFOLD, BEYOND SECOND VALVE FROM CROSS MAY BE OPTIONALLY POSITIONED OUTSIDE OF SUBSTRUCTURE.
11. EXTENSIONS AND HAND WHEELS TO BE INSTALLED AND BRACED AT ALL TIMES.
12. TWO INCH (2") LINES AND VALVES ARE PERMITTED ON THE KILL LINE.

NOTE: ALL UNMARKED VALVES MAY BE
PLUG OR GATE VALVE. METAL
TO METAL SEAL.

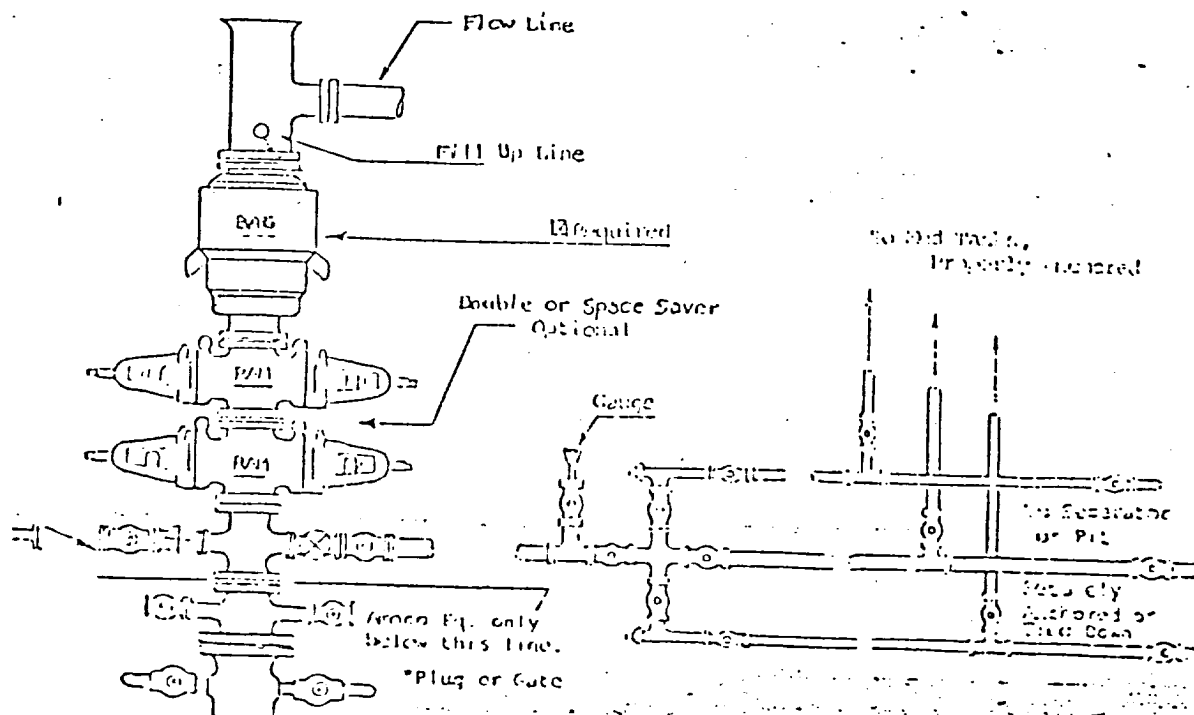

3000: W.P.