

STATE OF NEW MEXICO
ENERGY AND MINERALS DEPARTMENT

OIL CONSERVATION DIVISION
P.O. BOX 2088
SANTA FE, NEW MEXICO 87501

Form C-101
Revised 1-1-65

NO. OF COPIES RECEIVED	
DISTRIBUTION	
SANTA FE	<input checked="" type="checkbox"/>
ILE	<input checked="" type="checkbox"/>
S.G.S.	<input checked="" type="checkbox"/>
ND OFFICE	<input checked="" type="checkbox"/>
ERATOR	<input checked="" type="checkbox"/>

RECEIVED

DEC 6 1982

O. C. D.
ARTESIA, OFFICE

5A. Indicate Type of Lease
STATE ☒ FEE ☐

5. State Oil & Gas Lease No.
E-8560

XXXXXXXXXXXXXXXXXXXXXXXXXXXX
XXXXXXXXXXXXXXXXXXXXXXXXXXXX

7. Unit Agreement Name

8. Farm or Lease Name
Amoco Supron Mesa

9. Well No.
1

10. Field and Pool, or Wildcat
Und. Bunker Hill Penrose

XXXXXXXXXXXXXXXXXXXXXXXXXXXX
XXXXXXXXXXXXXXXXXXXXXXXXXXXX
XXXXXXXXXXXXXXXXXXXXXXXXXXXX

12. County
Eddy

XXXXXXXXXXXXXXXXXXXXXXXXXXXX
XXXXXXXXXXXXXXXXXXXXXXXXXXXX

APPLICATION FOR PERMIT TO DRILL, DEEPEN, OR PLUG BACK

TYPE OF WORK

DRILL ☒

DEEPEN ☐

PLUG BACK ☐

TYPE OF WELL

OIL

GAS

SINGLE

MULTIPLE

WELL ☒

WELL ☐

OTHER ☐

ZONE ☐

ZONE ☐

Name of Operator

Read & Stevens, Inc. ☒

Address of Operator

P.O. Box 1518, Roswell, NM 88201

Location of Well

UNIT LETTER E LOCATED 1980 FEET FROM THE North LINE

760 FEET FROM THE West LINE OF SEC. 13 TWP. 16S RGE. 31E NMPM

XXXXXXXXXXXXXXXXXXXXXXXXXXXX
XXXXXXXXXXXXXXXXXXXXXXXXXXXX
XXXXXXXXXXXXXXXXXXXXXXXXXXXX

XXXXXXXXXXXXXXXXXXXXXXXXXXXX
XXXXXXXXXXXXXXXXXXXXXXXXXXXX

XXXXXXXXXXXXXXXXXXXXXXXXXXXX	19. Proposed Depth	19A. Formation	20. Rotary or C.T.
XXXXXXXXXXXXXXXXXXXXXXXXXXXX	4250'	Penrose	Rotary
Elevations (Show whether DF, RT, etc.)	21A. Kind & Status Plug Bond	21B. Drilling Contractor	22. Approx. Date Work will start
4398' GR	Statewide	Sierra Drilg. Co. Rig #5	February 1, 1983

PROPOSED CASING AND CEMENT PROGRAM

SIZE OF HOLE	SIZE OF CASING	WEIGHT PER FOOT	SETTING DEPTH	SACKS OF CEMENT	EST. TOP
11"	8 5/8"	24#	1300'	500sx	Circ.
7 7/8"	4 1/2"	10.5#	4250'	600sx	3000'

We propose to drill and test the Penrose Sand formation. Approximately 1300' of 8 5/8" surface casing will be set to protect fresh water sands. Cement will be circulated. If the well is commercial, 4 1/2" production casing will be run and cemented to cover the pay zone with at least 600' of cement.

Mud Program: Native mud to 1300', brine 1300' to 3500', brine and starch 3500' to TD.

BOP Program: One 11" 5000psi WP Shaffer Type "LWS" Hydraulic operated, double BOP w/NL-Shaffer D05040-35 BOP control unit with 40 gal capacity.

APPROVAL VALID FOR 180 DAYS
PERMIT NUMBER 6-7-83
UNLESS DRILLING UNDERWAY

PLEASE DESCRIBE PROPOSED PROGRAM: IF PROPOSAL IS TO DEEPEN OR PLUG BACK, GIVE DATA ON PRESENT PRODUCTIVE ZONE AND PROPOSED NEW PRODUCTIVE ZONE. GIVE BLOWOUT PREVENTER PROGRAM, IF ANY.

I hereby certify that the information above is true and complete to the best of my knowledge and belief.

SIGNED B. Stubby TITLE Drilling & Production Manager DATE December 2, 1982

(This space for State Use)

APPROVED BY Mike Walker TITLE OIL AND GAS INSPECTOR DATE DEC 10 1982
REASONS OF APPROVAL, IF ANY:

NEW MEXICO OIL CONSERVATION COMMISSION
WELL LOCATION AND ACREAGE DEDICATION PLAT

Form C-102
Supersedes C-12H
Effective 1-1-81

All distances must be from the outer boundaries of the Section.

Owner READ & STEVENS INCORPORATED			Lease Amoco Supron Mesa		Well No. 1
Section E	Range 13	Township 16 South	Range 31 East	County Eddy	
Depth of Well					
1980		feet from the North line and		760 feet from the West line	
Depth of Well		Penetration Formation		Permitted Acreage	
4398.0'		Und. Bunker Hill Penrose		40	

- Outline the acreage dedicated to the subject well by colored pencil or hatchure marks on the plat below.
- If more than one lease is dedicated to the well, outline each and identify the ownership thereof (both as to working interest and royalty).
- If more than one lease of different ownership is dedicated to the well, have the interests of all owners been consolidated by communitization, unitization, force-pooling, etc?

☒ Yes ☐ No If answer is "yes," type of consolidation _____

If answer is "no," list the owners and tract descriptions which have actually been consolidated. (Use reverse side of this form if necessary.) _____

No allowable will be assigned to the well until all interests have been consolidated (by communitization, unitization, forced-pooling, or otherwise) or until a non-standard unit, eliminating such interests, has been approved by the Commission.

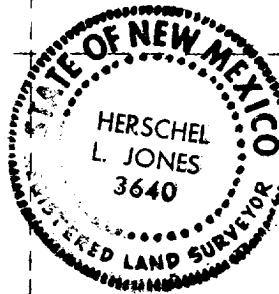
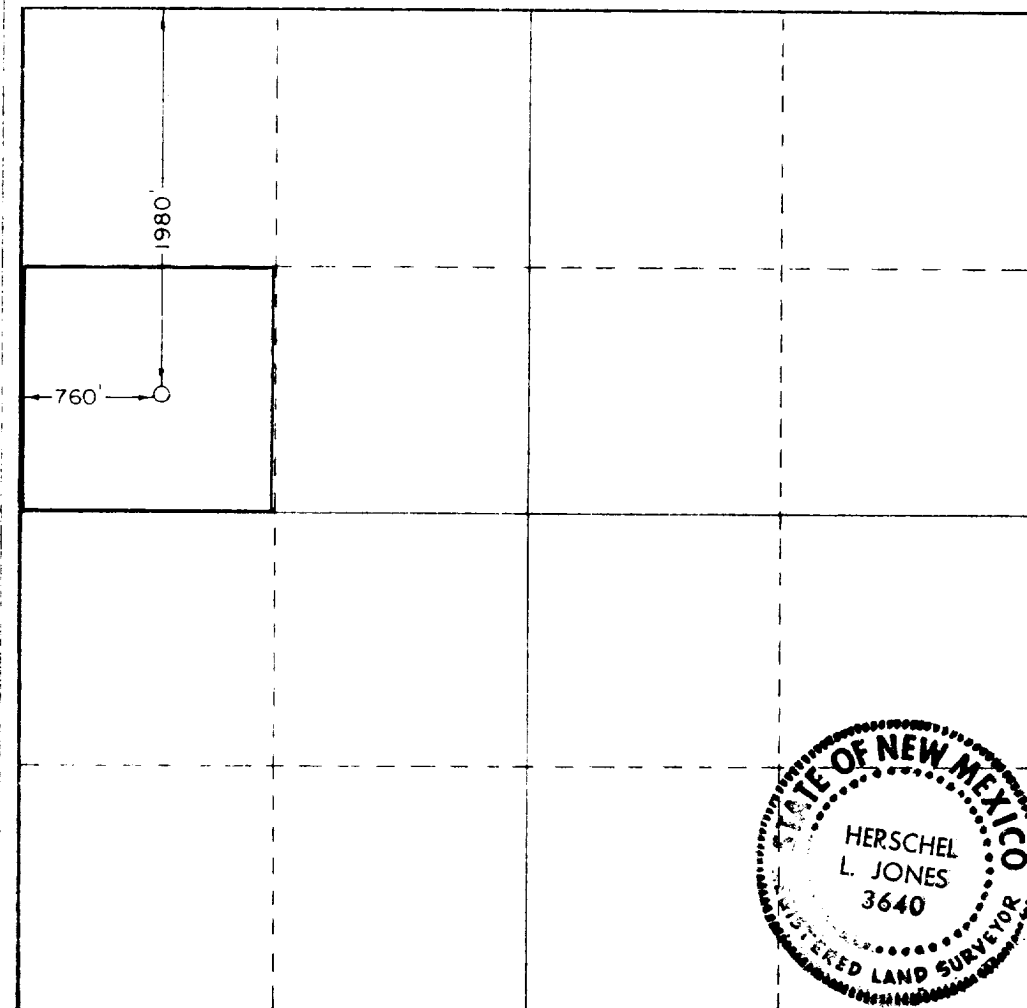

CERTIFICATION

I hereby certify that the information contained herein is true and complete to the best of my knowledge and belief.

Susie Russell

Name
Susie Russell
Position
Authorized Agent
Company
Read & Stevens, Inc.

Date
November 30, 1982

I hereby certify that the well location shown on this plat was plotted from field notes of actual surveys made by me or under my supervision, and that the same is true and correct to the best of my knowledge and belief.

Date Surveyed
November 17, 1982
Registered Professional Engineer and/or Land Surveyor

Herschel L. Jones

Certificate No.
3640

