

NM OIL CONS. COMMISSION

Drawer DD

Artesia, NM 88210

UNITED STATES
DEPARTMENT OF THE INTERIOR
GEOLOGICAL SURVEYSUBMIT IN 2 APPLICATIONS
(Other instructions on
reverse side)Form approved.
Budget Bureau No. 42-R1425.

30 015-24370

c/8 J

DEC 20 1982

5. LEASE DESIGNATION AND SERIAL NO.

NM-0439900

6. IF INDIAN, ALLOTTEE OR TRIBE NAME

7. UNIT AGREEMENT NAME

8. FARM OR LEASE NAME

Federal "CB" Com

9. WELL NO.

3

10. FIELD AND POOL, OR WILDCAT

Eagle Creek - 1-1-83

11. SEC., T., R., M., OR BLK.
AND SURVEY OR AREA

Sec. 15-T17S-R25E

12. COUNTY OR PARISH 13. STATE

Eddy

NM

17. NO. OF ACRES ASSIGNED
TO THIS WELL

320

20. ROTARY OR CABLE TOOLS

Rotary

22. APPROX. DATE WORK WILL START*

ASAP

APPLICATION FOR PERMIT TO DRILL, DEEPEN, OR PLUG BACK

1a. TYPE OF WORK

DRILL ☒DEEPEN ☐MINERALS MGMT. SERVICE
ROSWELL, NEW MEXICO
JAN 04 1983

b. TYPE OF WELL

OIL
WELL ☐GAS
WELL ☒

OTHER

SINGLE
ZONE ☐MULTIPLE
ZONE ☐

2. NAME OF OPERATOR

Yates Petroleum Corporation ✓

3. ADDRESS OF OPERATOR

207 S. 4th, Artesia, New Mexico 88210

4. LOCATION OF WELL (Report location clearly and in accordance with any State requirements.)

At surface

660' FSL and 1980' FWL

At proposed prod. zone

same

14. DISTANCE IN MILES AND DIRECTION FROM NEAREST TOWN OR POST OFFICE*

4 miles west of Artesia, NM.

15. DISTANCE FROM PROPOSED*

LOCATION TO NEAREST

PROPERTY OR LEASE LINE, FT.

(Also to nearest drlg. unit line, if any)

660'

16. NO. OF ACRES IN LEASE

840.31

18. DISTANCE FROM PROPOSED LOCATION*

TO NEAREST WELL, DRILLING, COMPLETED,
OR APPLIED FOR, ON THIS LEASE, FT.

330'

19. PROPOSED DEPTH

8150'

21. ELEVATIONS (Show whether DF, RT, GR, etc.)

3530' GL

23.

PROPOSED CASING AND CEMENTING PROGRAM

SIZE OF HOLE	SIZE OF CASING	WEIGHT PER FOOT	SETTING DEPTH	QUANTITY OF CEMENT
17 1/2"	13 3/8"	48#	appr. 360'	300 circulated
12 1/4"	8 5/8"	24#	appr. 1150'	600 circulated
7 7/8"	5 1/2"	10.5# K-11.6#	K TD	300
		15.5# K-17#K		

We propose to drill to the Morrow formation, test with approximately 360' of 13 3/8" casing to shut off gravel and caving and 8 5/8" casing will be set 100' below the Arteisan zone with cement and circulated. 4 1/2" or 5 1/2" production casing will be run to TD and cemented with 600' of coverage on pay. Will perforate and stimulate as needed for production.

MUD PROGRAM: Fresh water gel and LCM to 1150' water from 1150' casing point to 6200', KCL/starch/driskap/ to 7500', KCL gel & driskap to TD.

BOP PROGRAM: BOP's will be installed on 8 5/8" casing and tested daily.

GAS NOT DEDICATED.

IN ABOVE SPACE DESCRIBE PROPOSED PROGRAM: If proposal is to deepen or plug back, give data on present productive zone and proposed new productive zone. If proposal is to drill or deepen directionally, give pertinent data on subsurface locations and measured and true vertical depths. Give blowout preventer program, if any.

24.

SIGNED

TITLE Regulatory Manager

DATE 12/17/82

(This space for Federal or State office use)

PERMIT NO.

APPROVED

APPROVAL DATE

(ORIG. SGD.) DAVID R. GLASS

DATE

APPROVED BY

CONDITIONS OF APPROVAL, IF ANY:

DEC 21 1982

JAMES A. GILLHAM
DISTRICT SUPERVISORPosted 1-7-83
1-7-83

NEW MEXICO OIL CONSERVATION COMMISSION
WELL LOCATION AND ACREAGE DEDICATION PLAT

Form C-102
Supersedes C-128
Effective 1-1-65

All distances must be from the outer boundaries of the Section.

Operator YATES PETROLEUM CORPORATION			Lease Federal CB Com		Well No. 3
Unit Letter N	Section 15	Township 17 South	Range 25 East	County Eddy	
Actual Postage Location of Well:					
660 feet from the South line and		1980 feet from the West line			
Surface Elevation 3530.	Producing Formation MORROW	Pool EAGLE CREEK - 111.1	Dedicated Acreage 320 Acres		

1. Outline the acreage dedicated to the subject well by colored pencil or hatchure marks on the plat below.
2. If more than one lease is dedicated to the well, outline each and identify the ownership thereof (both as to working interest and royalty).
3. If more than one lease of different ownership is dedicated to the well, have the interests of all owners been consolidated by communitization, unitization, force-pooling, etc?

☒ Yes ☐ No If answer is "yes," type of consolidation **TO BE COMMUNITIZED**

If answer is "no," list the owners and tract descriptions which have actually been consolidated. (Use reverse side of this form if necessary.) _____

No allowable will be assigned to the well until all interests have been consolidated (by communitization, unitization, forced-pooling, or otherwise) or until a non-standard unit, eliminating such interests, has been approved by the Commission.

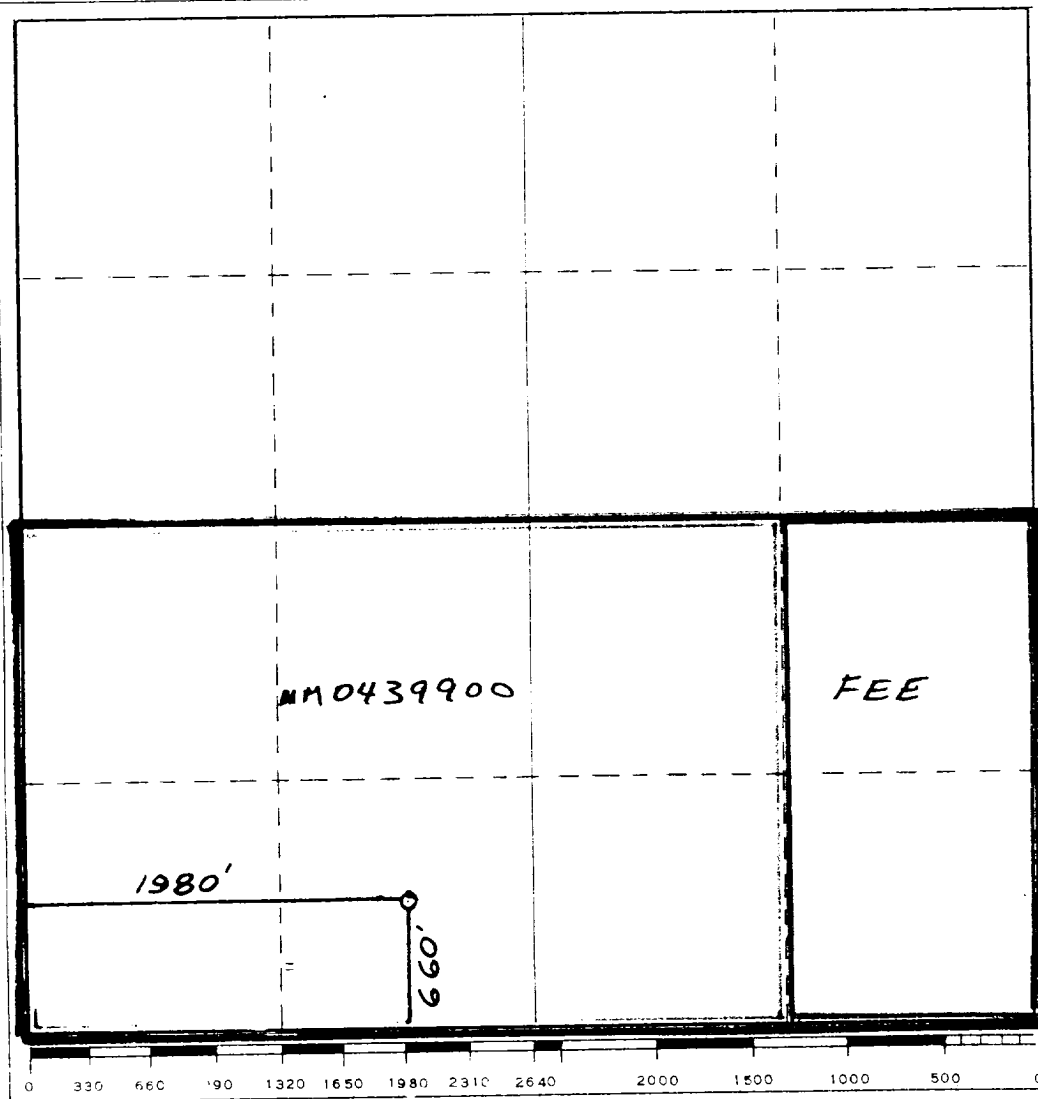

CERTIFICATION

I hereby certify that the information contained herein is true and complete to the best of my knowledge and belief.

Dan R. Reddy
Name
Regulatory Mgr.
Position
Yates Petroleum Corp.
Company

Date
12-24-82

I hereby certify that the well location shown on this plat was plotted from field notes of actual surveys made by me or under my supervision, and that the same is true and correct to the best of my knowledge and belief.

Date Surveyed
December 4, 1982
Registered Professional Engineer
and/or Land Surveyor

Dan R. Reddy
Certificate No.
NM PE&LS #5412

YATES PETROLEUM CORPORATION
Federal "CB" Com #3
660' FSL and 1980' FWL
Section 15-T17S-R25E
Eddy County, New Mexico

In conjunction with Form 9-331C, Application for Permit to Drill subject well, Yates Petroleum Corporation submits the following ten items of pertinent information in accordance with USGS requirements.

1. The geologic surface formation is alluvium.

2. The estimated tops of geologic markers are as follows:

San Andres	702'	Atoka	7657'
Glorieta	1981'	Morrow	7894'
Abo	4054'	Chester Lime	8064'
Wolfcamp Lime	5215'	TD	8150'
Cisco	6234'		
Lower Canyon	7111'		
Strawn	7275'		

3. The estimated depths at which anticipated water, oil or gas formations are expected to be encountered:

Water: 150'-250' 760'-1050'

Oil or Gas: Oil: Slaughter 1330'-1440', Gas: 5250'-5300', 6300'-6450',
7670'-7700', 7900'-8100'

4. Proposed Casing Program: See Form 9-331C.

5. Pressure Control Equipment: See Form 9-331C and Exhibit B.

6. Mud Program: See Form 9-331C.

7. Auxiliary Equipment: Kelly Cock; pit level indicators and flow sensor equipment;
sub with full-opening valve on floor, drill pipe connection.

8. Testing, Logging and Coring Program:

Mud Logging: One man unit out from under intermedi-te csg.

Samples: 10' out from under surface

DST's: as warranted

Coring: as warranted

Logging: CNL-FDC TD to csg w/GR-CNL to surface & DLL from TD to csg
w/RxO

9. No abnormal pressures or temperatures are anticipated.

10. Anticipated starting date: As soon as possible after approval.

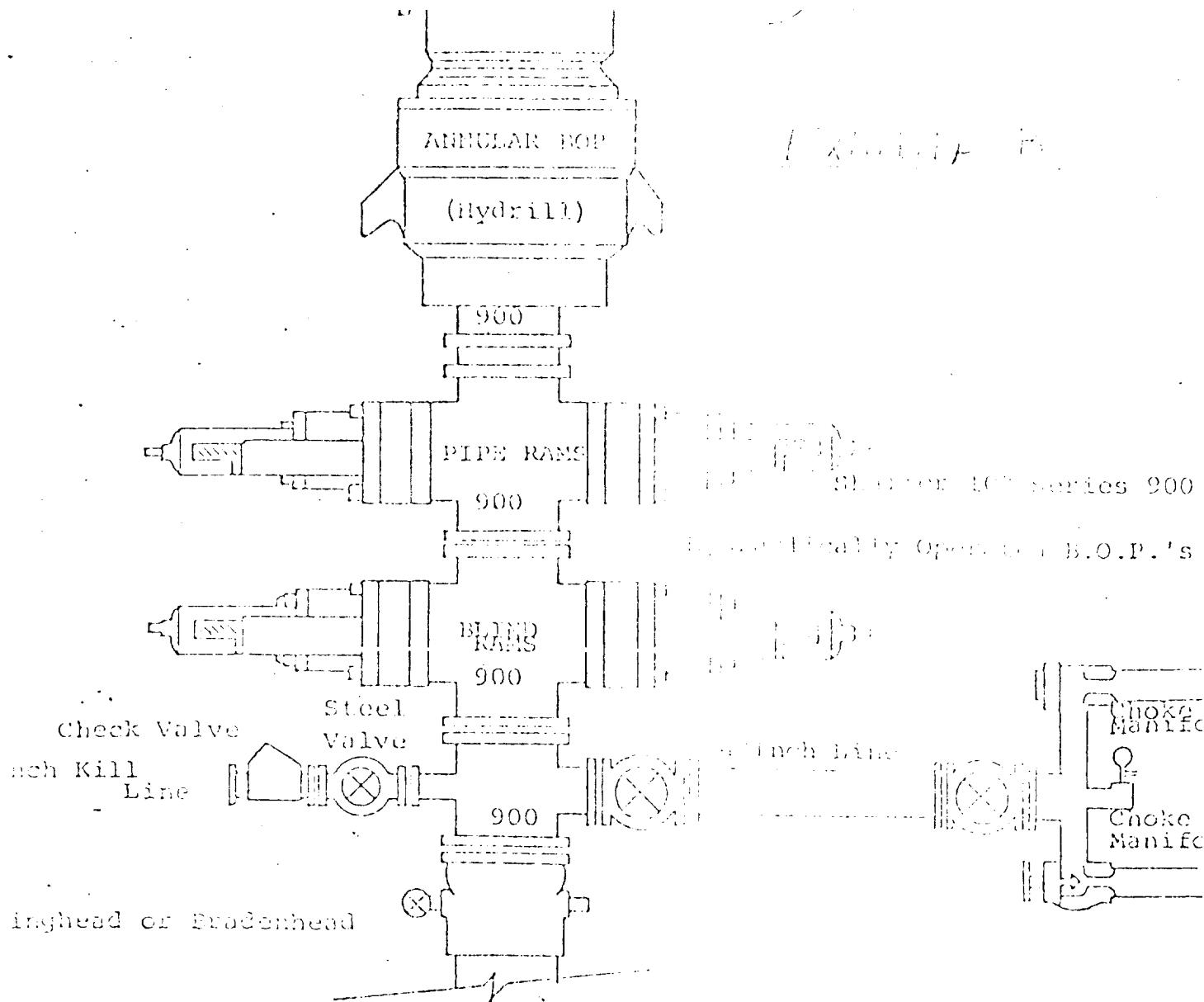

FOLLOWING CONSTITUTE MINIMUM BLOWOUT PREVENTER REQUIREMENTS

All preventers to be hydraulically operated with secondary manual controls installed prior to drilling out from under the rig.

Choke outlet to be a minimum of 4" diameter.

Kill line to be of all steel construction - 2" minimum diameter.

All connections from operating manifolds to preventers to be all steel. Hole or tube a minimum of one inch in diameter.

The available closing pressure shall be at least 100% in excess of that required with sufficient volume to operate the B.O.P.'s.

All connections to and from preventer to have a pressure rating equivalent to that of the B.O.P.'s.

Inside blowout preventer to be available during flow.

Operating controls located a safe distance from the rig floor.

Hole must be kept filled on trips before intermediate casing. Operator not responsible for blowouts resulting from not keeping hole full.

B. P. float must be installed and used before any of first gas intrusion.

Exhibit C

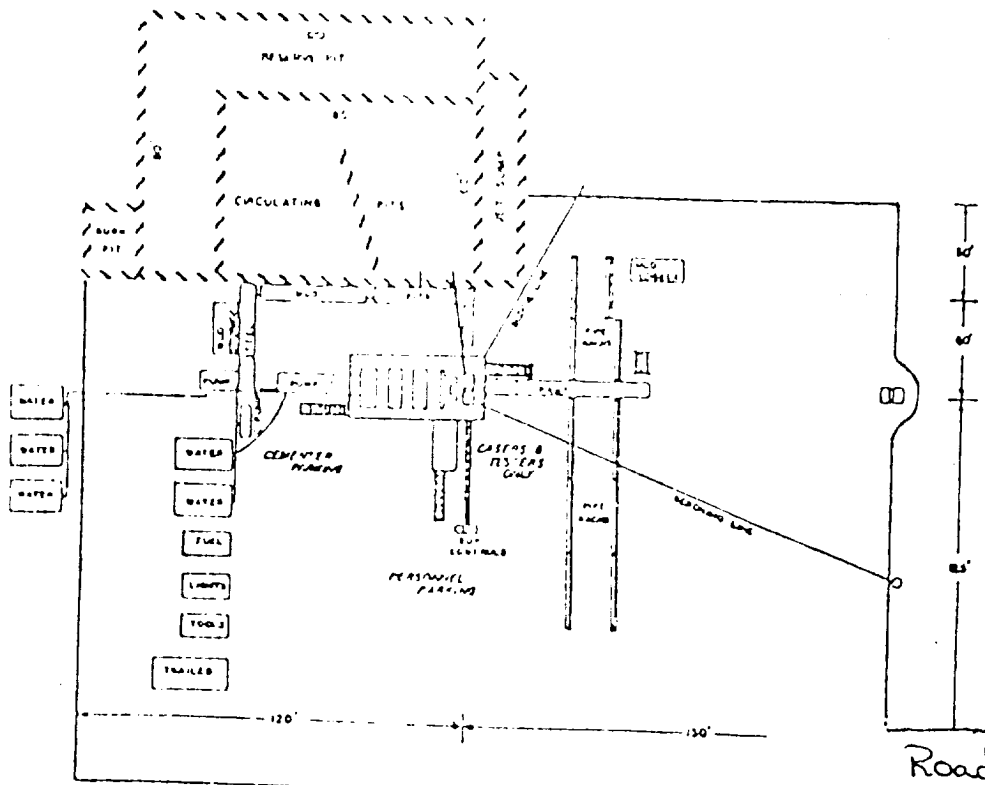

DRILLING RIG LAYOUT

Scale: 1 inch = 50 feet

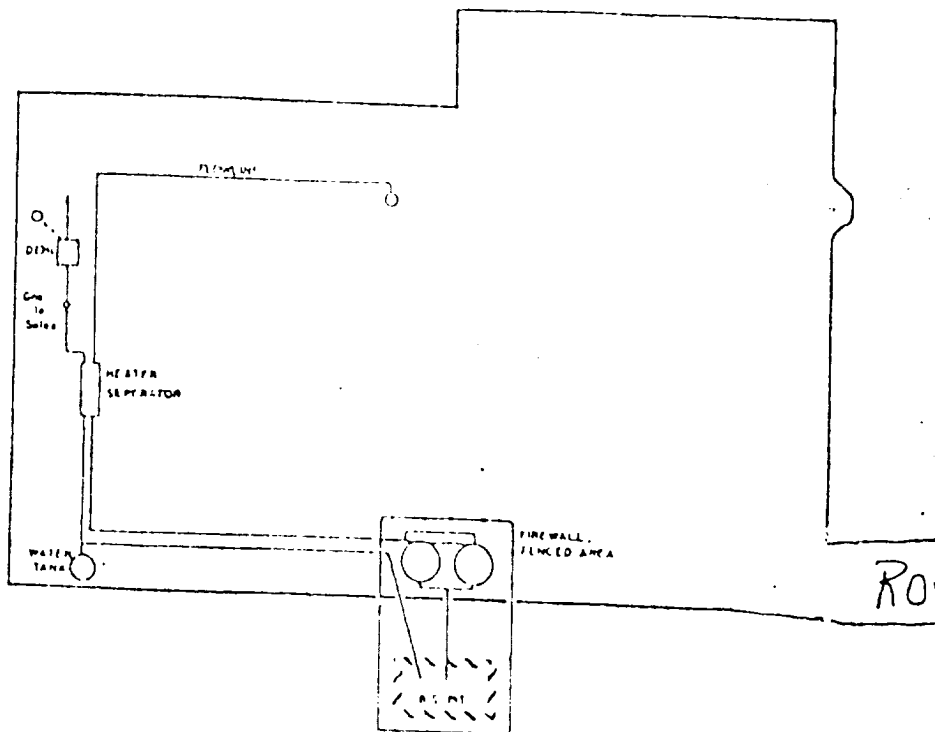

TANK BATTERY LAYOUT

Scale: 1 inch = 50 feet