

NO. OF COPIES RECEIVED	
DISTRIBUTION	
SANTA FE	<input checked="" type="checkbox"/>
FILE	<input checked="" type="checkbox"/>
U.S.G.S.	<input checked="" type="checkbox"/>
LAND OFFICE	<input checked="" type="checkbox"/>
OPERATOR	<input checked="" type="checkbox"/>

MAR 04 1983

O. C. D.

ARTESIA OFFICE

APPLICATION FOR PERMIT TO DRILL, DEEPEN, OR PLUG BACK

1. Type of Work

2. Type of Well

DRILL ☒DEEPEN ☐PLUG BACK ☐OIL WELL ☒GAS WELL ☐

OTHER

SINGLE ZONE ☐MULTIPLE ZONE ☐

Name of Operator

Yates Petroleum Corporation

Address of Operator

207 S. 4th, Artesia, New Mexico 88210

Location of Well

UNIT LETTER H A LOCATED 990 FEET FROM THE North LINE990 FEET FROM THE East LINE OF SEC. 23 TWP. 17S RGE. 25E N.M.P.M.

3A. Indicate Type of Lease

STATE ☐FEE ☒

5. State Oil & Gas Lease No.

7. Unit Agreement Name

8. Farm or Lease Name

Johnson "FE"

9. Well No.

4

10. Field and Pool, or Wildcat
Eagle Creek (SA)12. County
Eddy

19. Proposed Depth

1500'

19A. Formation

San Andres

20. Rotary or C.T.

Rotary

Elevations (Show whether Dr, RL, etc.)

3481' GL

21A. Kind & Status Plug. Bond

Blanket

21B. Drilling Contractor

AFT #1

22. Approx. Date Work will start

ASAP

PROPOSED CASING AND CEMENT PROGRAM

SIZE OF HOLE	SIZE OF CASING	WEIGHT PER FOOT	SETTING DEPTH	SACKS OF CEMENT	EST. TOP
14 1/2"	10 3/4"	30#	appr. 400'	200 sx	circulated
9 1/2"	7"	23#	1150'	400 sx	circulated
6 1/4"	4 1/2"	9.5#	TD	125 sx	circulated

We propose to drill a San Andres test with approximately 400' of surface casing to shut off gravel and caving. 7" intermediate casing will be run and set 100' below the Artesian water zone and if commercial production is encountered, a string will be run, perforated and stimulated for production.

MUD PROGRAM: FW gel/LCM to 1150', (or dry drill), water to TD.

BOP PROGRAM: BOP's will be installed on 7" casing and tested daily.

APPROVAL VALID FOR 150 DAYS
PERMIT EXPIRES 9/5/83
UNLESS DRILLING UNDERWAY

ABOVE SPACE DESCRIBE PROPOSED PROGRAM: IF PROPOSAL IS TO DEEPEN OR PLUG BACK, GIVE DATA ON PRESENT PRODUCTIVE ZONE AND PROPOSED NEW PRODUCTION ZONE. GIVE BLOWOUT PREVENTER PROGRAM, IF ANY.

I hereby certify that the information above is true and complete to the best of my knowledge and belief.

Signed Cy Cameron Title Regulatory Agent

Date 3/3/83

(This space for State Use)

PROVED BY Mike Walker

TITLE

OIL AND GAS INSPECTOR

DATE

MAR 08 1983

ADDITIONS OF APPROVAL, IF ANY:

Washed NEW O.C.C. in sufficient
time to assess cementing

the 7 casing

NEW MEXICO OIL CONSERVATION COMM. ON
WELL LOCATION AND ACREAGE DEDICATION PLAT

Form C-102
Supersedes C-128
Effective 1-1-65

All distances must be from the outer boundaries of the Section.

Operator YATES PETROLEUM CORPORATION		Lease Johnson FE		Well No. 4
Tract Letter A	Section 23	Township 17 South	Range 25 East	County Eddy

Actual Footage Location of Well:

990 feet from the North line and	990 feet from the East line
Ground Level Elev. 3481.	Producing Formation SAN ANDRES
Pool EAGLE CREEK (SA)	Dedicated Acreage: 40 Acres

1. Outline the acreage dedicated to the subject well by colored pencil or hachure marks on the plat below.
2. If more than one lease is dedicated to the well, outline each and identify the ownership thereof (both as to working interest and royalty).
3. If more than one lease of different ownership is dedicated to the well, have the interests of all owners been consolidated by communitization, unitization, force-pooling, etc?

☐ Yes ☒ No If answer is "yes," type of consolidation _____

If answer is "no," list the owners and tract descriptions which have actually been consolidated. (Use reverse side of this form if necessary.) _____

No allowable will be assigned to the well until all interests have been consolidated (by communitization, unitization, forced-pooling, or otherwise) or until a non-standard unit, eliminating such interests, has been approved by the Commission.

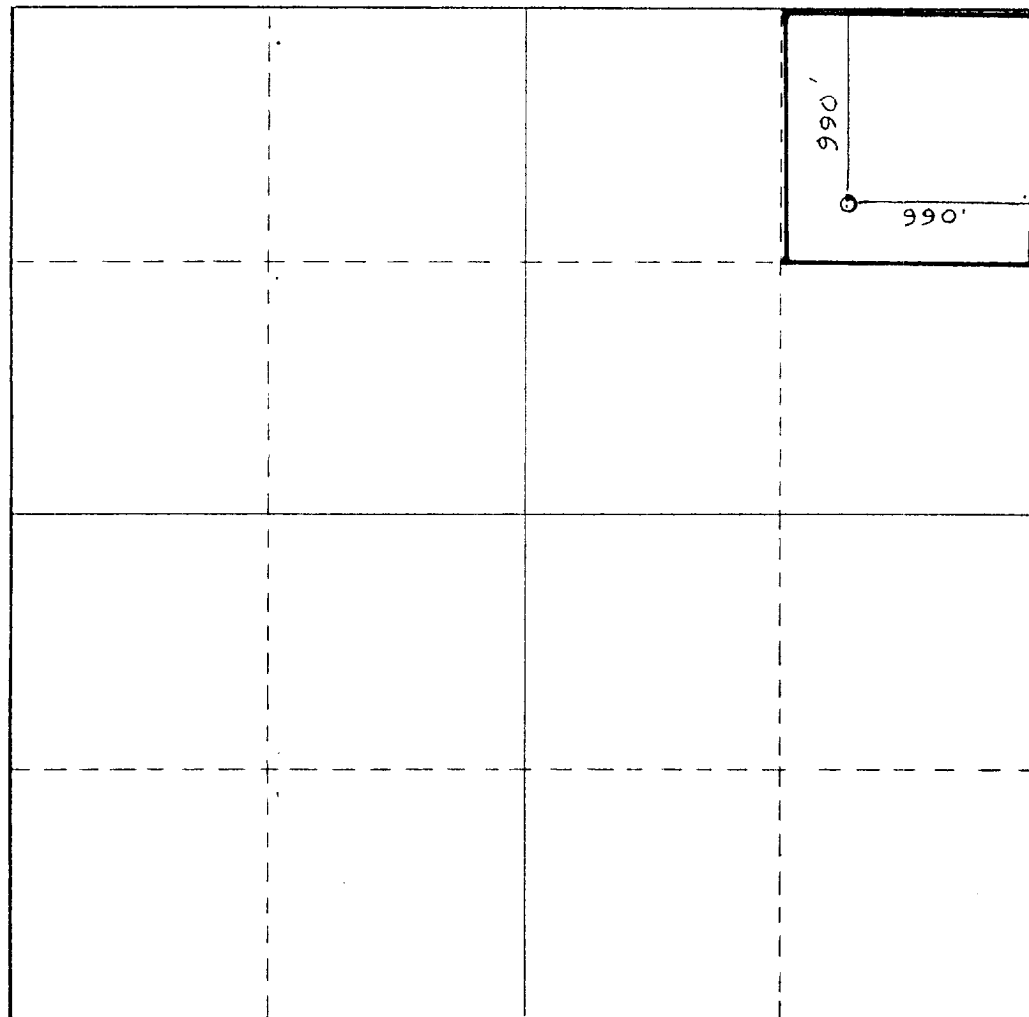

CERTIFICATION

I hereby certify that the information contained herein is true and complete to the best of my knowledge and belief.

Cy Cowan

Name

Cy Cowan

Position

Regulatory Agent

Company

Yates Petroleum Corp.

Date

3/3/83

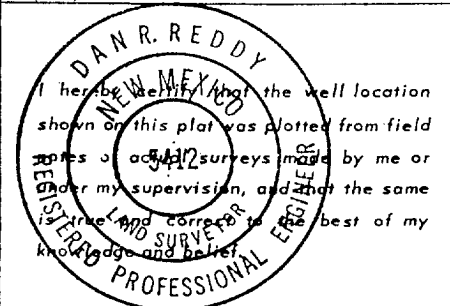

Date Surveyed

March 2, 1983

Registered Professional Engineer and/or Land Surveyor

Dan R. Reddy

Certificate No.

NM PE&LS #5412

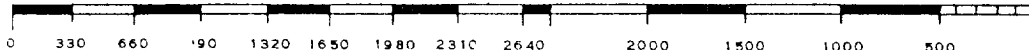

EXHIBIT B

BDP DIAGRAM

