

STATE OF NEW MEXICO
OIL AND MINERALS DEPARTMENT

OIL CONSERVATION DIVISION
P.O. BOX 2088
SANTA FE, NEW MEXICO 87501

Form C-101
Revised 10-1-78

NO. OF COPIES RECEIVED	
DISTRIBUTION	
SANTA FE	<input checked="" type="checkbox"/>
FILE	<input checked="" type="checkbox"/>
U.S.G.S.	<input checked="" type="checkbox"/>
LAND OFFICE	<input checked="" type="checkbox"/>
OPERATOR	<input checked="" type="checkbox"/>

MAR 04 1983

O. C. D.

APPLICATION FOR PERMIT TO DRILL, DEEPEN, OR PLUG BACK

Type of Work

DRILL ☒

DEEPEN ☐

PLUG BACK ☐

Type of Well

OIL WELL ☒

GAS WELL ☐

OTHER

SINGLE ZONE ☐

MULTIPLE ZONE ☐

Name of Operator

Yates Petroleum Corporation

Address of Operator

207 S. 4th, Artesia, New Mexico 88210

Location of Well

UNIT LETTER P

LOCATED 330

FEET FROM THE South

LINE

990

FEET FROM THE East

LINE OF SEC. 15

TWP. 17S

RGE. 25E

NMPM

5A. Indicate Type of Lease

STATE ☐

FEED ☒

5. State Oil & Gas Lease No.

7. Unit Agreement Name

8. Farm or Lease Name

Morris Estate CC

9. Well No.

7

10. Field and Pool, or Wildcat

Eagle Creek (SA)

17. County

Eddy

19. Proposed Depth

1500'

19A. Formation

San Andres

20. Rotary or C.T.

Rotary

Elevations (show whether DF, KT, etc.)

3509' GL

21A. Kind & Status Plug. Bond

Blanket

21B. Drilling Contractor

LaRue #2

22. Approx. Date Work will start

ASAP

PROPOSED CASING AND CEMENT PROGRAM

SIZE OF HOLE	SIZE OF CASING	WEIGHT PER FOOT	SETTING DEPTH	SACKS OF CEMENT	EST. TOP
14 1/2"	10 3/4"	30#	appr. 350'	200 sx	circulated
9 1/2"	7"	23#	appr. 1150'	400 sx	circulated
6 1/4"	4 1/2"	9.5#	TD	125 sx	

Proposed to drill a San Andres test with approximately 350' of surface casing to shut off gravel and caving. 7" intermediate casing will be run and set 100' below the Artesian Zone and if commercial production is encountered a string will be run, perforated and stimulated for production.

MUD PROGRAM: FW gel and LCM to 1150' (or dry drill), water to TD.

BOP PROGRAM: BOP's will be installed on 7" casing and tested daily.

GAS NOT DEDICATED.

APPROVAL VALID FOR 180 DAYS
PERMIT EXPIRES 9/4/83
UNLESS DRILLING UNDERWAY

ABOVE SPACE DESCRIBE PROPOSED PROGRAM: IF PROPOSAL IS TO DEEPEN OR PLUG BACK, GIVE DATA ON PRESENT PRODUCTIVE ZONE AND PROPOSED NEW PRODUCTIVE ZONE. GIVE BLOWOUT PREVENTER PROGRAM, IF ANY.

I hereby certify that the information above is true and complete to the best of my knowledge and belief.

By Kew Beardsley Title Regulatory Agent

Date 3/2/83

(This space for State Use)

APPROVED BY Mike Walker

TITLE

OIL AND GAS INSPECTOR

DATE MAR 08 1983

CONDITIONS OF APPROVAL, IF ANY:

Notify NMOPCC of completion

time to witness completion

the 2 casing

*Posted to log
3-11-83*

W MEXICO OIL CONSERVATION COMMISSION
WELL LOCATION AND ACREAGE DEDICATION PLAT

Form C-102
Supersedes C-128
Effective 1-1-65

All distances must be from the outer boundaries of the Section.

Operator YATES PETROLEUM CORPORATION			Lease Morris Estate CC		Well No. 7
Unit Letter P	Section 15	Township 17 South	Range 25 East	County Eddy	
Actual Footage Location of Well: 330 feet from the South line and 990 feet from the East line					
Ground Level Elev. 3509.	Producing Formation San Andres	Pool Eagle Creek (SA)	Dedicated Acreage: 40 Acres		

1. Outline the acreage dedicated to the subject well by colored pencil or hachure marks on the plat below.
2. If more than one lease is dedicated to the well, outline each and identify the ownership thereof (both as to working interest and royalty).
3. If more than one lease of different ownership is dedicated to the well, have the interests of all owners been consolidated by communitization, unitization, force-pooling, etc?

☐ Yes ☐ No If answer is "yes," type of consolidation _____

If answer is "no," list the owners and tract descriptions which have actually been consolidated. (Use reverse side of this form if necessary.) _____

No allowable will be assigned to the well until all interests have been consolidated (by communitization, unitization, forced-pooling, or otherwise) or until a non-standard unit, eliminating such interests, has been approved by the Commission.

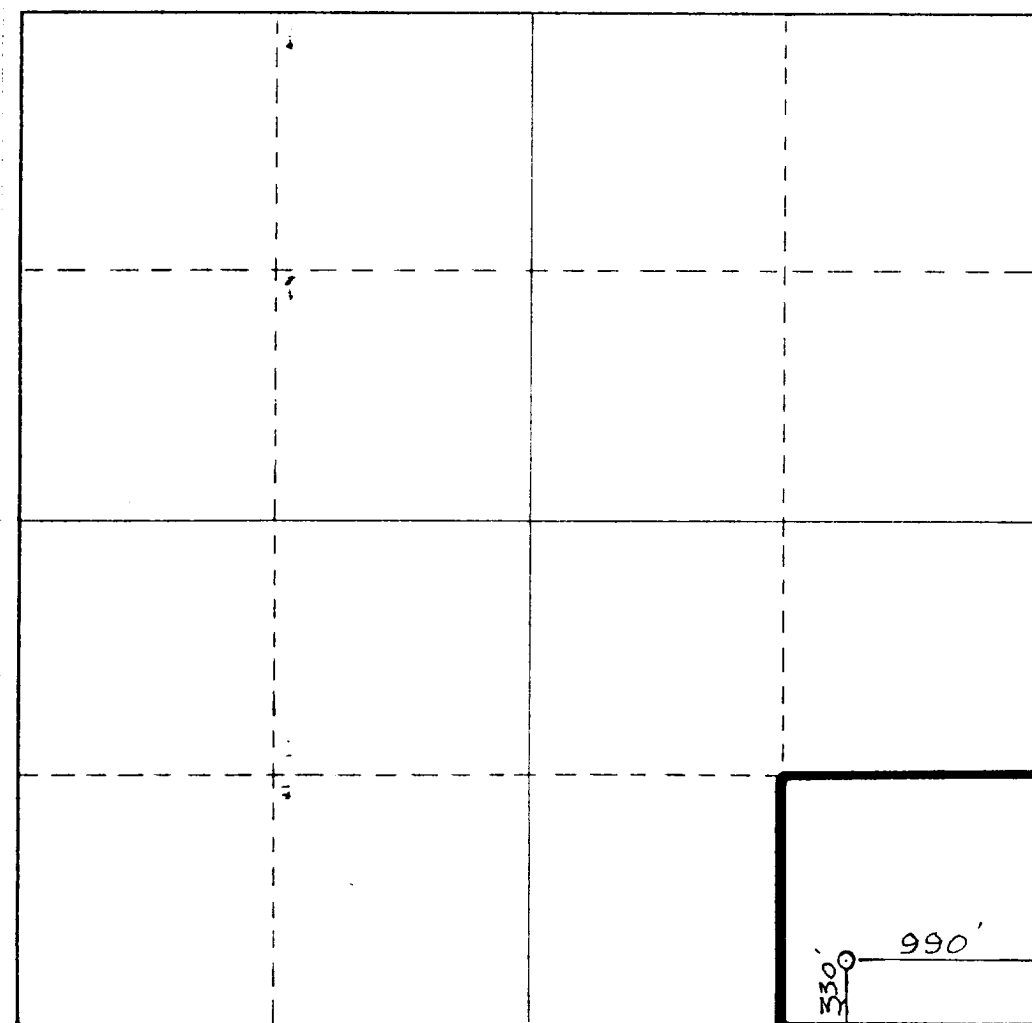

CERTIFICATION

I hereby certify that the information contained herein is true and complete to the best of my knowledge and belief.

Name

Ken Beardemphl

Position

Regulatory Agent

Company

Yates Petroleum Corp.

Date

3/2/83

herby certify that the well location shown on this plat was plotted from field notes of actual surveys made by me or under my supervision, and that the same is true and correct to the best of my knowledge and belief.

Date Surveyed

March 1, 1983

Registered Professional Engineer and/or Land Surveyor

Certificate No.

NM PE&LS #5412

EXHIBIT D

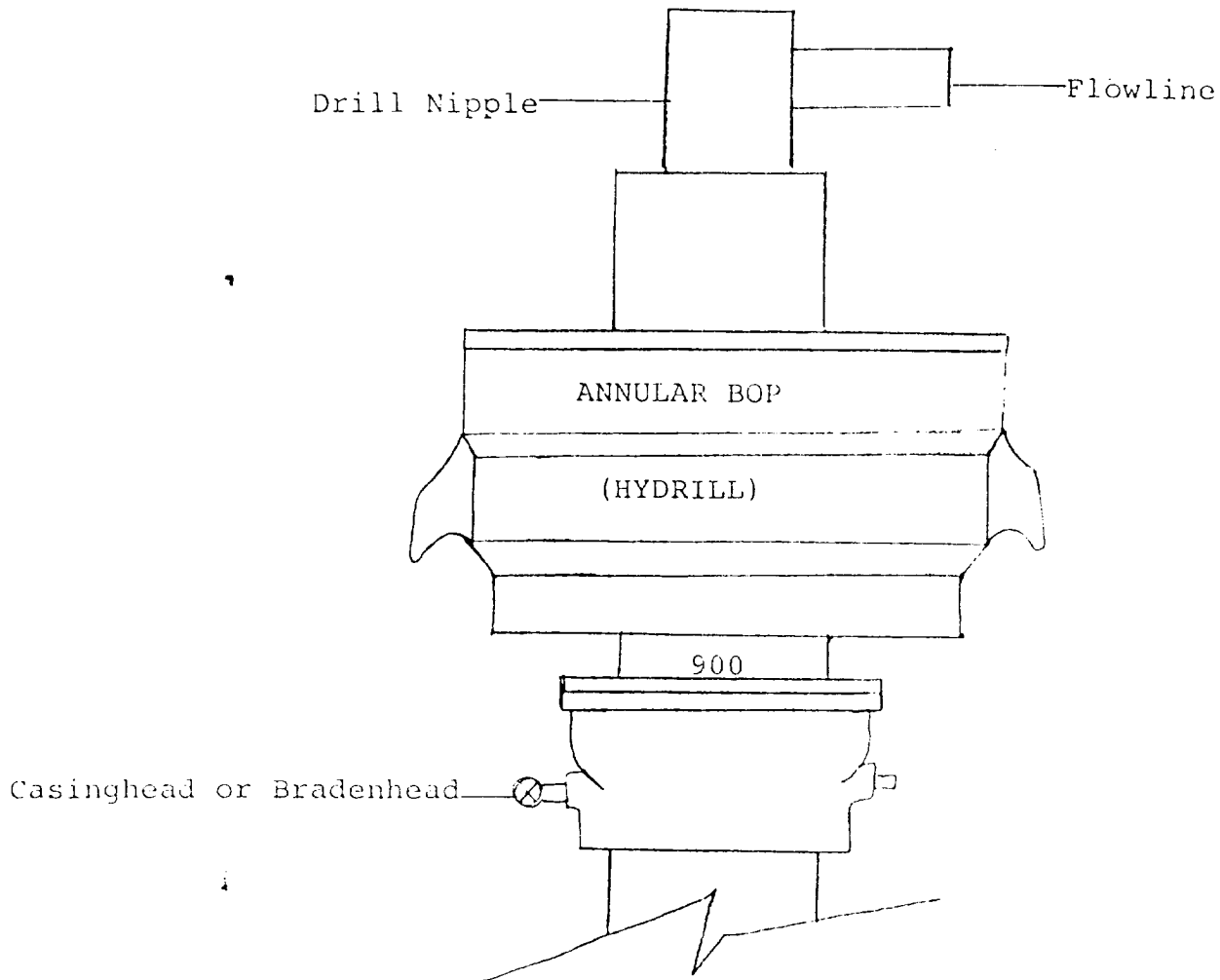

THE FOLLOWING CONSTITUTE MINIMUM BLOWOUT PREVENTER REQUIREMENTS

1. All preventers to be hydraulically operated with secondary manual controls installed prior to drilling out from under casing.
2. All connections from operating manifolds to preventers to be all steel. Hole or tube a minimum of one inch in diameter.
3. The available closing pressure shall be at least 15% in excess of that required with sufficient volume to operate the BOP's.
4. All connections to and from preventer to have a pressure rating equivalent to that of the BOP's.
5. Hole must be kept filled on trips below intermediate casing.