

DISTRIBUTION		
SANTA FE	✓	
FILE	✓	✓
U.S.G.S.	2	
LAND OFFICE	✓	
OPERATOR	✓	

RECEIVED

APR 20 1983

5A. Indicate Type of Lease	STATE <input checked="" type="checkbox"/>	FEL <input type="checkbox"/>
5. State Oil & Gas Lease No.	LG-8286	

APPLICATION FOR PERMIT TO DRILL, DEEPEN, OR PLUG BACK **O. C. D.**

1a. Type of Work DRILL <input checked="" type="checkbox"/> DEEPEN <input type="checkbox"/> PLUG BACK <input type="checkbox"/>		ARTESIA, OFFICE	
b. Type of Well OIL WELL <input checked="" type="checkbox"/> GAS WELL <input type="checkbox"/> OTHER <input type="checkbox"/>		SINGLE ZONE <input type="checkbox"/> MULTIPLE ZONE <input type="checkbox"/>	
2. Name of Operator Collier Energy, Inc. ✓		7. Unit Agreement Name	
3. Address of Operator P.O. Drawer R Artesia, New Mexico 88210		8. Farm or Lease Name Suzy-Q	
4. Location of Well UNIT LETTER <u>W</u> LOCATED <u>660</u> FEET FROM THE <u>South</u> LINE <u>SWSE</u> AND <u>1980</u> FEET FROM THE <u>East</u> LINE OF SEC. <u>2</u> TWP. <u>16S</u> RGE. <u>29E</u> NADP4		9. Well No. #1	
		10. Field and Pool, or Wildcat Wildcat - San Andres	
		17. County Eddy	
		19. Proposed Depth 3500'	
		19A. Formation San Andres	
		20. Rotary or C.T. Rotary	
21. Elevations (Show whether DT, RT, etc.) 3727.1		21A. Kind & Status Plug. Bond Statewide	
		21B. Drilling Contractor Collier Drilling	
		22. Approx. Date Work will start May 1, 1983	

23.

## PROPOSED CASING AND CEMENT PROGRAM

SIZE OF HOLE	SIZE OF CASING	WEIGHT PER FOOT	SETTING DEPTH	SACKS OF CEMENT	EST. TOP
10 3/4"	8 5/8"	24#	500' <sup>1</sup> 350' <sup>2</sup>	350 sxs	Surface
7 7/8"	5 1/2"	15.5#	3500"	500 sxs	Surface

Plan to spud May 1, 1983, Artesia Queen Grayburg San Andres test with 10 3/4 bit set 500' of 8 5/8", 24# casing, cement to surface with 350 sxs Class "C" neat. Drill out with 7 7/8" bit with 10# brine to proposed depth of 2600'. If commercial shows are present, 5 1/2, 15.5# casing will be set with 500 sxs Class "C" neat and circulate to surface. If dry hole, proper plugs will be set as prescribed by NM OCD.

ADDITIONAL TIME FOR 180 DAYS  
10-22-83  
UNLESS DRILLING UNDERWAY

IN ABOVE SPACE DESCRIBE PROPOSED PROGRAM: IF PROPOSAL IS TO DEEPEN OR PLUG BACK, GIVE DATA ON PRESENT PRODUCTIVE ZONE AND PROPOSED NEW PROGRAM. GIVE BLOWOUT PREVENTER PROGRAM, IF ANY.

I hereby certify that the information above is true and complete to the best of my knowledge and belief.

Signed [Signature] Title Production Clerk Date April 19, 1983

(This space for State Use)

APPROVED BY [Signature] TITLE OIL AND GAS INSPECTOR DATE APR 22 1983

Posted APR 22 1983  
JED 10:16  
4-22-83

**MEXICO OIL CONSERVATION COMMISS.**  
**WELL LOCATION AND ACREAGE DEDICATION PLAT**

Form C-102  
**RECEIVED**  
 Revised C-128  
 Effective 1-1-65

All distances must be from the outer boundaries of the Section

**APR 20 1983**

**O. C. D.**  
**ARTESIA, OFFICE**

Operator <b>Collier Energy, Inc.</b>		Lease <b>Suzy Q</b>		Well No. <b>1</b>	
Unit Letter <b>W</b>	Section <b>2</b>	Township <b>16 South</b>	Range <b>29 East</b>	County <b>Eddy County</b>	
Actual Footage Location of Well:					
<b>660</b> feet from the <b>South</b> line and		<b>1980</b> feet from the <b>East</b> line			
Ground Level Elev. <b>3727.1</b>	Producing Formation <b>SA Slaughter Zone</b>	Pool <b>Wildcat</b>	Dedicated Acreage: <b>40</b> Acres		

1. Outline the acreage dedicated to the subject well by colored pencil or hachure marks on the plat below.
2. If more than one lease is dedicated to the well, outline each and identify the ownership thereof (both as to working interest and royalty).
3. If more than one lease of different ownership is dedicated to the well, have the interests of all owners been consolidated by communitization, unitization, force-pooling, etc?

☐ Yes ☐ No If answer is "yes," type of consolidation \_\_\_\_\_

If answer is "no," list the owners and tract descriptions which have actually been consolidated. (Use reverse side of this form if necessary.) \_\_\_\_\_

No allowable will be assigned to the well until all interests have been consolidated (by communitization, unitization, forced-pooling, or otherwise) or until a non-standard unit, eliminating such interests, has been approved by the Commission.

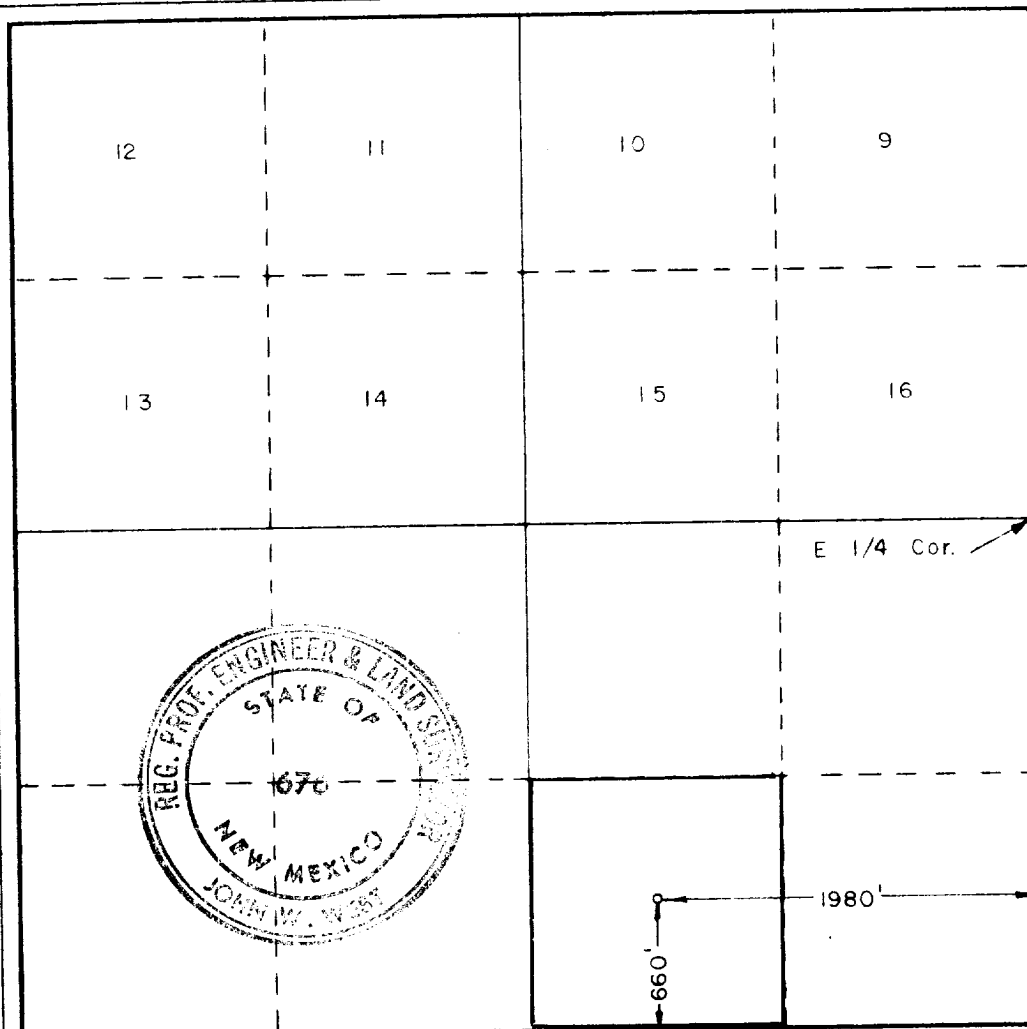

**CERTIFICATION**

I hereby certify that the information contained herein is true and complete to the best of my knowledge and belief.

Name	<i>Dianna J. Hall</i>
Position	<b>Production Clerk</b>
Company	<b>Collier Energy, Inc.</b>
Date	<b>April 15, 1983</b>

I hereby certify that the well location shown on this plat was plotted from field notes of actual surveys made by me or under my supervision, and that the same is true and correct to the best of my knowledge and belief.

Date Surveyed	<b>04/11/83</b>
Registered Professional Engineer and/or Land Surveyor	<i>John W. West</i>
Certificate No.	<b>JOHN W. WEST NO. 676</b>

