

NO. OF COPIES RECEIVED	
DISTRIBUTION	
SANTA FE	<input checked="" type="checkbox"/>
FILE	<input checked="" type="checkbox"/>
U.S.G.S.	<input checked="" type="checkbox"/>
LAND OFFICE	<input checked="" type="checkbox"/>
OPERATOR	<input checked="" type="checkbox"/>

P. O. BOX 2088
SANTA FE, NEW MEXICO 87501

JUL 27 1983

O. C. D.

ARTESIA, OFFICE

5A. Indicate Type of Lease

STATE ☐FEE ☒

5. State Oil & Gas Lease No.

APPLICATION FOR PERMIT TO DRILL, DEEPEN, OR PLUG BACK

1. Type of Work

DRILL ☒DEEPEN ☐PLUG BACK ☐

2. Type of Well

OIL WELL ☒GAS WELL ☐OTHER ☐SINGLE ZONE ☐MULTIPLE ZONE ☐

Name of Operator

Yates Petroleum Corporation

Address of Operator

207 S. 4th, Artesia, New Mexico 88210

Location of Well

UNIT LETTER K

LOCATED 1980

FEET FROM THE South

LINE

1980 FEET FROM THE West

LINE OF SEC. 23

TWP. 17S

RGE. 25E

NMPM

7. Unit Agreement Name

8. Farm or Lease Name

Gissler "AV"

9. Well No.

37

10. Field and Pool, or Wildcat

Eagle Creek/SA

12. County

Eddy

19. Proposed Depth

1500'

19A. Formation

San Andres

20. Rotary or C.T.

Rotary

21. Elevations (show whether D.F., K.T., etc.)

3500'

21A. Kind & Status Plug. Bond

Blanket

21B. Drilling Contractor

LaRue #2

22. Approx. Date Work will start

ASAP

PROPOSED CASING AND CEMENT PROGRAM

SIZE OF HOLE	SIZE OF CASING	WEIGHT PER FOOT	SETTING DEPTH	SACKS OF CEMENT	EST. TOP
14 3/4"	10 3/4"	30#	appr. 320'	200 sx	circulated
9 1/2"	7"	23#	appr. 1150'	400 sx	circulated
6 1/4"	4 1/2"	9.5#	TD	125 sx	circulated

We propose to drill a San Andres test. Approximately 320' of surface casing will be run to shut off gravel and caving. 7" intermediate casing will be run and set 100' below the Artesian Zone. If commercial production is encountered, a string will be run, perforated and stimulated for production.

MUD PROGRAM: FW gel/LCM to 1100' (or dry drill), water to TD.

BOP PROGRAM: BOP's will be installed on 7" casing and tested daily.

APPROVAL VALID FOR 180 DAYS
PERMIT EXPIRES 1-28-84
UNLESS DRILLING IS UNDERWAY

*Approved by
490-10108 Book
7-19-83*

ABOVE SPACE DESCRIBE PROPOSED PROGRAM: IF PROPOSAL IS TO DEEPEN OR PLUG BACK, GIVE DATA ON PRESENT PRODUCTIVE ZONE AND PROPOSED NEW PRODUCTION ZONE. GIVE BLOWOUT PREVENTER PROGRAM, IF ANY.

I hereby certify that the information above is true and complete to the best of my knowledge and belief.

Signed Arthur Rodriguez

Title Regulatory Agent

Date 7/26/83

(This space for State Use)

APPROVED BY Mike Williams

TITLE OIL AND GAS INSPECTOR

DATE JUL 28 1983

ADDITIONS OF APPROVAL, IF ANY:

Notify P.O. Box 2088, Santa Fe, NM 87501

that I am running

the 7 casing

NEW MEXICO OIL CONSERVATION COMMISSION
WELL LOCATION AND ACREAGE DEDICATION PLAT

Form C-102
Supersedes C-128
Effective 1-1-65

All distances must be from the outer boundaries of the Section.

Operator YATES PETROLEUM CORPORATION		Lease Gissler AV		Well No. 37
Unit Letter K	Section 23	Township 17 South	Range 25 East	County Eddy
Actual Footage Location of Well:				
1980 feet from the South line and		1980 feet from the West line		
Ground Level Elev. 3500	Producing Formation San Andres	Pool Eagle Creek/San Andres	Dedicated Acreage: 40 Acres	

1. Outline the acreage dedicated to the subject well by colored pencil or hatchure marks on the plat below.
2. If more than one lease is dedicated to the well, outline each and identify the ownership thereof (both as to working interest and royalty).
3. If more than one lease of different ownership is dedicated to the well, have the interests of all owners been consolidated by communitization, unitization, force-pooling, etc?

☐ Yes ☐ No If answer is "yes," type of consolidation _____

If answer is "no," list the owners and tract descriptions which have actually been consolidated. (Use reverse side of this form if necessary.) _____

No allowable will be assigned to the well until all interests have been consolidated (by communitization, unitization, forced-pooling, or otherwise) or until a non-standard unit, eliminating such interests, has been approved by the Commission.

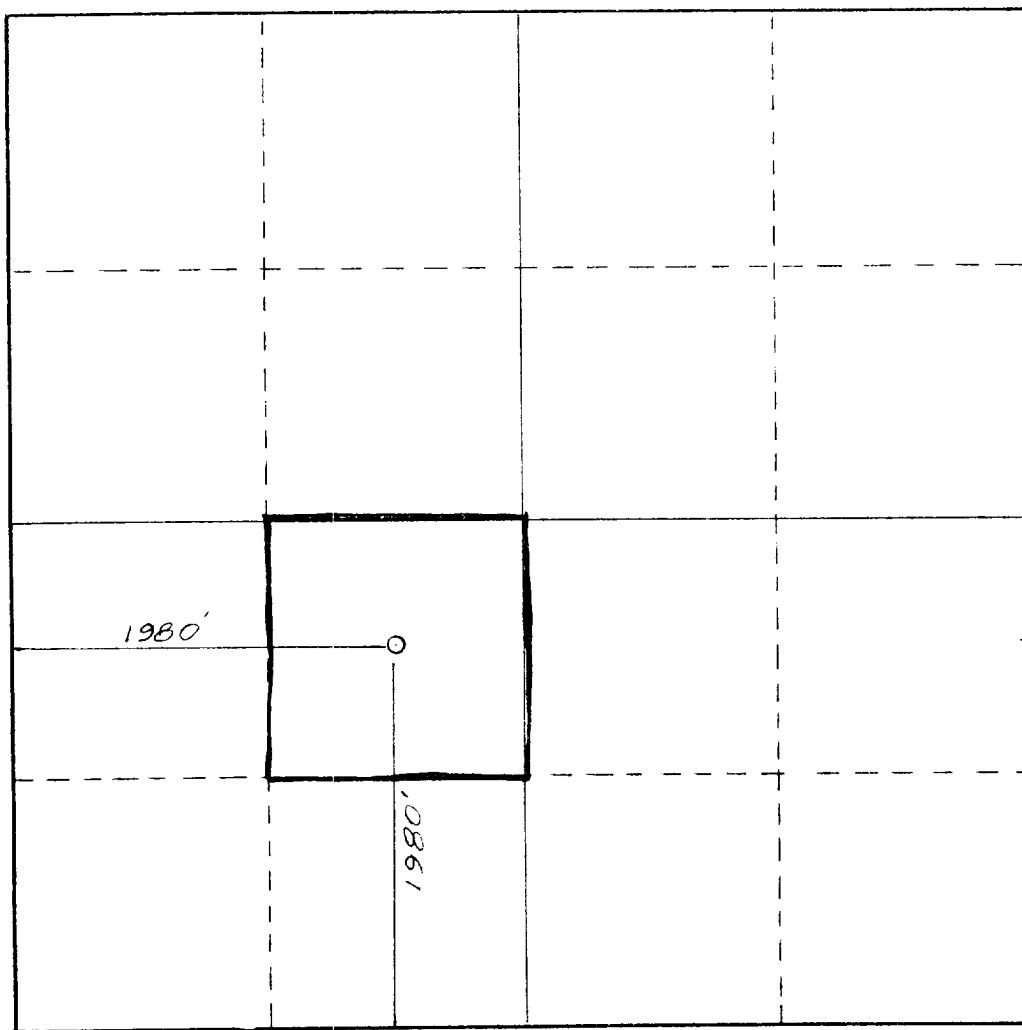

CERTIFICATION

I hereby certify that the information contained herein is true and complete to the best of my knowledge and belief.

Gliserio Rodriguez
Name

Gliserio Rodriguez

Position

Regulatory Agent

Company

Yates Petroleum Corp.

Date

7/25/83

I hereby certify that the well location shown on this plat was plotted from field notes of actual surveys made by me or under my supervision, and that the same is true and correct to the best of my knowledge and belief.

DAN R. REDDY
NEW MEXICO
REGISTERED PROFESSIONAL ENGINEER
AND SURVEYOR
#5412

Date Surveyed

July 24, 1983

Registered Professional Engineer and/or Land Surveyor

Dan R. Reddy
Certificate No.

NM PE&LS #5412

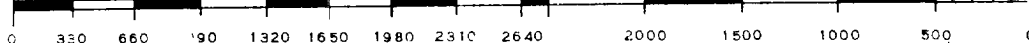

EXHIBIT B

BDP DIAGRAM

