

NO. OF COPIES RECEIVED	
DISTRIBUTION	
SANTA FE	<input checked="" type="checkbox"/>
FILE	<input checked="" type="checkbox"/>
U.S.G.S.	<input checked="" type="checkbox"/>
LAND OFFICE	<input checked="" type="checkbox"/>
OPERATOR	<input checked="" type="checkbox"/>

AUG 16 1983

O. C. D.

APPLICATION FOR PERMIT TO DRILL, DEEPEN, (ARTESIA) OFFICE

5A. Indicate Type of Lease	
STATE <input checked="" type="checkbox"/>	FEE <input type="checkbox"/>
5. State Oil & Gas Lease No.	
B-11593	
7. Unit Agreement Lease	
8. Leasehold Name	
Sunray State	
9. Well No.	
2	
10. Locality	
Red Lake Qn Grbg SA	
11. Eddy	
Eddy	
12. Depth	
2900'	
San Andres	
Rotary	
13. Approx. Date Work will start	
8/19/83	

Type of Work

Type of Well DRILL ☒ DEEPEN ☐ PLUG BACK ☐

Gas Well ☒ Other ☐ Single ☒ Multiple ☐

Name of Operator
Marbob Energy Corporation

Address of Operator
P.O. Drawer 217, Artesia, N.M. 88210

Location of Well UNIT LETTER L 2075 South

330 West 27 17S 28E

3682.3' GR	Statewide active	Artesia Fishing Tools	8/19/83
------------	------------------	-----------------------	---------

PROPOSED CASING AND CEMENT PROGRAM

SIZE OF HOLE	SIZE OF CASING	WEIGHT PER FOOT	SLEEFER DEPTH	THICKNESS OF CEMENT	EST. TOP
12 1/4"	8 5/8"	24#	500'	300	Circulate
7 7/8"	5 1/2"	15.50#	2900'	550	Attempt to circ

We propose to drill to 500' and run 8 5/8" 24# new casing, cement, circulate cement, drill on to 2900' to test the San Andres formation, run 5 1/2" casing and cement.

*Posted a pd
JD-11593
8-19-83*

APPROVAL VALID FOR 180 DAYS
PERMIT NO. 2-25-84
UNLESS DRILLING UNDERWAY

PLEASE DISCLOSE PROPOSED PROGRAM IF PROPOSAL IS TO DEEPEN OR PLUG BACK, GIVE DATA ON PRESENT PRODUCTIVE ZONE AND PROPOSED NEW PRODUCTION ZONE, GIVE PRODUCTION PROGRAM, IF ANY.

I certify that the information above is true and complete to the best of my knowledge and belief.

Carolee Morris Title Production Clerk Date 8/15/83

(This space for State use)

Original Signed By
Leslie A. Clements
Supervisor District II

AUG 19 1983

COPIES BY TITLE DATE

COPIES OF APPROVAL, IF ANY

NEW MEXICO OIL CONSERVATION COMMISSION
WELL LOCATION AND ACREAGE DEDICATION PLAT

Form C-102
Supersedes C-128
Effective 1-1-65

All distances must be from the outer boundaries of the Section

Marbob Energy Corporation			Lease Sunray State		Well No. 2
Letter L	Section 27	Township 17 South	Range 28 East	County Eddy County	
Well Location of Well:					
2075 feet from the South line and		330 feet from the West line			
Well Level Elev. 3682.3	Producing Formation San Andres	Pool Red Lake On Grbg SA	Dedicated Acreage: 40 Acres		

1. Outline the acreage dedicated to the subject well by colored pencil or hachure marks on the plat below.
2. If more than one lease is dedicated to the well, outline each and identify the ownership thereof (both as to working interest and royalty).
3. If more than one lease of different ownership is dedicated to the well, have the interests of all owners been consolidated by communitization, unitization, force-pooling, etc?
- ☒ Yes ☐ No If answer is "yes," type of consolidation _____

If answer is "no," list the owners and tract descriptions which have actually been consolidated. (Use reverse side of this form if necessary.) _____

No allowable will be assigned to the well until all interests have been consolidated (by communitization, unitization, forced-pooling, or otherwise) or until a non-standard unit, eliminating such interests, has been approved by the Commission.

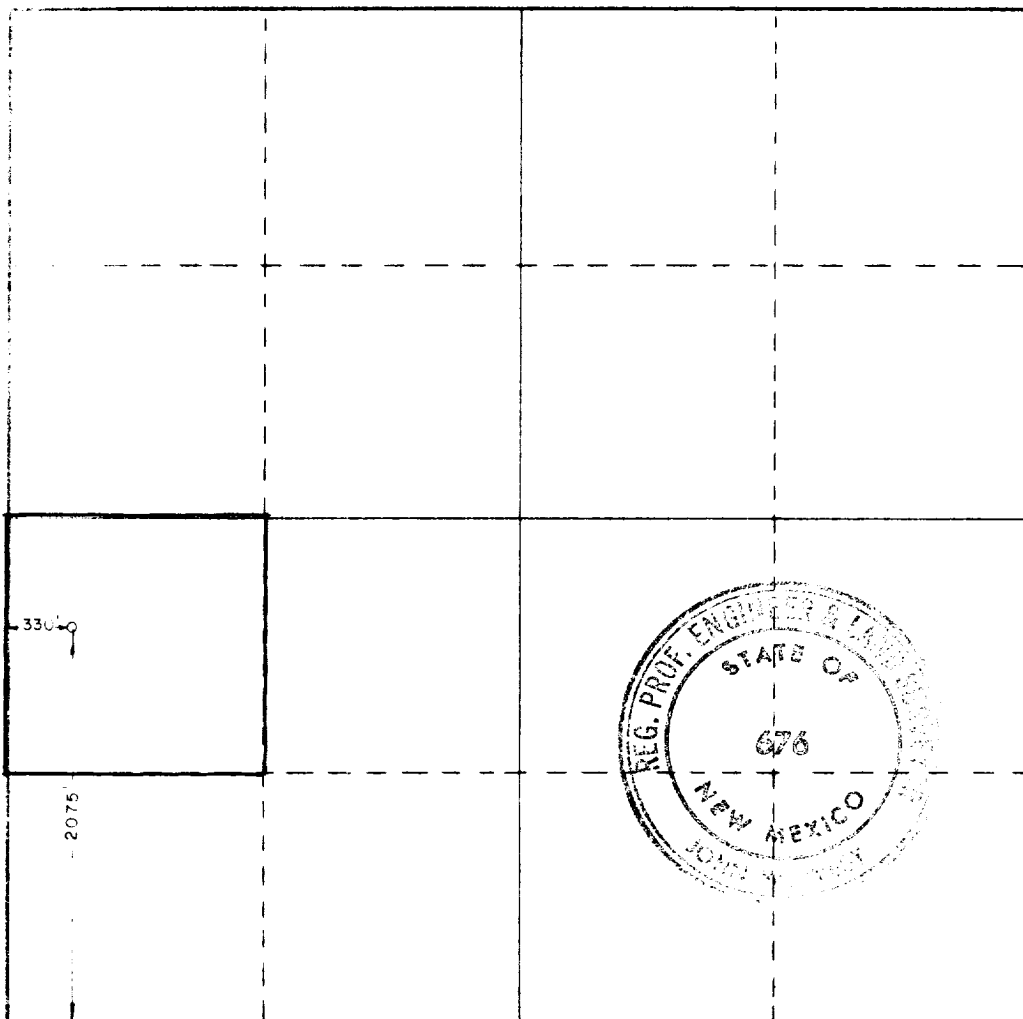

CERTIFICATION

I hereby certify that the information contained herein is true and complete to the best of my knowledge and belief.

Carolyn Orris

Name

Carolyn Orris

Position

Production Clerk

Company

Marbob Energy Corporation

Date

8/15/83

I hereby certify that the well location shown on this plat was plotted from field notes of actual surveys made by me or under my supervision, and that the same is true and correct to the best of my knowledge and belief.

Date Surveyed

July 18, 1983

Registered Professional Engineer and Land Surveyor

John W. West

Certificate No. JOHN W. WEST, 676
RONALD J. EIDSON, 3239

330 660 990 1320 1650 1980 2310 2640 2000 1600 1000 600