

STATE OF NEW MEXICO
ENERGY AND MINERALS DEPARTMENT

OIL CONSERVATION DIVISION

Form C-101
Revised 10-1-78

NO. OF COPIES RECEIVED	
DISTRIBUTION	
SANTA FE	<input checked="" type="checkbox"/>
FILE	<input checked="" type="checkbox"/>
U.S.G.S.	<input checked="" type="checkbox"/>
LAND OFFICE	<input checked="" type="checkbox"/>
OPERATOR	<input checked="" type="checkbox"/>

P. O. BOX 2088
SANTA FE, NEW MEXICO 87501RECEIVED BY
SEP 27 1983

O. C. D.

ARTESIA OFFICE

5A. Indicate Type of Lease
STATE <input checked="" type="checkbox"/> FEE <input type="checkbox"/>
5. State Oil & Gas Lease No.
E-379

APPLICATION FOR PERMIT TO DRILL, DEEPEN, OR PLUG BACK

1a. Type of Work		7. Unit Agreement Name	
DRILL <input checked="" type="checkbox"/> DEEPEN <input type="checkbox"/> PLUG BACK <input type="checkbox"/>		—	
b. Type of Well		8. Farm or Lease Name	
OIL WELL <input checked="" type="checkbox"/> GAS WELL <input type="checkbox"/> OTHER <input type="checkbox"/>		STATE "M"	
2. Name of Operator		9. Well No.	
C.E. LARUE & B.N. MUNCY JR.		1	
3. Address of Operator		10. Field and Pool, or Wildcat	
P.O. BOX 1037 ARTESIA, NM 88210		RED LAKE QN/GB/SA	
4. Location of Well		12. County	
UNIT LETTER M LOCATED 790 FEET FROM THE SOUTH LINE		EDDY	
AND 990 FEET FROM THE WEST LINE OF SEC. 36 TWP. 17S RGE. 27E NMPM			
19. Proposed Depth		19A. Formation	
1400'		QUEEN	
20. Rotary or C.T.		ROTARY	
21. Elevations (show whether DF, RT, etc.)		21B. Drilling Contractor	
3632' GL		ARTESIA FISHING TOOL #1	
21A. Kind & Status Plug. Bond		22. Approx. Date Work will start	
BLANKET		10-1-83	

23. PROPOSED CASING AND CEMENT PROGRAM

SIZE OF HOLE	SIZE OF CASING	WEIGHT PER FOOT	SETTING DEPTH	SACKS OF CEMENT	EST. TOP
11 1/4"	8 5/8"	24#	275'	CIRCULATE	CIRCULATE
7 7/8"	4 1/2"	9 3/4#	1400'	CIRCULATE	CIRCULATE

B.O.P. DIAGRAM - ATTACHED

Post ID-1
9-30-83
New loc & APIAPPROVAL VALID FOR 180 DAYS
PERMIT EXPIRES 3-29-84
UNLESS DRILLING UNDERWAY

4. ABOVE SPACE DESCRIBE PROPOSED PROGRAM; IF PROPOSAL IS TO DEEPEN OR PLUG BACK, GIVE DATA ON PRESENT PRODUCTIVE ZONE AND PROPOSED NEW PRODUCTIVE ZONE. GIVE BLOWOUT PREVENTER PROGRAM, IF ANY.

I hereby certify that the information above is true and complete to the best of my knowledge and belief.

Signed M.B. MUNCY Title AGENT Date 9/27/83
(This space for State Use)APPROVED BY [Signature] TITLE Notify N.M.O.C.C. in sufficient time to witness cementing the 8 5/8" + 4 1/2" casing
OIL AND GAS INSPECTOR
DATE SEP 29 1983
CONDITIONS OF APPROVAL, IF ANY:

NEW MEXICO OIL CONSERVATION COMMISSIO.
WELL LOCATION AND ACREAGE DEDICATION PLAT

Form C-102
Supersedes C-128
Effective 1-1-65

All distances must be from the outer boundaries of the Section.

Operator C.E. LARUE & B.N. MUNCY JR.		Lease State "M"		Well No. 1
Unit Letter M	Section 36	Township 17 South	Range 27 East	County Eddy
Actual Footage Location of Well: 790 feet from the south line and 990 feet from the west line				
Ground Level Elev. 3632.0'	Producing Formation QUEEN	Pool RED LAKE QN/GB/SA	Dedicated Acreage: 40 Acres	

1. Outline the acreage dedicated to the subject well by colored pencil or hachure marks on the plat below.
2. If more than one lease is dedicated to the well, outline each and identify the ownership thereof (both as to working interest and royalty).
3. If more than one lease of different ownership is dedicated to the well, have the interests of all owners been consolidated by communitization, unitization, force-pooling, etc?

☐ Yes ☐ No If answer is "yes," type of consolidation _____

If answer is "no," list the owners and tract descriptions which have actually been consolidated. (Use reverse side of this form if necessary.) _____

No allowable will be assigned to the well until all interests have been consolidated (by communitization, unitization, forced-pooling, or otherwise) or until a non-standard unit, eliminating such interests, has been approved by the Commission.

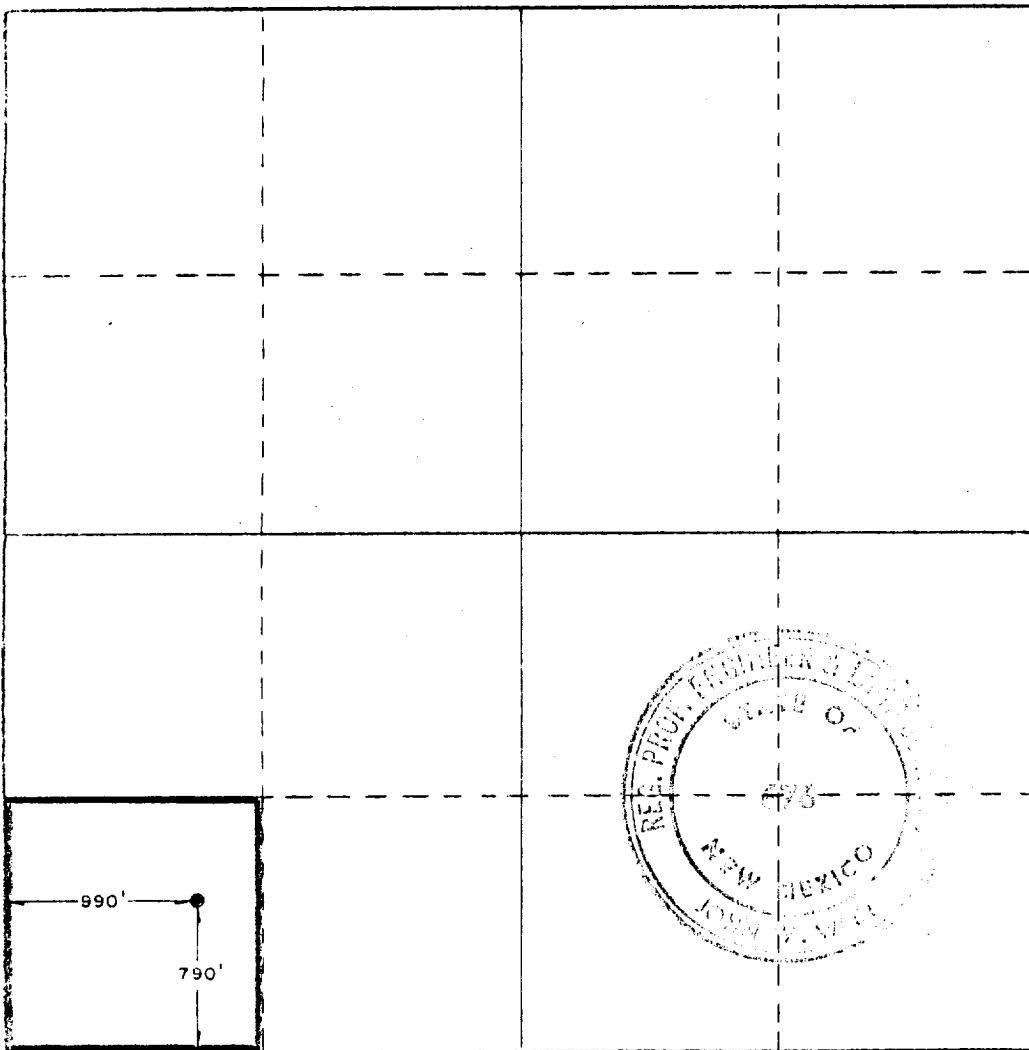

CERTIFICATION

I hereby certify that the information contained herein is true and complete to the best of my knowledge and belief.

Name
MARTIN B. MUNCY

Position
AGENT

Company
C.E. LARUE & B.N. MUNCY JR.

Date
9/27/83

I hereby certify that the well location shown on this plat was plotted from field notes of actual surveys made by me or under my supervision, and that the same is true and correct to the best of my knowledge and belief.

Date Surveyed
August 5, 1983

Registered Professional Engineer and/or Land Surveyor

John W. West
Certificate No. **JOHN W. WEST,** 676

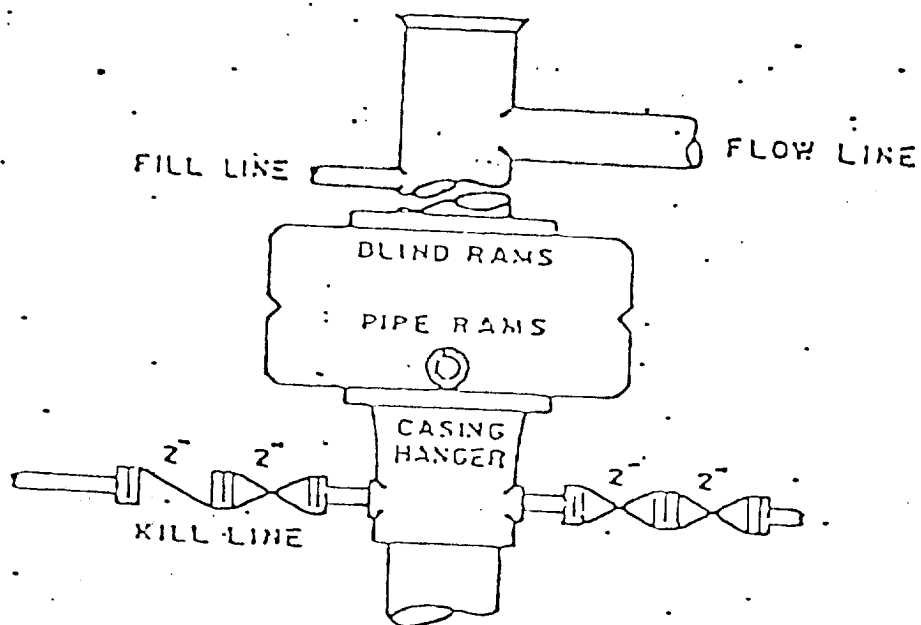

DUAL RAM-TYPE PREVENTER

900 Series