

UNITED STATES
DEPARTMENT OF THE INTERIOR
GEOLOGICAL SURVEY

Drawer DD
Artesia, NM 8. 0

SUBMIT IN TRIPPLICATE*
(Other instructions on re-
verse side)

30-015-24614

Form approved.
Budget Bureau No. 42-R1424.

5. LEASE DESIGNATION AND SERIAL NO.

NM 0255 27A

6. IF INDIAN, ALLOTTEE OR TRIBE NAME

7. UNIT AGREEMENT NAME

8. FARM OR LEASE NAME

BERRY

9. WELL NO.

32Y

10. FIELD AND POOL, OR WILDCAT

Red LAKE-Q-G-SA

11. SEC., T., R., M., OR BLK. AND
SURVEY OR AREA

24 175 27E

12. COUNTY OR PARISH

EDDY

13. STATE

NM

SUNDRY NOTICES AND REPORTS ON WELLS

(Do not use this form for proposals to drill or to deepen or plug back to a different reservoir.
Use "APPLICATION FOR PERMIT—" for such proposals.)

1. OIL WELL ☒ GAS WELL ☐ OTHER ☐

2. NAME OF OPERATOR

LATCH OPERATIONS

3. ADDRESS OF OPERATOR

Box 10108 Lubbock TX 79400

4. LOCATION OF WELL (Report location clearly and in accordance with any State requirements.
See also space 17 below.)
At surface

990 FNL & 980 FEL

14. PERMIT NO.

15. ELEVATIONS (Show whether DF, RT, GR, etc.)

3545 GR

16. Check Appropriate Box To Indicate Nature of Notice, Report, or Other Data

NOTICE OF INTENTION TO:

TEST WATER SHUT-OFF

PULL OR ALTER CASING

FRACTURE TREAT

MULTIPLE COMPLETE

SHOOT OR ACIDIZE

ABANDON*

REPAIR WELL

CHANGE PLANS

(Other)

SUBSEQUENT REPORT OF:

WATER SHUT-OFF

REPAIRING WELL

FRACTURE TREATMENT

ALTERING CASING

SHOOTING OR ACIDIZING

ABANDONMENT*

(Other)

(NOTE: Report results of multiple completion on Well
Completion or Recompletion Report and Log form.)

17. DESCRIBE PROPOSED OR COMPLETED OPERATIONS (Clearly state all pertinent details, and give pertinent dates, including estimated date of starting any
proposed work. If well is directionally drilled, give subsurface locations and measured and true vertical depths for all markers and zones perti-
nent to this work.)*

1. BERRY 32 had to be P/A due to collapsed casing
2. We plan to move the well 10' to the East and will rename it Berry 32Y
3. 10 3/4 x 40.5" conductor pipe will be set to 60' and cemented.
4. 7" x 23" surface will be set to 350' & circulated
5. 4 1/2 x 10.5" will be set to 2300'
6. All long strings will be circulated.
7. NO NEW PAD WILL BE NEEDED.

Post #10-1
10-7-83
New loc. & API

RECEIVED

JUN 3 1983

OIL & GAS

ROSWell, NEW MEXICO

18. I hereby certify that the foregoing is true and correct

SIGNED

Joseph B. Schiele

TITLE

Agent

DATE

6/1/83

(This space for Federal or State office use)

(Orig. Sgd.) PETER W. CHESTER

APPROVED BY

TITLE

DATE

CONDITIONS OF APPROVAL IF ANY

SEP 27 1983

Verbal approval
5/26/83 by A. Lopez

*See Instructions on Reverse Side

OIL CONSERVATION DIVISION

STATE OF NEW MEXICO
ENERGY AND MINERALS DEPARTMENTP. O. BOX 2088
SANTA FE, NEW MEXICO 87501Form C-102
Revised 10-1-78

All distances must be from the outer boundaries of the Section.

Operator LATCH OPERATIONS		Lease BERRY		RECEIVED	Well No. 32Y
Unit Letter A	Section 24	Township 17S	Range 27E	County SEDDY SEP 26 2 43 PM '83	
Actual Postage Location of Well: 996 feet from the North line and 980 feet from the EAST line					
Ground Level Elev. 3545	Producing Formation SAN ANDRES		Pool Port Lake - U-6-SH Empire Yates Seawater	Dedicated Acreage: 40 Acres	

- Outline the acreage dedicated to the subject well by colored pencil or hachure marks on the plat below.
- If more than one lease is dedicated to the well, outline each and identify the ownership thereof (both as to working interest and royalty).
- If more than one lease of different ownership is dedicated to the well, have the interests of all owners been consolidated by communitization, unitization, force-pooling, etc?
☐ Yes ☐ No If answer is "yes," type of consolidation _____
 If answer is "no," list the owners and tract descriptions which have actually been consolidated. (Use reverse side of this form if necessary.) _____
 No allowable will be assigned to the well until all interests have been consolidated (by communitization, unitization, forced-pooling, or otherwise) or until a non-standard unit, eliminating such interests, has been approved by the Division.

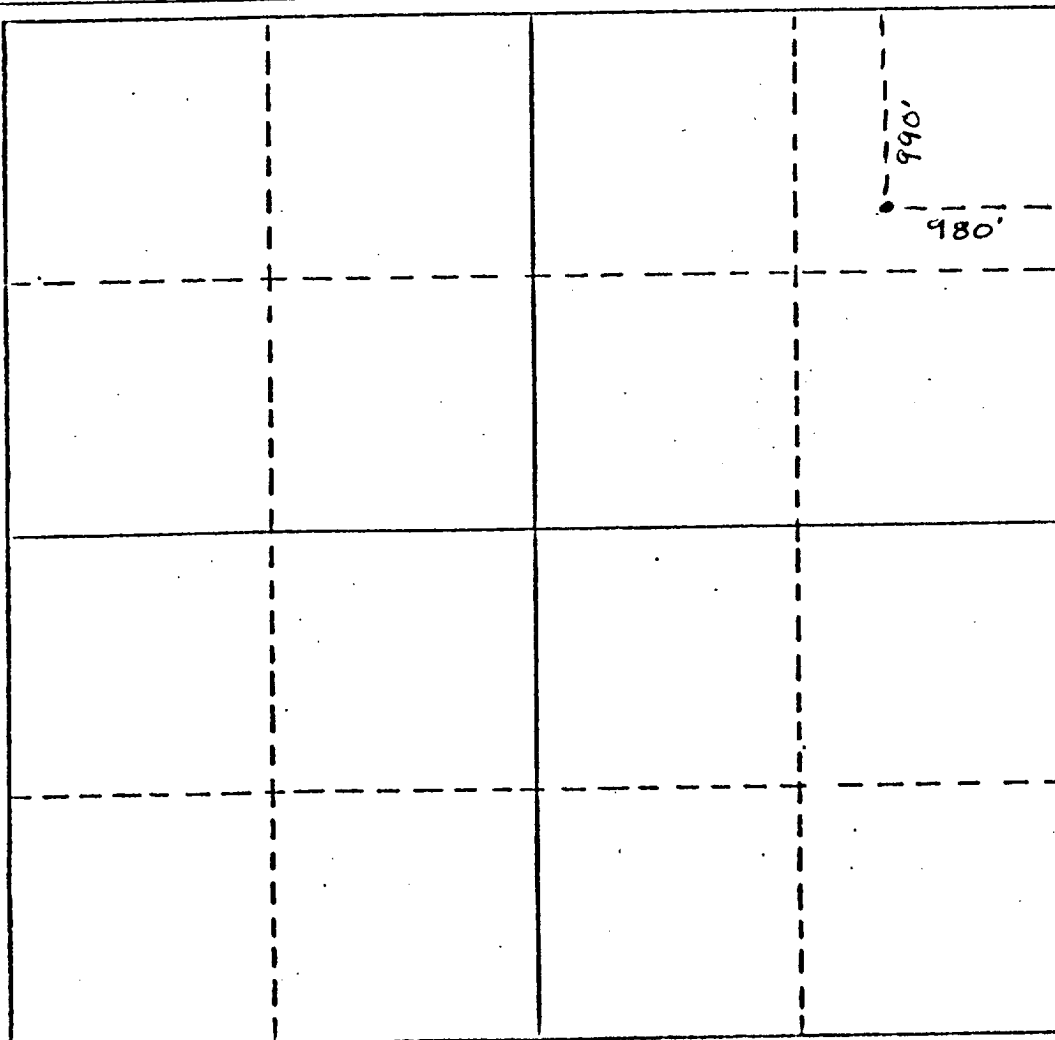

CERTIFICATION

I hereby certify that the information contained herein is true and complete to the best of my knowledge and belief.

Joseph B. Schell Jr.
Name
Agent
Position
LATCH OPERATIONS
Company
22 Sept 83
Date

I hereby certify that the well location shown on this plat was plotted from field notes of actual surveys made by me or under my supervision, and that the same is true and correct to the best of my knowledge and belief.

JUNE 1, 1983
Date Surveyed

Registered Professional Engineer
and/or Land Surveyor

Harold Carey
Certificate No.

802

