

P. O. BOX 2088

SANTA FE, NEW MEXICO 87501

NO. OF COPIES RECEIVED	
DISTRIBUTION	
SANTA FE	<input checked="" type="checkbox"/>
FILE	<input checked="" type="checkbox"/>
U.S.G.S.	<input checked="" type="checkbox"/>
LAND OFFICE	<input checked="" type="checkbox"/>
OPERATOR	<input checked="" type="checkbox"/>

5A. Indicate Type of Lease	
STATE <input type="checkbox"/>	FEE <input checked="" type="checkbox"/>
5. State Oil & Gas Lease No.	

## APPLICATION FOR PERMIT TO DRILL, DEEPEN, OR PLUG BACK

1a. Type of Work

DRILL ☒DEEPEN ☐PLUG BACK ☐

b. Type of Well

OIL WELL ☐GAS WELL ☐

OTHER Injection Well

SINGLE ZONE ☐MULTIPLE ZONE ☐

2. Name of Operator

Yates Petroleum Corporation ✓

3. Address of Operator

207 S. 4th, Artesia, New Mexico 88210

4. Location of Well

UNIT LETTER L LOCATED 2630 FEET FROM THE South LINEAND 660 FEET FROM THE West LINE OF SEC. 23 TWP. 17S RGE. 25E N.M.P.M.

7. Unit Agreement Name

8. Form or Lease Name

Gissler "AV"

9. Well No.

42

10. Field and Pool, or Wildcat

Eagle Creek/SA

11. County

Eddy

19. Proposed Depth	19A. Formation	20. Rotary or C.T.
1500'	San Andres	Rotary
21. Elevations (show whether DF, H1, etc.)	21A. Kind & Status Plug. Bond	21B. Drilling Contractor
3511' GL	Blanket	Undesignated
22. Approx. Date Work will start		
ASAP		

23.

## PROPOSED CASING AND CEMENT PROGRAM

SIZE OF HOLE	SIZE OF CASING	WEIGHT PER FOOT	SETTING DEPTH	SACKS OF CEMENT	EST. TOP
17 1/2"	13 3/8"	48# H-40	320'	200 sx	circulated
12 1/4"	9 5/8"	36# J-55	1170'	400 sx	circulated
8 3/4"	5 1/2"	17# J-55	1500'	200 sx	circulated

We propose to drill and set up a water injection system in the Eagle Creek field. This plan was approved by Mr. Joe Ramey, NMOC Director, 9/26/83 - Case No. 7935, Order No. R-7354.

MUD PROGRAM: FW gel/LCM to 1100' (or dry drill), water to TD.

Posted APR  
28-10-78 Book  
11-14-83

BOP PROGRAM: BOP's will be installed and tested daily.

APPROVAL VALID FOR 180 DAYS  
PERMIT EXPIRES 5-14-84  
UNLESS DRILLING UNDERWAY

ABOVE SPACE DESCRIBE PROPOSED PROGRAM; IF PROPOSAL IS TO DEEPEN OR PLUG BACK, GIVE DATA ON PRESENT PRODUCTIVE ZONE AND PROPOSED NEW PRODUCTIVE ZONE. GIVE BLOWOUT PREVENTER PROGRAM, IF ANY.

I hereby certify that the information above is true and complete to the best of my knowledge and belief.

Signed Cy Carson Title Regulatory Agent Date 11/4/83  
(This space for State Use)

APPROVED BY Mike Wilkins TITLE OIL AND GAS INSPECTOR DATE NOV 14 1983  
CONDITIONS OF APPROVAL, IF ANY:

Notify N.M.O.C.C. in sufficient  
time to witness cementing  
the 9 5/8 casing

W MEXICO OIL CONSERVATION COMMISSION  
WELL LOCATION AND ACREAGE DEDICATION PLAT

Form C-102  
Supersedes C-128  
Effective 1-1-65

All distances must be from the outer boundaries of the Section.

Operator <b>YATES PETROLEUM CORPORATION</b>		Lease <b>Gissler AV</b>		Well No. <b>42</b>
Unit Letter <b>L</b>	Section <b>23</b>	Township <b>17 South</b>	Range <b>25 East</b>	County <b>Eddy</b>
Actual Footage Location of Well: <b>2630</b> feet from the <b>South</b> line and <b>660</b> feet from the <b>West</b> line				
Ground Level Elev. <b>3511.</b>	Producing Formation <b>SAN Andres</b>	Pool <b>EAGLE CREEK (SA)</b>	Dedicated Acreage: <b>40</b> Acres	

1. Outline the acreage dedicated to the subject well by colored pencil or hachure marks on the plat below.
2. If more than one lease is dedicated to the well, outline each and identify the ownership thereof (both as to working interest and royalty).
3. If more than one lease of different ownership is dedicated to the well, have the interests of all owners been consolidated by communitization, unitization, force-pooling, etc?

☐ Yes ☒ No If answer is "yes," type of consolidation \_\_\_\_\_

If answer is "no," list the owners and tract descriptions which have actually been consolidated. (Use reverse side of this form if necessary.) \_\_\_\_\_

No allowable will be assigned to the well until all interests have been consolidated (by communitization, unitization, forced-pooling, or otherwise) or until a non-standard unit, eliminating such interests, has been approved by the Commission.

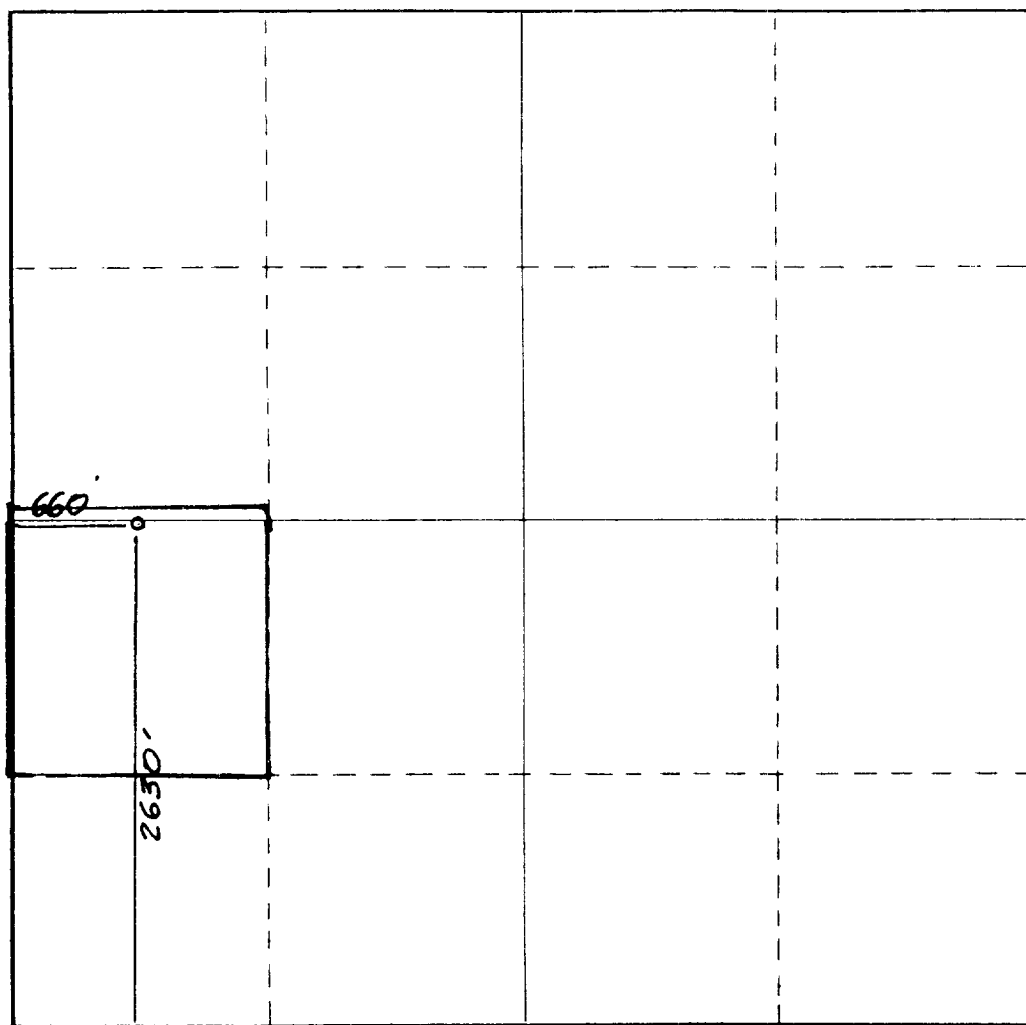

CERTIFICATION

I hereby certify that the information contained herein is true and complete to the best of my knowledge and belief.

*Cy Cowan*

Name

Cy Cowan

Position

Regulatory Agent

Company

Yates Petroleum Corp.

Date

11/4/83

*DAN R. REDDY*  
I hereby certify that the well location shown on this plat was plotted from field notes of actual surveys made by me or under my supervision, and that the same is true and correct to the best of my knowledge and belief.

Date Surveyed

October 29, 1983

Registered Professional Engineer and/or Land Surveyor

*Dan R. Reddy*

Certificate No.

NM PE&LS #5412

0 330 660 990 1320 1650 1980 2310 2640 2970 3300 3630 3960 4290 4620 4950 5280 5610 5940 6270 6600

EXHIBIT B

BDP DIAGRAM

RATED 3000<sup>±</sup>

