

UNITED STATES  
DEPARTMENT OF THE INTERIOR  
GEOLOGICAL SURVEY

## APPLICATION FOR PERMIT TO DRILL, DEEPEN, OR PLUG BACK

## 1a. TYPE OF WORK

DRILL ☒DEEPEN ☐PLUG BACK ☐

## b. TYPE OF WELL

OIL ☒GAS ☐OTHER ☐

## 2. NAME OF OPERATOR

Yates Petroleum Corporation ✓

## 3. ADDRESS OF OPERATOR

207 S. 4th, Artesia, New Mexico 88210

## 4. LOCATION OF WELL (Report location clearly and in accordance with any State requirements.)\*

At surface

990' FSL and 330' FEL

At proposed prod. zone

same

## 14. DISTANCE IN MILES AND DIRECTION FROM NEAREST TOWN OR POST OFFICE\*

Approximately 6 miles west of Artesia, New Mexico.

## 15. DISTANCE FROM PROPOSED\*

LOCATION TO NEAREST  
PROPERTY OR LEASE LINE, FT.

(Also to nearest drlg. unit line, if any)

330'

18. DISTANCE FROM PROPOSED LOCATION\*  
TO NEAREST WELL, DRILLING, COMPLETED,  
OR APPLIED FOR, ON THIS LEASE, FT.

19. PROPOSED DEPTH

320

1460'

## 21. ELEVATIONS (Show whether DF, RT, GR, etc.)

3588  
3558 GL

## 23.

## PROPOSED CASING AND CEMENTING PROGRAM

SIZE OF HOLE	SIZE OF CASING	WEIGHT PER FOOT	SETTING DEPTH	QUANTITY OF CEMENT
14 1/2"	10 3/4"	30#	appr 320'	200 sx circulated
9 1/2"	7"	20#	appr 1100'	400 sx circulated
6 1/2"	4 1/2"	10.5#	TD	125 sx circulated

We propose to drill and test the San Andres and intermediate formations. Approximately 320' of surface casing. 7" intermediate casing will be run to 100' below the Artesian Zone. If commercial, production casing will be run and cemented with adequate cover, perforated and stimulated as needed for production.

MUD PROGRAM: FW gel/LCM to 1100' (or dry drill), water to TD.

BOP PROGRAM: BOP's will be installed at the offset and tested daily.

GAS NOT DEDICATED.

IN ABOVE SPACE DESCRIBE PROPOSED PROGRAM: If proposal is to deepen or plug back, give data on present productive zone and proposed new productive zone. If proposal is to drill or deepen directionally, give pertinent data on subsurface locations and measured and true vertical depths. Give blowout preventer program, if any.

## 24.

SIGNED

TITLE Regulatory Agent

DATE 12/13/83

(This space for Federal or State office use)

PERMIT NO.

'Orig. Sgd.' Earl R. Cunningham

APPROVAL DATE

District Manager

APPROVED BY

CONDITIONS OF APPROVAL, IF ANY

TITLE

DATE

DEC 20 1983

Wanted a plug  
to test back  
2-23-83

**NEW MEXICO OIL CONSERVATION COMMISSION  
WELL LOCATION AND ACREAGE DEDICATION PLAT**

Form O-102  
Supersedes O-128  
Effective 1-1-83

All distances must be from the outer boundaries of the Section

Operator <b>YATES PETROLEUM CORPORATION</b>			Lease <b>Federal CD</b>		Well No. <b>9</b>
Unit Letter <b>D</b>	Section <b>29</b>	Township <b>17 South</b>	Range <b>25 East</b>	County <b>Eddy</b>	
Actual Footage Location of Well:					
990 feet from the <b>South</b> line and		330 feet from the <b>East</b> line			
Land Level Elev. <b>3588</b>	Producing Formation <b>SAN ANDRES</b>	Pool <b>Eagle Creek (SA)</b>	Estimated Acreage <b>40</b>		

1. Outline the acreage dedicated to the subject well by colored pencil or hatchure marks on the plat below.
2. If more than one lease is dedicated to the well, outline each and identify the ownership thereof (both as to working interest and royalty).
3. If more than one lease of different ownership is dedicated to the well, have the interests of all owners been consolidated by communitization, unitization, force-pooling, etc?

☐ Yes ☒ No If answer is "yes" type of consolidation \_\_\_\_\_

If answer is "no," list the owners and tract descriptions which have actually been consolidated. (Use reverse side of this form if necessary.) \_\_\_\_\_

No allowable will be assigned to the well until all interests have been consolidated (by communitization, unitization, forced-pooling, or otherwise) or until a non-standard unit, eliminating such interests, has been approved by the Commission.

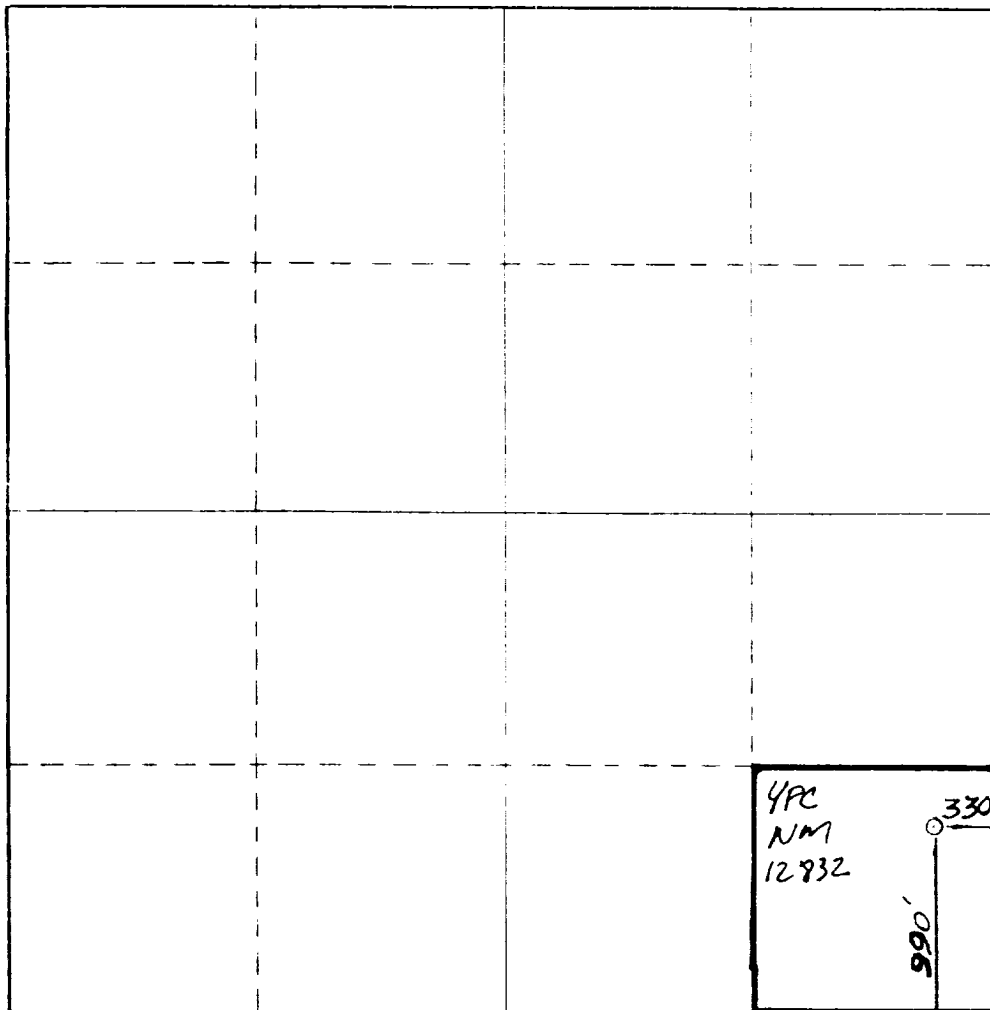

<b>CERTIFICATION</b>	
I hereby certify that the information contained herein is true and complete to the best of my knowledge and belief.	
<i>Cy Cowan</i>	
Name <b>Cy Cowan</b>	
Position <b>Regulatory Agent</b>	
Company <b>Yates Petroleum Corp.</b>	
Date <b>12/13/83</b>	
I hereby certify that the well location shown on this plat was plotted from field notes of actual surveys made by me or under my supervision and that the same are true and correct to the best of my knowledge and belief.	
Date of Survey <b>Dec. 8, 1983</b>	
Registered Professional Engineer and/or Land Surveyor	
<i>Dan R. Reddy</i>	
Certificate No. <b>NMPELS #5412</b>	

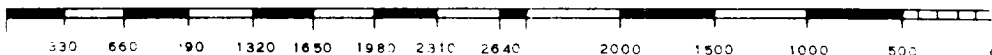
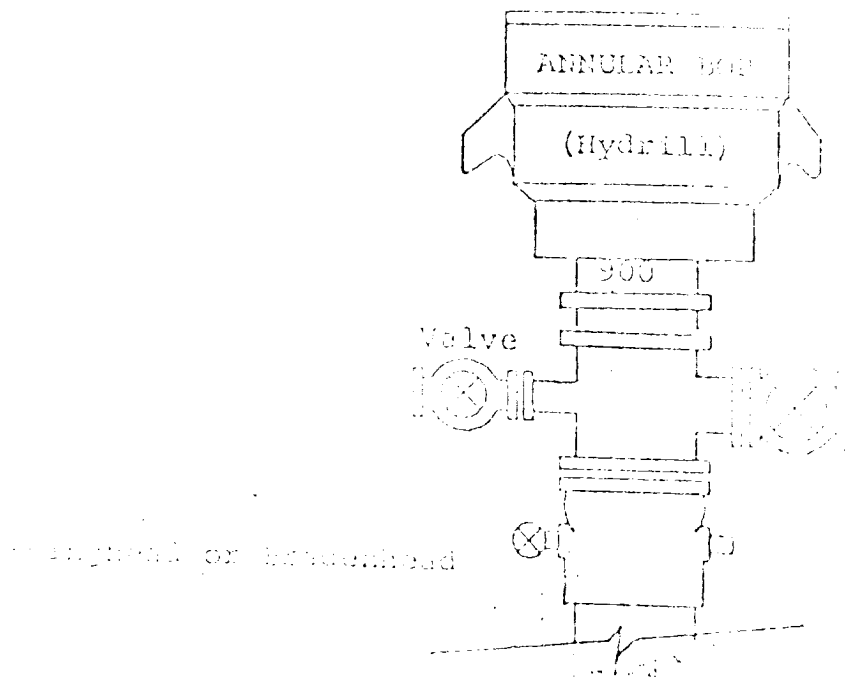

EXHIBIT B  
BDP DIAGRAM  
RATED 3000<sup>42</sup>



YATES PETROLEUM CORPORATION  
Federal "CD" #8  
990' FSL and 330' FEL  
Sec. 29-T17S-R25E

In conjunction with Form 9-331C, Application for Permit to Drill subject well, Yates Petroleum Corporation submits the following ten items of pertinent information in accordance with BIM requirements.

1. The geologic surface formation is quaternary alluvium.
2. The estimated tops of geologic markers are as follows:  
TD                                      appr. 1470'
3. The estimated depths at which anticipated water, oil or gas formations are expected to be encountered:  
  
Water: 150-350' and 700-950'  
  
Oil or Gas: San Andres 1300-1400'
4. Proposed Casing Program: See Form 9-331C.
5. Pressure Control Equipment: See Form 9-331C.
6. Mud Program: See Form 9-331C.
7. Auxiliary Equipment: Kelly Cock; pit level indicators and flow sensor equipment;  
sub with full-opening valve on floor, drill pipe connection.
8. Testing, Logging and Coring Program:  
  
Samples: 10' samples from under surface  
DST's: none  
Coring: none  
Logging: GR-Nuetron
9. No abnormal pressures or temperatures are anticipated.
10. Anticipated starting date: As soon as possible after approval.



YATES PETROLEUM CORP.  
Exhibit C

