

STATE OF NEW MEXICO  
ENERGY AND MINERALS DEPARTMENT

OIL CONSERVATION DIVISION

30-015-24887

Form C-101  
Revised 10-1-78

NO. OF COPIES RECEIVED	
DISTRIBUTION	
SANTA FE	<input checked="" type="checkbox"/>
FILL	<input checked="" type="checkbox"/>
U.S.G.S.	<input checked="" type="checkbox"/>
LAND OFFICE	<input checked="" type="checkbox"/>
OPERATOR	<input checked="" type="checkbox"/>

SANTA FE, NEW MEXICO 87501

RECEIVED BY  
P.O. BOX 2088

JUN 01 1984

O. C. D.  
ARTESIA, OFFICE

5A. Indicate Type of Lease

STATE ☒ FEE ☐

5. State Oil & Gas Lease No.  
B-5862

APPLICATION FOR PERMIT TO DRILL, DEEPEN, OR PLUG BACK

1a. Type of Work		7. Unit Agreement Name	
b. Type of Well OIL WELL <input checked="" type="checkbox"/> GAS WELL <input type="checkbox"/> OTHER <input type="checkbox"/> DRILL <input type="checkbox"/> DEEPEN <input type="checkbox"/> PLUG BACK <input type="checkbox"/> SINGLE ZONE <input type="checkbox"/> MULTIPLE ZONE <input type="checkbox"/>		8. Farm or Lease Name Hudson-Saikin	
2. Name of Operator Metex Pipe & Supply		9. Well No. 2	
3. Address of Operator Box 1037, Artesia, New Mexico 88210		10. Field and Pool, or Wildcat Red Lake <b>Q2 66 SA</b>	
4. Location of Well UNIT LETTER <u>E</u> LOCATED <u>2310</u> FEET FROM THE <u>North</u> LINE AND <u>990</u> FEET FROM THE <u>West</u> LINE OF SEC. <u>31</u> TWP. <u>17 S</u> RGE. <u>28 E</u> N.M.P.M.		12. County Eddy	
19. Proposed Depth 2000		19A. Formation Grayburg	
20. Rotary or C.T. Rotary		21. Elevations (Show whether DF, RT, etc.) 3642 Gr.	
21A. Kind & Status Plug. Bond State Wide		21B. Drilling Contractor La Rue	
22. Approx. Date Work will start 6-5-84			

23.

PROPOSED CASING AND CEMENT PROGRAM

SIZE OF HOLE	SIZE OF CASING	WEIGHT PER FOOT	SETTING DEPTH	SACKS OF CEMENT	EST. TOP
12 1/2"	8 5/8	24#	260'	circ	circ
7 7/8	4 1/2 or 5 1/2	9.5 or 15.5#	2000'	circ	circ

Fresh water from surface to 260'  
Cut brine to 10" brine from 260' to TD.  
BOP INSTALLED ON 8 5/8" CSG.

APPROVAL VALID FOR 180 DAYS  
PERMIT EXPIRES 12-1-84  
UNLESS DRILLING UNDERWAY

IN ABOVE SPACE DESCRIBE PROPOSED PROGRAM; IF PROPOSAL IS TO DEEPEN OR PLUG BACK, GIVE DATA ON PRESENT PRODUCTIVE ZONE AND PROPOSED NEW PRODUCTIVE ZONE. GIVE BLOWOUT PREVENTER PROGRAM, IF ANY.

I hereby certify that the information above is true and complete to the best of my knowledge and belief.

Signed Robert E. DeLong Title Agent Date 6-1-84  
(This space for State Use)

APPROVED BY Sam Brooks TITLE Geologist DATE 6-1-84  
CONDITIONS OF APPROVAL, IF ANY:

## OIL CONSERVATION DIVISION

STATE OF NEW MEXICO  
ENERGY AND MINERALS DEPARTMENTP. O. BOX 2088  
SANTA FE, NEW MEXICO 87501Form C-102  
Revised 10-1-78

All distances must be from the outer boundaries of the Section.

Operator <b>Metex Pipe &amp; Supply</b>		Lease <b>Hudson-Saikin</b>		Well No. <b>2</b>	
Unit Letter <b>E</b>	Section <b>31</b>	Township <b>17 South</b>	Range <b>28 East</b>	County <b>Eddy</b>	
Actual Footage Location of Well:					
<b>2310'</b>	feet from the <b>North</b>	Line and	<b>990'</b>	feet from the <b>West</b>	Line
Ground Level Elev. <b>3642</b>	Producing Formation <b>Grayburg</b>	Pool <b>Red Lake</b>		Dedicated Acreage: <b>40</b> Acres	

1. Outline the acreage dedicated to the subject well by colored pencil or hatchure marks on the plat below.
2. If more than one lease is dedicated to the well, outline each and identify the ownership thereof (both as to working interest and royalty).
3. If more than one lease of different ownership is dedicated to the well, have the interests of all owners been consolidated by communitization, unitization, force-pooling, etc?

☐ Yes ☐ No If answer is "yes," type of consolidation \_\_\_\_\_

If answer is "no," list the owners and tract descriptions which have actually been consolidated. (Use reverse side of this form if necessary.) \_\_\_\_\_

No allowable will be assigned to the well until all interests have been consolidated (by communitization, unitization, forced-pooling, or otherwise) or until a non-standard unit, eliminating such interests, has been approved by the Division.

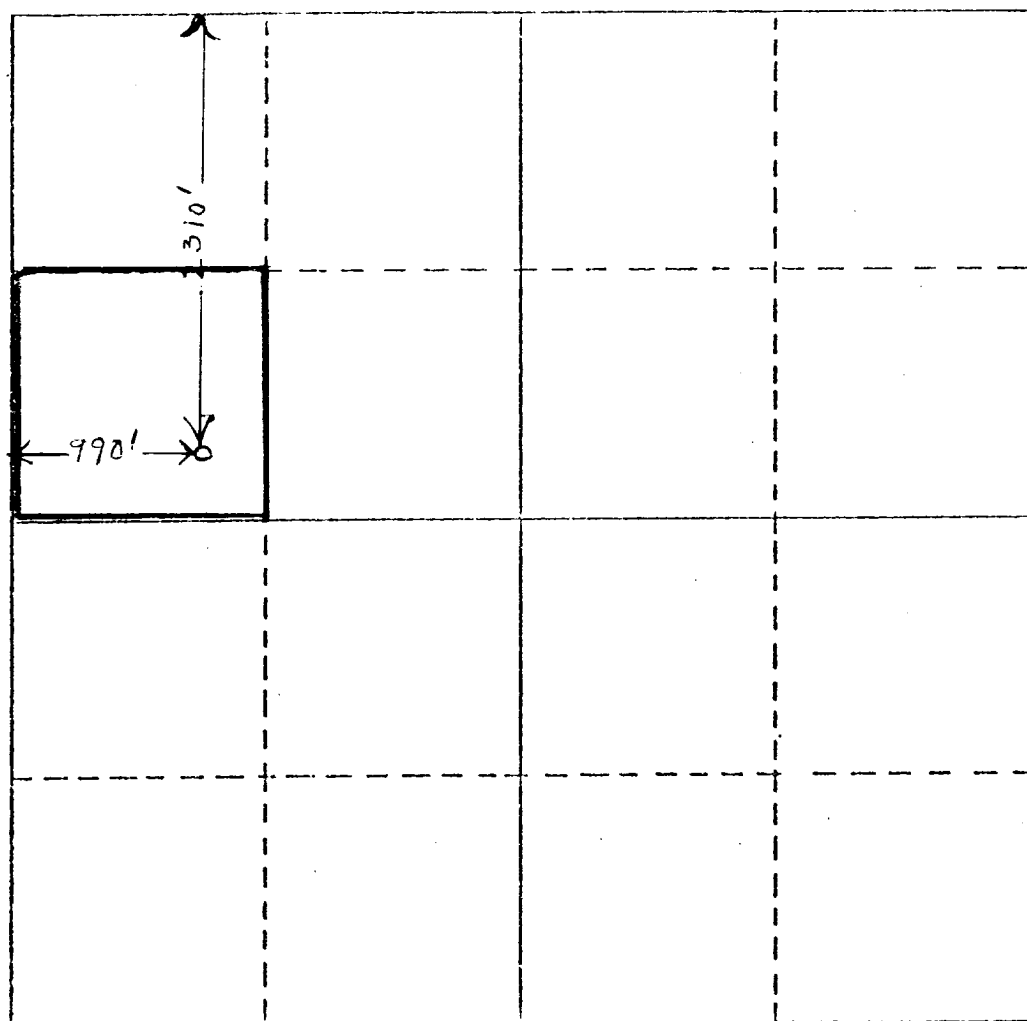

## CERTIFICATION

I hereby certify that the information contained herein is true and complete to the best of my knowledge and belief.

Name Robert E. Baling  
Position Agent

Company  
Metex pipe & Supply

Date  
6-1-1984

I hereby certify that the well location shown on this plat was plotted from field notes of actual surveys made by me or under my supervision, and that the same is true and correct to the best of my knowledge and belief.

6-1-84  
Date Surveyed  
N. Raymond Lamb  
Registered Professional Engineer  
and/or Lead Surveyor

N. Raymond Lamb  
Certificate No. 929

