

NO. OF COPIES RECEIVED	
DISTRIBUTION	
SANTA FE	<input checked="" type="checkbox"/>
FILE	<input checked="" type="checkbox"/>
U.S.G.S.	2
LAND OFFICE	<input checked="" type="checkbox"/>
OPERATOR	<input checked="" type="checkbox"/>

NEW MEXICO OIL CONSERVATION COMMISSION
RECEIVED BY
AUG 08 1985
O. C. D.
ARTESIA, OFFICE

Form C-101
Revised 1-1-85 30-015-25022

5A. Indicate Type of Lease
STATE ☒ FEE ☐
5. State Oil & Gas Lease No.
V-489

APPLICATION FOR PERMIT TO DRILL, DEEPEN, OR PLUG BACK

1a. Type of Work DRILL <input checked="" type="checkbox"/> DEEPEN <input type="checkbox"/> PLUG BACK <input type="checkbox"/>		7. Unit Agreement Name
b. Type of Well OIL WELL <input checked="" type="checkbox"/> GAS WELL <input type="checkbox"/> OTHER <input type="checkbox"/> SINGLE ZONE <input type="checkbox"/> MULTIPLE ZONE <input type="checkbox"/>		8. Farm or Lease Name Duffield "16" State Com.
2. Name of Operator Southland Royalty Company.		9. Well No. 1
3. Address of Operator 21 Desta Drive, Midland, Texas 79705		10. Field and Pool, or Wildcat Diamond Mound (Atoka)-M
4. Location of Well UNIT LETTER N LOCATED 990 FEET FROM THE South LINE AND 2180 FEET FROM THE West LINE OF SEC. 16 TWP. 16S RGE. 27E NMPM		12. County Eddy
19. Proposed Depth 8800'		19A. Formation Atoka
20. Rotary or C.T. Rotary		
21. Elevations (Show whether DF, RT, etc.) 3575.9' OR 3566.2'		21A. Kind & Status Plug. Bond Blanket
21B. Drilling Contractor		22. Approx. Date Work will start 11-12-84

PROPOSED CASING AND CEMENT PROGRAM

SIZE OF HOLE	SIZE OF CASING	WEIGHT PER FOOT	SETTING DEPTH	SACKS OF CEMENT	EST. TOP
17 1/2"	13 3/8"	48#	350'	400 sx.	Circ.
12 1/4"	8 5/8"	24#	1500'	750 sx.	Circ.
7 7/8"	4 1/2"	10.5 & 11.6#	8800'	300 sx.	TOC @ 6000' by

Drill 17 1/2" hole to 350'. Set 13 3/8" csg @ 350'. Cmt w/400 sx. Drill 12 1/4" hole to 1500'. Set 8 5/8" csg @ 1500'. Cmt w/750 sx. Drill 7 7/8" hole to TD to test the Atoka and intermediate horizons with shows. If commercial, run 4 1/2" csg to TD. Cmt w/sufficient volume to bring cmt above prospective zones. Estimated top of cmt @ 6000'. Perforate and stimulate.

MUD PROGRAM: 0-350' spud mud; 350-1500' brine; 1500-8000' fresh wtr; 8000-TD Cut brine, gel, Drispac, 3% KCl. MW 9-9.2. VIS 32-36, 6 cc. BHP @ TD anticipated to be 4400 psi.
BOP PROGRAM: BOP to be installed and tested after setting 8 5/8" cas & at 8000'. BOP to be tested by Yellow Jacket, Inc.

GAS NOT DEDICATED

APPROVAL VALID FOR 180 DAYS
PERMIT EXPIRES 2-15-86
UNLESS DRILLING UNDERWAY

Was Expired Intent

IN ABOVE SPACE DESCRIBE PROPOSED PROGRAM IF PROPOSAL IS TO DEEPEN OR PLUG BACK, GIVE DATA ON PRESENT PRODUCTIVE ZONE AND PROPOSED NEW PRODUCTIVE ZONE. GIVE BLOWOUT PREVENTER PROGRAM, IF ANY.

I hereby certify that the information above is true and complete to the best of my knowledge and belief.

Signed Danell Roberts Title Operations Engineer Date 8-6-85

(This space for State Use)

Original Signed By

APPROVED BY Mike Williams

CONDITIONS OF APPROVAL, IF ANY

TITLE Notify N.M.O.C.C. in sufficient

time to witness cementing

the 8 5/8 casing

DATE AUG 15 1985

**NEW MEXICO OIL CONSERVATION COMMISSION
WELL LOCATION AND ACREAGE DEDICATION PLAT**

Form C-102
Supersedes C-128
Effective 1-1-65

All distances must be from the outer boundaries of the Section

Operator Southland Royalty Co.			Lease Duffield "16" State Com		Well No. 1
Unit Letter N	Section 16	Township 16S	Range 27E	County Eddy	
Actual Footage Location of Well: <div style="display: flex; justify-content: space-between;"> 990 feet from the South line and 2180 feet from the West line </div>					
Ground Level Elev. 3566.3	Producing Formation Atoka		Pool Diamond Mound		Dedicated Acreage: 320 Acres

- Outline the acreage dedicated to the subject well by colored pencil or hatchure marks on the plat below.
- If more than one lease is dedicated to the well, outline each and identify the ownership thereof (both as to working interest and royalty).
- If more than one lease of different ownership is dedicated to the well, have the interests of all owners been consolidated by communitization, unitization, force-pooling, etc?

☒ Yes ☐ No If answer is "yes," type of consolidation Communitized

If answer is "no," list the owners and tract descriptions which have actually been consolidated. (Use reverse side of this form if necessary.) _____

No allowable will be assigned to the well until all interests have been consolidated (by communitization, unitization, forced-pooling, or otherwise) or until a non-standard unit, eliminating such interests, has been approved by the Commission.

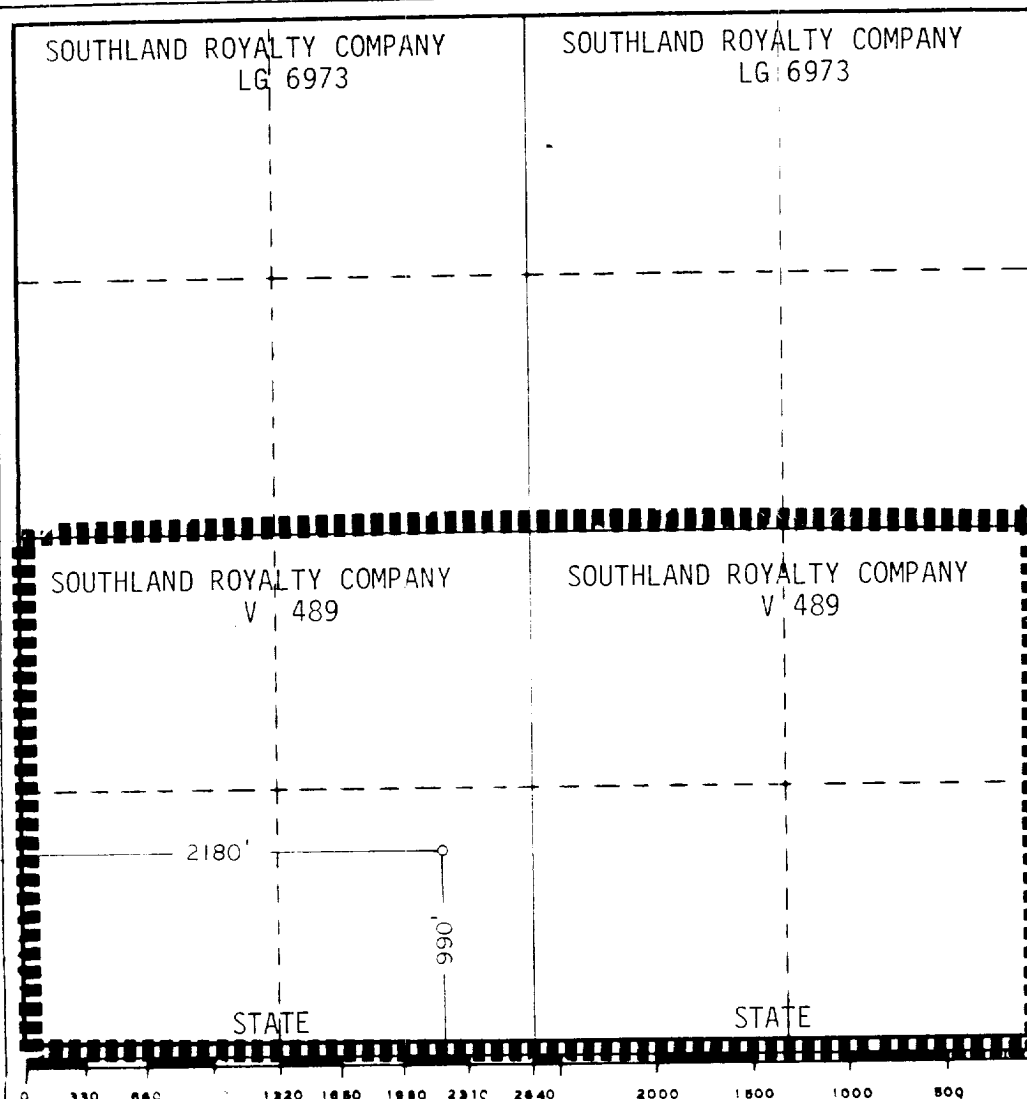

CERTIFICATION	
I hereby certify that the information contained herein is true and complete to the best of my knowledge and belief.	
<i>Darrell Roberts</i>	
Name	Darrell Roberts
Position	Operations Engineer
Company	Southland Royalty Company
Date	8-6-85
I hereby certify that the well location shown on this plat was plotted from field notes of actual surveys made by me or under my supervision, and that the same is true and correct to the best of my knowledge and belief.	
Date Surveyed	Nov. 2, 1985
Registered Professional Engineer and/or Land Surveyor	
<i>John W. West</i>	
Certificate No.	JOHN W. WEST, 676
	RONALD J. EIDSON, 3239