

STATE OF NEW MEXICO
ENERGY AND MINERALS DEPARTMENT

OIL CONSERVATION DIVISION
P. O. BOX 2088
SANTA FE, NEW MEXICO 87501

RECEIVED BY
DEC 03 1984
O. C. D.
ARTESIA, OFFICE

Form C-101
Revised 10-1-80
30-015-25118

NO. OF COPIES RECEIVED	
DISTRIBUTION	
SANTA FE	✓
FILE	✓
U.S.G.S.	2
LAND OFFICE	✓
OPERATOR	✓

5A. Indicate Type of Lease
STATE ☒ FEE ☐
5. State Oil & Gas Lease No.
V-176

APPLICATION FOR PERMIT TO DRILL, DEEPEN, OR PLUG BACK

14. Type of Work a. Type of Well DRILL <input checked="" type="checkbox"/> DEEPEN <input type="checkbox"/> PLUG BACK <input type="checkbox"/> OIL WELL <input checked="" type="checkbox"/> GAS WELL <input type="checkbox"/> OTHER <input type="checkbox"/> SINGLE ZONE <input checked="" type="checkbox"/> MULTIPLE ZONE <input type="checkbox"/>		7. Unit Agreement Name	
2. Name of Operator Marbob Energy Corporation ✓		8. Farm or Lease Name M.C. State	
3. Address of Operator P.O. Drawer 217, Artesia, N.M. 88210		9. Well No. 1	
4. Location of Well UNIT LETTER J LOCATED 2310 FEET FROM THE South LINE AND 2310 FEET FROM THE East LINE OF SEC. 23 TWP. 17S RGE. 28E NADRA		10. Field and Pool, or Wildcat Red Lake Qn Grbg SA	
11. Elevations (show whether DT, KT, etc.) 3700.4' GR		12. County Eddy	
21A. Kind & Status Plug. Bend Statewide active		19. Proposed Depth 3500'	
21B. Drilling Contractor Larue Drilling Co.		19A. Formation San Andres	
22. Approx. Date Work will start 12/5/84		20. Rotary or C.T. Rotary	

PROPOSED CASING AND CEMENT PROGRAM

SIZE OF HOLE	SIZE OF CASING	WEIGHT PER FOOT	SETTING DEPTH	SACKS OF CEMENT	EST. TOP
12 1/4"	8 5/8"	24#	500'	300	Circ.
7 7/8"	5 1/2"	15.50#	3500'	600	Attempt to circ

We propose to drill to 500', set 8 5/8" casing, reduce hole and drill on to 3500' to test the San Andres, run 5 1/2" casing and cement.

APPROVAL VALID FOR 180 DAYS
FORM EXPIRES 6-3-85
UNLESS DRILLING UNDERWAY

Posted ID
API & NL
12-7-84

IN ABOVE SPACE DESCRIBE PROPOSED PROGRAM; IF PROPOSAL IS TO DEEPEN OR PLUG BACK, GIVE DATA ON PRESENT PRODUCTIVE ZONE AND PROPOSED NEW PRODUCTIVE ZONE. GIVE BLOWOUT PREVENTER PROGRAM, IF ANY.

I hereby certify that the information above is true and complete to the best of my knowledge and belief.

Signed Carolyn Gurrillo Title Production Clerk Date 11/30/84

(This space for State Use)

ON FILED
BY LARRY BROOKS
GEOLOGIST - NMOC

APPROVED BY _____ TITLE _____ DATE DEC 03 1984

CONDITIONS OF APPROVAL, IF ANY:

NEW MEXICO OIL CONSERVATION COMMISSION
WELL LOCATION AND ACREAGE DEDICATION PLAT

Form C-102
Supersedes C-128
Effective 1-1-65

All distances must be from the outer boundaries of the Section.

Operator MARBOB ENERGY CORPORATION			Lease M.C. STATE		Well No. 1
Unit Letter J	Section 23	Township 17 South	Range 28 East	County Eddy County	
Actual Footage Location of Well: 2310 feet from the South line and 2310 feet from the East line					
Ground Level Elev. 3700.4	Producing Formation San Andres	Pool Red Lake Qn Grbg SA		Dedicated Acreage: 40 Acres	

1. Outline the acreage dedicated to the subject well by colored pencil or hachure marks on the plat below.
2. If more than one lease is dedicated to the well, outline each and identify the ownership thereof (both as to working interest and royalty).
3. If more than one lease of different ownership is dedicated to the well, have the interests of all owners been consolidated by communitization, unitization, force-pooling, etc?

☐ Yes ☐ No If answer is "yes," type of consolidation _____

If answer is "no," list the owners and tract descriptions which have actually been consolidated. (Use reverse side of this form if necessary.) _____

No allowable will be assigned to the well until all interests have been consolidated (by communitization, unitization, forced-pooling, or otherwise) or until a non-standard unit, eliminating such interests, has been approved by the Commission.

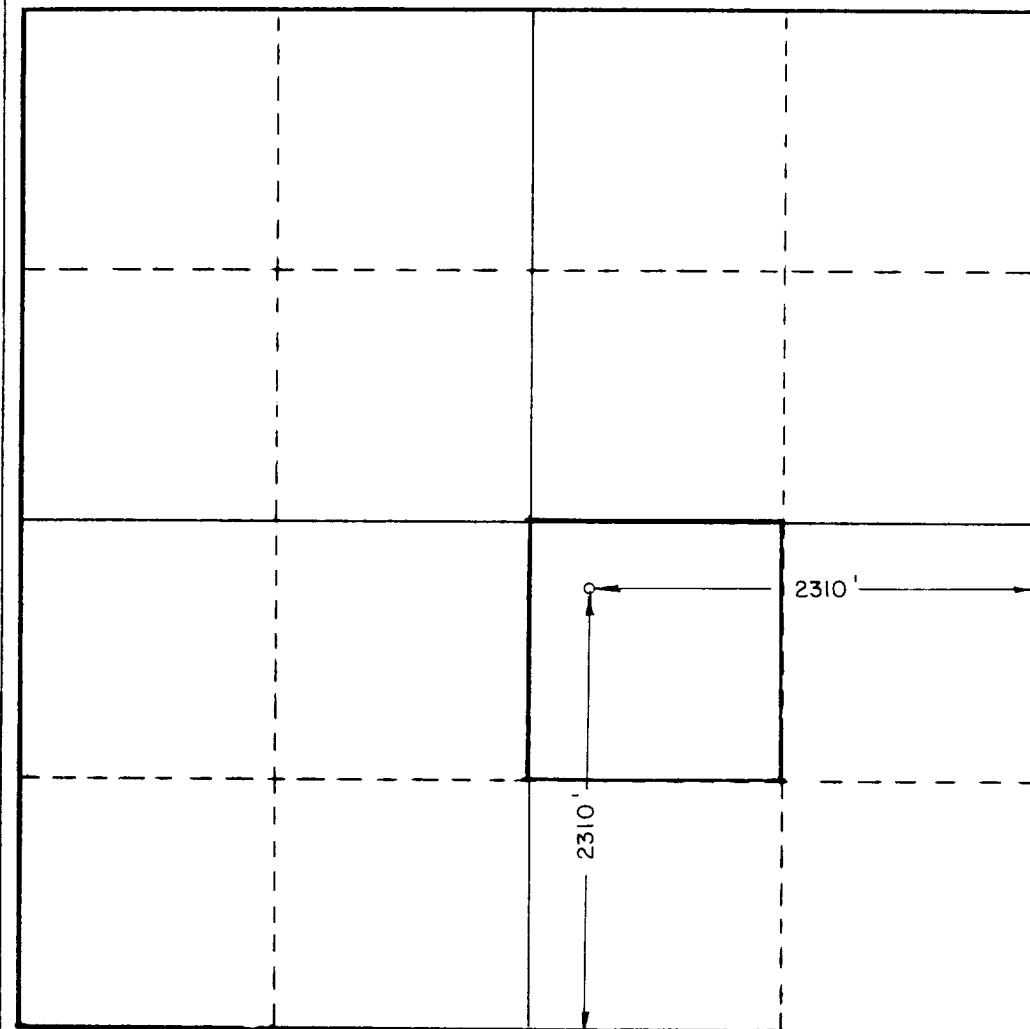

CERTIFICATION

I hereby certify that the information contained herein is true and complete to the best of my knowledge and belief.

Carolyn Purcella
Name

Carolyn Purcella

Position

Production Clerk

Company

Marbob Energy Corporation

Date

11/14/84

I hereby certify that the well location shown on this plat was plotted from field notes of actual surveys made by me or under my supervision, and that the same is true and correct to the best of my knowledge and belief.

Date Surveyed

October 27, 1984

Registered Professional Engineer and/or Land Surveyor

John W. West

Certificate No. JOHN W. WEST, 676

RONALD J. EIDSON, 3239