

UNITED STATES  
DEPARTMENT OF THE INTERIOR  
GEOLOGICAL SURVEY

JAN 7 1985  
APPLICATION FOR PERMIT TO DRILL, DEEPEN, OR PLUG BACK

30-015-25154

5. LEASE DESIGNATION AND SERIAL NO.  
NM-025527-A

6. IF INDIAN, ALLOTTEE OR TRIBE NAME

7. UNIT AGREEMENT NAME

8. FARM OR LEASE NAME  
Berry A

9. WELL NO.  
33

10. FIELD AND POOL, OR WILDCAT  
Empire Yates SR

11. SEC., T., R., M., OR B.L.  
AND SURVEY OR AREA  
Sec. 24-T17S-R27E

12. COUNTY OR PARISH  
Eddy

13. STATE  
N.M.

1. TYPE OF WORK  
ARTESIA OFFICE  
OIL WELL ☒ GAS WELL ☐ OTHER WIV SINGLE ZONE ☒ MULTIPLE ZONE ☐

2. NAME OF OPERATOR  
Marbob Energy Corporation

3. ADDRESS OF OPERATOR  
P.O. Drawer 217, Artesia, N.M. 88210

4. LOCATION OF WELL (Report location clearly and in accordance with any State requirements.)\*  
At surface 1610 FSL 2040 FWL  
At proposed prod. zone Same

14. DISTANCE IN MILES AND DIRECTION FROM NEAREST TOWN OR POST OFFICE\*  
8 air miles east of Artesia, N.M. 88210

15. DISTANCE FROM PROPOSED\* LOCATION TO NEAREST PROPERTY OR LEASE LINE, FT. (Also to nearest drig. unit line, if any) 1610'

16. NO. OF ACRES IN LEASE 1400

17. NO. OF ACRES ASSIGNED TO THIS WELL 40

18. DISTANCE FROM PROPOSED LOCATION\* TO NEAREST WELL, DRILLING, COMPLETED, OR APPLIED FOR, ON THIS LEASE, FT. 1300'

19. PROPOSED DEPTH 600'

20. ROTARY OR CABLE TOOLS  
Rotary

21. ELEVATIONS (Show whether DF, RT, GR, etc.)  
3512' GR

22. APPROX. DATE WORK WILL START\*  
1/1/85

23. PROPOSED CASING AND CEMENTING PROGRAM

SIZE OF HOLE	SIZE OF CASING	WEIGHT PER FOOT	SETTING DEPTH	QUANTITY OF CEMENT
12 1/4"	8 5/8"	24#	350'	Sufficient to circulate
7 7/8"	5 1/2"	15.50#	600'	Attempt to circulate

Attached are: 1. Location & acreage dedication plat  
2. Supplemental drilling data  
3. Surface use plan

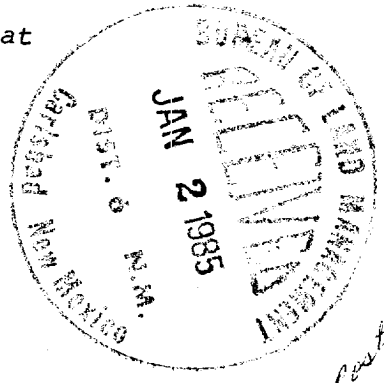

IN ABOVE SPACE DESCRIBE PROPOSED PROGRAM: If proposal is to deepen or plug back, give data on present productive zone and proposed new productive zone. If proposal is to drill or deepen directionally, give pertinent data on subsurface locations and measured and true vertical depths. Give blowout preventer program, if any.

24. SIGNED Carolyn Purcella TITLE Production Clerk DATE 12/18/84  
(This space for Federal or State office use)

PERMIT NO. \_\_\_\_\_ APPROVAL DATE \_\_\_\_\_  
APPROVED BY \_\_\_\_\_ TITLE AREA MANAGER  
CONDITIONS OF APPROVAL, IF ANY: CARLESON RESOURCE AREA DATE 1-4-85

Subject to WIV  
Like Approval Location  
by State

\*See Instructions On Reverse Side

APPROVAL SUBJECT TO  
GENERAL REQUIREMENTS AND  
SPECIAL STIPULATIONS  
ATTACHED

**NEW MEXICO OIL CONSERVATION COMMISSION  
WELL LOCATION AND ACREAGE DEDICATION PLAT**

Form C-102  
Supersedes C-128  
Effective 1-1-65

All distances must be from the outer boundaries of the Section

Operator <b>MARBOB ENERGY CORP.</b>			Lease <b>BERRY A</b>		Well No. <b>33</b>
Unit Letter <b>K</b>	Section <b>24</b>	Township <b>17S</b>	Range <b>27E</b>	County <b>EDDY</b>	
Actual Footage Location of Well: <b>2040</b> feet from the <b>WEST</b> line and <b>1610</b> feet from the <b>SOUTH</b> line					
Ground Level Elev. <b>3512.0</b>	Producing Formation <b>Seven Rivers</b>		Pool <b>Empire Yates Seven Rivers</b>		Dedicated Acreage: <b>40</b> Acres

1. Outline the acreage dedicated to the subject well by colored pencil or hachure marks on the plat below.
2. If more than one lease is dedicated to the well, outline each and identify the ownership thereof (both as to working interest and royalty).
3. If more than one lease of different ownership is dedicated to the well, have the interests of all owners been consolidated by communitization, unitization, force-pooling, etc?

☐ Yes    ☐ No    If answer is "yes," type of consolidation \_\_\_\_\_

If answer is "no," list the owners and tract descriptions which have actually been consolidated. (Use reverse side of this form if necessary.) \_\_\_\_\_

No allowable will be assigned to the well until all interests have been consolidated (by communitization, unitization, forced-pooling, or otherwise) or until a non-standard unit, eliminating such interests, has been approved by the Commission.

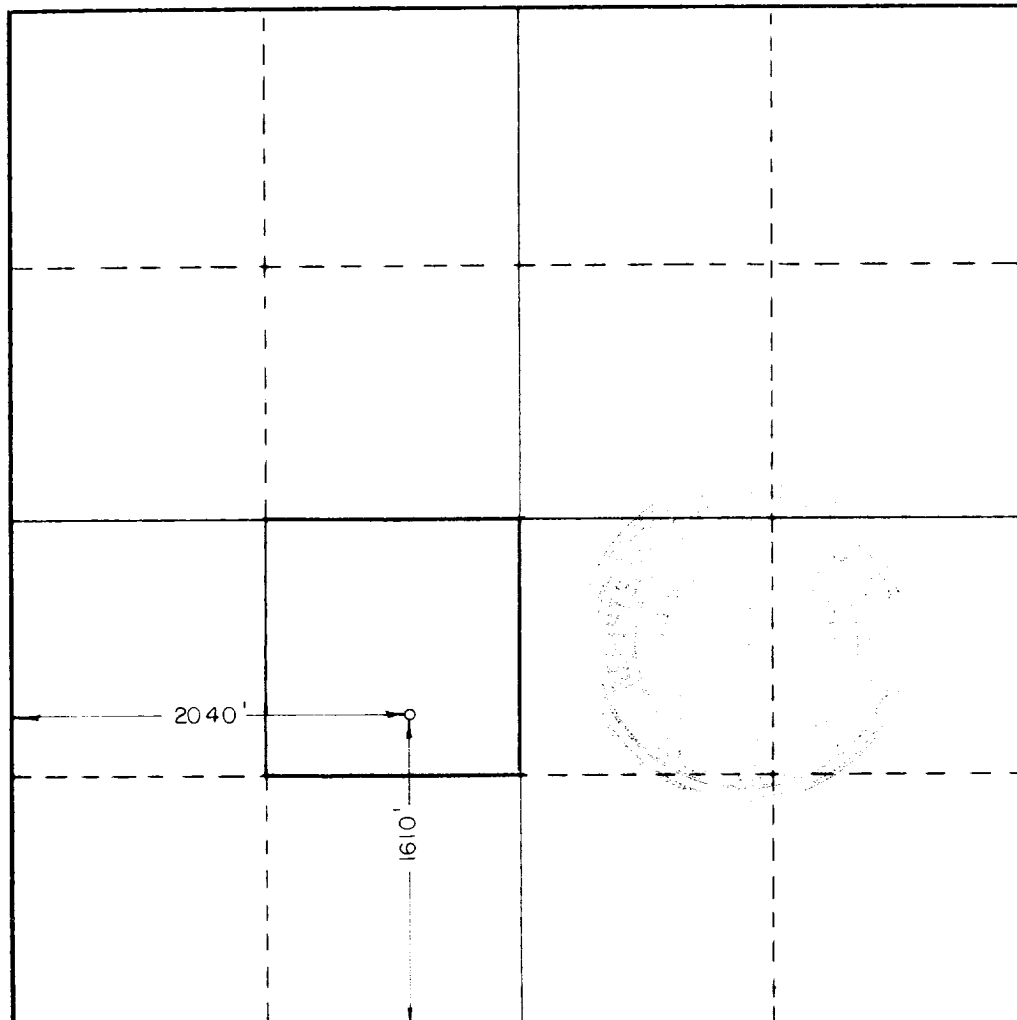

**CERTIFICATION**

I hereby certify that the information contained herein is true and complete to the best of my knowledge and belief.

*Carolyn Purcella*  
Name

*Carolyn Purcella*  
Position

*Production Clerk*  
Company

*Marbob Energy Corp.*  
Date

*12/18/84*

I hereby certify that the well location shown on this plat was plotted from field notes of actual surveys made by me or under my supervision, and that the same is true and correct to the best of my knowledge and belief.

Date Surveyed  
*11/13/84*

Registered Professional Engineer  
and/or Land Surveyor

*Ronald J. Eidson*  
Certificate No. **JOHN W. WEST, 676**  
**RONALD J. EIDSON, 3239**

**REGAN OFFSHORE INTERNATIONAL, INC.**

Torrance,

*Annuale*

**REGAN BLOWOUT PREVENTERS**

The Regan Torus Blowout Preventer is used primarily on production and workover rigs for well control up to 3000 PSI working pressure.

**DESIGN FEATURES**

- The Torus Preventer is designed for minimum weight to facilitate its use with production and workover rigs.
- The rubber packer will conform to any size foot in the well bore. Sealing ability is not affected by minor damage to the inner layer.
- The packer will seal in open hole at full working pressure.
- The dual packer design increases the reliability of the preventer since the outer rubber is never exposed to the well bore. Packer reliability service: the outer packer is rarely replaced.

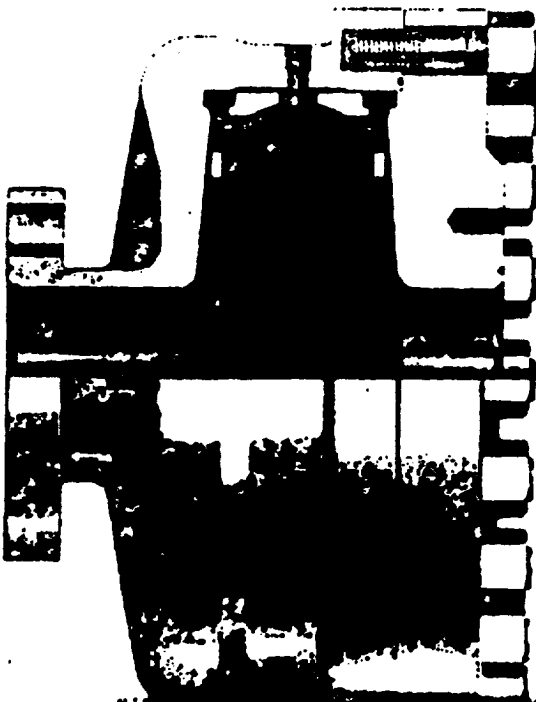

**TORUS BLOWOUT PREVENTER**  
PATENTED

**SPECIFICATIONS**

DIMENSIONS (in.)						
Nominal Size	Test Pressure (psi)	Outside Diameter	True Bore	Overall Height	Weight (lb.)	End Flanges (I)
6	1000	24	21 1/2	19 1/2	140	2000 x 2000
8	1500	30	27 1/2	25 1/2	220	2400 x 2400
10	2000	36	33 1/2	31 1/2	300	3000 x 3000
12	2500	42	39 1/2	37 1/2	400	3600 x 3600
14	3000	48	45 1/2	43 1/2	500	4200 x 4200
16	3500	54	51 1/2	49 1/2	600	4800 x 4800
18	4000	60	57 1/2	55 1/2	700	5400 x 5400
20	4500	66	63 1/2	61 1/2	800	6000 x 6000
22	5000	72	69 1/2	67 1/2	900	6600 x 6600
24	5500	78	75 1/2	73 1/2	1000	7200 x 7200
26	6000	84	81 1/2	79 1/2	1100	7800 x 7800
28	6500	90	87 1/2	85 1/2	1200	8400 x 8400
30	7000	96	93 1/2	91 1/2	1300	9000 x 9000
32	7500	102	99 1/2	97 1/2	1400	9600 x 9600
34	8000	108	105 1/2	103 1/2	1500	10200 x 10200
36	8500	114	111 1/2	109 1/2	1600	10800 x 10800
38	9000	120	117 1/2	115 1/2	1700	11400 x 11400
40	9500	126	123 1/2	121 1/2	1800	12000 x 12000
42	10000	132	129 1/2	127 1/2	1900	12600 x 12600
44	10500	138	135 1/2	133 1/2	2000	13200 x 13200
46	11000	144	141 1/2	139 1/2	2100	13800 x 13800
48	11500	150	147 1/2	145 1/2	2200	14400 x 14400
50	12000	156	153 1/2	151 1/2	2300	15000 x 15000
52	12500	162	159 1/2	157 1/2	2400	15600 x 15600
54	13000	168	165 1/2	163 1/2	2500	16200 x 16200
56	13500	174	171 1/2	169 1/2	2600	16800 x 16800
58	14000	180	177 1/2	175 1/2	2700	17400 x 17400
60	14500	186	183 1/2	181 1/2	2800	18000 x 18000
62	15000	192	189 1/2	187 1/2	2900	18600 x 18600
64	15500	198	195 1/2	193 1/2	3000	19200 x 19200
66	16000	204	201 1/2	199 1/2	3100	19800 x 19800
68	16500	210	207 1/2	205 1/2	3200	20400 x 20400
70	17000	216	213 1/2	211 1/2	3300	21000 x 21000
72	17500	222	219 1/2	217 1/2	3400	21600 x 21600
74	18000	228	225 1/2	223 1/2	3500	22200 x 22200
76	18500	234	231 1/2	229 1/2	3600	22800 x 22800
78	19000	240	237 1/2	235 1/2	3700	23400 x 23400
80	19500	246	243 1/2	241 1/2	3800	24000 x 24000
82	20000	252	249 1/2	247 1/2	3900	24600 x 24600
84	20500	258	255 1/2	253 1/2	4000	25200 x 25200
86	21000	264	261 1/2	259 1/2	4100	25800 x 25800
88	21500	270	267 1/2	265 1/2	4200	26400 x 26400
90	22000	276	273 1/2	271 1/2	4300	27000 x 27000
92	22500	282	279 1/2	277 1/2	4400	27600 x 27600
94	23000	288	285 1/2	283 1/2	4500	28200 x 28200
96	23500	294	291 1/2	289 1/2	4600	28800 x 28800
98	24000	300	297 1/2	295 1/2	4700	29400 x 29400
100	24500	306	303 1/2	301 1/2	4800	30000 x 30000

1. Bottom Flange  
2. Top Flange  
3. Side Flange  
4. Side Flange  
5. Side Flange  
6. Side Flange  
7. Side Flange  
8. Side Flange  
9. Side Flange  
10. Side Flange  
11. Side Flange  
12. Side Flange  
13. Side Flange  
14. Side Flange  
15. Side Flange  
16. Side Flange  
17. Side Flange  
18. Side Flange  
19. Side Flange  
20. Side Flange  
21. Side Flange  
22. Side Flange  
23. Side Flange  
24. Side Flange  
25. Side Flange  
26. Side Flange  
27. Side Flange  
28. Side Flange  
29. Side Flange  
30. Side Flange  
31. Side Flange  
32. Side Flange  
33. Side Flange  
34. Side Flange  
35. Side Flange  
36. Side Flange  
37. Side Flange  
38. Side Flange  
39. Side Flange  
40. Side Flange  
41. Side Flange  
42. Side Flange  
43. Side Flange  
44. Side Flange  
45. Side Flange  
46. Side Flange  
47. Side Flange  
48. Side Flange  
49. Side Flange  
50. Side Flange  
51. Side Flange  
52. Side Flange  
53. Side Flange  
54. Side Flange  
55. Side Flange  
56. Side Flange  
57. Side Flange  
58. Side Flange  
59. Side Flange  
60. Side Flange  
61. Side Flange  
62. Side Flange  
63. Side Flange  
64. Side Flange  
65. Side Flange  
66. Side Flange  
67. Side Flange  
68. Side Flange  
69. Side Flange  
70. Side Flange  
71. Side Flange  
72. Side Flange  
73. Side Flange  
74. Side Flange  
75. Side Flange  
76. Side Flange  
77. Side Flange  
78. Side Flange  
79. Side Flange  
80. Side Flange  
81. Side Flange  
82. Side Flange  
83. Side Flange  
84. Side Flange  
85. Side Flange  
86. Side Flange  
87. Side Flange  
88. Side Flange  
89. Side Flange  
90. Side Flange  
91. Side Flange  
92. Side Flange  
93. Side Flange  
94. Side Flange  
95. Side Flange  
96. Side Flange  
97. Side Flange  
98. Side Flange  
99. Side Flange  
100. Side Flange

SUP Exhibit "F"

REGAN BLOWOUT PREVENTER  
Harbob Energy Corporation  
Well #33 Berry A Federal  
NE1SW1 SEC. 24-17S-27E.

## SUPPLEMENTAL DRILLING DATA

MARPOB ENERGY CORPORATION  
WELL #33 BEEFY A FEDERAL  
NE1/4SW1/4 SEC. 24-17S-27E  
BEEFY COUNTY, NEW MEXICO  
(INJECTION WELL)

1. SURFACE FORMATION: Quaternary.
2. ESTIMATED TOPS OF GEOLOGIC MARKERS:

Yates	200'	Queen	930'
Seven Rivers	400'	Grayburg	1380'
Eyers	730'	San Andres	1725'
		Lovington	1800'

3. ANTICIPATED POROSITY ZONES:

Water	200'-230'
Oil	420'-600'

4. CASING DESIGN:

<u>SIZE</u>	<u>INTERVAL</u>	<u>WEIGHT</u>	<u>GRADE</u>	<u>JOINT</u>	<u>CONDITION</u>
8 5/8"	0-350'	24.0#	K-55	STC	New
5 1/2"	0-600'	15.5#	K-55	STC	New

5. SURFACE CONTROL EQUIPMENT: A double ram-type or annular BOP will be used. (See diagram attached as Exhibit "E")

6. CIRCULATING MEDIUM:

0 - 350'	Fresh water mud with gel or lime as needed for viscosity control.
350'- 600'	Fresh water mud, conditioned as necessary for control of viscosity and water loss or gain.

7. AUXILIARY EQUIPMENT: Drill string safety valve.
8. LOGGING PROGRAM: CNL-FDC W/CR Log will be run to TD.
9. ABNORMAL PRESSURES, TEMPERATURES OR GASES: A water flow may be encountered in the Yates section.
10. ANTICIPATED STARTING DATE: It is planned that operations will commence about January 1, 1985. Duration of drilling, testing and completion operations should be one to four weeks.

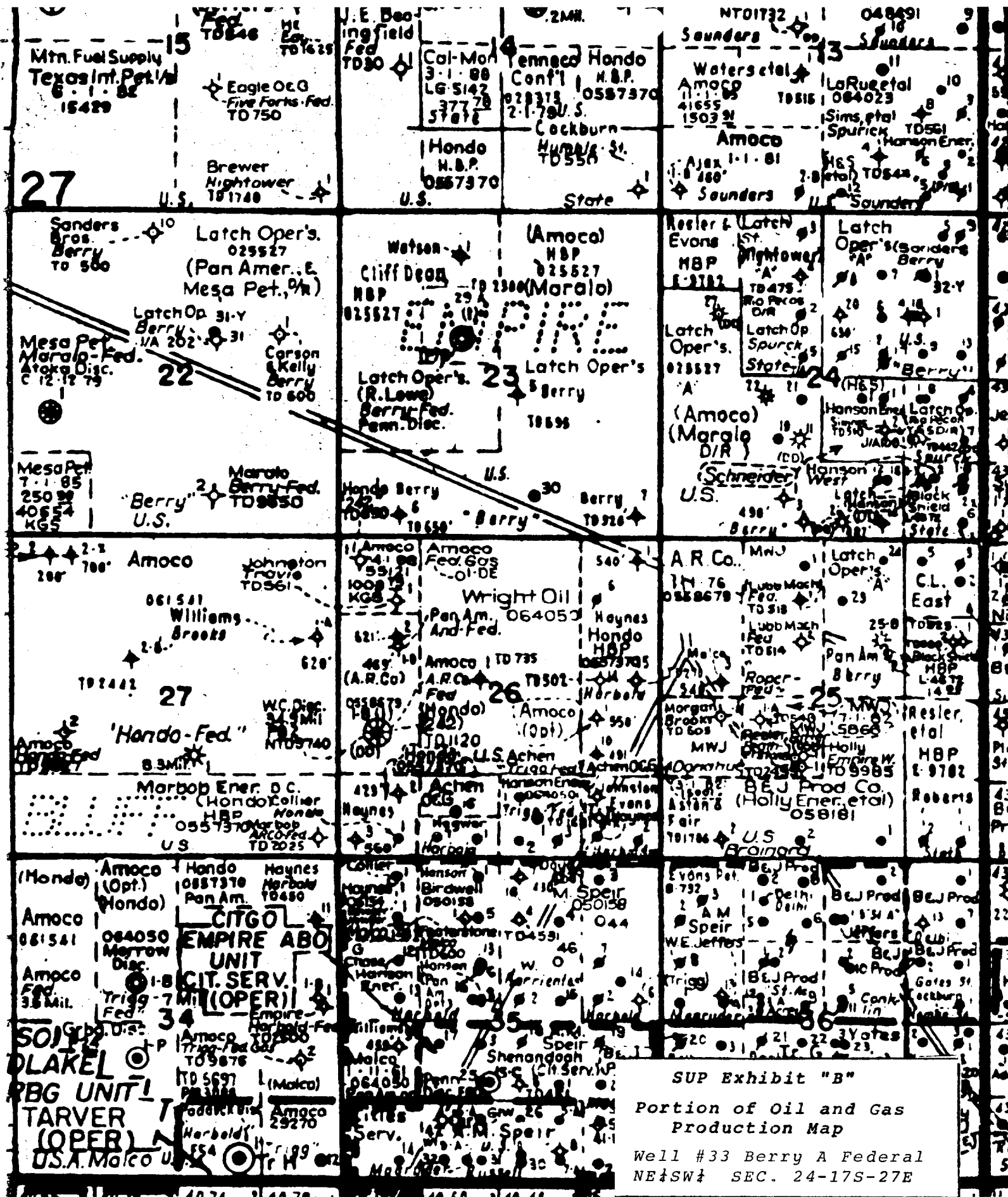

**SUP Exhibit "B"**  
**Portion of Oil and Gas**  
**Production Map**  
**Well #33 Berry A Federal**  
**NE $\frac{1}{4}$ SW $\frac{1}{4}$  SEC. 24-17S-27E**

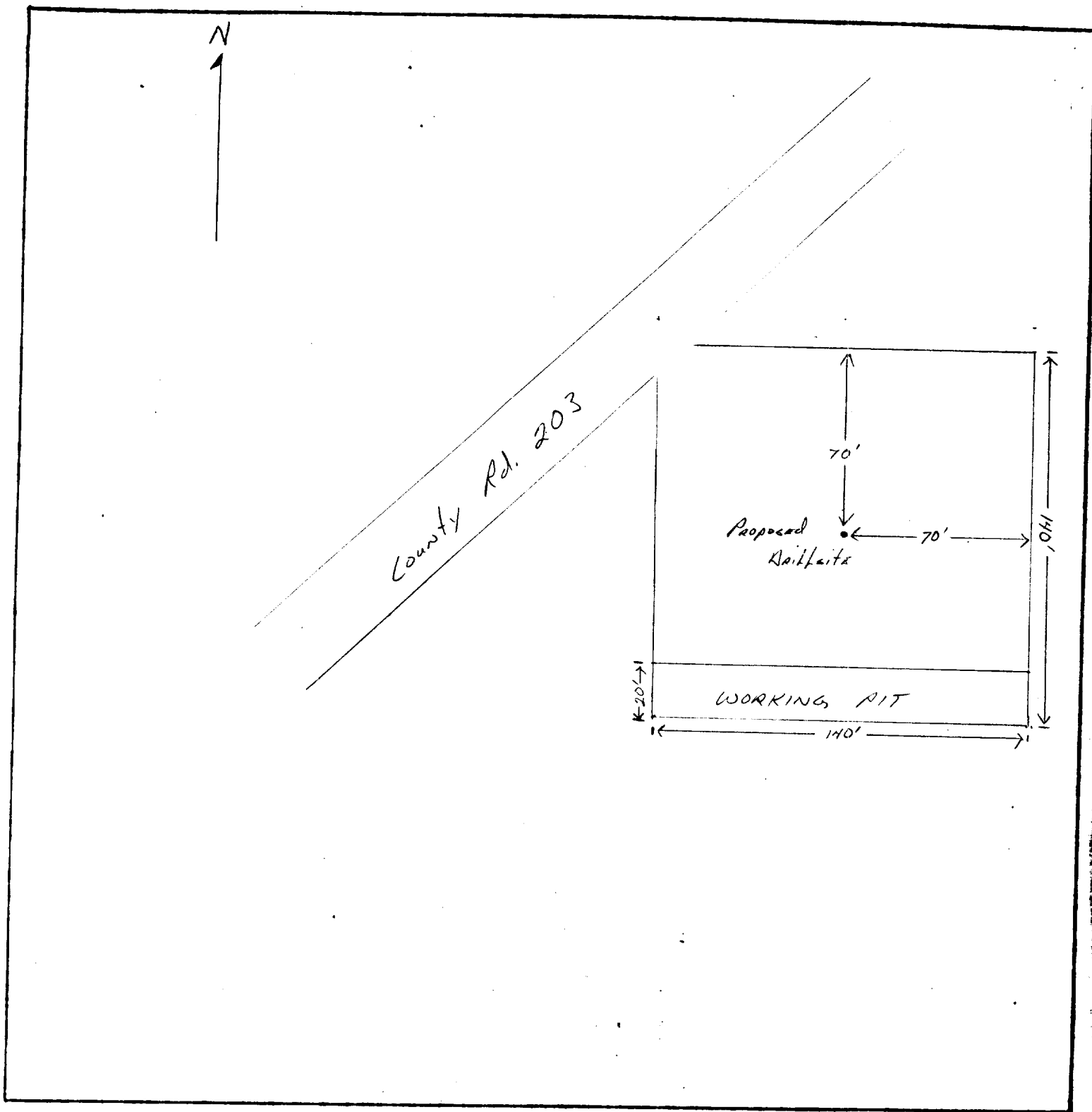

LEGEND

1cm = 20 ft.

SUP Exhibit "D"

SKETCH OF PROPOSED WELL PAD  
Well #33 Berry A Federal  
NE $\frac{1}{4}$ SW $\frac{1}{4}$  SEC. 24-17S-27E