

RECEIVED BY

DEC 13 1984

NEW MEXICO OIL CONSERVATION COMMISSION  
WELL LOCATION AND ACREAGE DEDICATION PLATForm C-102  
Supersedes C-128  
Effective 1-1-65

All distances must be from the outer boundaries of the Section.

Operator Tom R. Minihan		Lease South Red Lake Grayburg Unit		Well No. 45
Unit B	Section 35	Township 17 South	Range 27 East	County Eddy
Actual Footage Location of Well: 330 feet from the North line and 1661 feet from the East line				
Ground Level Elev.	Producing Formation Grayburg	Pool Redlake Grayburg	Dedicated Acreage: 40 Acres	

1. Outline the acreage dedicated to the subject well by colored pencil or hatchure marks on the plat below.
2. If more than one lease is dedicated to the well, outline each and identify the ownership thereof (both as to working interest and royalty).
3. If more than one lease of different ownership is dedicated to the well, have the interests of all owners been consolidated by communitization, unitization, force-pooling, etc?

☐ Yes ☐ No If answer is "yes," type of consolidation \_\_\_\_\_

If answer is "no," list the owners and tract descriptions which have actually been consolidated. (Use reverse side of this form if necessary.) \_\_\_\_\_

No allowable will be assigned to the well until all interests have been consolidated (by communitization, unitization, forced-pooling, or otherwise) or until a non-standard unit, eliminating such interests, has been approved by the Commission.

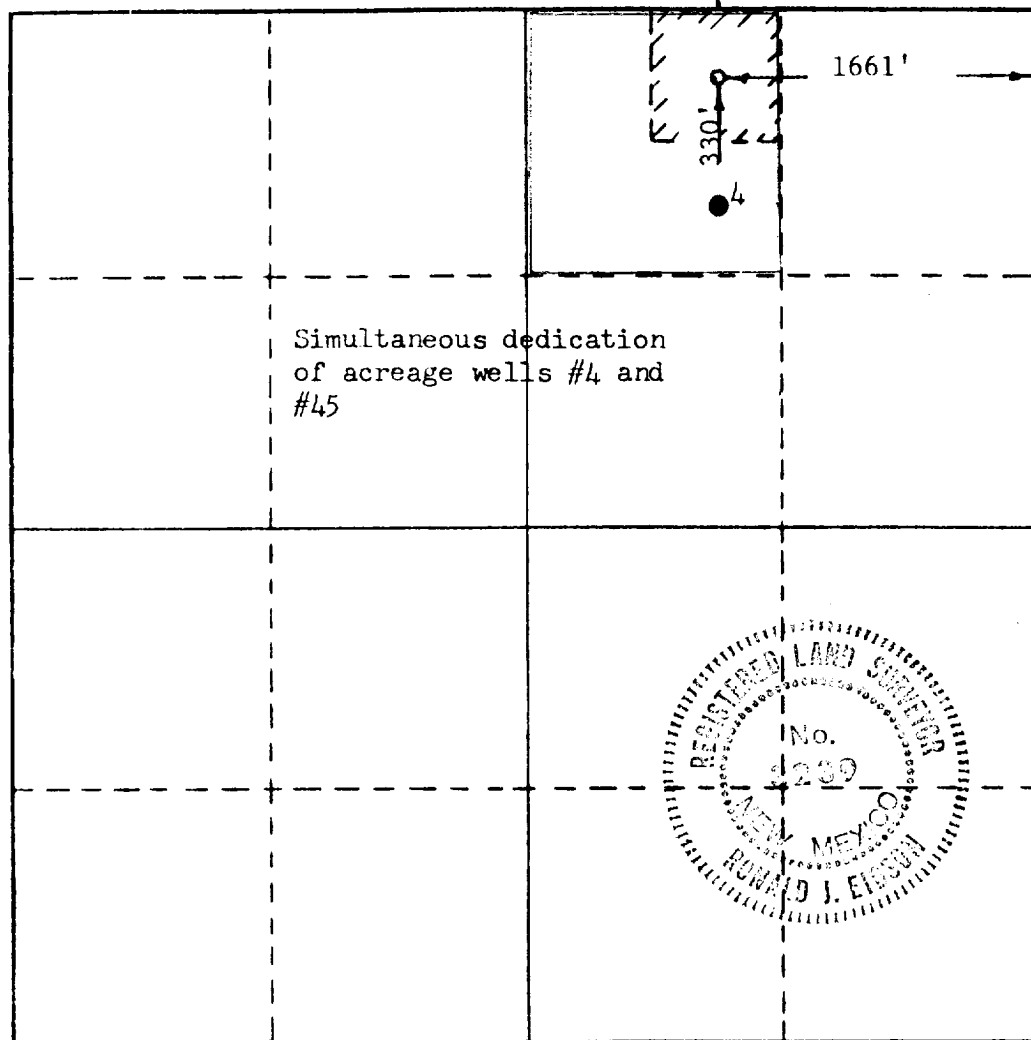

## CERTIFICATION

I hereby certify that the information contained herein is true and complete to the best of my knowledge and belief.

Name Tom R. Minihan  
Position Co-Owner  
Company Ton R. Minihan  
Date December 22, 1982

I hereby certify that the well location shown on this plat was plotted from field notes of actual surveys made by me or under my supervision, and that the same is true and correct to the best of my knowledge and belief.

Date Surveyed December 22, 1982  
Registered Professional Engineer and/or Land Surveyor Ronald J. Eidson  
Certificate No. JOHN W. WEST 676  
PATRICK A. ROMERO 6463  
Ronald J. Eidson 3239

0 800 1000 1800 2000 2640 2840 3200 3400 3600 3800 4000 4200 4400 4600 4800 5000 5200 5400 5600 5800 6000 6200 6400 6600 6800 7000 7200 7400 7600 7800 8000 8200 8400 8600 8800 9000 9200 9400 9600 9800 10000