

NEW MEXICO OIL CONSERVATION COMMISSION
 WELL LOCATION AND ACREAGE DEDICATION PLAT

RECEIVED BY Form C-102
 Supercedes C-128
 Effective 1-1-65

NOV 30 1984

All distances must be from the outer boundaries of the Section.

Operator Tom R. Minihan		Lease South Red Lake Grayburg Unit O. C. D. Well No. 46		
Unit Letter G	Section 35	Township 17 South	Range 27 East	County Eddy

Actual Footage Location of Well:

1656 feet from the North line and 1656 feet from the East line	
Ground Level Elev.	Producing Formation Grayburg
Pool S R L Grayburg	Dedicated Acreage: XXXX 40 Acres

1. Outline the acreage dedicated to the subject well by colored pencil or hatchure marks on the plat below.
2. If more than one lease is dedicated to the well, outline each and identify the ownership thereof (both as to working interest and royalty).
3. If more than one lease of different ownership is dedicated to the well, have the interests of all owners been consolidated by communitization, unitization, force-pooling, etc?

☐ Yes ☐ No If answer is "yes," type of consolidation _____

If answer is "no," list the owners and tract descriptions which have actually been consolidated. (Use reverse side of this form if necessary.) _____

No allowable will be assigned to the well until all interests have been consolidated (by communitization, unitization, forced-pooling, or otherwise) or until a non-standard unit, eliminating such interests, has been approved by the Commission.

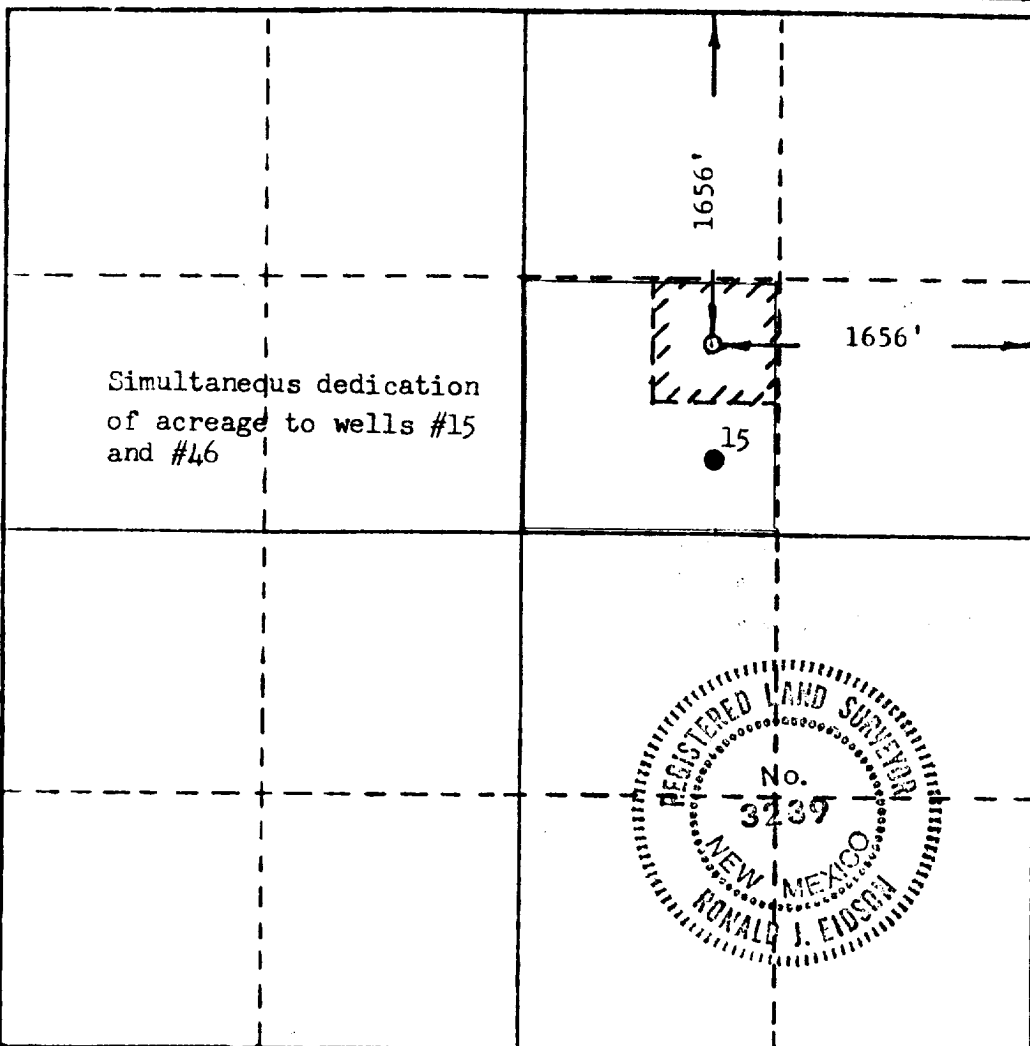

CERTIFICATION

I hereby certify that the information contained herein is true and complete to the best of my knowledge and belief.

Name
Tom R. Minihan
 Position
Co-Owner
 Company
Tom R. Minihan
 Date
December 22, 1982

I hereby certify that the well location shown on this plat was plotted from field notes of actual surveys made by me or under my supervision, and that the same is true and correct to the best of my knowledge and belief.

Date Surveyed
December 22, 1982
 Registered Professional Engineer
 and/or Land Surveyor

Certificate No. JOHN A. WEST 676
 PATRICK A. ROMERO 6888
 Ronald J. Eidson 3239

