

NO. OF COPIES RECEIVED	
DISTRIBUTION	
SANTA FE	✓
FILE	✓
U.S.G.S.	✓
LAND OFFICE	✓
OPERATOR	✓

NEW MEXICO OIL CONSERVATION COMMISSION

Form C-101
Revised 1-1-65

JAN 06 '89

O. C. D.
ARTESIA OFFICE

5A. Indicate Type of Lease STATE <input type="checkbox"/> FEE <input checked="" type="checkbox"/>
5. State Oil & Gas Lease No.
7. Unit Agreement Name
8. Farm or Lease Name Powell-Kissinger BS
9. Well No. 2
10. Field and Pool, or Wildcat Eagle Creek Strawn
12. Locality Eddy
19. Proposed Depth Strawn
19A. Formation Strawn
20. Pulling Unit Pulling Unit
21. Elevations (Show whether DP, RT, etc.) 3552' GR
21A. Kind & Status Plug. Bond Blanket
21B. Drilling Contractor
22. Approx. Date Work will start When approved

APPLICATION FOR PERMIT TO DRILL, DEEPEN, OR PLUG BACK

1a. Type of Work b. Type of Well OIL WELL <input type="checkbox"/> GAS WELL <input checked="" type="checkbox"/> OTHER RECOMPLETE <input type="checkbox"/> SINGLE ZONE <input type="checkbox"/> MULTIPLE ZONE <input type="checkbox"/>	DRILL <input type="checkbox"/> DEEPEN <input type="checkbox"/> PLUG BACK <input checked="" type="checkbox"/>
2. Name of Operator Yates Petroleum Corporation ✓	
3. Address of Operator 105 South 4th St., Artesia, NM 88210	
4. Location of Well UNIT LETTER 0 LOCATED 990 FEET FROM THE South LINE AND 1650 FEET FROM THE East LINE OF SEC. 33 TWP. 17S RGT. 25E NMPM	
19. Proposed Depth	19A. Formation
20. Pulling Unit	
21. Elevations (Show whether DP, RT, etc.)	21A. Kind & Status Plug. Bond
21B. Drilling Contractor	22. Approx. Date Work will start

PROPOSED CASING AND CEMENT PROGRAM

SIZE OF HOLE	SIZE OF CASING	WEIGHT PER FOOT	SETTING DEPTH	SACKS OF CEMENT	EST. TOP
17 1/2"	13-3/8"	54.5#	249'	250 sx (in place)	
12 1/2"	8-5/8"	24#	1120'	600 sx (in place)	
7-7/8"	5 1/2"	15.5 & 17#	8500'	1895 sx (in place)	

Well presently completed in Atoka-Morrow perforations 8160-63' and 8348-67'. Propose to set a CIBP at 8300' w/35' cement on top. Will set a blanking plug in Atoka packer, perforate Strawn limes at 7700-03' and 8550-56', stimulate and complete as dual Atoka-Strawn with Strawn producing thru a sliding sleeve.

IN ABOVE SPACE DESCRIBE PROPOSED PROGRAM: IF PROPOSAL IS TO DEEPEN OR PLUG BACK, GIVE DATA ON PRESENT PRODUCTIVE ZONE AND PROPOSED NEW PRODUCTIVE ZONE. GIVE BLOWOUT PREVENTER PROGRAM, IF ANY.

I hereby certify that the information above is true and complete to the best of my knowledge and belief.

Signature James A. Doadler Title Production Supervisor Date 1-4-89
(This space for State Use)

Original Signed by

APPROVED BY Mike Williams TITLE DATE

CONDITIONS OF APPROVAL, IF ANY:

All distances must be from the outer boundaries of the Section.

Operator Yates Petroleum Corporation		Lease Powell-Kissinger BS		Well No. 2
Unit Letter 0	Section 33	Township 17 South	Range 25 East	County Eddy
Actual Postage Location of Well: 990 feet from the South line and 1650 feet from the East line				
Ground Level Elev. 3552'	Producing Formation Strawn	Pool Eagle Creek Strawn	Dedicated Acreage: 320 Acres	

- Outline the acreage dedicated to the subject well by colored pencil or hachure marks on the plat below.
- If more than one lease is dedicated to the well, outline each and identify the ownership thereof (both as to working interest and royalty).
- If more than one lease of different ownership is dedicated to the well, have the interests of all owners been consolidated by communitization, unitization, force-pooling, etc?

☐ Yes ☒ No If answer is "yes," type of consolidation _____

If answer is "no," list the owners and tract descriptions which have actually been consolidated. (Use reverse side of this form if necessary.) _____

No allowable will be assigned to the well until all interests have been consolidated (by communitization, unitization, forced-pooling, or otherwise) or until a non-standard unit, eliminating such interests, has been approved by the Division.

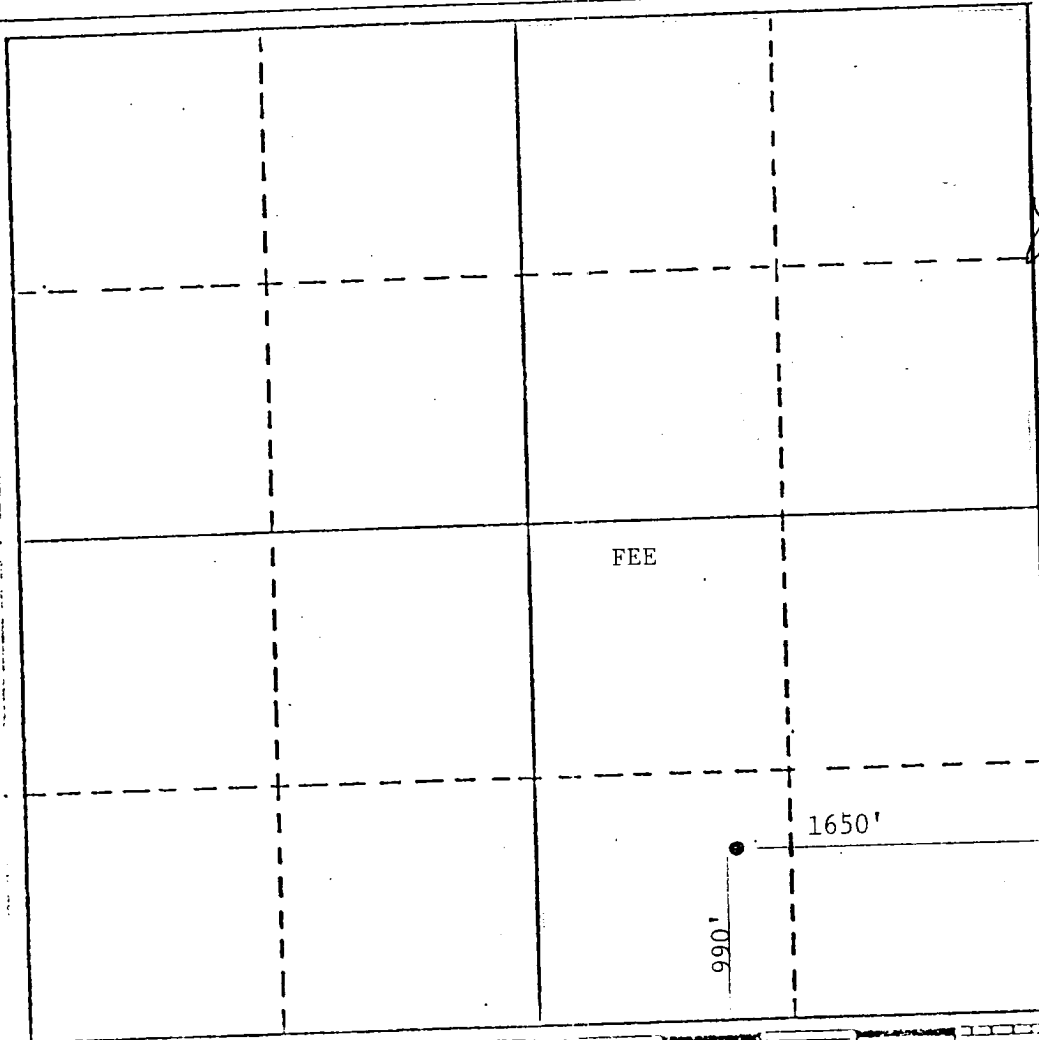

CERTIFICATION

I hereby certify that the information contained herein is true and complete to the best of my knowledge and belief.

Juanita Goodlett
Name

Juanita Goodlett

Position
Production Supervisor

Company
Yates Petroleum Corporation

Date
12-4-89

I hereby certify that the well location shown on this plat was plotted from field notes of actual surveys made by me or under my supervision, and that the same is true and correct to the best of my knowledge and belief.

REFER TO ORIGINAL PLAT.

Date Surveyed

Registered Professional Engineer
and/or Land Surveyor

Certificate No.

